

NOTES:
 ▲ SINGLE PACKING: ONE CONNECTOR PER LABELED BAG PACKAGED. LABELED PER TEC-107-115
 ▲ Ag PLATING
 ▲ COLOR: WHITE

- 4 ELECTRICAL CHARACTERISTICS
- FREQUENCY RANGE: DC - 4 GHz
 - NOMINAL IMPEDANCE: 50 Ohm
 - INSULATION RESISTANCE: 5000 Mohm
 - WORKING VOLTAGE: 500 Volts RMS at Sea Level
 - DIELECTRIC WITHSTAND VOLTAGE: 1200 Volts RMS Max
 - CONTACT RESISTANCE: 1.00 mOhm Max
 - CENTRE CONTACT: 1.00 mOhm Max
 - OUTER CONTACT: 1.30:1 Max
 - VSWR @ 4GHz: 0.30 Max
 - INSERTION LOSS dB @ x 3 GHz: 170N Min
500 Cycles Min
- 5 MECHANICAL CHARACTERISTICS
- CABLE RETENTION FORCE: -65 to +165 DegC
 - DURABILITY: 500 Cycles Min
- 6 ENVIRONMENTAL CHARACTERISTICS
- OPERATING TEMPERATURE: -65 to +165 DegC
- 7 ALL DIMENSIONS ARE NOMINAL FOR REFERENCE ONLY UNLESS OTHERWISE STATED
- 8 FOR USE ON CABLES: RG58C/U, 141A/U, URM43, 76, BELDEN 9907
- ▲ TRAY PACKAGE

NOT
RELEASED

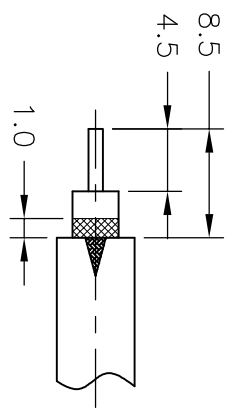

RECOMMENDED
STRIPPING DIMENSIONS

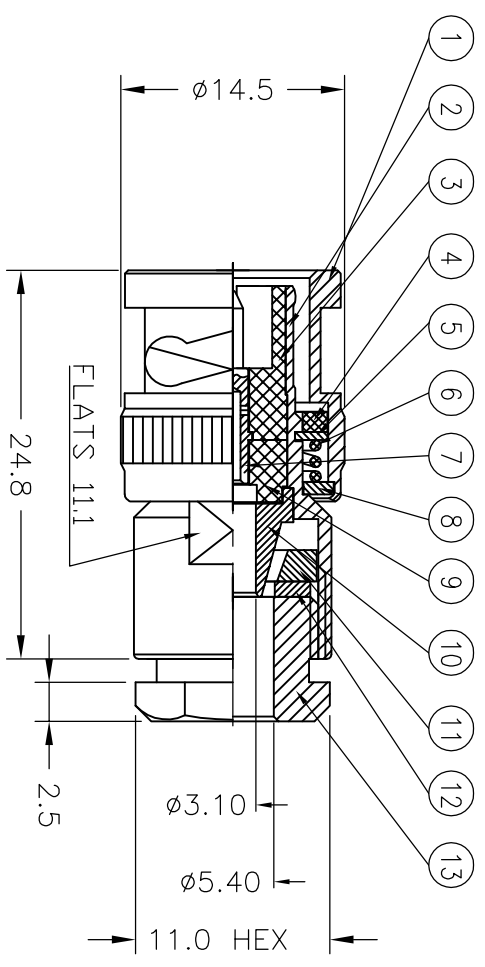

QTY	DESCRIPTION	MATERIAL	ITEM
1	NUT	BRASS	13
1	WASHER	BRASS	12
1	CLAMP	BRASS	11
1	SLEEVE	BRASS	10
1	INSULATOR II	PTFE	9
1	WASHER	BRASS	8
1	CENTER CONTACT	STEEL	7
1	SPRING	PHOS BRONZE	6
1	RING	SILICONE RUBBER	5
1	GASKET	PTFE	4
1	INSULATOR I	BRASS	3
1	BODY	BRASS	2
1	SHELL	BRASS	1
6--0	SHELL	BRASS	1
1--0	SHELL	BRASS	1

THIS DRAWING IS A CONTROLLED DOCUMENT.

DMN	21NOV2001	APVD	RG	PRODUCT SPEC	411-3274	WEIGHT	0
CHK	A-BEKEN	APVD	F W-KING	APPLICATION SPEC	411-3274		
	21NOV2001						

QUANTITY PER ASSY

PARTS LIST

STE TE Connectivity

BNC STRAIGHT PLUG SOLDER (PS) RG58
50 OHM

SIZE: A300779
PAGE CODE: C
DRAWING NO: 1478401

RESTRICTED TO

SCALE: 1:1 SHEET: 1 of 1 REV: C