



Datasheet

ENGLISH

# RS PRO 24 V dc, 200 mNm DC Geared Motor

RS Stock Number: 258-8316

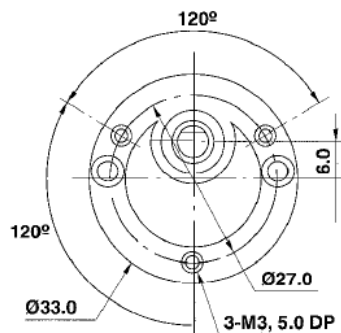
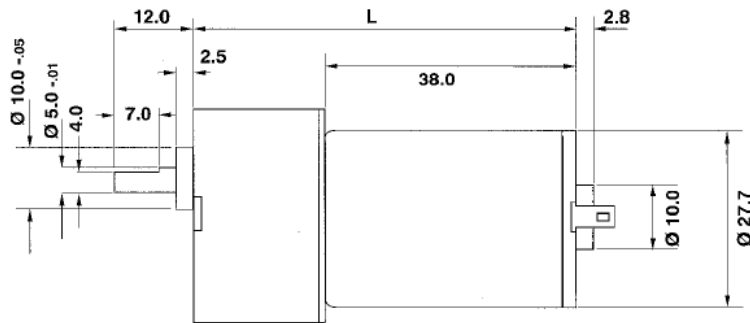
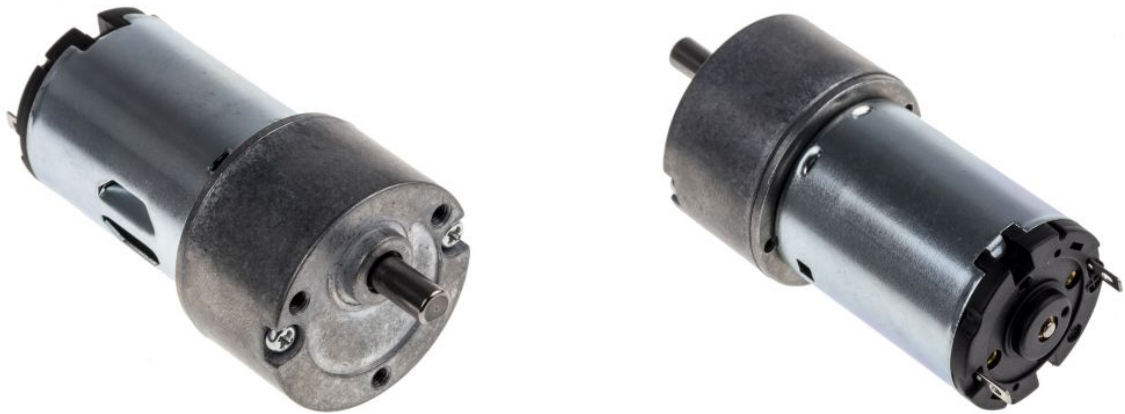

All dimensions in millimetres



ENGLISH

## Datasheet

# RS PRO 24 V dc, 200 mNm DC Geared Motor

## Description

The DC Geared motor is designed for low cost, high volume applications such as vending machines, magnetic card readers, printer mechanisms, actuators and all types of coin control systems.

Fitted with an all metal gearhead with sintered iron gears running on hardened steel shafts.

The output shaft runs in sintered bronze bearings.

## Features

Weight: 115 – 140 gms according to ration

Maximum radial load: 50N (8 mm from mounting face)

Maximum axial load: 33N (at shaft centre)

Maximum radial play: 0.08 mm

Maximum axial play: 0.50 mm

## Specifications

Article Number	Voltage (V)	Ratio	Output Rotation	Length (mm)	Maximum Torque (nMn)	Nominal No Load Speed (rev/min)	Nominal No Load Current (mA)
258-8316	24	50:1	CCW	57.8	200	75	30