

LED PIR FLOODLIGHT

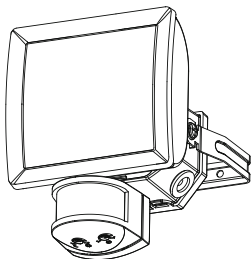

Model: LEDX10PIRB

Model: LEDX10PIRWH

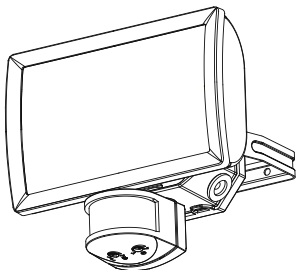

Model: LEDX20PIRB

Model: LEDX20PIRWH



Installation & Operating Instructions

1. Designated Use

- LEDX10PIR and LEDX20PIR are an outdoor motion detector for automatic LED lighting control.
- Mainly for wall installation.
- Simple plug in wall plate for easy & safe connection
- Suitable for a wide range of locations: corridors, gardens, staircases, entrances, garages, outdoor parking areas etc.



WARNING

2. Basic Safety Instruction

Danger of death through electric shock.

- Must only be installed by qualified electricians.
- Avoid the metal parts of the device due to potentially high temperature.
- Conforms to the latest EC directives.
- Designed for use in normal environments
- Intended for outdoor installation.
- Energy saving.
- Long LED lamp life time.



1

Index :

Page 2	Contents and Tools required
Page 3	Connection and Installation procedure
Page 4	Installation procedure
Page 5	Sensor detection range
Page 6	Walk test & adjustment, Detector head adjustment
Page 7	Setting advise and Knob settings
Page 8	Lens masking
Page 9	Manual Override Mode, Lamp adjustment and Warning
Page 10	Technical specifications

3. Contents:

What's in the box?

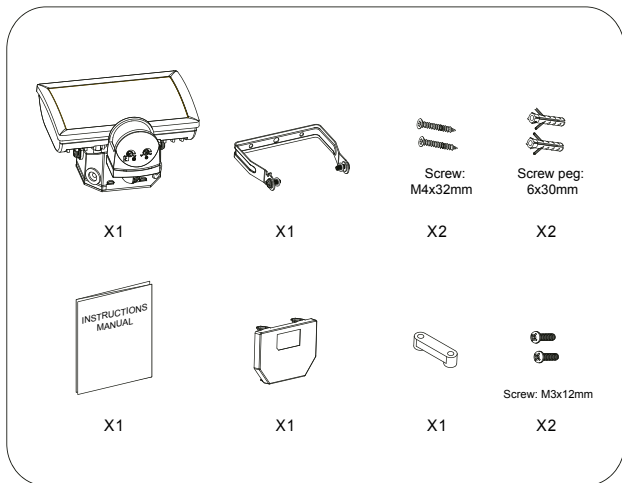

Product's weight

LEDX10PIR: 0.55kg, LEDX20PIR: 0.72kg

4. Tools required:

Tools / Equipment need for installation.

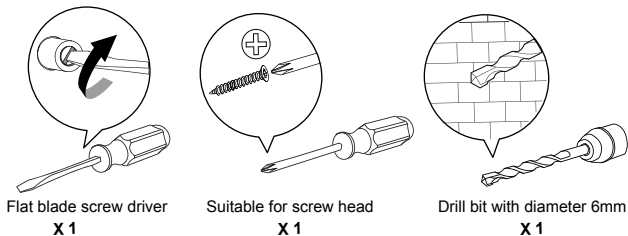

5. Connection:

Connect the cable to the terminal block as follows
(see connection diagram):

Ensure the connections are secure. Refit wall plate ensuring it clicks firmly into place.

L	LIVE	BROWN
N	NEUTRAL	BLUE
	EARTH	GREEN / YELLOW

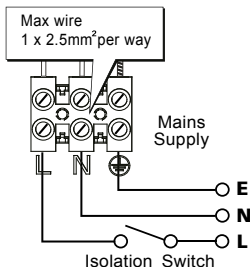

*** IMPORTANT ***

Switch off the electricity at the fuse box by removing the relevant fuse or switching off the circuit breaker before proceeding with the installation.

3

6. Installation Procedure:

- ① Switch off the power.
- ② Marking the screw hole.

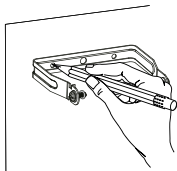
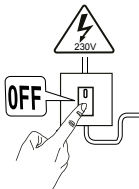

- ③ Drill and push the screw peg into the hole.
- ④ Fix the U bracket to the wall.

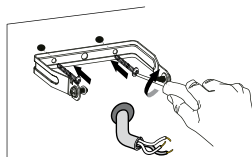
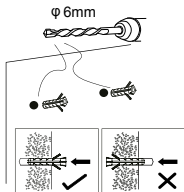

Mounting Screws: (M4 x 32mm) x 2

- ⑤ First, feed the cable through the rubber gasket of the junction box.

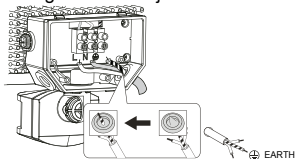

- ⑥ Attach the strain relief to the device and screw in.

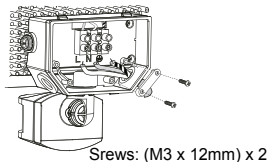

- ⑦ Tighten the screws.

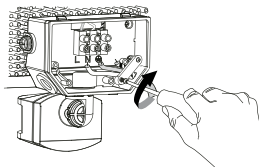

- ⑧ Loosen the screws.

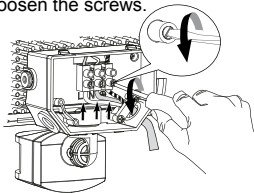

- ⑨ Connect the individual wires to the appropriate terminal then tighten the screw.

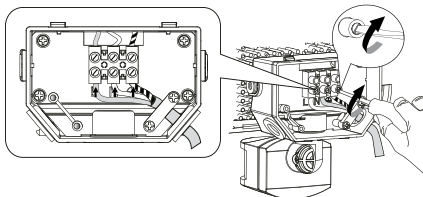

CONNECTION

(See connection diagram)
Connect the mains supply cable to the on the terminal block backplate as follows.

L	LIVE	BROWN
N	NEUTRAL	BLUE
⊕	EARTH	GREEN / YELLOW

- ⑩ Attach the wallplate to the device.

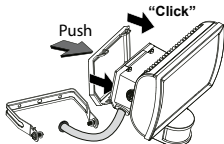

- ⑪ Attach the device to the U bracket then tighten the screws on both sides.

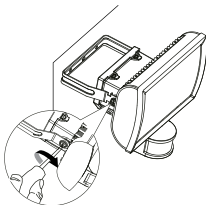

- ⑫ Connect device to the mains.
Unit goes into warm-up period for 40 sec.

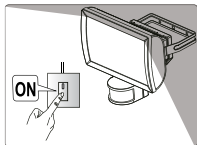

Installation Advise:



WARNING

As the detector reacts to variations in temperature, avoid situations:

- Do not direct motion detectors at objects with highly-reflective surface such as mirrors etc.
- Do not install motion detectors near heat sources such as heating outlets, air conditioning system, lamps etc.
- Do not direct the motion detector at objects that move in the wind such as curtains, large plants etc.
- Take account of motion direction during test run.

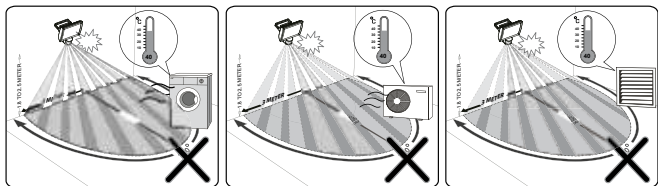

5

Detection Range:

LEDX10PIR and LEDX20PIR:

Recommended installation height is 2.5 meter above ground, the maximum detection range about 12 meter and at the angle of about 180 deg.

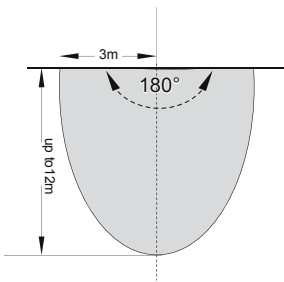
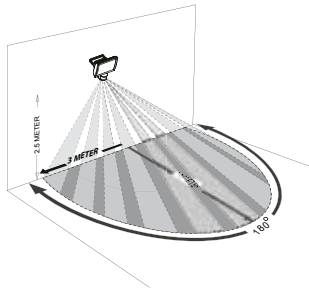

Walk Test and Adjustment

The purpose of Walk Test is used to test and adjust the detection coverage of LEDX10PIR and LEDX20PIR under auto mode.

- Adjust the Time knob to minimum (fully anti-clockwise), then conduct a walk test as described in test procedure.

Test procedure:

- Adjust the Time knob to (fully anti-clockwise), (Lux knob can be “Sun” or “Moon”).
- Switch power on.
- Walk across the detection area, once the detector is triggered the lamp will turn ON for 2 seconds.

Note walking direction when performing test.

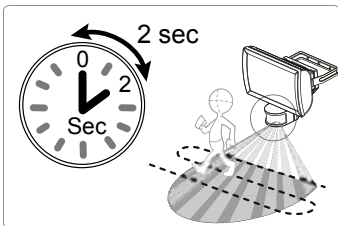
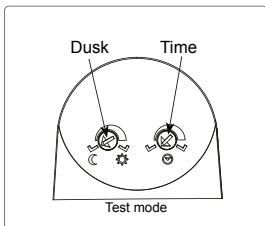

Detector Head Adjustment

The detector head can be 90° turned left or right by hand and can be tilted 90° downward .

- * Do not use the adjuster knobs to turn the detector head.

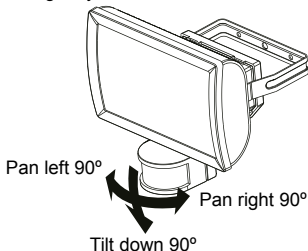

Knob Settings

LEDX10PIR or LEDX20PIR have two adjustment knobs:
Time and Lux at the bottom of the detector head.

- Adjust knobs carefully with flat blade screwdriver.

TIME knob setting

- You can set the time knob from 5 sec to about 10 min, LEDX10PIR or LEDX20PIR will turn ON the lamp, for the time duration set after each detected movement.
- Adjust the knob as desired.

LUX knob setting

- When setting the Lux knob at "MOON", LEDX10PIR or LEDX20PIR will only operate in the dark.
- When setting the Lux knob at "SUN", LEDX10PIR or LEDX20PIR will operate in any light level.

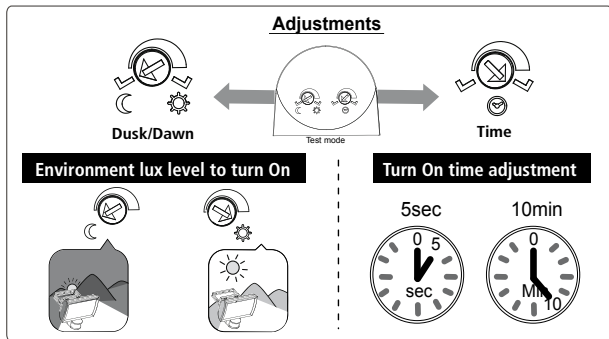

Dusk Setting (Time knob setting)

- When setting the Time knob to fully clock wise, the motion detector of LEDX10PIR or LEDX20PIR won't function.

The lamp will operate depending on the "LUX" level, ie Dusk to Dawn..

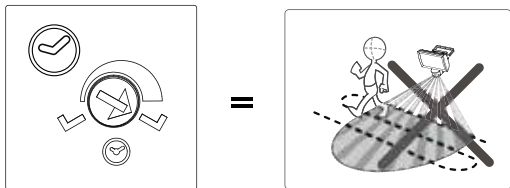



Lamp turns ON at night.



Lamp turns ON at day & night.



Setting Advise



WARNING

Lens masking



+



=

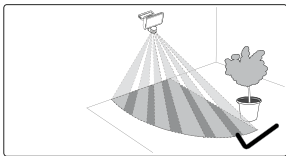
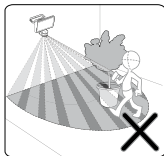
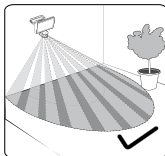
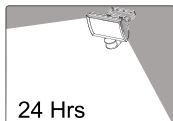

8

The purpose of the lens mask is to mask out areas not desired for detection.

Masking The Sensor Lens:

- To restrict the sensor coverage, preventing detection in unwanted areas, mask the sensor lens using the masking label provided. The top section of the lens covers long range detection, the bottom covers short range. Similarly the left and right lens sections cover the left and right detection areas respectively.

Lens Mask

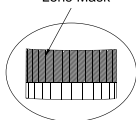

Restrict long detection

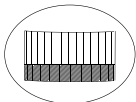

Restrict short detection

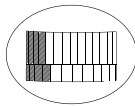

Restrict RHS detection

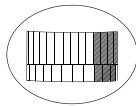

Restrict LHS detection

Manual Override Mode:

The light can be switched on for longer time periods by use of the Manual Override Mode.

This can be activated at night by using the internal wall switch or circuit breaker.

Switch the internal wall switch/circuit breaker single (OFF/ON) within 1.5 second.

The unit will now illuminate continuously until dawn or until switched back into Auto Mode.

To switch the unit back into Auto Mode, switch the internal wall switch/circuit breaker once (OFF/ON) within 1.5 second.

The unit will return to its Auto mode and will operate as set up after the walk test procedure.

Lamp Adjustment

The lamp can be tilted upward 45° and tilted down 60°.

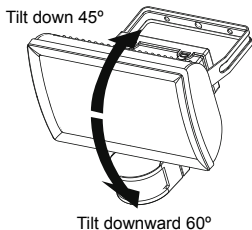

WARNING

This product will get warm when in normal use. Can be installed on surfaces of normal flammability e.g. wood, plasterboard, brickwork and other masonry. Do not install on flammable surfaces such as plastics.

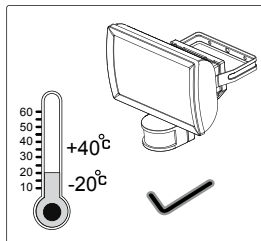

Technical specifications:

Energy Efficiency	Class A+
Energy Usage Lamp On	LEDX10PIR - 10kWh/1000h, 9.5W typ LEDX20PIR - 17kWh/1000h, 16.1W typ
Power Supply	230 V AC ~ 50Hz
Power Factor	> 0.95
Colour Temperature	5000 - 5600k
Colour Rendering	> 70
Lumen Output initial	LEDX10PIR - Black: 685 lm typ, White: 750 lm typ LEDX20PIR - Black: 1260 lm typ, White: 1325 lm typ
Detection Range	Up to 12 metres
Detection Angle	180°
Lamp Beam Angle	110 x 100 degrees
Time On Adjustment	The lamps are not replaceable in this product 5 seconds -10 minutes
Dusk Level Adjustment	Day & night or night only operation
Environmental Protection	IP55 (suitable for indoor and outdoor use)
EC Directives	Conforms to current EC Directives

10

If you experience problems refer to Troubleshooting Guide.
If problems still exist, do not immediately return the unit to store.
Telephone the Timeguard Customer Helpline

020 8450 0515

Qualified Customer Support Co-ordinators will be on-line to assist
in resolving your query.

3 Year Guarantee

In the unlikely event of this product becoming faulty due to defective material or manufacture within 3 years of the date of purchase, please return it to your supplier in the first year with proof of purchase and it will be replaced free of charge. For years 2 and 3 or any difficulty in the first year telephone the helpline on 020 8450 0515.

Note:

A proof of purchase is required in all cases. For all eligible replacements (where agreed by Timeguard) the customer is responsible for all shipping/postage charges outside of the UK. All shipping costs are to be paid in advance before a replacement is sent.



HELPLINE

020 8450 0515

or email helpline @ timeguard.com



For a product brochure please contact:

Timeguard Limited.

Victory Park, 400 Edgware Road,
London NW2 6ND

Sales Office: 020 8452 1112
or email csc @ timeguard.com

A **theben**[®] Group Company

67.058.502 (Iss.3)