



EMERGENCY-STOP MUSHROOM PUSHBUTTON,  
16MM, ROUND, PLASTIC, RED, LATCHING,  
ROTATE-TO-UNLATCH MECHANISM, 1NC,  
WITH YELLOW BACKING PLATE,  
INSCRIPTION EMERGENCY-STOP

**Actuato/ signaling device:**

<b>Design of the product</b>		Complete unit round with positive latching in accordance with ISO 13850
<b>Design of the operating mechanism</b>		Emergency stop mushroom pushbutton
<b>Functionality / of the actuator</b>		Latching
<b>Type of unlocking device</b>		rotate-to-unlatch mechanism
<b>Color / of the activation element</b>		Red
<b>Material / of the activation element</b>		plastic
<b>Number of switching positions</b>		2
<b>Product component / front ring</b>		No
<b>Product function / EMERGENCY STOP function</b>		Yes

**Holder:**

<b>Material / of the holder</b>		Plastic
---------------------------------	--	---------

**Contact block/ lampholder:**

<b>Design of the electrical connection</b>		tab terminals
<b>Number of switching elements</b>		1
<b>Number of NC contacts / for auxiliary contacts</b>		1
<b>Number of NO contacts / for auxiliary contacts</b>		0
<b>Number of changeover contacts / for auxiliary contacts</b>		0

<b>Product function / positive opening</b>		Yes
<b>Number of lampholders</b>		0
<b>Product extension / optional / fluorescent materials</b>		No

#### Accessories:

<b>Marking / of backing plate</b>		Yellow backing plate, inscription "NOT-HALT"
-----------------------------------	--	--

#### General technical details:

<b>Voltage type / of operating voltage</b>		AC/DC
<b>Operating voltage / rated value</b>		
• minimum	V	5
• maximum	V	250
<b>Operating current</b>		
• at AC-12		
• at 24 V / rated value	A	10
• at 60 V / rated value	A	10
• at 110 V / rated value	A	10
• at 230 V / rated value	A	10
• at AC-15		
• at 24 V / rated value	A	4
• at 60 V / rated value	A	4
• at 110 V / rated value	A	4
• at 230 V / rated value	A	4
• at DC-12		
• at 24 V / rated value	A	6
• at 60 V / rated value	A	5
• at 110 V / rated value	A	2.5
• at 230 V / rated value	A	1
• at DC-13		
• at 24 V / rated value	A	3
• at 60 V / rated value	A	1.2
• at 110 V / rated value	A	0.7
• at 230 V / rated value	A	0.3
<b>Resistance against shock / for devices without incandescent lamp / according to IEC 60068-2-27</b>		<= 50g
<b>Resistance against vibration / according to IEC 60068-2-6</b>		20 ... 200 Hz: 5g
<b>Operating cycles / maximum</b>	1/h	1,000
<b>Mechanical operating cycles as operating time / typical</b>		10,000,000
<b>Reference code</b>		
• according to DIN EN 61346-2		S

<ul style="list-style-type: none"> <li>according to DIN 40719 extended according to IEC 204-2 / according to IEC 750</li> </ul>		S
<b>Tightening torque / of the screws in the bracket / maximum</b>	N-m	0.4
<b>Ambient temperature</b>		
<ul style="list-style-type: none"> <li>during operating</li> </ul>	°C	-25 ... +70
<ul style="list-style-type: none"> <li>during storage</li> </ul>	°C	-40 ... +80
<b>Protection class IP</b>		IP65
<b>climatic class / during the operating phase / according to EN 60721</b>		3K6
<b>Mounting type</b>		front mounting
<b>Shape / of the installation hole</b>		round
<b>Installation width</b>	mm	28.5
<b>Mounting diameter</b>	mm	16
<b>Mounting height</b>	mm	21
<b>Mounting depth</b>	mm	50

#### Certificates/ approvals:

General Product Approval	Declaration of Conformity	Test Certificates
--------------------------	---------------------------	-------------------



[Special Test Certificate](#)

other

[Confirmation](#)

[other](#)

[Environmental Confirmations](#)

#### Further information:

**Information- and Downloadcenter (Catalogs, Brochures,...)**

<http://www.siemens.com/industrial-controls/catalogs>

**Industry Mall (Online ordering system)**

<http://www.siemens.com/industrial-controls/mall>

**Cax online generator**

<http://www.siemens.com/cax>

**Service&Support (Manuals, Certificates, Characteristics, FAQs,...)**

<http://support.automation.siemens.com/WW/view/en/3SB2203-1AC01/all>

**Image database (product images, 2D dimension drawings, 3D models, device circuit diagrams, ...)**

[http://www.automation.siemens.com/bilddb/cax\\_en.aspx?mlfb=3SB2203-1AC01](http://www.automation.siemens.com/bilddb/cax_en.aspx?mlfb=3SB2203-1AC01)

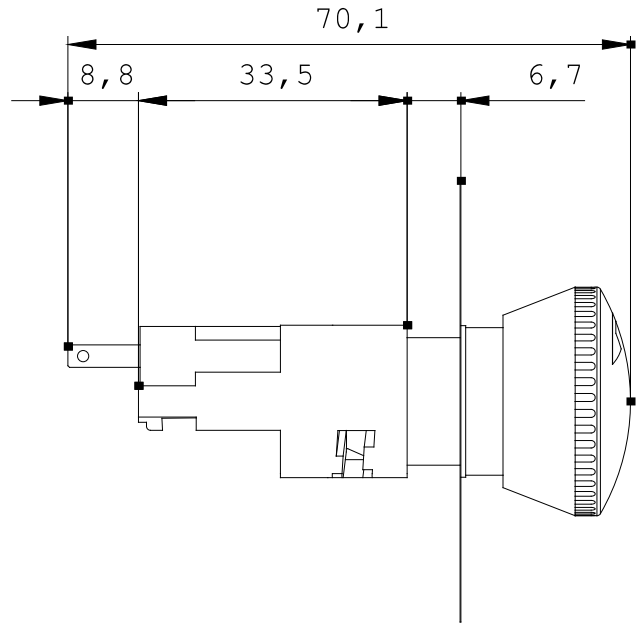
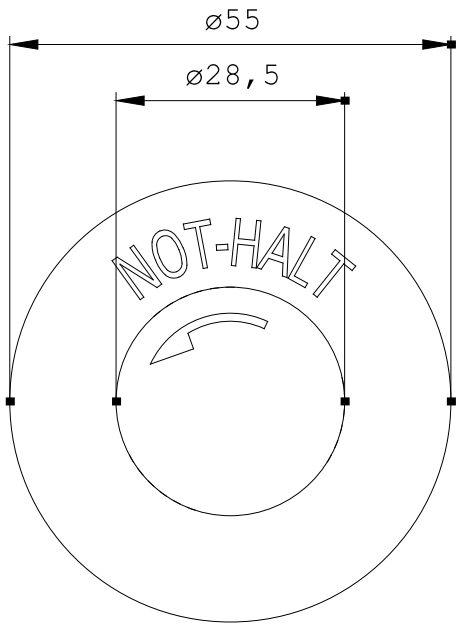

last change:

Jul 7, 2014