

Studded Circuit Board

SCBS/SCBSM/SCBS/MSCBSM

Natural

Top Hole: Snap-lock: 4 ± 0.08
Panel Thickness: 1.57

Type 1

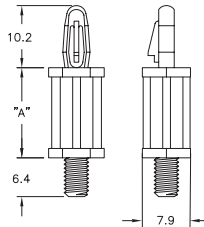

Top Hole: Snap-lock: 3.18 ± 0.05
Panel Thickness: 1.57

Type 2

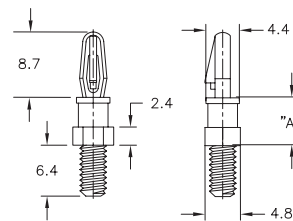

Thread: #6-32		Thread: #8-32		Thread: M3		Thread: M4		"A" Standoff Height	Std Pack Qty
SCBSM (Type 2)	SCBS (Type 1)	MSCBSM (Type 2)		MSCBS (Type 1)		MSCBSM (Type 2)			
UL94 V2 Nylon 6/6, RMS-01	UL94 V2 Nylon 6/6, RMS-01	UL94 V2 Nylon 6/6, RMS-01	UL94 V0 Nylon 6/6, RMS-19	UL94 V2 Nylon 6/6, RMS-01	UL94 V0 Nylon 6/6, RMS-19	UL94 V2 Nylon 6/6, RMS-01	UL94 V0 Nylon 6/6, RMS-01		
SCBSM-632-2-01	-	MSCBSM-M3-2-01	MSCBSM-M3-2-19	-	-	MSCBSM-M4-2-01	MSCBSM-M4-2-19	3.2	1000
SCBSM-632-3-01	-	MSCBSM-M3-3-01	MSCBSM-M3-3-19	-	-	MSCBSM-M4-3-01	MSCBSM-M4-3-19	4.8	1000
SCBSM-632-4-01	SCBS-4-01	MSCBSM-M3-4-01	MSCBSM-M3-4-19	MSCBS-4-01	MSCBS-4-19	MSCBSM-M4-4-01	MSCBSM-M4-4-19	6.4	1000
SCBSM-632-5-01	-	MSCBSM-M3-5-01	MSCBSM-M3-5-19	-	-	MSCBSM-M4-5-01	MSCBSM-M4-5-19	7.9	1000
SCBSM-632-6-01	SCBS-6-01	MSCBSM-M3-6-01	MSCBSM-M3-6-19	MSCBS-6-01	MSCBS-6-19	MSCBSM-M4-6-01	MSCBSM-M4-6-19	9.5	1000
SCBSM-632-7-01	-	MSCBSM-M3-7-01	MSCBSM-M3-7-19	-	-	MSCBSM-M4-7-01	MSCBSM-M4-7-19	11.1	1000
SCBSM-632-8-01	SCBS-8-01	MSCBSM-M3-8-01	MSCBSM-M3-8-19	MSCBS-8-01	MSCBS-8-19	MSCBSM-M4-8-01	MSCBSM-M4-8-19	12.7	1000
SCBSM-632-9-01	-	MSCBSM-M3-9-01	MSCBSM-M3-9-19	-	-	MSCBSM-M4-9-01	MSCBSM-M4-9-19	14.3	1000
SCBSM-632-10-01	SCBS-10-01	MSCBSM-M3-10-01	MSCBSM-M3-10-19	MSCBS-10-01	MSCBS-10-19	MSCBSM-M4-10-01	MSCBSM-M4-10-19	15.9	1000
-	SCBS-12-01	-	-	MSCBS-12-01	MSCBS-12-19	-	-	19.1	1000
-	SCBS-14-01	-	-	MSCBS-14-01	MSCBS-14-19	-	-	22.2	1000
-	SCBS-16-01	-	-	MSCBS-16-01	MSCBS-16-19	-	-	25.4	1000
-	SCBS-18-01	-	-	MSCBS-18-01	MSCBS-18-19	-	-	28.6	1000
-	SCBS-22.5-01	-	-	MSCBS-22.5-01	MSCBS-22.5-19	-	-	35.7	1000

Studded Circuit Board

TCBNS

Black, UL94 V2 Nylon 6/6, RMS-172

Top Hole: See Table
Panel Thickness: 1.6

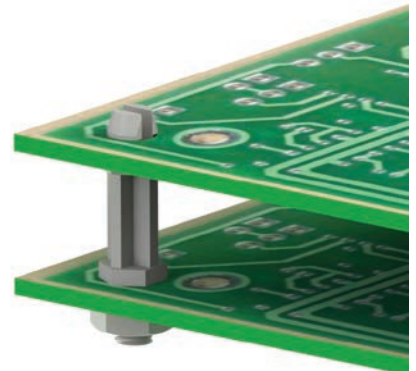
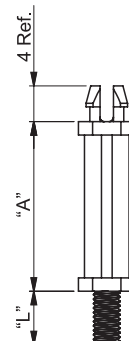

Part Number			"A" Standoff Height	Std Pack Qty
Top Hole: \emptyset 3 Thread: M2.5 "L" Thread Length: 6	Top Hole: \emptyset 3 Thread: M3 "L" Thread Length: 6	Top Hole: \emptyset 3.8 Thread: M4 "L" Thread Length: 8		
TCBNS-M2.5-3	TCBNS-M3-3	TCBNS-M4-3	3	1000
TCBNS-M2.5-5	TCBNS-M3-5	TCBNS-M4-5	5	1000
TCBNS-M2.5-6	TCBNS-M3-6	TCBNS-M4-6	6	1000
TCBNS-M2.5-8	TCBNS-M3-8	TCBNS-M4-8	8	1000
TCBNS-M2.5-10	TCBNS-M3-10	TCBNS-M4-10	10	1000
TCBNS-M2.5-12	TCBNS-M3-12	TCBNS-M4-12	12	1000
TCBNS-M2.5-15	TCBNS-M3-15	TCBNS-M4-15	15	1000
TCBNS-M2.5-20	TCBNS-M3-20	TCBNS-M4-20	20	1000