

**Ordering number C11713\_ANNA-40-5-S**

Family	Anna-40-5	FWHM	19 degrees
Type	Lens array	Efficiency	87 %
LED	LUXEON A	cd/lm	5.710
Color	Clear	Gerber File	Available
Diameter	40 mm		
Height	10.7 mm		
Style	Round		
Optic Material	PMMA		
Holder Material	-		
Fastening	Pin, glue		
Status	Ready		

**Ordering number C11714\_ANNA-40-5-M**

Family	Anna-40-5	FWHM	26 degrees
Type	Lens array	Efficiency	84 %
LED	LUXEON A	cd/lm	2.840
Color	Clear	Gerber File	Available
Diameter	40 mm		
Height	10.7 mm		
Style	Round		
Optic Material	PMMA		
Holder Material	-		
Fastening	Pin, glue		
Status	Ready		

**Ordering number C11715\_ANNA-40-5-W**

Family	Anna-40-5	FWHM	34 degrees
Type	Lens array	Efficiency	82 %
LED	LUXEON A	cd/lm	1.680
Color	Clear	Gerber File	Available
Diameter	40 mm		
Height	10.7 mm		
Style	Round		
Optic Material	PMMA		
Holder Material	-		
Fastening	Pin, glue		
Status	Ready		

**NOTE: The typical divergence will be changed by different color, chip size and chip position tolerance. The typical total divergence is the full angle measured where the luminous intensity is half of the peak value.**



**PRODUCT DATASHEET**  
**Anna-40-5 series**  
last update 4/6/2012

PHILIPS  
LUMILEDS

**GENERAL INFORMATION**

- Product series especially designed & optimized for LUXEON A series of LEDs.
- Special care taken to make light distribution as uniform as possible.
- Lens material optical grade PMMA with high UV and temperature resistance. Allows use of high current and temperature conditions.

Please find more information about used material from below:

[http://ledil.fi/sites/default/files/Documents/Technical/Material/PMMA%20N%20UL94\\_Yellow%20Card.pdf](http://ledil.fi/sites/default/files/Documents/Technical/Material/PMMA%20N%20UL94_Yellow%20Card.pdf)

<http://ledil.fi/sites/default/files/Documents/Technical/Material/PMMA%20N%20PLEXIGLAS-Datasheet.pdf>

D

C

B

A

4

4

3

3

2

2

1

1

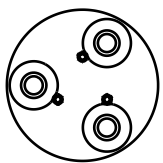

Anna-3

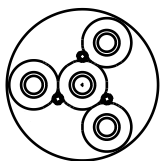

Anna-4

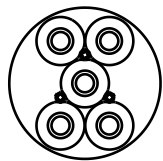

Anna-5

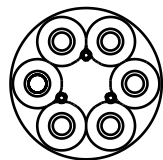

Anna-6

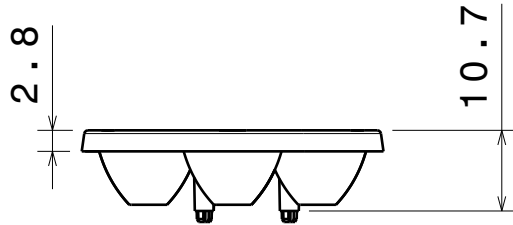

Anna-7

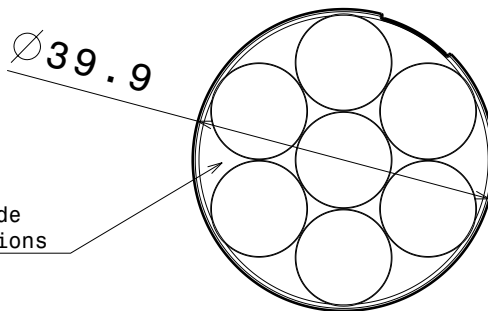

Same top side in all versions

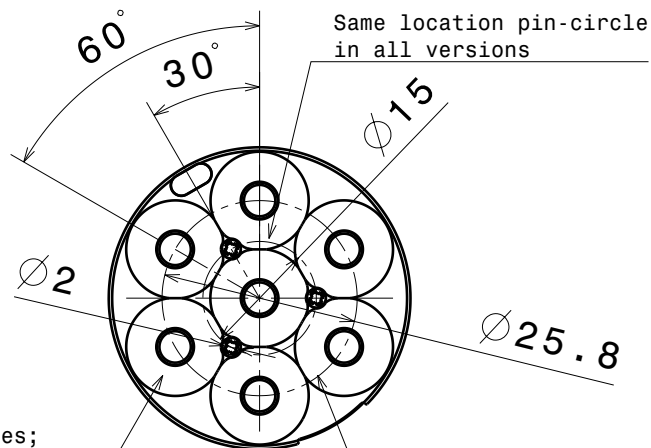
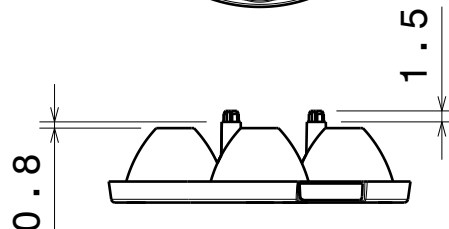

Same location pin-circle in all versions

Same led-circle in all versions

Number of cones varies; 3, 4, 5, 6 and 7pcs on bottom side depending the version.

Material: PMMA

Versions:

- Anna-3-S
- Anna-3-M
- Anna-3-W
- Anna-4-S
- Anna-4-M
- Anna-4-W
- Anna-5-S
- Anna-5-M
- Anna-5-W
- Anna-6-S
- Anna-6-M
- Anna-6-W
- Anna-7-S
- Anna-7-M
- Anna-7-M2
- Anna-7-W

This drawing is our property. It can't be reproduced or communicated without our written agreement.



Ledil Oy  
Salorankau 10  
FIN-24100 SALO  
Finland

DRAWING TITLE

Datasheet Anna40-series Lens

DRAWN BY  
ah

DATE  
8.12.2011

CHECKED BY  
pv

DATE  
8.12.2011

SIZE  
A4

DRAWING NUMBER  
Anna-40

REV  
4

DESIGNED BY  
hh

DATE  
30.07.2010

SCALE 1:1 WEIGHT (g)

SHEET 1/1

D

A