

IIW201

IIK3022-BPKG/M/K1/SC/US104-DPS

Inductive sensors

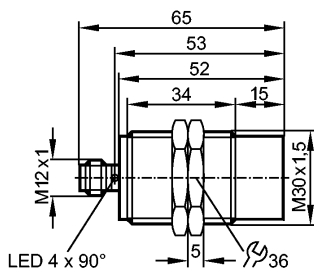

Made in Germany



Product characteristics

Inductive sensor
Metal thread M30 x 1.5
Connector
Electromagnetic-field immune
Increased sensing range
Gold-plated contacts
Correction factor = 1
Sensing range 22 mm; [nf] non-flush mountable

Electrical data

Electrical design	DC PNP
Operating voltage [V]	10...30 DC; "supply class 2" to cULus.
Current consumption [mA]	< 20
Protection class	II
Reverse polarity protection	yes

Outputs

Output function	normally open
Voltage drop [V]	< 2.5
Current rating [mA]	200
Short-circuit protection	pulsed
Overload protection	yes
Switching frequency [Hz]	1000

Range

Sensing range [mm]	22
Real sensing range (Sr) [mm]	22 ± 10 %
Operating distance [mm]	0...17.6

Accuracy / deviations

Correction factors	mild steel = 1 / stainless steel approx. 1 / brass approx. 1 / aluminium approx. 1 / copper approx. 1
Hysteresis [% of Sr]	3...15
Switch-point drift [% of Sr]	-10...10

Environment

Ambient temperature [°C]	-25...70
Protection	IP 67

Tests / approvals

EMC	EN 61000-4-2 ESD: 4 kV CD / 8 kV AD EN 61000-4-3 HF radiated: 10 V/m (80...1000 MHz)
-----	---

IIW201

IIK3022-BPKG/M/K1/SC/US104-DPS

Inductive sensors

	EN 61000-4-4 Burst:	2 kV
	EN 61000-4-6 HF conducted:	10 V (0.15...80 MHz)
	EN 55011:	class B
MTTF	[Years]	1915

Mechanical data

Mounting	non-flush mountable
Housing materials	housing: Brass safe-coated; active face: Duroplast (PF)
Weight	[kg] 0.117

Displays / operating elements

Output status indication	LED	yellow (4 x 90°)
--------------------------	-----	------------------

Electrical connection

Connection	M12 connector; Gold-plated contacts
------------	-------------------------------------

Wiring

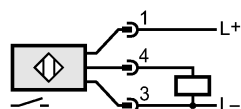

Accessories

Accessories (included)	2 lock nuts
------------------------	-------------

Remarks

Pack quantity	[piece]	1
---------------	---------	---