

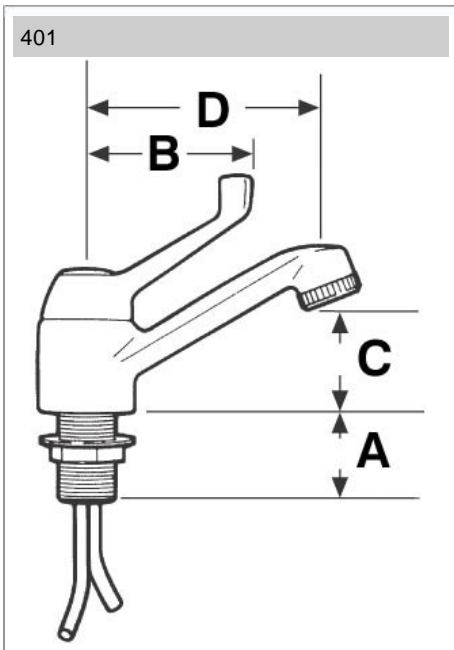

Monobloc Basin Mixer, spray outlet with maximum temperature limit



Size	Pattern No.	Pack 1 Qty	Pack 2 Qty	Code	Barcode	Price (£) ex VAT
1/2	401	1	0	319007	5013866005121	£324.89



Code	Description	A	B	C	D
319007	401 CP PEGLESPRAY MONO BASIN MIXER	41	78	52	117

Pegler Yorkshire reserve the right to change specifications

5 Year Guarantee

Luxury Taps and Mixers

Pegler Yorkshire Customcare 5 Year Guarantee - Terms and Conditions

Product are subject to a 5 year guarantee that is between Pegler Yorkshire and the final purchaser of the product.

The guarantee is subject to proof of purchase being supplied.

This guarantee does not affect any statutory rights the consumer may have in law.

The guarantee covers manufacturing or material defects and does not cover parts subject to normal wear and tear.

Finishes other than chrome are covered for a period of 3 years only and the guarantee on the finish is subject to the cleaning instructions being followed.

The guarantee is not applicable where the product is fitted contrary to the conditions in the fitting instructions.

Abusive behaviour and accidental damage to the product are not covered by this guarantee.

The extent of this liability is limited to the cost of the replacement of the defective item and not to fitting or consequential damages.

Description	Minimum Operating Pressure (bar)	Maximum Cold Working Pressure (bar)	Maximum Hot Working Pressure (bar)
401 Monobloc Basin	0.2 bar	10.0 bar at temperatures up to	Not Suitable for Maximum Hot Working

Care

To maintain the surface finish, simply wipe occasionally with a mild detergent on a soft damp cloth. Dry, using a soft cloth. Never use abrasive cleaners or chemical household cleaners and avoid contact with concentrated bleach.

Maintenance

No regular maintenance is required for this product.

In case of complete replacement Pegler recommend service valves should be fitted to the supply inlets.

For any further help or replacement parts please contact the Service Support Team on 0800 1560050.

Regulations

It is important to ensure that the water supplies to your taps and mixers are connected in accordance with the water regulations (WRAS) requirements and good plumbing practice.

It is Pegler's recommendation and good plumbing practice that the supplies of hot and cold water to the mixer should be at equal (balanced) pressures in order to provide a consistent flow. Supplies should be from a common source, either mains or tank fed. If supplies are not equal pressures then non return valves should be fitted.

401

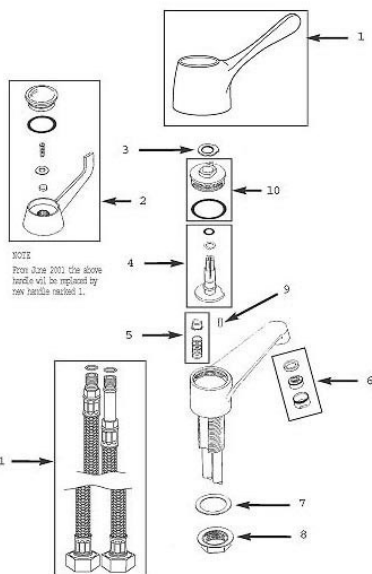

1						
Spare Key	Description	Code	Barcode	Date From	Date To	Price (£) ex VAT
1	HD44CP LEVER HANDLE CHROME	850874	5013866062858	01/06/2001	To Current	£70.73
2						
Spare Key	Description	Code	Barcode	Date From	Date To	Price (£) ex VAT
2	HD29CP LEVER HANDLE FOR PEGLERSPRAY	817134	5013866058608	01/01/1990	31/05/2001	£60.93
3						
Spare Key	Description	Code	Barcode	Date From	Date To	Price (£) ex VAT
3	TLP 1 TEMPERTATURE LIMIT PLATE	817136	5013866058622	01/01/1900	To Current	£4.91
4						
Spare Key	Description	Code	Barcode	Date From	Date To	Price (£) ex VAT
4	SOR3 SPINDLE & O RING SET	817131	5013866058585	01/01/1900	To Current	£26.22
5						
Spare Key	Description	Code	Barcode	Date From	Date To	Price (£) ex VAT
5	SSP1 SEAL & SPRING SET	817132	5013866058592	01/01/1900	To Current	£7.93
6						
Spare Key	Description	Code	Barcode	Date From	Date To	Price (£) ex VAT
6	FS40CP FLOW STRAIGHTNER ASSEMBLY CHROME	811588	5013866054990	01/01/1900	To Current	£21.41
7						
Spare Key	Description	Code	Barcode	Date From	Date To	Price (£) ex VAT
7	ARW9 ANTI ROTATIONAL WASHER	811499	5013866054396	01/01/1900	To Current	£1.84
8						
Spare Key	Description	Code	Barcode	Date From	Date To	Price (£) ex VAT
8	3/4 BN 915 BACKNUT	817072	5013866023361	01/01/1900	To Current	£3.01
9						
Spare Key	Description	Code	Barcode	Date From	Date To	Price (£) ex VAT
9	CSP1 CARTRIDGE SECURING PIN	817135	5013866058615	01/01/1900	To Current	£1.24
10						
Spare Key	Description	Code	Barcode	Date From	Date To	Price (£) ex VAT
10	LN41 HEADWORK RETAINING NUT	850723	5013866061912	01/01/1900	To Current	£6.34
11						

Spare Key	Description	Code	Barcode	Date From	Date To	Price (£) ex VAT
11	FCF2 FLEXIBLE TAILS PAIR	850873	5013866062841	01/01/1900	To Current	£15.45

Pegler Yorkshire Group Ltd, St Catherine's Ave, Doncaster, S Yorkshire, DN4 8DF
Telephone: Phone +44 (0) 844 243 4400 Fax: +44 (0) 844 243 9870 Website: www.pegleryorkshire.co.uk
Registered office : Pegler Yorkshire Group Ltd, St Catherine's Ave, Doncaster, S Yorkshire, DN4 8DF Company no : 00401507

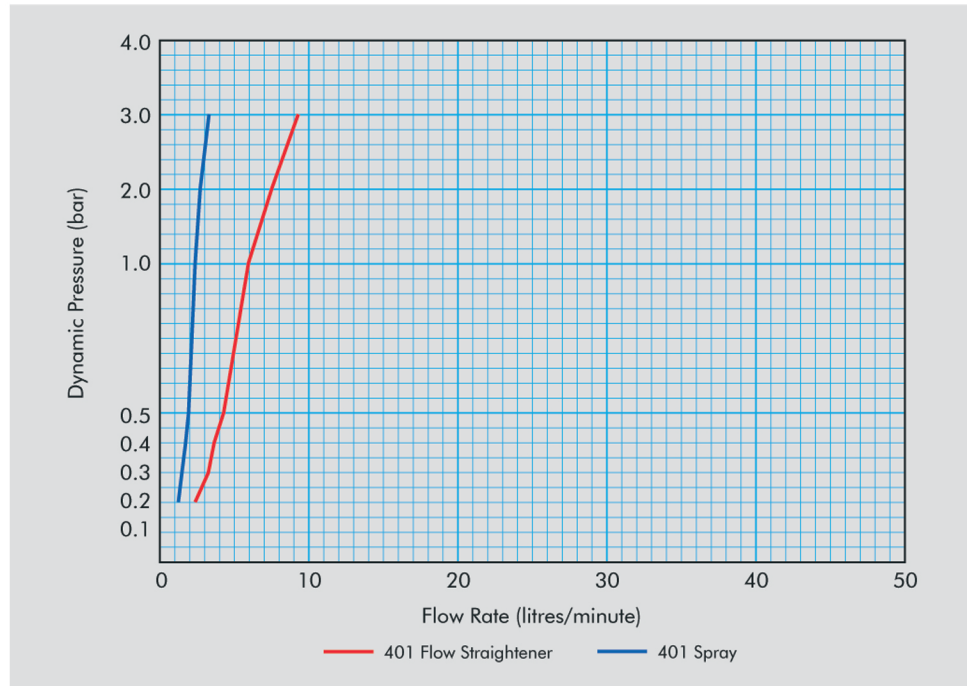
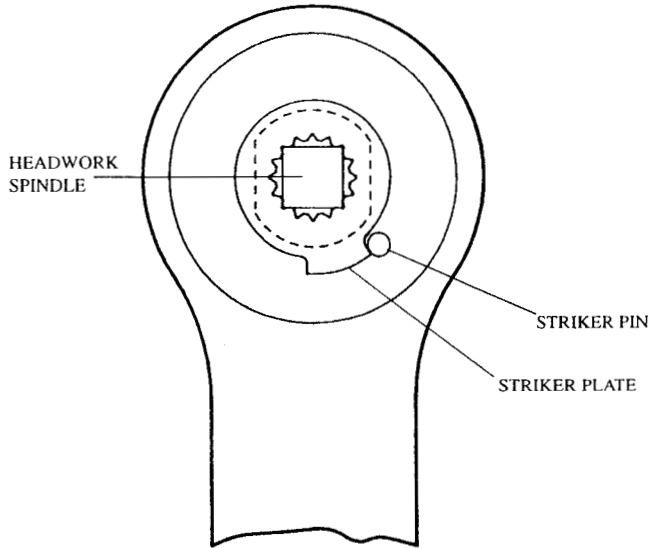

DIAGRAM (A)



PRODUCT CODE: 889067

Pegler Limited, St. Catherine's Avenue, Doncaster DN4 8DF.
Telephone: 01302 368581 Fax: 01302 367661

YOUR GUIDE TO THE INSTALLATION, CARE AND MAINTENANCE OF THE PEGLERSPRAY

*Lever Operated Monobloc
Basin Mixer Spray Tap*

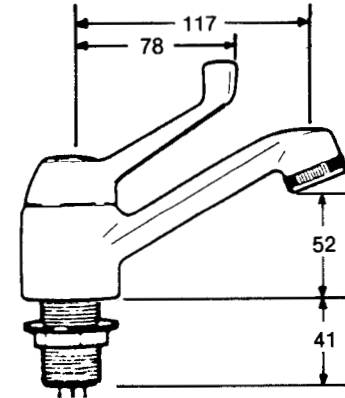

(Pattern 401)

PEGLER
A WATERTIGHT GUARANTEE OF QUALITY

INSTALLATION

1. Hot and cold water supplies must be from storage tank or balanced pressures in order to satisfy Water Byelaw requirements.
2. Available head of water shall be not less than two metres, measured from spray outlet to the bottom of the cold water cistern.
3. Hot and cold water marking on the inlet pipes should be observed. Make sure that the hot water inlet supply pipe is connected to the correct inlet of the fitting (as marked on the left hand side when facing mixer).
4. A flow regulator is incorporated in the spray head and this can be adjusted to provide the desired rate of flow at the water pressure available. To adjust the rate of flow, unscrew the knurled spray head. The adjusting screw can then be seen in the centre of the spray head and can be set by means of a screwdriver. The best setting will be found by a process of trial and error.
5. At inlet pressures below three metres head it is recommended that the adjusting screw be removed completely in order to obtain the maximum possible flow.
An alternative flow straightener is provided with the fitting which can be used at pressures above 5 metres (0.5 bar) head of water. This allows the fitting to be used for basin filling purposes as opposed to handrinse only. To fit the flow straightener proceed as follows.
 - i. Unscrew the knurled spray head complete with spray plate and flow adjuster.
 - ii. Place sealing washer provided into outlet and screw alternative flow straightener and casing into outlet.

MAXIMUM OUTLET TEMPERATURE SETTING

This mixer is provided with a maximum outlet temperature device which allows the outlet temperature from the mixer to be limited to a temperature below that of the system hot water temperature. This is a mechanical device which is dependant upon the available temperatures and pressures of the supply system. It is useful in installations where the system hot water temperature

has to be maintained at 60° C plus in order to reduce the risk of Legionella Bacteria being present within the hot water supply system. To set the maximum hot outlet temperature proceed as follows

- i. Install mixer as described above.
- ii. Move lever until the desired maximum hot outlet temperature is reached.
- iii. Remove indicator disk from lever handle and remove lever handle.
- iv. Place striker plate on headwork spindle so that it is in contact with the striker pin on the headwork - see diagram A. (Reverse side)

Note - If plate fouls the pin and you are unable to fully push down the striker pin remove striker plate and invert, then place back on to spindle. Fine adjustment is available with either side of the plate as the notches are in slightly different positions on the opposite sides of the plate.

- v. Re-assemble lever handle and indicator disk.

CARE AND MAINTENANCE

In hard water areas it may occasionally be necessary to remove lime deposits from the spray head. This is readily done by unscrewing the spray disk retaining screw and cleaning the grooves in the three plastic disks with a small brush.

No other regular maintenance is required. Should it become necessary, after a long period of service, to renew the spindle seal or the two spring-loaded seats, access to these can be obtained by removing the handle (retaining screw under indicator disk) and unscrewing the head.

Replacement seals can be obtained from the manufacturers. (Pegler Ltd, St Catherines Ave, Doncaster, DN4 8DF. Tel. 0302 368581).

To maintain the surfaces finish simply wipe occasionally with a mild detergent on a soft damp cloth. Dry using a soft cloth, never use abrasive cleaners or chemical household cleansers. Avoid contact with concentrated bleach. For any spare parts requirements please contact the Pegler Sales office.