

tyco / *Electronics*

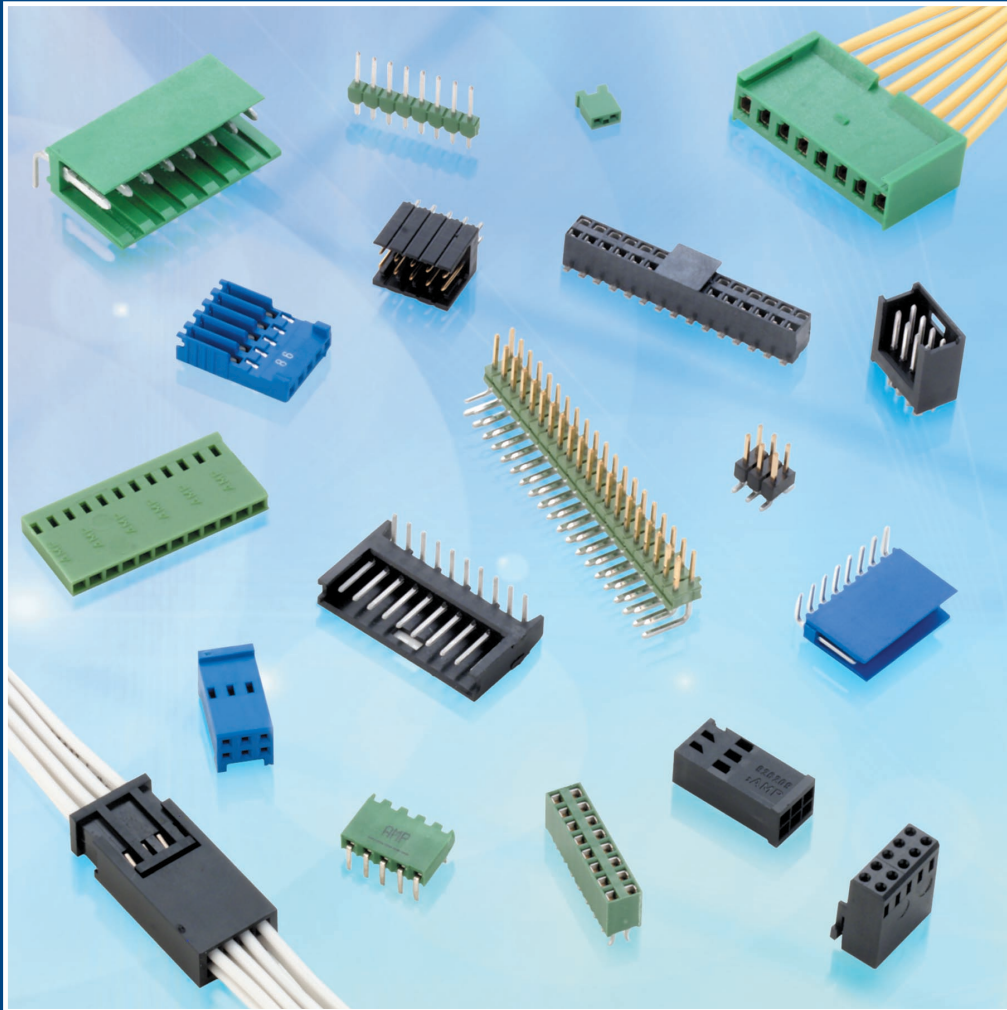

AMPMODU Interconnection System

European Standard Products

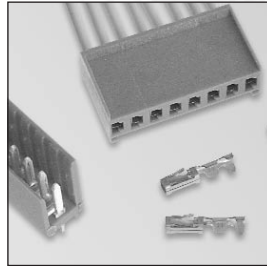

3.96mm [.156"] Centerline Interconnection System

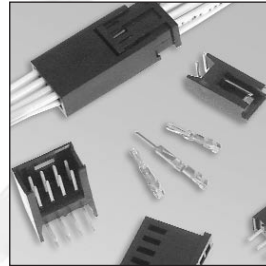

2.54mm [.100"] Centerline Interconnection System Italian Range

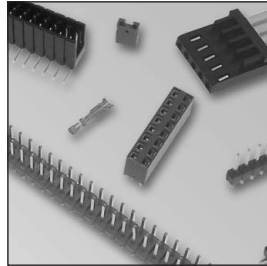

2.54mm [.100"] Centerline Interconnection System

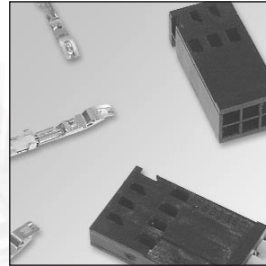

Locking Clip Connectors

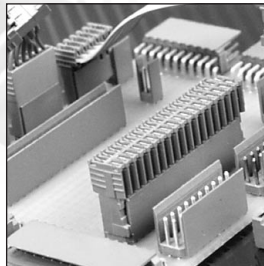

HE 13 / HE 14 - 2.54mm [.100"] Centerline Interconnection System

Contents

AMPMODU 3.96mm [.156"] Centerline Interconnection System

MOD I Receptacle Housings and Crimp Contacts6
 MOD I PCB Receptacle Contacts7
 MOD I Shrouded Headers8
 MOD I Unshrouded Headers9
 MOD I Shunt Connectors9

AMPMODU 2.54mm [.100"] Centerline Interconnection System - Italian Range

MOD II Receptacle Housings12
 MOD II Pin Housings.....13
 MOD II Pin and Receptacle Crimp Contacts.....14
 MOD II PCB Receptacles15-16
 MOD II Shrouded Headers17-18

AMPMODU 2.54mm [.100"] Centerline Interconnection System

MOD II Breakaway Pin Headers20-25
 HV-100 / HV-190 PCB Receptacles26-31
 MOD II Shrouded Headers32-33
 MOD IV Receptacle Housings and Accessories34-36
 MOD IV / V Receptacle Crimp Contacts37
 MOD II PCB Receptacle Contacts38
 MOD IV Shunt Connectors38

AMPMODU Locking Clip Connectors

Locking Clip Receptacle Housings and Contacts40-42

HE 13 / HE 14 - 2.54mm [.100"] Centerline Interconnection System

IDC Receptacle Assemblies44-45
 Shrouded Headers46-47
 Receptacle Housings48
 Receptacle Crimp Contacts49

Part Number Index50

Engineering Notes



Product Facts

- Rugged connector system featuring 0.79 x 1.57mm (.031" x .062") posts with mating receptacles
- Current rating 5 amps max per contact. Varies due to ambient temperature, wire size and duty cycles
- Available for board-to-board and wire-to-board applications
- Contacts available in both tin and gold plating
- Flame retardant thermoplastic housings UL 94V-1 rated
- Shrouded pin headers are polarised and detented

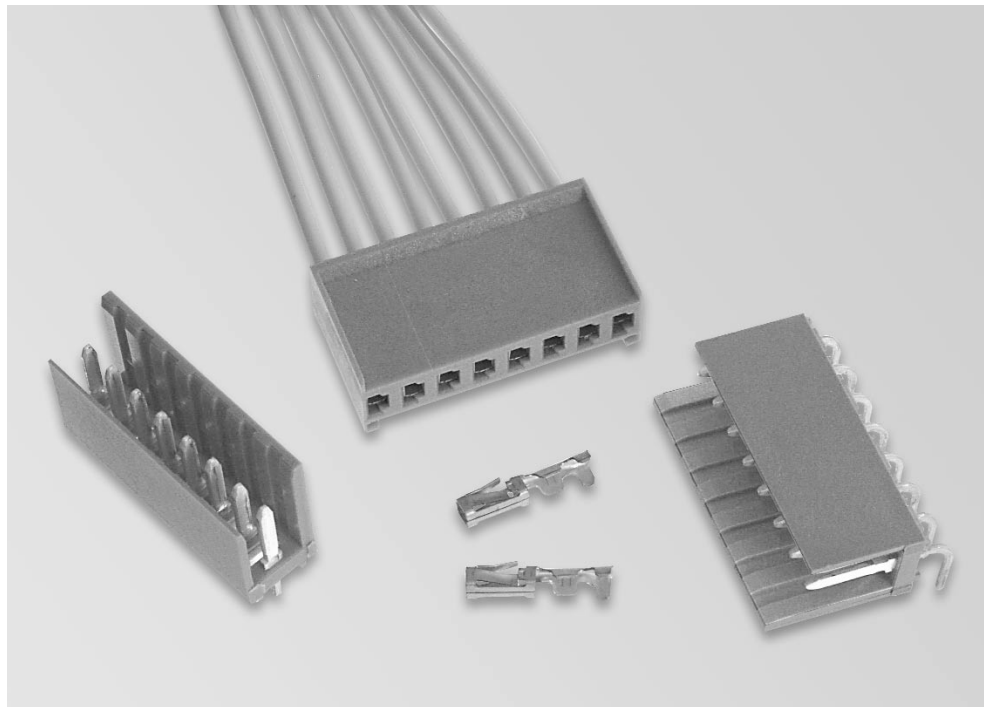

Performance Specifications:

Contact Current Rating—5 A max

Operating temperature—
-40°C to +105°C

Engaging Force

2.5 N per contact max
(standard pressure contacts)

Separating Force

0.5 N per contact min
(standard pressure contacts)

Durability

(Standard Pressure Contacts)

0.4 µm gold— 100 cycles

0.8 µm tin— 10 cycles

Contact Resistance—15 mΩ max

Insulation Resistance—
5000 MΩ min

The 0.79 x 1.57mm (.031" x .062") interconnection system has been an industry standard for modular packaging for over 30 years. It is a rugged large scale system for board to board and wire to board connection in applications such as power supplies, industrial control and switchgear.

MOD I Receptacles

Cable mounted receptacle housings accept crimp contacts with a wire size range from 17-22AWG (0.32-1.00mm²) and with a variety of plating options. Contacts are available in both reeled and loose piece format to suit different manufacturing requirements and volumes. Unhoused pcb receptacle contacts provide a simple board to board solution with MOD I unshrouded headers.

MOD I Headers

Pcb mount headers are provided in both shrouded and unshrouded versions. Shrouded headers are available in both straight and right angle variants with in-built polarisation when used with MOD I cable mount receptacles. Unshrouded pcb headers are offered for straight pcb mounting. Tin or gold plated contacts are available for both styles.

MOD I Shunt Connectors

The shunt connector is the easiest form of programming, allowing simple and flexible electrical connection. Supplied in strips they can be broken off as required. The open top design allows the use of a test probe while located in-circuit.

MOD I Receptacle Housings

Single Row

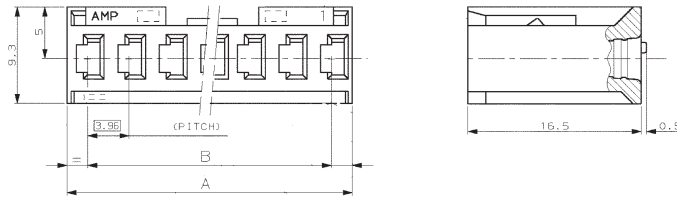
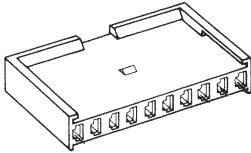

Material and Finish:

Housing—Green glass fibre filled polycarbonate, UL 94V-1 rated

Technical Documents:

Product Specification
108-20026

Application Specification
114-20040

No. of Positions	Dimensions		Part Numbers
	A	B	
2	7.8	3.96	280590
4	15.7	11.89	280591
6	23.7	19.81	280592
8	31.6	27.74	280593
10	39.5	35.66	280594
12	47.4	43.59	280595

Keying Plug Part Number 87116-2

(Plugs directly into Housing)



MOD I Crimp Snap-In Receptacle Contacts, with Insulation Support

Material and Finish:

Phosphor bronze, plated as follows:

Plating A—Selectively plated 0.8 µm gold on contact area, with gold flash over 1.27 µm nickel on entire contact

Plating B—Selectively plated 0.4 µm gold on contact area with gold flash over 1.27 µm nickel on entire contact

Plating C—Pre-tin plated 0.8 µm

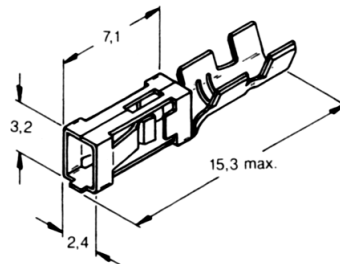

Related Product Data:

Application Tooling
Extraction Tool: 843473-1

Technical Documents:

Product Specification
108-20026

Application Specification
114-20040

Wire Size Range mm ²	AWG	Insulation Diameter mm	Plating	Part Numbers		Hand Tool
				Strip Form	Loose Piece	
0.32-0.80	22-18	1.80-2.30	Plating B	280621-2	181299-2	1285002-1
			Plating C	280621-1	181299-1	
			Plating A	280621-6	181299-6	
			Plating C	280702-1*	182198-1*	
0.5 -1.0	20-17	2.20-2.80	Plating C	281423-1*	-	

* With high contact pressure

MOD I PCB Mount Receptacle Contacts

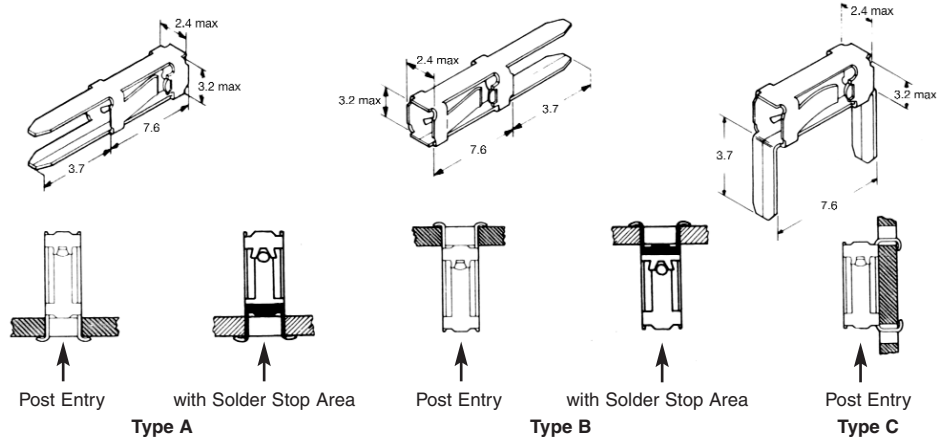

Material and Finish:

Phosphor Bronze
For Plating, see table

Technical Documents:

Application Specification
114-25004

Part Numbers							Finish (Contact Zone)
Type A		Type B		Type C			
On Reel	Loose Piece	On Reel	Loose Piece	On Reel	Loose Piece		
141002-1	141007-2	141003-2	141008-2	141004-2	141009-2	Galvanised tin plated	
142165-1	—	142166-1	142166-2	—	—	Tin plated with Solder Stop Area	
141002-4	141007-4	141003-4	141008-4	141004-4	141009-4	0.8µm Au over 1.3µm Ni	
141584-2	141588-2	141585-2	141589-2	141586-2	141590-2	Duplex 0.8µm Au over 1.3µm Ni*	

* In the duplex gold plated version, the rest of the receptacle is nickel plated, the solder tabs are tin plated

Keying Plug
Part Number 86181-2

(Plugs directly into Housing)



MOD I Shrouded Headers

Straight Shrouded Header

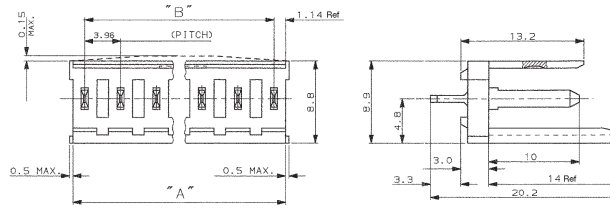
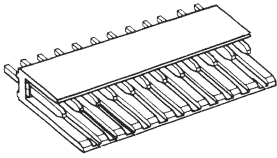

Material and Finish:

Housing—Green glass fibre filled polycarbonate, UL 94V-1 rated

Posts—Brass (gold plating) or phosphor bronze (tin plating). Plating details as follows:

Plating A—Gold 0.4 µm on contact area, tin on solder area, with entire post underplated 1.3 µm nickel

Plating B—Tin 3.8 µm min

No. of Positions	Dimensions		Part Numbers	
	A	B	Plating B	Plating A
2	6.2	3.96	280609-1	280609-2
4	14.2	11.89	280610-1	280610-2
6	22.1	19.81	280611-1	280611-2
8	30.0	27.74	280612-1	280612-2
10	37.9	35.66	280613-1	280613-2
12	45.9	43.59	280614-1	280614-2

Technical Documents:

Product Specification
108-20026

Right-Angle Shrouded Header

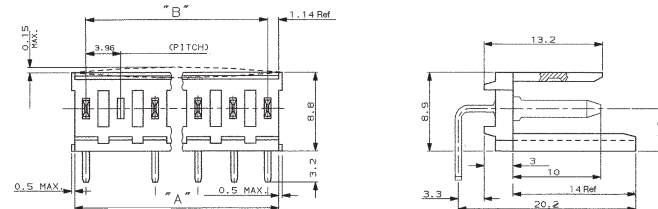
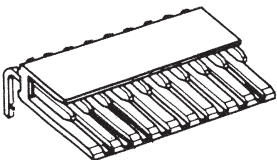

Material and Finish:

Housing—Green glass fibre filled polycarbonate, UL 94V-1 rated

Posts—Brass (gold plating) or phosphor bronze (tin plating). Plating details as follows:

Plating A—Gold 0.4 µm on contact area, tin on solder area, with entire post underplated 1.3 µm nickel

Plating B—Tin 3.8 µm min

No. of Positions	Dimensions		Part Numbers	
	A	B	Plating B	Plating A
2	6.2	3.96	280615-1	280615-2
4	14.2	11.89	280616-1	280616-2
6	22.1	19.81	280617-1	280617-2
8	30.0	27.74	280618-1	280618-2
10	37.9	35.66	280619-1	280619-2
12	45.9	43.59	280620-1	280620-2

Technical Documents:

Product Specification
108-20026

MOD I Unshrouded Headers

Straight Unshrouded Header

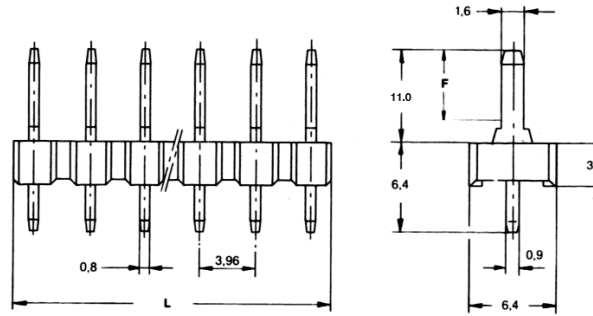
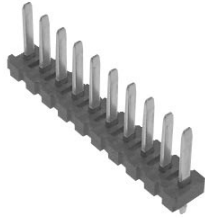

Material and Finish:

Housing—Thermoplastic polyester, green UL94V-0 rated

Posts—Brass

Plating A—0.8 µm gold on contact area (F), tin on solder area, with entire post underplated 1.3µm nickel

Plating B—Tin plated 2.5 µm min tin over 1.3 µm nickel

Technical Documents:

Product Specification
108-20026

No. of Positions	Dimension L	Part Numbers	
		Plating B	Plating A (F=7.0)
2	7.3	826576-2	826539-2
3	11.3	826576-3	826539-3
4	15.2	826576-4	826539-4
5	19.2	826576-5	826539-5
6	23.1	826576-6	826539-6
7	27.1	826576-7	826539-7
8	31.1	826576-8	826539-8
9	35.1	826576-9	826539-9
10	39.0	1-826576-0	1-826539-0
20	78.6	2-826576-0	2-826539-0
36	141.6	3-826576-6	3-826539-6

Ordering Information: For intermediate number of positions, please combine dash numbers

MOD I Shunt Connector

Shunt Connectors

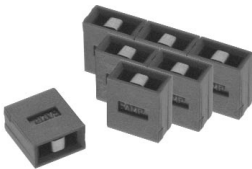

Material and Finish:

Housing—Polyamide 6.6, green UL94-HB rated

Contact Material—Phosphor Bronze

Plating—Tin 2.0µm min

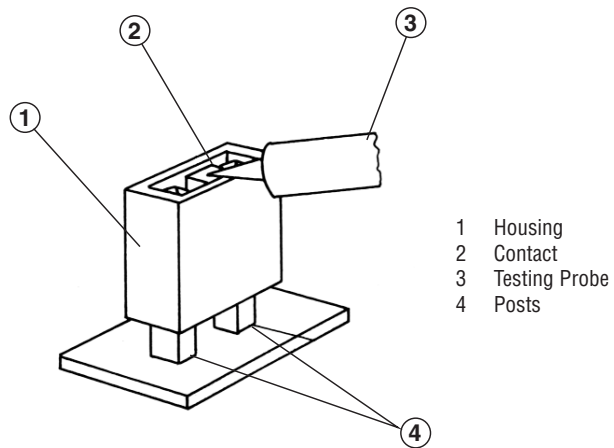

No. of Positions	Part Numbers
1	826853-1
2	826853-2
3	826853-3

Engineering Notes



Product Facts

- Single and double row connector system featuring 0.63mm square posts with mating receptacles
- Current rating 3 amps max per contact. Varies due to ambient temperature, wire size and duty cycles
- Available for wire-to-board, board-to-board and wire-to-wire applications
- Contacts available in both tin and gold plating
- Flame retardant thermoplastic housings UL 94V-1 and UL 94V-0 rated
- Shrouded pin headers are polarised and detented

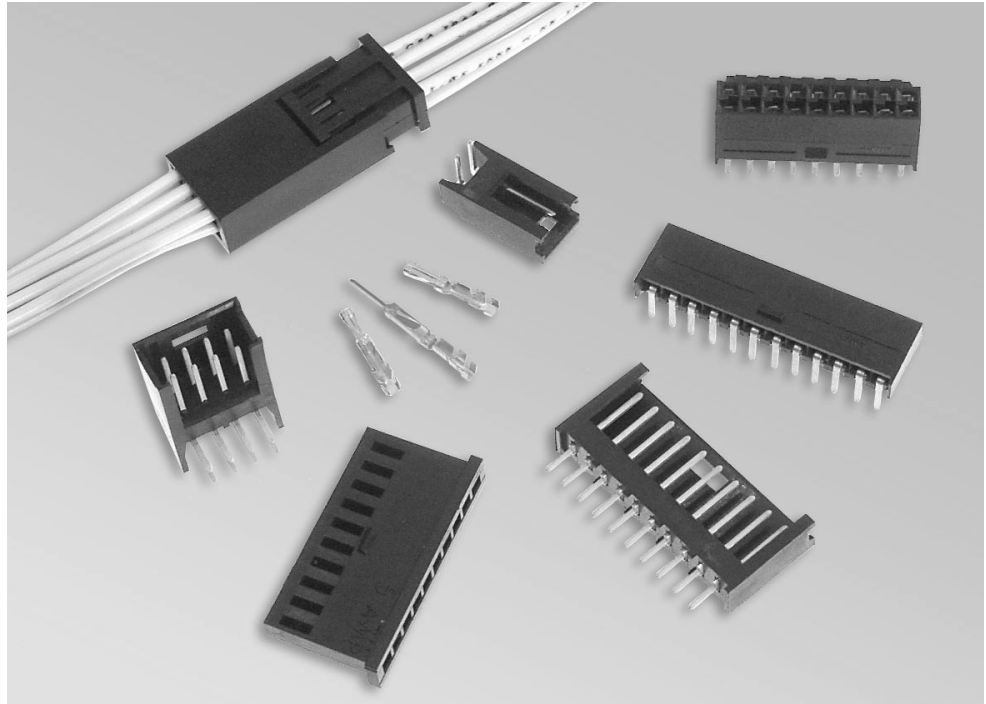

Performance Specifications:

Contact Current Rating—3 A max

Operating temperature—
-40°C to +80°C

Engaging Force

1.8 N per contact max
(standard pressure contacts)

Separating Force

0.4 N per contact min
(standard pressure contacts)

Durability

(Standard Pressure Contacts)

0.4 µm gold— 100 cycles

0.8 µm gold— 200 cycles

Contact Resistance—15 mΩ max

Insulation Resistance—
5000 MΩ min

A range of fully intermateable products on a 2.54mm (0.1") centreline for board to board, wire to board and wire to wire applications. A very flexible range, ideal where a number of system connection methods are required, the MOD II Italian range provides reliable and dependable connection for a wide range of applications.

MOD II Receptacles

Receptacle products are offered in vertical and horizontal pcb mounting and as cable mount housings for crimp snap-in contacts with insulation support. Both pcb and cable mount receptacles feature polarisation and detent latching giving a positive click when used with the corresponding header variants. Crimp contacts for receptacle housings accommodate a wire size range of 20-30AWG (0.04mm² to 0.5mm²) and are available with a number of different plating options.

MOD II Headers and Pin Housings

Available as both shrouded pcb headers with 0.63mm posts or as cable mount housings to accept crimp snap-in pin contacts with insulation support. Shrouded headers feature gold or tin plating in straight or right angle and will mate with both pcb and cable mount receptacles. Cable mount pin housings also mate with both pcb and cable mount receptacles. Crimp contacts for pin housings allow termination to wire size ranges 22-30AWG (0.04mm² to 0.32mm²) with a choice of plating finishes.

MOD II Receptacle Housings

Single Row

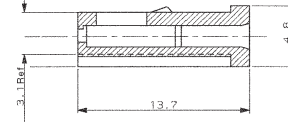
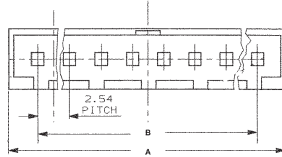
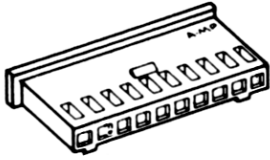

Material and Finish:

Housing—Black thermoplastic, UL 94V-1 rated

Technical Documents:

Product Specification
108-20025

Application Specification
114-20004

No. of Positions	Dimensions		Part Numbers
	A	B	
2	7.1	2.54	280358
4	12.2	7.62	280359
6	17.3	12.70	280360
8	22.3	17.78	280361
9	24.9	20.32	280512
10	27.4	22.86	280362
12	32.5	27.94	280514
15	40.1	35.56	280363
22	57.9	53.34	280364

Double Row

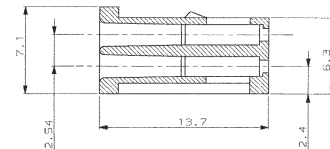
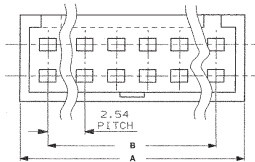
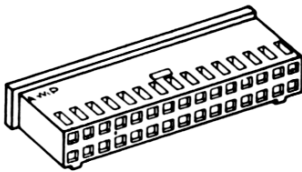

Material and Finish:

Housing—Black thermoplastic, UL 94V-1 rated

Technical Documents:

Product Specification
108-20025

Application Specification
114-20004

No. of Positions	Dimensions		Part Numbers
	A	B	
2x4	12.2	7.62	280365
2x5	14.7	10.16	284123-1
2x6	17.2	12.70	282792-1
2x8	22.3	17.78	280366
2x9	24.9	20.32	280513
2x12	32.5	27.94	280515
2x15	40.1	35.56	280368
2x18	47.8	43.18	281018
2x22	57.9	53.34	280369

Keying Plug Part Number 87077-2

(Plugs directly into Housing)



MOD II Pin Housings

Single Row

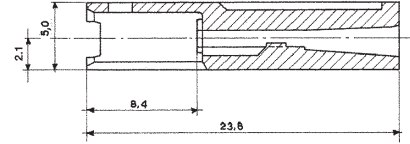
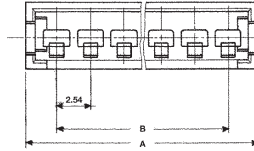
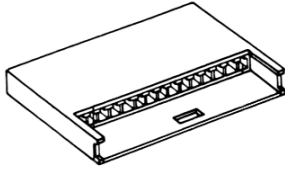

Material and Finish:

Housing—Black thermoplastic,
UL 94V-1 rated

Technical Documents:

Product Specification
108-20025

No. of Positions	Dimensions		Part Numbers
	A	B	
2	7.4	2.54	280628
4	12.5	7.62	280629
6	17.5	12.70	280630
8	22.6	17.78	280631
9	25.1	20.32	280632
10	27.7	22.86	280633
12	32.8	27.94	280634
15	40.4	35.56	280635

Double Row

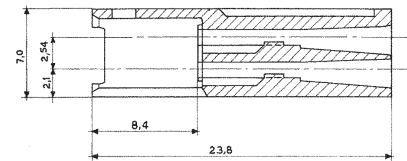
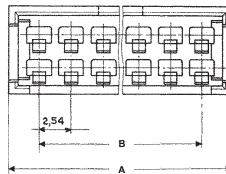
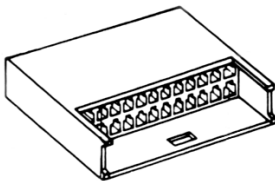

Material and Finish:

Housing—Black thermoplastic,
UL 94V-1 rated

Technical Documents:

Product Specification
108-20025

No. of Positions	Dimensions		Part Numbers
	A	B	
2x4	12.5	7.62	280637
2x8	22.6	17.78	280638
2x12	32.8	27.94	280640

MOD II Crimp Snap-In Receptacle Contacts, with Insulation Support

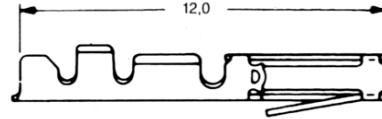

Material and Finish:

Phosphor bronze, plated as follows:

Plating A—Pre-tin plated 0.8 µm

Plating B—Selectively plated 0.4 µm gold on contact area, with gold flash over 1.3 µm nickel on entire contact

Plating C—Selectively plated 0.4 µm gold on contact area, over 1.3 µm nickel on entire contact

Plating D—Selectively plated 0.8 µm gold on contact area, with gold flash over 1.3 µm nickel on entire contact

Wire Size Range mm ²	AWG	Insulation Diameter mm	Plating	Part Numbers		Hand Tool
				Strip Form	Loose Piece	
0.5-0.2	20-24	1.60 max	Plating D	281999-1	-	-
			Plating A	281556-2*	-	
0.32-0.13	22-26	0.90-1.55	Plating B	280530-1	181270-1	58654-1
			Plating C	280530-3	181270-3	
			Plating D	280530-4	181270-4	
			Plating A	280708-2*	182206-2*	
0.08-0.04	28-30	0.64-1.27	Plating B	280422-1	181271-1	58654-1
			Plating A	280709-2*	182207-2*	

* With high contact pressure

Technical Documents:

Product Specification

108-20025

Application Specification

114-20004

MOD II Crimp Snap-In Pin Contacts, with Insulation Support



Material and Finish:

Phosphor bronze, plated as follows:

Plating A—2.5 µm tin over 1.3 µm nickel on entire contact

Plating B—Selectively plated 0.4 µm gold on contact area, with gold flash over 1.3 µm nickel on entire contact

Wire Size Range mm ²	AWG	Insulation Diameter mm	Plating	Part Numbers		Hand Tool
				Strip Form	Loose Piece	
0.32-0.13	22-26	0.90-1.55	Plating B	86557-6	86561-6	58535-1
			Plating A	1-86557-4	86561-9	
0.08-0.04	28-30	0.64-1.27	Plating B	88048-4	-	-
			Plating A	88048-2	-	

Technical Documents:

Application Specification

114-16003

MOD II Receptacles, Vertical PCB Mount

Single Row

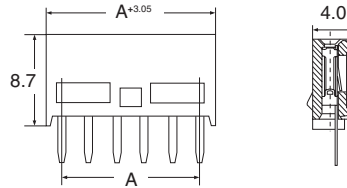
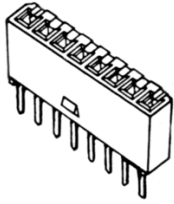

Material and Finish:

Housing—Black glass fibre filled polyester, UL 94V-0 rated

Contacts—Phosphor bronze, plated as follows:

Plating A—Selectively plated 0.4 µm gold on contact area with gold flash over nickel on entire contact

Plating B—Tin 0.8 µm

No. of Positions	Plating / Part Numbers		Dimension A
	Plating A	Plating B	
4	-	281327-1	7.62
8	281349-2	-	17.78
9	280851-2	-	20.32
12	281350-2	281331-1	27.94
15	281351-2	281328-1	35.56
22	-	281332-1	53.34

Technical Documents:

Product Specification
108-20025

Double Row

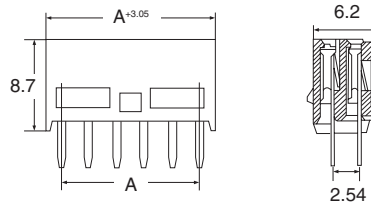
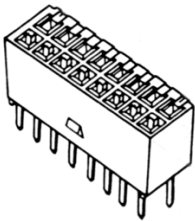

Material and Finish:

Housing—Black glass fibre filled polyester, UL 94V-0 rated

Contacts—Phosphor bronze, plated as follows:

Plating A—Selectively plated 0.4 µm gold on contact area with gold flash over nickel on entire contact

Plating B—Tin 0.8 µm

No. of Positions	Plating / Part Numbers		Dimension A
	Plating A	Plating B	
2x8	281352-2	281215-1	17.78
2x9	281353-2	281339-1	20.32
2x12	281216-2	281340-1	27.94
2x15	280922-2	-	35.56
2x22	280836-2	281342-1	53.34

Technical Documents:

Product Specification
108-20025

Keying Plug Part Number 86286-1

(Plugs into receptacle contact)

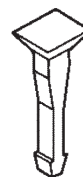

MOD II Receptacles, Horizontal PCB Mount

Single Row

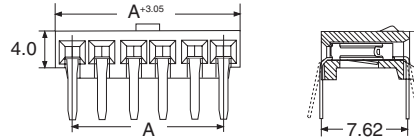
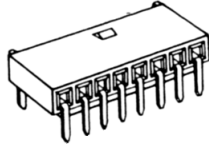

Material and Finish:

Housing—Black glass fibre filled polyester, UL 94V-0 rated

Contacts—Phosphor bronze, plated as follows:

Plating A—Selectively plated 0.4 µm gold on contact area with gold flash over nickel on entire contact

Plating B—Tin 0.8 µm

No. of Positions	Plating / Part Numbers		Dimension A
	Plating A	Plating B	
4	281218-2	281333-1	7.62
8	280578-2	281334-1	17.78
9	280579-2	-	20.32
12	280580-2	281336-1	27.94
15	280581-2	-	35.56
22	280582-2	-	53.34

Technical Documents:

Product Specification
108-20025

Double Row

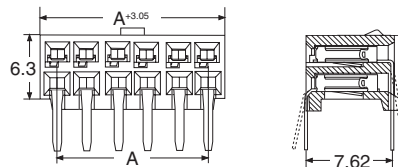
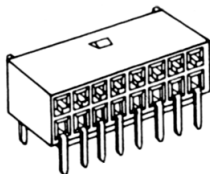

Material and Finish:

Housing—Black glass fibre filled polyester, UL 94V-0 rated

Contacts—Phosphor bronze, plated as follows:

Plating A—Selectively plated 0.4 µm gold on contact area with gold flash over nickel on entire contact

Plating B—Tin 0.8 µm

No. of Positions	Plating / Part Numbers		Dimension A
	Plating A	Plating B	
2x8	280583-2	-	17.78
2x12	280585-2	-	27.94
2x15	280586-2	-	35.56

Technical Documents:

Product Specification
108-20025

Keying Plug Part Number 86286-1

(Plugs into receptacle contact)

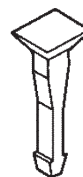

MOD II Shrouded Headers, Straight

Single Row Header

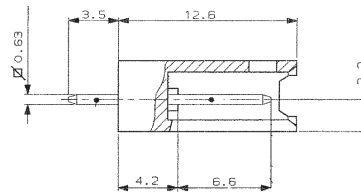
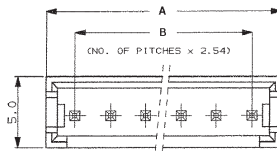
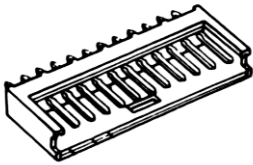

Material and Finish:

Housing—Black thermoplastic, UL 94V-0 rated

Posts—Brass (gold plating) or phosphor bronze (tin plating). Plating details as follows:

Plating A—Gold 0.8 μm on contact area and 2.5 μm tin on solder area, with entire post underplated 1.3 μm nickel

Plating B—Gold 0.4 μm on contact area and 2.5 μm tin on solder area, with entire post underplated 1.3 μm nickel

Plating C—Tin 3.5 μm

No. of Positions	Dimensions		Part Numbers		
	A	B	Plating C	Plating B	Plating A
2	7.7	2.54	280370-1	280370-2	280370-3
4	12.7	7.62	280371-1	280371-2	280371-3
6	17.8	12.70	280372-1	280372-2	280372-3
8	22.9	17.78	280373-1	280373-2	280373-3
9	25.4	20.32	280508-1	280508-2	-
10	28.0	22.86	280374-1	280374-2	280374-3
12	33.1	27.94	280520-1	280520-2	280520-3
15	40.7	35.56	280375-1	280375-2	280375-3
22	58.5	53.34	280376-1	280376-2	280376-3

Technical Documents:

Product Specification
108-20025

Double Row Header

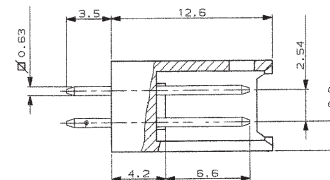
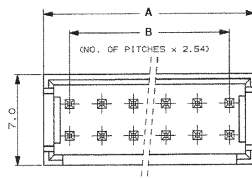
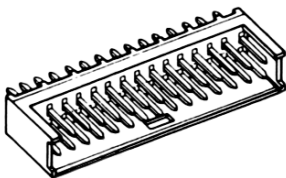

Material and Finish:

Housing—Black thermoplastic, UL 94V-0 rated

Posts—Brass (gold plating) or phosphor bronze (tin plating). Plating details as follows:

Plating A—Gold 0.8 μm on contact area and 2.5 μm tin on solder area, with entire post underplated 1.3 μm nickel

Plating B—Gold 0.4 μm on contact area and 2.5 μm tin on solder area, with entire post underplated 1.3 μm nickel

Plating C—Tin 3.5 μm

No. of Positions	Dimensions		Part Numbers		
	A	B	Plating C	Plating B	Plating A
2x4	12.7	7.62	280384-1	280384-2	280384-3
2x8	22.9	17.78	280385-1	280385-2	280385-3
2x9	25.4	20.32	280509-1	280509-2	280509-3
2x12	33.1	27.94	280521-1	280521-2	280521-3
2x15	40.7	35.56	280387-1	280387-2	280387-3
2x18	48.3	43.18	-	281019-2	-
2x22	58.5	53.34	280388-1	280388-2	-

Technical Documents:

Product Specification
108-20025

MOD II Shrouded Headers, Right-Angle

Single Row Header

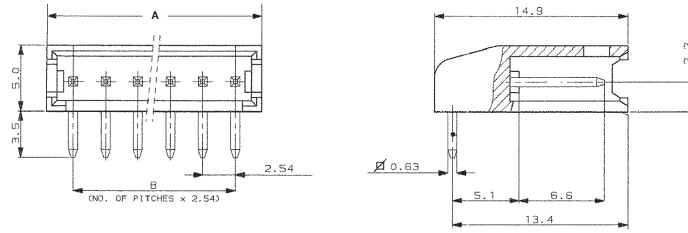
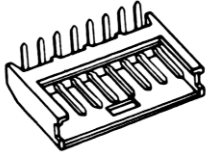

Material and Finish:

Housing—Black thermoplastic, UL 94V-0 rated

Posts—Brass (gold plating) or phosphor bronze (tin plating). Plating details as follows:

Plating A—Gold 0.8 μm on contact area and 2.5 μm tin on solder area, with entire post underplated 1.3 μm nickel

Plating B—Gold 0.4 μm on contact area and 2.5 μm tin on solder area, with entire post underplated 1.3 μm nickel

Plating C—Tin 3.5 μm

No. of Positions	Dimensions		Part Numbers		
	A	B	Plating C	Plating B	Plating A
2	7.7	2.54	280377-1	280377-2	280377-3
4	12.7	7.62	280378-1	280378-2	280378-3
6	17.8	12.70	280379-1	280379-2	280379-3
8	22.9	17.78	280380-1	280380-2	280380-3
9	25.4	20.32	280511-1	-	-
10	28.0	22.86	280381-1	280381-2	280381-3
12	33.1	27.94	280523-1	280523-2	280523-3
15	40.7	35.56	280382-1	280382-2	-
22	58.5	53.34	280383-1	280383-2	-

Technical Documents:

Product Specification
108-20025

Double Row Header

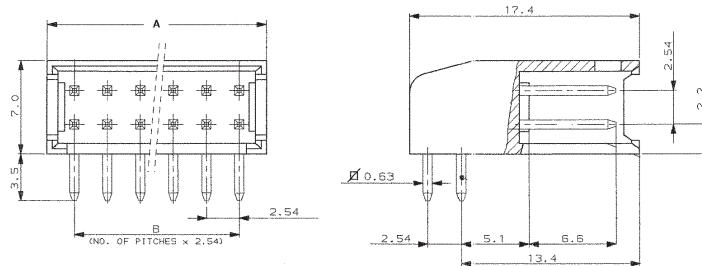
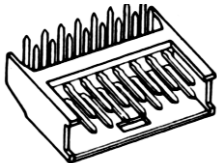

Material and Finish:

Housing—Black thermoplastic, UL 94V-0 rated

Posts—Brass (gold plating) or phosphor bronze (tin plating). Plating details as follows:

Plating A—Gold 0.8 μm on contact area and 2.5 μm tin on solder area, with entire post underplated 1.3 μm nickel

Plating B—Gold 0.4 μm on contact area and 2.5 μm tin on solder area, with entire post underplated 1.3 μm nickel

Plating C—Tin 3.5 μm

No. of Positions	Dimensions		Part Numbers		
	A	B	Plating C	Plating B	Plating A
2x4	12.7	7.62	280389-1	280389-2	280389-3
2x5	15.2	10.16	—	284124-1	—
2x6	17.8	12.70	—	282790-1	—
2x8	22.9	17.78	280390-1	280390-2	280390-3
2x9	25.4	20.32	280510-1	280510-2	280510-3
2x12	33.1	27.94	280522-1	280522-2	280522-3
2x15	40.7	35.56	280392-1	280392-2	280392-3
2x18	48.3	43.18	-	281021-2	-
2x22	58.5	53.34	280393-1	280393-2	280393-3

Technical Documents:

Product Specification
108-20025

Product Facts

- Comprehensive single and double row connector system featuring 0.63mm posts with mating receptacles
- Current rating 3A max per contact. Varies due to ambient temperature, wire size and duty cycles
- Available for wire-to-board and board-to-board applications
- Contacts available in both tin and gold plating
- Flame retardant thermoplastic housings are UL 94V-0 rated

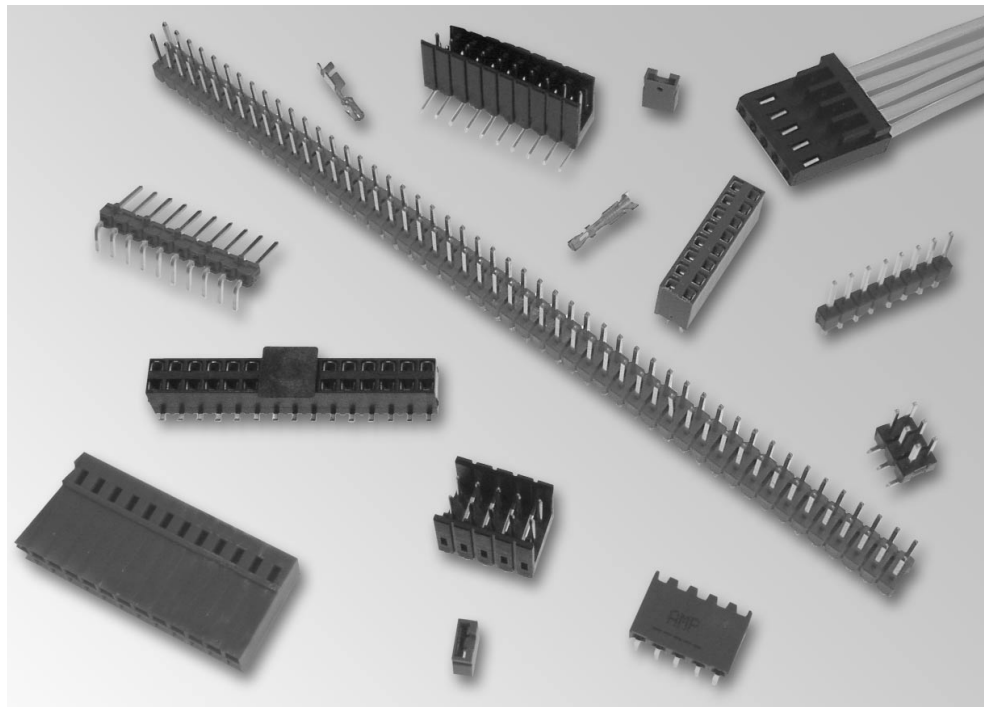

Performance Specifications:

Contact Current Rating—3 A max

Operating temperature—
-55°C to +105°C min

Contact Resistance—20 mΩ max

Insulation Resistance—
1000 MΩ max

A wide range of modular interconnects on the industry standard 2.54mm (0.1") grid addressing applications across all industry sectors. Designed for wire to board or board to board connection, including stacking, the AMPMODU 2.54mm system provides a comprehensive solution for this ever popular connection style.

MOD II Breakaway Pin Headers

Supplied in a breakaway form, headers can be conveniently broken to any size needed ensuring maximum versatility. Available in straight and right angle, compatibility with mating receptacles is assured through a range of pin lengths and plating options. Pin headers are offered for surface mount, press fit action pin and standard through hole solder.

HV100/190 PCB Receptacles

HV100/190 receptacles are available in vertical and horizontal mounting and offer the benefit of a short contact point design. Options for sealing, top or bottom entry and surface mounting ensure a suitable connector is available for each application. Three mounting heights for the HV100 vertical receptacle allow the connector to be used for versatile stacking applications. All HV100/190 receptacles feature a choice of gold or tin contact plating.

MOD II Shrouded Headers

With a range of dedicated cable mount receptacle products, the MOD II shrouded headers allow wire to board connection with the added security of shrouded pin contacts. MOD II headers also offer the benefit of compatibility with high temperature surface mount processes.

MOD IV Cable Mount Receptacles

Available in two styles, MOD IV cable mount receptacle housings accept MOD IV/V crimp snap-in contacts, providing connection to the MOD II shrouded headers and the MOD II breakaway pin header family. Complete with a range of accessories including keying and retention plugs, this range of receptacles offer reliable and cost effective wire to board connection. Contacts suitable for wire sizes 20-32AWG (0.032mm² to 0.56mm²) are available with a range of plating finishes in standard or high pressure variants.

MOD IV Shunt Connectors

The shunt connector provides quick and easy programming of electrical circuits. Supplied in strips they can be broken off as required, or may be supplied in loose piece form. The open top design allows the use of a test probe while in-circuit.

MOD II Low Cost Line Breakaway Pin Headers—Unshrouded, Straight

Single Row 0.63mm Square Post

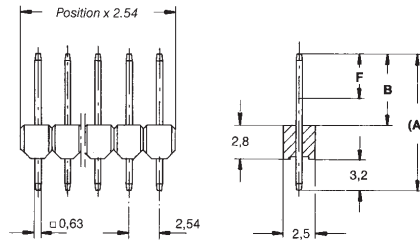
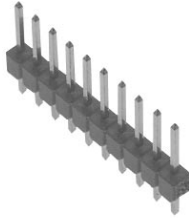

Material and Finish:

Housing—Green polyester, glass filled, UL 94V-0 rated

Posts—Phosphor bronze, plated as follows:

Plating A

Contact Zone (Area F)—0.8 µm gold over 1.3 µm nickel

Soldering Zone—3 µm min. tin over 1.3 µm nickel

Plating B—2 µm min. tin over 1.3 µm nickel

Technical Documents:

Product Specification
108-18012

No. of Positions	A=11.8 B=5.8 F=4.4		A=12.7 B=6.7 F=4.4		A=14.0 B=8.0 F=4.4	
	Part Numbers		Part Numbers		Part Numbers	
	Plating A	Plating B	Plating A	Plating B	Plating A	Plating B
2	826646-2	826936-2	826629-2	826926-2	826648-2	826938-2
3	826646-3	826936-3	826629-3	826926-3	826648-3	826938-3
4	826646-4	826936-4	826629-4	826926-4	826648-4	826938-4
5	826646-5	826936-5	826629-5	826926-5	826648-5	826938-5
6	826646-6	826936-6	826629-6	826926-6	826648-6	826938-6
7	826646-7	826936-7	826629-7	826926-7	826648-7	826938-7
8	826646-8	826936-8	826629-8	826926-8	826648-8	826938-8
9	826646-9	826936-9	826629-9	826926-9	826648-9	826938-9
10	1-826646-0	1-826936-0	1-826629-0	1-826926-0	1-826648-0	1-826938-0
20	2-826646-0	2-826936-0	2-826629-0	2-826926-0	2-826648-0	2-826938-0
50	5-826646-0	5-826936-0	5-826629-0	5-826926-0	5-826648-0	5-826938-0

Ordering Information: For intermediate number of positions, please combine dash numbers

Double Row 0.63mm Square Post

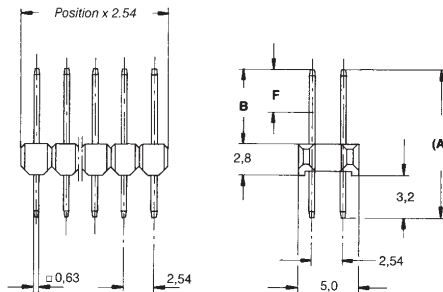
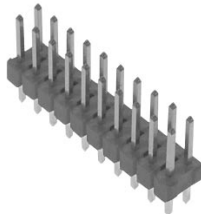

Material and Finish:

Housing—Green polyester, glass filled, UL 94V-0 rated

Posts—Phosphor bronze, plated as follows:

Plating A

Contact Zone (Area F)—0.8 µm gold over 1.3 µm nickel

Soldering Zone—3 µm min. tin over 1.3 µm nickel

Plating B—2 µm min. tin over 1.3 µm nickel

Technical Documents:

Product Specification
108-18012

No. of Positions	A=11.8 B=5.8 F=4.4		A=12.7 B=6.7 F=5.5		A=14.0 B=8.0 F=4.4	
	Part Numbers		Part Numbers		Part Numbers	
	Plating A	Plating B	Plating A	Plating B	Plating A	Plating B
2x2	826656-2	826942-2	826632-2	826925-2	826658-2	826944-2
2x3	826656-3	826942-3	826632-3	826925-3	826658-3	826944-3
2x4	826656-4	826942-4	826632-4	826925-4	826658-4	826944-4
2x5	826656-5	826942-5	826632-5	826925-5	826658-5	826944-5
2x6	826656-6	826942-6	826632-6	826925-6	826658-6	826944-6
2x7	826656-7	826942-7	826632-7	826925-7	826658-7	826944-7
2x8	826656-8	826942-8	826632-8	826925-8	826658-8	826944-8
2x9	826656-9	826942-9	826632-9	826925-9	826658-9	826944-9
2x10	1-826656-0	1-826942-0	1-826632-0	1-826925-0	1-826658-0	1-826944-0
2x20	2-826656-0	2-826942-0	2-826632-0	2-826925-0	2-826658-0	2-826944-0
2x50	5-826656-0	5-826942-0	5-826632-0	5-826925-0	5-826658-0	5-826944-0

Ordering Information: For intermediate number of positions, please combine dash numbers

MOD II Low Cost Line Breakaway Pin Headers—Unshrouded, Right Angle

Single Row 0.63mm Square Post

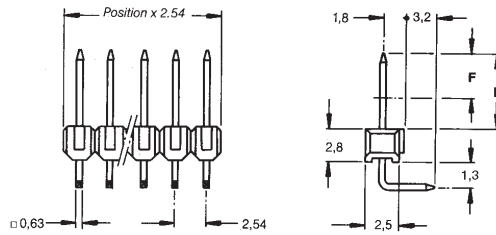
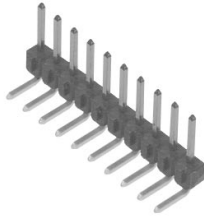

Material and Finish:

Housing—Green polyester, glass filled, UL 94V-0 rated

Posts—Phosphor bronze, plated as follows:

Plating A

Contact Zone (Area F)—0.8 µm gold over 1.3 µm nickel

Soldering Zone—3 µm min. tin over 1.3 µm nickel

Plating B—2 µm min. tin over 1.3 µm nickel

Technical Documents:

Product Specification
108-18012

No. of Positions	B=5.8 F=4.4		B=6.7 F=4.4		B=8.0 F=4.4	
	Part Numbers		Part Numbers		Part Numbers	
	Plating A	Plating B	Plating A	Plating B	Plating A	Plating B
2	826652-2	826949-2	826631-2	826947-2	826654-2	826951-2
3	826652-3	826949-3	826631-3	826947-3	826654-3	826951-3
4	826652-4	826949-4	826631-4	826947-4	826654-4	826951-4
5	826652-5	826949-5	826631-5	826947-5	826654-5	826951-5
6	826652-6	826949-6	826631-6	826947-6	826654-6	826951-6
7	826652-7	826949-7	826631-7	826947-7	826654-7	826951-7
8	826652-8	826949-8	826631-8	826947-8	826654-8	826951-8
9	826652-9	826949-9	826631-9	826947-9	826654-9	826951-9
10	1-826652-0	1-826949-0	1-826631-0	1-826947-0	1-826654-0	1-826951-0
20	2-826652-0	2-826949-0	2-826631-0	2-826947-0	2-826654-0	2-826951-0
50	5-826652-0	5-826949-0	5-826631-0	5-826947-0	5-826654-0	5-826951-0

Ordering Information: For intermediate number of positions, please combine dash numbers

Double Row 0.63mm Square Post

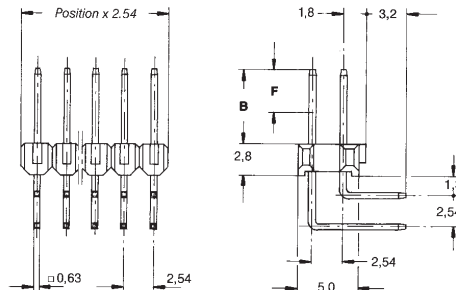

Material and Finish:

Housing—Green polyester, glass filled, UL 94V-0 rated

Posts—Phosphor bronze, plated as follows:

Plating A

Contact Zone (Area F)—0.8 µm gold over 1.3 µm nickel

Soldering Zone—3 µm min. tin over 1.3 µm nickel

Plating B—2 µm min. tin over 1.3 µm nickel

Technical Documents:

Product Specification
108-18012

No. of Positions	B=5.8 F=4.4		B=6.7 F=5.5		B=8.0 F=4.4	
	Part Numbers		Part Numbers		Part Numbers	
	Plating A	Plating B	Plating A	Plating B	Plating A	Plating B
2x2	826662-2	826955-2	826634-2	826953-2	826664-2	826957-2
2x3	826662-3	826955-3	826634-3	826953-3	826664-3	826957-3
2x4	826662-4	826955-4	826634-4	826953-4	826664-4	826957-4
2x5	826662-5	826955-5	826634-5	826953-5	826664-5	826957-5
2x6	826662-6	826955-6	826634-6	826953-6	826664-6	826957-6
2x7	826662-7	826955-7	826634-7	826953-7	826664-7	826957-7
2x8	826662-8	826955-8	826634-8	826953-8	826664-8	826957-8
2x9	826662-9	826955-9	826634-9	826953-9	826664-9	826957-9
2x10	1-826662-0	1-826955-0	1-826634-0	1-826953-0	1-826664-0	1-826957-0
2x20	2-826662-0	2-826955-0	2-826634-0	2-826953-0	2-826664-0	2-826957-0
2x50	5-826662-0	5-826955-0	5-826634-0	5-826953-0	5-826664-0	5-826957-0

Ordering Information: For intermediate number of positions, please combine dash numbers

MOD II Economy Line Breakaway Pin Headers—Unshrouded, Straight

Single Row 0.63mm Square Post



With retention feature when used with 925369 MOD IV receptacle housing

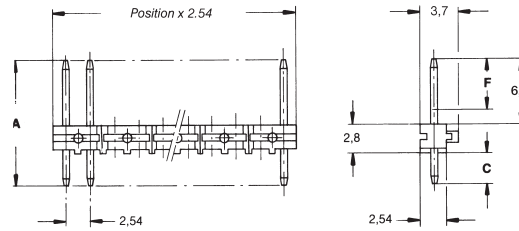

Material and Finish:

Housing—Green polyester, glass filled, UL 94V-0 rated

Posts—Phosphor bronze, plated as follows:

Plating A

Contact Zone (Area F)—0.8 µm gold over 1.3 µm nickel

Soldering Zone—2.5 µm min. tin over 1.3 µm nickel

Plating B—2 µm min. tin over 1.3 µm nickel

Technical Documents:

Product Specification
108-18012

No. of Positions	A = 12.7 C = 3.2 F=4.4		A = 15.2 C = 5.7 F= 4.4		A = 20.3 C = 10.8 F= 4.4	
	Part Numbers	Plating B	Part Numbers	Plating B	Part Numbers	Plating B
2	825433-2	828214-2	825434-2	827312-2	825435-2	827313-2
3	825433-3	828214-3	825434-3	827312-3	825435-3	827313-3
4	825433-4	828214-4	825434-4	827312-4	825435-4	827313-4
5	825433-5	828214-5	825434-5	827312-5	825435-5	827313-5
6	825433-6	828214-6	825434-6	827312-6	825435-6	827313-6
7	825433-7	828214-7	825434-7	827312-7	825435-7	827313-7
8	825433-8	828214-8	825434-8	827312-8	825435-8	827313-8
9	825433-9	828214-9	825434-9	827312-9	825435-9	827313-9
10	1-825433-0	1-828214-0	1-825434-0	1-827312-0	1-825435-0	1-827313-0
20	2-825433-0	2-828214-0	2-825434-0	2-827312-0	2-825435-0	2-827313-0
50	5-825433-0	5-828214-0	5-825434-0	5-827312-0	5-825435-0	5-827313-0

Ordering Information: For intermediate number of positions, please combine dash numbers

Double Row 0.63mm Square Post



With retention feature when used with 925370 MOD IV receptacle housing

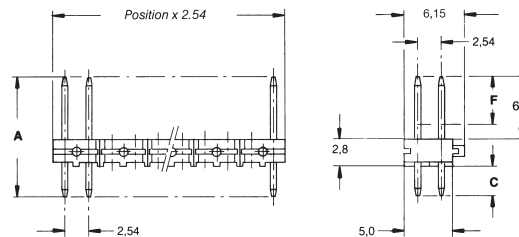

Material and Finish:

Housing—Green polyester, glass filled, UL 94V-0 rated

Posts—Phosphor bronze, plated as follows:

Plating A

Contact Zone (Area F)—0.8 µm gold over 1.3 µm nickel

Soldering Zone—2.5 µm min. tin over 1.3 µm nickel

Plating B—2 µm min. tin over 1.3 µm nickel

Technical Documents:

Product Specification
108-18012

No. of Positions	A= 12.7 C= 3.2 F=4.4	
	Part Numbers	Plating B
2x2	825440-2	828213-2
2x3	825440-3	828213-3
2x4	825440-4	828213-4
2x5	825440-5	828213-5
2x6	825440-6	828213-6
2x7	825440-7	828213-7
2x8	825440-8	828213-8
2x9	825440-9	828213-9
2x10	1-825440-0	1-828213-0
2x20	2-825440-0	2-828213-0
2x50	5-825440-0	5-828213-0

Ordering Information: For intermediate number of positions, please combine dash numbers

MOD II Economy Line Breakaway Pin Headers—Unshrouded, Right Angle

Single Row 0.63mm Square Post

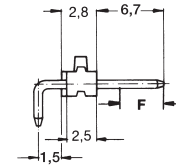
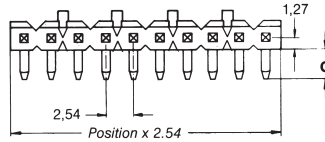

With retention feature when used with 925369 MOD IV receptacle housing

Material and Finish:

Housing—Green polyester, glass filled, UL 94V-0 rated

Posts—Phosphor bronze, plated as follows:

Plating

Contact Zone (Area F)—0.8 μm gold over 1.3 μm nickel

Soldering Zone—2 μm min. tin over 1.3 μm nickel

Technical Documents:

Product Specification
108-18012

No. of Positions	C= 3.2 F= 4.4
	Part Numbers
2	825437-2
3	825437-3
4	825437-4
5	825437-5
6	825437-6
7	825437-7
8	825437-8
9	825437-9
10	1-825437-0
20	2-825437-0
50	5-825437-0

Ordering Information: For intermediate number of positions, please combine dash numbers

Double Row 0.63mm Square Post

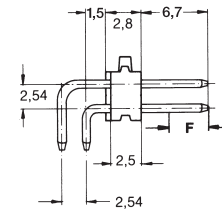
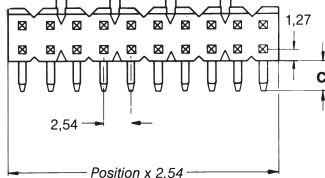

With retention feature when used with 925370 MOD IV receptacle housing

Material and Finish:

Housing—Green polyester, glass filled, UL 94V-0 rated

Posts—Phosphor bronze, plated as follows:

Plating

Contact Zone (Area F)—0.8 μm gold over 1.3 μm nickel

Soldering Zone—2 μm min. tin over 1.3 μm nickel

Technical Documents:

Product Specification
108-18012

No. of Positions	C= 3.2 F= 4.4
	Part Numbers
2x2	825457-2
2x3	825457-3
2x4	825457-4
2x5	825457-5
2x6	825457-6
2x7	825457-7
2x8	825457-8
2x9	825457-9
2x10	1-825457-0
2x20	2-825457-0
2x50	5-825457-0

Ordering Information: For intermediate number of positions, please combine dash numbers

MOD II Surface Mount Breakaway Pin Headers—Unshrouded, Straight, End Stackable

Single Row 0.63mm Square Post

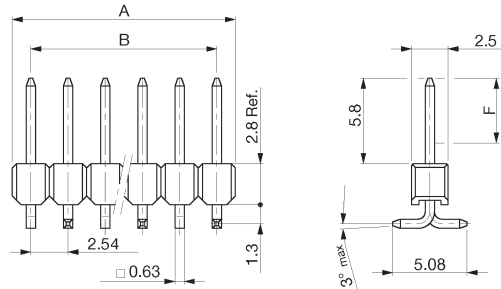
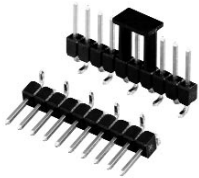

Material and Finish:

Housing and pick & place adapter
—PCT GV Black

Posts—Phosphor bronze, plated as follows:

Contact Zone (Area F)—0.8 μm gold over 1.3 μm nickel

Soldering Zone—min 2.5 μm tin over 1.3 μm nickel

Technical Documents:

Product Specification
108-18012

No. of Positions	Dimensions		F=4.4
	A	B	Part Numbers Blister Packaging
3	7.62	5.08	1241150-3
4	10.16	7.62	1241150-4
5	12.70	10.16	1241150-5
6	15.24	12.70	1241150-6
7	17.78	15.24	1241150-7
8	20.32	17.78	1241150-8
9	22.86	20.32	1241150-9
10	25.40	22.86	1-1241150-0
17	43.18	40.64	1-1241150-7

Ordering Information: For intermediate number of positions, please combine dash numbers

Double Row 0.63mm Square Post

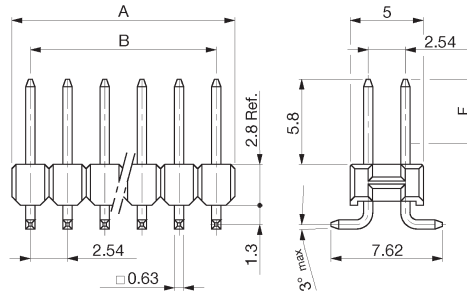

Material and Finish:

Housing and pick & place adapter
—PCT GV Black

Posts—Phosphor bronze, plated as follows:

Contact Zone (Area F)—0.8 μm gold over 1.3 μm nickel

Soldering Zone—min 2.5 μm tin over 1.3 μm nickel

Technical Documents:

Product Specification
108-18012

No. of Positions	Dimensions		F=4.4
	A	B	Part Numbers Blister Packaging
2x2	5.08	2.54	1241050-2
2x3	7.62	5.08	1241050-3
2x4	10.16	7.62	1241050-4
2x5	12.70	10.16	1241050-5
2x6	15.24	12.70	1241050-6
2x7	17.78	15.24	1241050-7
2x8	20.32	17.78	1241050-8
2x9	22.86	20.32	1241050-9
2x10	25.40	22.86	1-1241050-0
2x17	43.18	40.64	1-1241050-7

Ordering Information: For intermediate number of positions, please combine dash numbers

Note: Other pin lengths available on request

MOD II ACTION PIN Breakaway Pin Headers—Unshrouded, Straight

Single Row 0.63mm Square Post

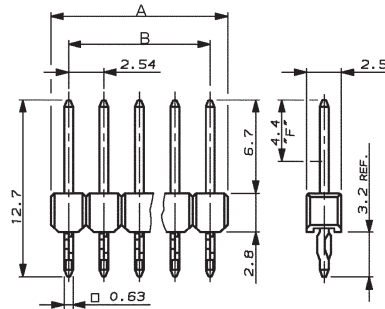

Material and Finish:

Housing—Polyester, glass filled, green UL 94V-0 rated

Posts—Phosphor bronze, plated as follows:

Plating A

Contact Zone (Area F)—0.1 µm gold, over 0.7 µm palladium alloy, over 1.27 µm nickel

Action Pin Zone—2.0 µm min. tin over 1.27 µm nickel

Plating B—Tin over 1.27 µm nickel

No. of Positions	Dimensions		Part Numbers	
	A	B	Plating A	Plating B
2	5.08	2.54	966575-2	966573-2
3	7.62	5.08	966575-3	966573-3
4	10.16	7.62	966575-4	966573-4
5	12.70	10.16	966575-5	966573-5
6	15.24	12.70	966575-6	966573-6
7	17.78	15.24	966575-7	966573-7
8	20.32	17.78	966575-8	966573-8
9	22.86	20.32	966575-9	966573-9
10	25.40	22.86	1-966575-0	1-966573-0
20	50.80	48.26	2-966575-0	2-966573-0
50	127.00	124.46	5-966575-0	5-966573-0

Ordering Information: For intermediate number of positions, please combine dash numbers

Technical Documents:

Product Specification
108-18012

Double Row 0.63mm Square Post

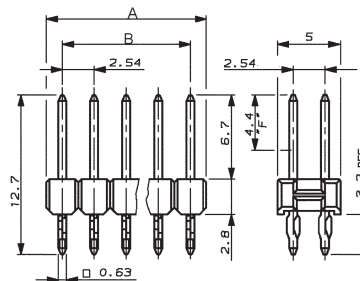
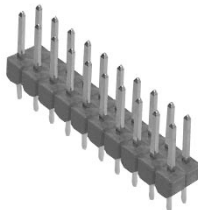

Material and Finish:

Housing—Polyester, glass filled, green UL 94V-0 rated

Posts—Phosphor bronze, plated as follows:

Plating A

Contact Zone (Area F)—0.1 µm gold, over 0.7 µm palladium alloy, over 1.27 µm nickel

Action Pin Zone—2.0 µm min. tin over 1.27 µm nickel

Plating B—Tin over 1.27 µm nickel

No. of Positions	Dimensions		Part Numbers	
	A	B	Plating A	Plating B
2x2	5.08	2.54	966574-2	966572-2
2x3	7.62	5.08	966574-3	966572-3
2x4	10.16	7.62	966574-4	966572-4
2x5	12.70	10.16	966574-5	966572-5
2x6	15.24	12.70	966574-6	966572-6
2x7	17.78	15.24	966574-7	966572-7
2x8	20.32	17.78	966574-8	966572-8
2x9	22.86	20.32	966574-9	966572-9
2x10	25.40	22.86	1-966574-0	1-966572-0
2x20	50.80	48.26	2-966574-0	2-966572-0
2x50	127.00	124.46	5-966574-0	5-966572-0

Ordering Information: For intermediate number of positions, please combine dash numbers

Technical Documents:

Product Specification
108-18012

HV-100 Receptacles, Vertical PCB Mount, Top Entry

Single Row Kinked Legs with Retention Feature Anti-Tilt

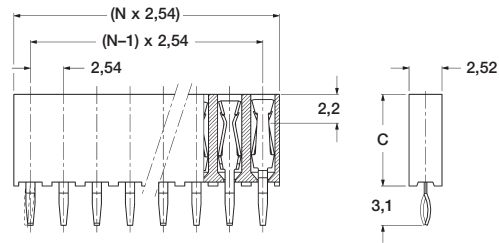
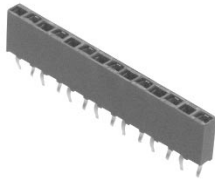

Material and Finish:

Housing—Polyester, glass filled, green UL 94V-0 rated

Contact Material—Phosphor bronze, plated as follows:

Plating A

Contact Zone—0.8 µm gold over 1.3 µm nickel

Soldering Zone—2.5 µm tin over 1.3 µm nickel

Plating B—2.5 µm tin

Technical Documents:

Product Specification
108-19056

No. of Positions	C=6.2		C=7.0		C=8.5	
	Part Numbers	Part Numbers	Part Numbers	Part Numbers	Part Numbers	Part Numbers
2	829094-2	829411-2	215297-2	215298-2	215299-2	215300-2
3	829094-3	829411-3	215297-3	215298-3	215299-3	215300-3
4	829094-4	829411-4	215297-4	215298-4	215299-4	215300-4
5	829094-5	829411-5	215297-5	215298-5	215299-5	215300-5
6	829094-6	829411-6	215297-6	215298-6	215299-6	215300-6
7	829094-7	829411-7	215297-7	215298-7	215299-7	215300-7
8	829094-8	829411-8	215297-8	215298-8	215299-8	215300-8
9	829094-9	829411-9	215297-9	215298-9	215299-9	215300-9
10	1-829094-0	1-829411-0	1-215297-0	1-215298-0	1-215299-0	1-215300-0
20	2-829094-0	2-829411-0	2-215297-0	2-215298-0	2-215299-0	2-215300-0
36	3-829094-6	3-829411-6	3-215297-6	3-215298-6	3-215299-6	3-215300-6

Ordering Information: For intermediate number of positions, please combine dash numbers

Double Row Kinked Legs with Retention Feature Anti-Tilt

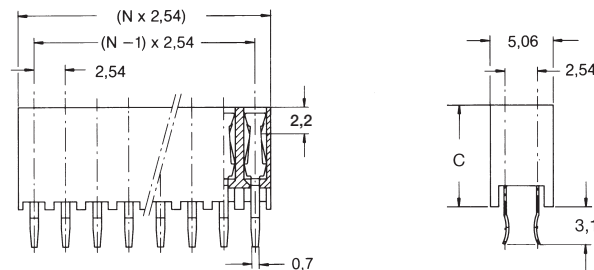
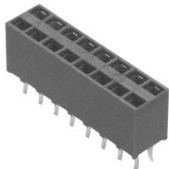

Material and Finish:

Housing—Polyester, glass filled, green UL 94V-0 rated

Contact Material—Phosphor bronze, plated as follows:

Plating A

Contact Zone—0.8 µm gold over 1.3 µm nickel

Soldering Zone—2.5 µm tin over 1.3 µm nickel

Plating B—2.5 µm tin

Technical Documents:

Product Specification
108-19056

No. of Positions	C=6.2		C=7.0		C=8.5	
	Part Numbers	Part Numbers	Part Numbers	Part Numbers	Part Numbers	Part Numbers
2x2	829095-2	829410-2	215307-2	215308-2	215309-2	215310-2
2x3	829095-3	829410-3	215307-3	215308-3	215309-3	215310-3
2x4	829095-4	829410-4	215307-4	215308-4	215309-4	215310-4
2x5	829095-5	829410-5	215307-5	215308-5	215309-5	215310-5
2x6	829095-6	829410-6	215307-6	215308-6	215309-6	215310-6
2x7	829095-7	829410-7	215307-7	215308-7	215309-7	215310-7
2x8	829095-8	829410-8	215307-8	215308-8	215309-8	215310-8
2x9	829095-9	829410-9	215307-9	215308-9	215309-9	215310-9
2x10	1-829095-0	1-829410-0	1-215307-0	1-215308-0	1-215309-0	1-215310-0
2x20	2-829095-0	2-829410-0	2-215307-0	2-215308-0	2-215309-0	2-215310-0
2x36	3-829095-6	3-829410-6	3-215307-6	3-215308-6	3-215309-6	3-215310-6

Ordering Information: For intermediate number of positions, please combine dash numbers

HV-100 Receptacles, Vertical PCB Mount, Sealed, Top Entry

Single Row Sealed, Kinked Legs with Retention Feature Anti-Tilt

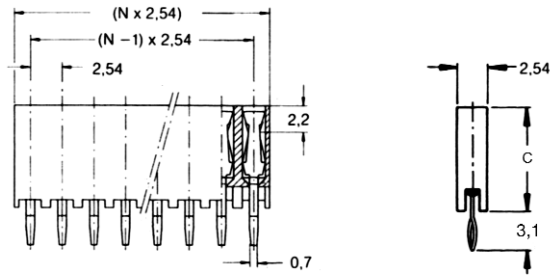
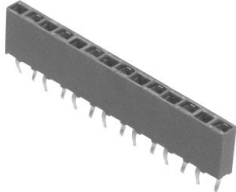

Material and Finish:

Housing—Polyester, glass filled, green UL 94V-0 rated

Contact Material—Phosphor bronze, plated as follows:

Plating A

Contact Zone—0.8 µm gold over 1.3 µm nickel

Soldering Zone—2.5 µm tin over 1.3 µm nickel

Plating B—2.5 µm tin

Technical Documents:

Product Specification
108-19056

No. of Positions	C=7.0		C=8.5	
	Part Numbers		Part Numbers	
	Plating A	Plating B	Plating A	Plating B
2	215301-2	215302-2	215303-2	215304-2
3	215301-3	215302-3	215303-3	215304-3
4	215301-4	215302-4	215303-4	215304-4
5	215301-5	215302-5	215303-5	215304-5
6	215301-6	215302-6	215303-6	215304-6
7	215301-7	215302-7	215303-7	215304-7
8	215301-8	215302-8	215303-8	215304-8
9	215301-9	215302-9	215303-9	215304-9
10	1-215301-0	1-215302-0	1-215303-0	1-215304-0
20	2-215301-0	2-215302-0	2-215303-0	2-215304-0
36	3-215301-6	3-215302-6	3-215303-6	3-215304-6

Ordering Information: For intermediate number of positions, please combine dash numbers

Double Row Sealed, Kinked Legs with Retention Feature Anti-Tilt

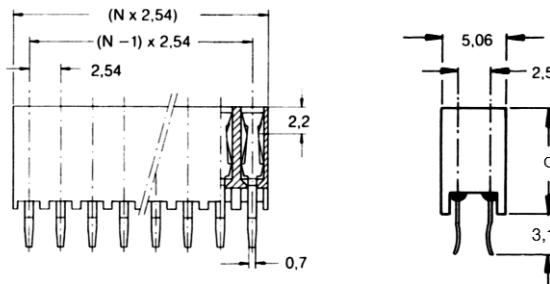
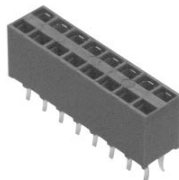

Material and Finish:

Housing—Polyester, glass filled, green UL 94V-0 rated

Contact Material—Phosphor bronze, plated as follows:

Plating A

Contact Zone—0.8 µm gold over 1.3 µm nickel

Soldering Zone—2.5 µm tin over 1.3 µm nickel

Plating B—2.5 µm tin

Technical Documents:

Product Specification
108-19056

No. of Positions	C=7.0		C=8.5	
	Part Numbers		Part Numbers	
	Plating A	Plating B	Plating A	Plating B
2x2	215311-2	215312-2	215313-2	215314-2
2x3	215311-3	215312-3	215313-3	215314-3
2x4	215311-4	215312-4	215313-4	215314-4
2x5	215311-5	215312-5	215313-5	215314-5
2x6	215311-6	215312-6	215313-6	215314-6
2x7	215311-7	215312-7	215313-7	215314-7
2x8	215311-8	215312-8	215313-8	215314-8
2x9	215311-9	215312-9	215313-9	215314-9
2x10	1-215311-0	1-215312-0	1-215313-0	1-215314-0
2x20	2-215311-0	2-215312-0	2-215313-0	2-215314-0
2x36	3-215311-6	3-215312-6	3-215313-6	3-215314-6

Ordering Information: For intermediate number of positions, please combine dash numbers

HV-100 Receptacles, Vertical PCB Mount, Top or Bottom Entry

Single Row

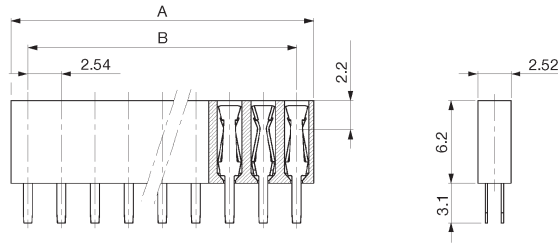
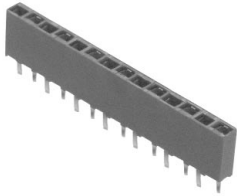

Material and Finish:

Housing—Polyester, glass filled, green UL 94V-0 rated

Contact Material—Phosphor bronze, plated as follows:

Plating A

Contact Zone—0.8 µm gold over 1.3 µm nickel

Soldering Zone—2.5 µm tin over 1.3 µm nickel

Plating B—2.5 µm tin

Technical Documents:

Product Specification
108-19056

No. of Positions	Dimensions		Part Numbers	
	A	B	Plating A	Plating B
2	5.08	2.54	215305-2	215306-2
3	7.62	5.08	215305-3	215306-3
4	10.16	7.62	215305-4	215306-4
5	12.70	10.16	215305-5	215306-5
6	15.24	12.70	215305-6	215306-6
7	17.78	15.24	215305-7	215306-7
8	20.32	17.78	215305-8	215306-8
9	22.86	20.32	215305-9	215306-9
10	25.40	22.86	1-215305-0	1-215306-0
20	50.80	48.26	2-215305-0	2-215306-0
36	91.44	88.90	3-215305-6	3-215306-6

Ordering Information: For intermediate number of positions, please combine dash numbers

Double Row

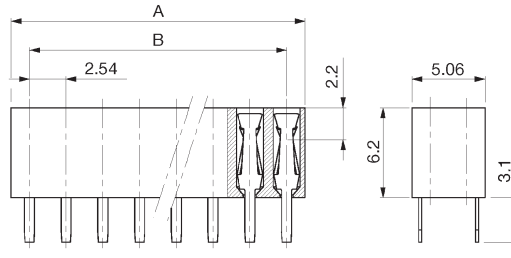
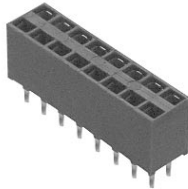

Material and Finish:

Housing—Polyester, glass filled, green UL 94V-0 rated

Contact Material—Phosphor bronze, plated as follows:

Plating A

Contact Zone—0.8 µm gold over 1.3 µm nickel

Soldering Zone—2.5 µm tin over 1.3 µm nickel

Plating B—2.5 µm tin

Technical Documents:

Product Specification
108-19056

No. of Positions	Dimensions		Part Numbers	
	A	B	Plating A	Plating B
2x2	5.08	2.54	215315-2	215316-2
2x3	7.62	5.08	215315-3	215316-3
2x4	10.16	7.62	215315-4	215316-4
2x5	12.70	10.16	215315-5	215316-5
2x6	15.24	12.70	215315-6	215316-6
2x7	17.78	15.24	215315-7	215316-7
2x8	20.32	17.78	215315-8	215316-8
2x9	22.86	20.32	215315-9	215316-9
2x10	25.40	22.86	1-215315-0	1-215316-0
2x20	50.80	48.26	2-215315-0	2-215316-0
2x36	91.44	88.90	3-215315-6	3-215316-6

Ordering Information: For intermediate number of positions, please combine dash numbers

HV-100 Receptacles, Vertical PCB Mount, Top or Bottom Entry

Single Row

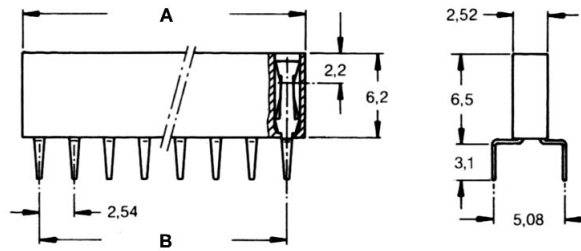
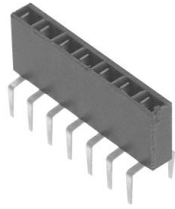

Material and Finish:

Housing—Polyester, glass filled, green UL 94V-0 rated

Contact Material—Phosphor bronze, plated as follows:

Plating A

Contact Zone—0.8 µm gold over 1.3 µm nickel

Soldering Zone—2.5 µm tin over 1.3 µm nickel

Plating B—2.5 µm tin

Technical Documents:

Product Specification
108-19056

No. of Positions	Dimensions		Part Numbers	
	A	B	Plating A	Plating B
2	5.08	2.54	829265-2	829575-2
3	7.62	5.08	829265-3	829575-3
4	10.16	7.62	829265-4	829575-4
5	12.70	10.16	829265-5	829575-5
6	15.24	12.70	829265-6	829575-6
7	17.78	15.24	829265-7	829575-7
8	20.32	17.78	829265-8	829575-8
9	22.86	20.32	829265-9	829575-9
10	25.40	22.86	1-829265-0	1-829575-0
20	50.80	48.26	2-829265-0	2-829575-0
36	91.44	88.90	3-829265-6	3-829575-6

Ordering Information: For intermediate number of positions, please combine dash numbers

Double Row

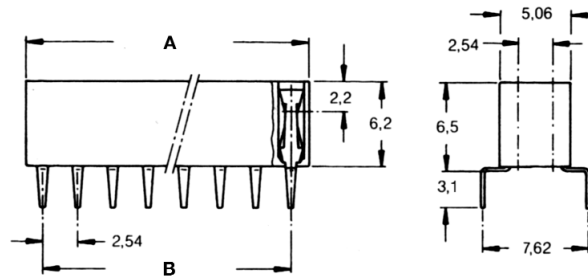
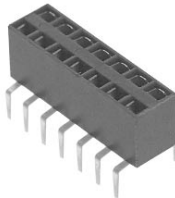

Material and Finish:

Housing—Polyester, glass filled, green UL 94V-0 rated

Contact Material—Phosphor bronze, plated as follows:

Plating A

Contact Zone—0.8 µm gold over 1.3 µm nickel

Soldering Zone—2.5 µm tin over 1.3 µm nickel

Plating B—2.5 µm tin

Technical Documents:

Product Specification
108-19056

No. of Positions	Dimensions		Part Numbers	
	A	B	Plating A	Plating B
2x2	5.08	2.54	829264-2	829576-2
2x3	7.62	5.08	829264-3	829576-3
2x4	10.16	7.62	829264-4	829576-4
2x5	12.70	10.16	829264-5	829576-5
2x6	15.24	12.70	829264-6	829576-6
2x7	17.78	15.24	829264-7	829576-7
2x8	20.32	17.78	829264-8	829576-8
2x9	22.86	20.32	829264-9	829576-9
2x10	25.40	22.86	1-829264-0	1-829576-0
2x20	50.80	48.26	2-829264-0	2-829576-0
2x36	91.44	88.90	3-829264-6	3-829576-6

Ordering Information: For intermediate number of positions, please combine dash numbers

HV-190 Receptacles, Horizontal PCB Mount, Side Entry, End Stackable

Single Row

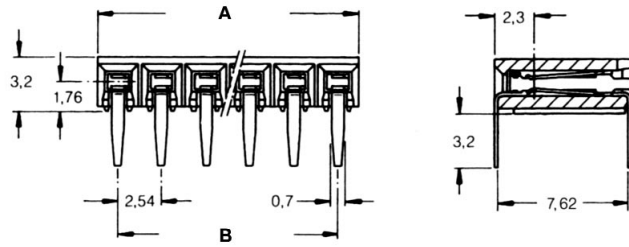
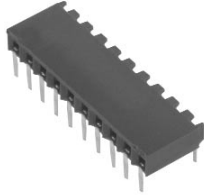

Material and Finish:

Housing—Polyester, glass filled, green UL 94V-0 rated

Contact Material—Phosphor bronze, plated as follows:

Plating A

Contact Zone—0.8 µm gold over 1.3 µm nickel

Soldering Zone—2.5 µm tin over 1.3 µm nickel

Plating B—2.5 µm tin

Technical Documents:

Product Specification
108-19072

No. of Positions	Dimensions		Part Numbers	
	A	B	Plating A	Plating B
2	5.08	2.54	216602-2	216601-2
3	7.62	5.08	216602-3	216601-3
4	10.16	7.62	216602-4	216601-4
5	12.70	10.16	216602-5	216601-5
6	15.24	12.70	216602-6	216601-6
7	17.78	15.24	216602-7	216601-7
8	20.32	17.78	216602-8	216601-8
9	22.86	20.32	216602-9	216601-9
10	25.40	22.86	1-216602-0	1-216601-0
20	50.80	48.26	2-216602-0	2-216601-0
36	91.44	88.90	3-216602-6	3-216601-6

Ordering Information: For intermediate number of positions, please combine dash numbers

Double Row

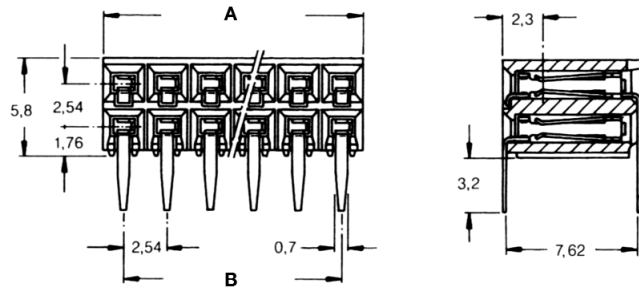
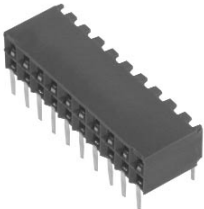

Material and Finish:

Housing—Polyester, glass filled, green UL 94V-0 rated

Contact Material—Phosphor bronze, plated as follows:

Plating A

Contact Zone—0.8 µm gold over 1.3 µm nickel

Soldering Zone—2.5 µm tin over 1.3 µm nickel

Plating B—2.5 µm

Technical Documents:

Product Specification
108-19072

No. of Positions	Dimensions		Part Numbers	
	A	B	Plating A	Plating B
2x2	5.08	2.54	216604-2	216603-2
2x3	7.62	5.08	216604-3	216603-3
2x4	10.16	7.62	216604-4	216603-4
2x5	12.70	10.16	216604-5	216603-5
2x6	15.24	12.70	216604-6	216603-6
2x7	17.78	15.24	216604-7	216603-7
2x8	20.32	17.78	216604-8	216603-8
2x9	22.86	20.32	216604-9	216603-9
2x10	25.40	22.86	1-216604-0	1-216603-0
2x20	50.80	48.26	2-216604-0	2-216603-0
2x36	91.44	88.90	3-216604-6	3-216603-6

Ordering Information: For intermediate number of positions, please combine dash numbers

HV-100 Surface Mount Receptacles, Vertical PCB Mount, Top or Bottom Entry, End Stackable

Single Row

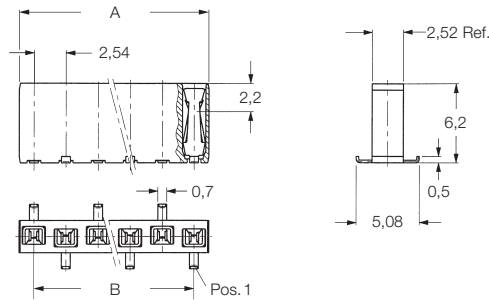

Material and Finish:

Housing and pick & place adapter—Liquid Crystal Polymer (LCP), black, UL 94V-0 rated

Contact Material—Phosphor bronze, plated as follows:

Plating A

Contact Zone—0.8 µm gold over 1.3 µm nickel

Soldering Zone—2.5 µm tin over 1.3 µm nickel

Plating B—2.5 µm tin

No. of Positions	Dimensions		Part Numbers		
	A	B	Tube Packaging	Blister Packaging	
			Plating A	Plating A	Plating B
3	7.62	5.08	966657-3	1241152-3	1355344-3
4	10.16	7.62	966657-4	1241152-4	1355344-4
5	12.70	10.16	966657-5	1241152-5	1355344-5
6	15.24	12.70	966657-6	1241152-6	1355344-6
7	17.78	15.24	966657-7	1241152-7	1355344-7
8	20.32	17.78	966657-8	1241152-8	1355344-8
9	22.86	20.32	966657-9	1241152-9	1355344-9
10	25.40	22.86	1-966657-0	1-1241152-0	1-1355344-0
11	27.94	25.40	1-966657-1	1-1241152-1	1-1355344-1
12	30.48	27.94	1-966657-2	1-1241152-2	1-1355344-2

Technical Documents:

Product Specification
108-19056

Double Row

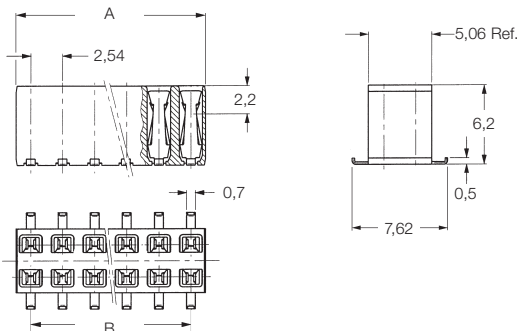

Material and Finish:

Housing and pick & place adapter—Liquid Crystal Polymer (LCP), black, UL 94V-0 rated

Contact Material—Phosphor bronze, plated as follows:

Plating A

Contact Zone—0.8 µm gold over 1.3 µm nickel

Soldering Zone—2.5 µm tin over 1.3 µm nickel

Plating B—2.5 µm tin

No. of Positions	Dimensions		Part Numbers		
	A	B	Tube Packaging	Blister Packaging	
			Plating A	Plating A	Plating B
2x2	5.08	2.54	966645-2	969973-2	1355347-2
2x3	7.62	5.08	966645-3	969973-3	1355347-3
2x4	10.16	7.62	966645-4	969973-4	1355347-4
2x5	12.70	10.16	966645-5	969973-5	1355347-5
2x6	15.24	12.70	966645-6	969973-6	1355347-6
2x7	17.78	15.24	966645-7	969973-7	1355347-7
2x8	20.32	17.78	966645-8	969973-8	1355347-8
2x9	22.86	20.32	966645-9	969973-9	1355347-9
2x10	25.40	22.86	1-966645-0	1-969973-0	1-1355347-0
2x20	50.80	48.26	2-966645-0	2-969973-0	2-1355347-0

Ordering Information: For intermediate number of positions, please combine dash numbers

Technical Documents:

Product Specification
108-19056

MOD II Surface Mount Compatible Headers, Shrouded, Straight

Single Row 0.63mm Round Post

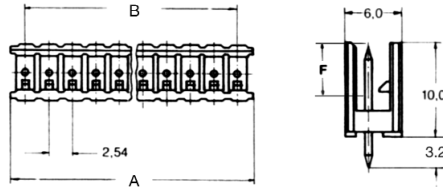

Material and Finish:

Housing—Polyester for high operating temp. (PCT), black, glass fibre filled

Posts—Phosphor bronze, (Plating A) or brass (Plating B) plated as follows:

Plating A

Contact Zone (Area F)—0.1 µm gold over 0.7 µm palladium alloy, over 1.3 µm nickel

Soldering Zone—2.0 µm min. tin over 1.3 µm nickel

Plating B—2.0 µm min. tin over 1.3 µm nickel

No. of Positions	Dimensions		F=4.4 Part Numbers	
	A	B	Plating A	Plating B
3	7.62	5.08	826467-3	827295-3
4	10.16	7.62	826467-4	827295-4
5	12.70	10.16	826467-5	827295-5
6	15.24	12.70	826467-6	827295-6
7	17.78	15.24	826467-7	827295-7
8	20.32	17.78	826467-8	827295-8
9	22.86	20.32	826467-9	827295-9
10	25.40	22.86	1-826467-0	1-827295-0
20	50.80	48.26	2-826467-0	2-827295-0
50	127.00	124.46	5-826467-0	5-827295-0

Ordering Information: For intermediate number of positions, please combine dash numbers

Technical Documents:

Product Specification

108-18012

Mateable Connectors

MOD IV Receptacles 926475

Double Row 0.63mm Round Post

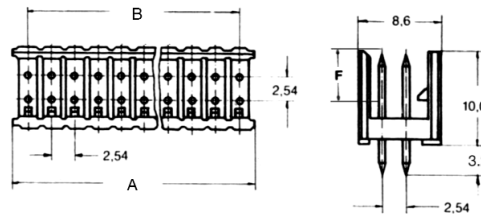
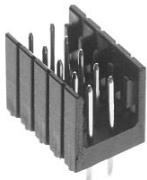

Material and Finish:

Housing—Polyester for high operating temp. (PCT), black, glass fibre filled

Posts—Phosphor bronze, (Plating A) or brass (Plating B) plated as follows:

Plating A

Contact Zone (Area F)—0.1 µm gold over 0.7 µm palladium alloy, over 1.3 µm nickel

Soldering Zone—2.0 µm min. tin over 1.3 µm nickel

Plating B—2.0 µm min. tin over 1.3 µm nickel

No. of Positions	Dimensions		F=4.4 Part Numbers	
	A	B	Plating A	Plating B
2x3	7.62	5.08	826469-3	827297-3
2x4	10.16	7.62	826469-4	827297-4
2x5	12.70	10.16	826469-5	827297-5
2x6	15.24	12.70	826469-6	827297-6
2x7	17.78	15.24	826469-7	827297-7
2x8	20.32	17.78	826469-8	827297-8
2x9	22.86	20.32	826469-9	827297-9
2x10	25.40	22.86	1-826469-0	1-827297-0
2x20	50.80	48.26	2-826469-0	2-827297-0
2x50	127.00	124.46	5-826469-0	5-827297-0

Ordering Information: For intermediate number of positions, please combine dash numbers

Technical Documents:

Product Specification

108-18012

Mateable Connectors

MOD IV Receptacles 926476

MOD II Surface Mount Compatible Headers, Shrouded, Right Angle

Single Row 0.63mm Round Post

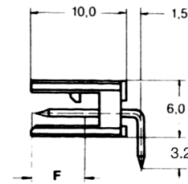
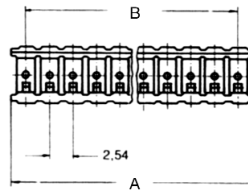
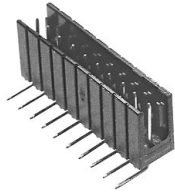

Material and Finish:

Housing—Polyester for high operating temp. (PCT), black, glass fibre filled

Posts—Phosphor bronze, (Plating A) or brass (Plating B) plated as follows:

Plating A

Contact Zone (Area F)—0.1 µm gold over 0.7 µm palladium alloy, over 1.3 µm nickel

Soldering Zone—2.0 µm min. tin over 1.3 µm nickel

Plating B—2.0 µm min. tin over 1.3 µm nickel

No. of Positions	Dimensions		F=4.4 Part Numbers	
	A	B	Plating A	Plating B
3	7.62	5.08	826468-3	827296-3
4	10.16	7.62	826468-4	827296-4
5	12.70	10.16	826468-5	827296-5
6	15.24	12.70	826468-6	827296-6
7	17.78	15.24	826468-7	827296-7
8	20.32	17.78	826468-8	827296-8
9	22.86	20.32	826468-9	827296-9
10	25.40	22.86	1-826468-0	1-827296-0
20	50.80	48.26	2-826468-0	2-827296-0
50	127.00	124.46	5-826468-0	5-827296-0

Ordering Information: For intermediate number of positions, please combine dash numbers

Technical Documents:

Product Specification

108-18012

Mateable Connectors

MOD IV Receptacles 926475

Double Row 0.63mm Round Post

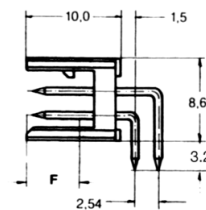
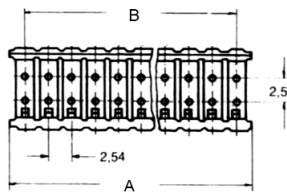
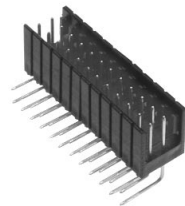

Material and Finish:

Housing—Polyester for high operating temp. (PCT), black, glass fibre filled

Posts—Phosphor bronze, (Plating A) or brass (Plating B) plated as follows:

Plating A

Contact Zone (Area F)—0.1 µm gold over 0.7 µm palladium alloy, over 1.3 µm nickel

Soldering Zone—2.0 µm min. tin over 1.3 µm nickel

Plating B—2.0 µm min. tin over 1.3 µm nickel

No. of Positions	Dimensions		F=4.4 Part Numbers	
	A	B	Plating A	Plating B
2x3	7.62	5.08	826470-3	827298-3
2x4	10.16	7.62	826470-4	827298-4
2x5	12.70	10.16	826470-5	827298-5
2x6	15.24	12.70	826470-6	827298-6
2x7	17.78	15.24	826470-7	827298-7
2x8	20.32	17.78	826470-8	827298-8
2x9	22.86	20.32	826470-9	827298-9
2x10	25.40	22.86	1-826470-0	1-827298-0
2x20	50.80	48.26	2-826470-0	2-827298-0
2x50	127.00	124.46	5-826470-0	5-827298-0

Ordering Information: For intermediate number of positions, please combine dash numbers

Technical Documents:

Product Specification

108-18012

Mateable Connectors

MOD IV Receptacles 926476

MOD IV Receptacle Housings

Single Row

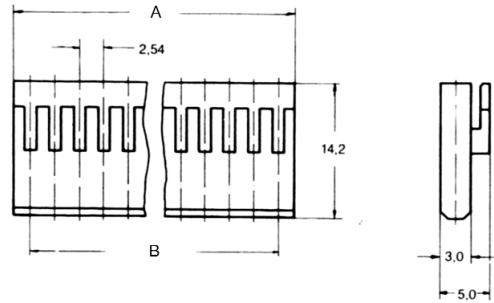
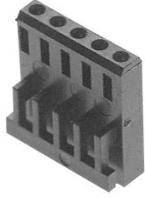

Material and Finish:

Housing—Polyester (PBT)
black, glass fibre filled

Technical Documents:

Product Specification

108-25007
108-25020
108-25021

Application Specification

114-25003

Mateable Connectors

MOD II Headers 827295
MOD II Headers 827296
MOD II Headers 826467
MOD II Headers 826468

No. of Positions	Dimensions		Part Numbers
	A	B	
3	7.62	5.08	926475-3
4	10.16	7.62	926475-4
5	12.70	10.16	926475-5
6	15.24	12.70	926475-6
7	17.78	15.24	926475-7
8	20.32	17.78	926475-8
9	22.86	20.32	926475-9
10	25.40	22.86	1-926475-0
20	50.80	48.26	2-926475-0
36	91.44	88.90	3-926475-6

Ordering Information: For intermediate number of positions, please combine dash numbers

Double Row

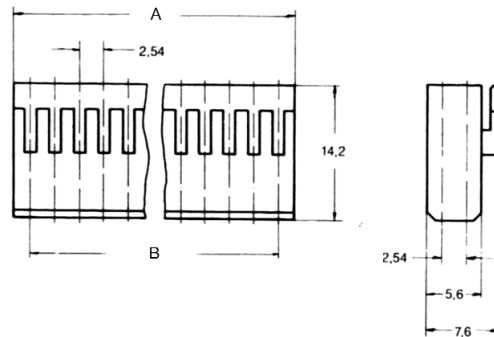
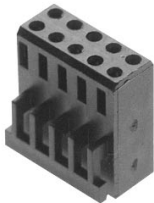

Material and Finish:

Housing—Polyester (PBT)
black, glass fibre filled

Technical Documents:

Product Specification

108-25007
108-25020
108-25021

Application Specification

114-25003

Mateable Connectors

MOD II Headers 827297
MOD II Headers 827298
MOD II Headers 826469
MOD II Headers 826470

No. of Positions	Dimensions		Part Numbers
	A	B	
2x2	5.08	2.54	926476-2
2x3	7.62	5.08	926476-3
2x4	10.16	7.62	926476-4
2x5	12.70	10.16	926476-5
2x6	15.24	12.70	926476-6
2x7	17.78	15.24	926476-7
2x8	20.32	17.78	926476-8
2x9	22.86	20.32	926476-9
2x10	25.40	22.86	1-926476-0
2x20	50.80	48.26	2-926476-0
2x36	91.44	88.90	3-926476-6

Ordering Information: For intermediate number of positions, please combine dash numbers

MOD IV Accessories for Receptacle Housings 926475 and 926476

Retention Plug with Strain Relief

Material and Finish:

Polycarbonate, glass fibre filled

Part Numbers	Colour
926478-1	Black
926478-2	Green
926478-3	Red

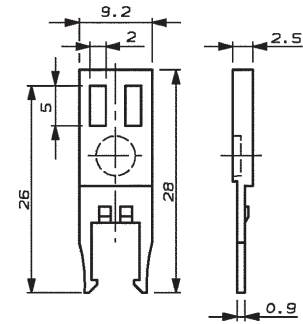

Retention Plug

Material:

Polycarbonate, glass fibre filled

Part Numbers	Colour
926477-1	Black
926477-2	Green
926477-3	Red

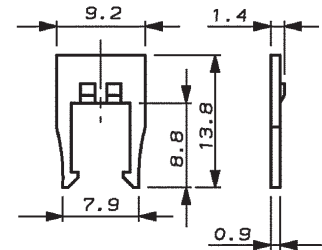

Keying Plug

Material:

Polyamide 6.6 glass fibre filled

Part Numbers	Colour
926498-1	Black
926498-2	Green
926498-3	Red

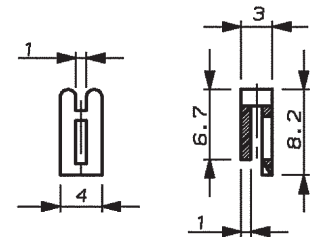

MOD IV Receptacle Housings

Single Row (with and without Strain Relief)



with Strain Relief

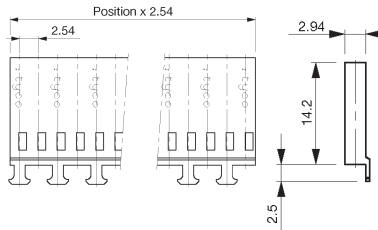

without Strain Relief

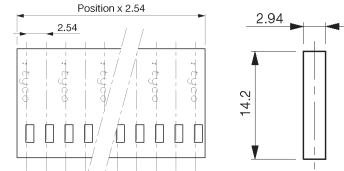

Material and Finish:

Green polyamide, 6.6 UL 94V-HB rated

Keying Plugs:

926519-2, Green
1-926519-2, Red

Technical Documents:

Product Specification

108-25007
108-25020
108-25021

Application Specification

114-25003

Mateable Connectors

MOD II Economy Line Breakaway
Pin Headers

No. of Positions	Part Numbers	
	With Strain Relief	Without Strain Relief
2	925369-2	925366-2
3	925369-3	925366-3
4	925369-4	925366-4
5	925369-5	925366-5
6	925369-6	925366-6
7	925369-7	925366-7
8	925369-8	925366-8
9	925369-9	925366-9
10	1-925369-0	1-925366-0
20	2-925369-0	2-925366-0
50	5-925369-0	5-925366-0

Ordering Information: For intermediate number of positions, please combine dash numbers

Double Row (with and without Strain Relief)

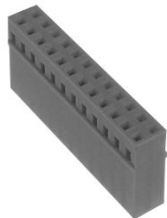

with Strain Relief

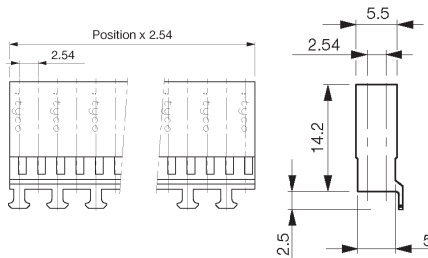

without Strain Relief

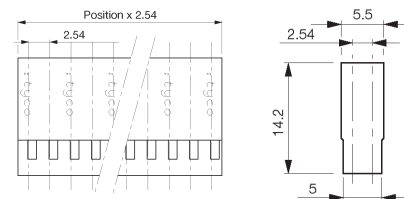

Material and Finish:

Green polyamide, 6.6 UL 94V-HB rated

Keying Plugs:

926519-2, Green
1-926519-2, Red

Technical Documents:

Product Specification

108-25007
108-25020
108-25021

Application Specification

114-25003

Mateable Connectors

MOD II Economy Line Breakaway
Pin Headers

No. of Positions	Part Numbers	
	With Strain Relief	Without Strain Relief
2x2	925370-2	925367-2
2x3	925370-3	925367-3
2x4	925370-4	925367-4
2x5	925370-5	925367-5
2x6	925370-6	925367-6
2x7	925370-7	925367-7
2x8	925370-8	925367-8
2x9	925370-9	925367-9
2x10	1-925370-0	1-925367-0
2x20	2-925370-0	2-925367-0
2x50	5-925370-0	5-925367-0

Ordering Information: For intermediate number of positions, please combine dash numbers

MOD IV/V Crimp Snap-In Receptacle Contacts, with Insulation Support, for use with MOD IV Receptacle Housings

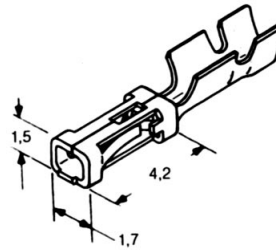

MOD IV Receptacle Contacts with Standard Contact Pressure

Material and Finish:

Body—Phosphor bronze, plated as follows:

Plating A—Selectively plated 0.8 µm gold on contact area, gold flash on crimp area, with entire contact underplated 1.3 µm nickel

Plating B—Selectively plated 0.8 µm gold on contact area, with gold flash over 1.3 µm nickel on entire contact

Plating C—Selectively plated 0.8 µm gold on contact area, tin plated on crimp area, with entire contact underplated 1.3 µm nickel

Plating D—Plated 2 µm tin

Wire Size Range mm ²	AWG	Insulation Dia. (Max) mm	Version	Part Numbers	
				Plating B	Plating A
0.032-0.09	32-28	1.2	Reel	167020-2	167020-1
			Loose Piece	167023-2	167023-1
0.2-0.56	24-20	1.4	Reel	167300-6	167300-8
			Loose Piece	141603-3	141603-4

* Consult Tyco Electronics for this wire size range

MOD IV Receptacle Contacts with Intermediate Contact Pressure

Wire Size Range mm ²	AWG	Insulation Dia. (Max) mm	Version	Part Numbers		
				Plating B	Plating A	Plating D
0.032-0.09	32-28	1.2	Reel	167021-2	167021-1	167021-3
			Loose Piece	167024-2	167024-1	167024-3
0.2-0.56	24-20	1.4	Reel	167301-4	2-167301-4	2-167301-2
			Loose Piece	141708-1	1-141708-2	1-141708-1

* Consult Tyco Electronics for this wire size range

Related Product Data:

Application Tooling

Hand Tool: 169481-1

Extraction Tool: 843473-1

Product Specification

108-25020

MOD IV Standard Contact Pressure

108-25021

MOD IV Intermediate Contact Pressure

108-25007

MOD V High Contact Pressure

Application Specification

114-25003

MOD V Receptacle Contacts with High Contact Pressure

Wire Size Range mm ²	AWG	Insulation Dia. (Max) mm	Version	Part Numbers		
				Plating B	Plating C	Plating D
0.032-0.09	32-28	1.2	Reel	167022-2	167022-1	167022-3
			Loose Piece	167025-2	167025-1	167025-3
0.2-0.56	24-20	1.4	Reel	166309-2	-	166309-3
			Loose Piece	166310-2	-	166310-3

* Consult Tyco Electronics for this wire size range

MOD II PCB Mount Receptacle Contacts

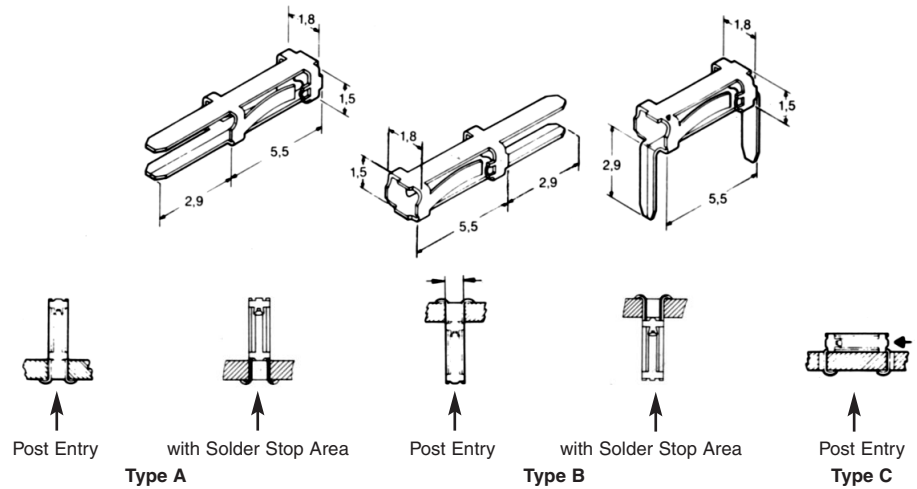

Material and Finish:

Phosphor Bronze

Technical Documents:

Application Specification
114-25004

Part Numbers							Finish (Contact Zone)
Type A		Type B		Type C			
On Reel	Loose Piece	On Reel	Loose Piece	On Reel	Loose Piece		
85861-3	—	—	—	85863-3	85866-3	Galvanised tin plated	
167651-1	—	167652-1	—	—	—	Tin plated with Solder Stop Area	
85861-4	—	—	85865-4	85863-4	85866-4	0.8µm Au over 1.3µm Ni	
141577-2	141577-4	141578-2	141578-4	141579-2	141579-4	Duplex 0.8µm Au over 1.3µm Ni*	

* In the duplex gold plated version, the rest of the receptacle is nickel plated, the solder tabs are tin plated

Keying Plug
Part Number 86286-1



MOD IV Shunt Connector

Shunt Connectors

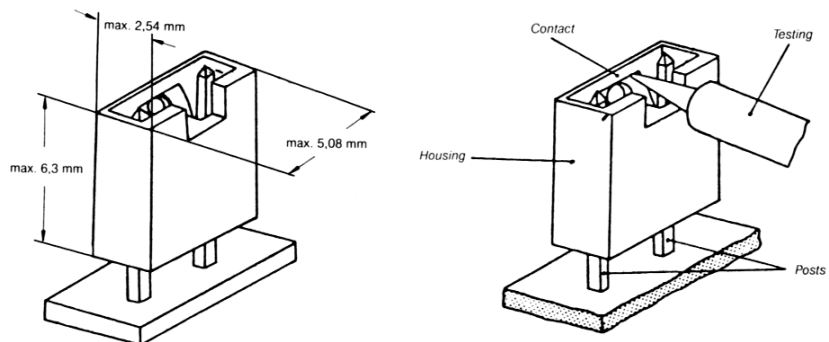
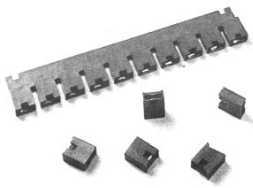

Material and Finish:

Housing—Thermoplastic Polyester
UL 94V-0 rated colour as below

Contact Material—Beryllium Copper

Plating A (green)—0.4 µm gold over
1.3 µm nickel

Plating B (green)—1 µm gold over
1.3 µm nickel

Plating C (black)—2.5 µm tin

	Part Numbers		
	Plating A	Plating B	Plating C
Strip Form	142270-1	142270-5	142270-3
Loose Piece	827914-1	—	827914-3

Product Facts

- Self retaining contact system
- Rapid installation
- Connection to 0.63 x 0.63 or 0.79 x 1.57mm posts
- Flame retardant
Thermoplastic housings are UL 94V-0 rated
- Tin or gold plated contacts

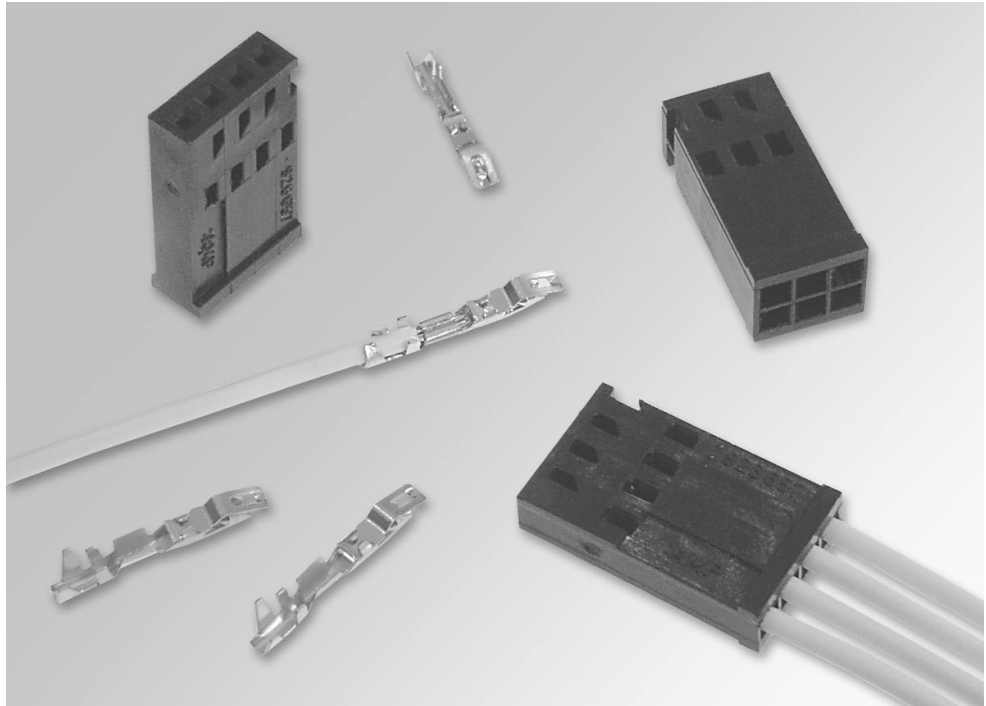

Performance Specifications:

Contact Current Rating—
3 A (0.63 x 0.63mm posts)
5 A (0.79 x 1.57mm posts)

Operating temperature—
-65 to +105°C (gold plating)
-65 to +85°C (tin plating)

Contact Resistance—
12mΩ max (gold plating)
16mΩ max (tin plating)

Insulation Resistance—
5000 MΩ min

Locking clip connectors provide reliable and secure low cost connection for a variety of applications. Designed to mate with 0.63mm x 0.63mm or 0.79mm x 1.57mm header posts, these connectors provide permanent connection integrity with quick connect/disconnect flexibility. Their self-retaining contacts allow rapid installation without the need for additional fastening to hold contacts and/or connector housings in place. When installed, locking clip connectors are positively locked and cannot be detached by pulling on the wires. Removal of a connector is however simply achieved by pulling directly on the housing, deflecting the contact springs within the connector and releasing the posts. For non-housed individual contacts, disconnection is achieved through the use of an inexpensive extraction tool.

AMPMODU Locking Clip Receptacle Housings

Available in single and double row variants, housings accept the range of locking clip contacts for secure connection of multiple circuits. Stackable open ended housings permit a number of connectors to be placed side by side without loss of pitch.

AMPMODU Locking Clip Receptacle Contacts

Suitable for installation into AMPMODU Locking Clip housings or for individual wire connection, contacts are offered for wire size ranges 20-30AWG (0.05mm² to 0.56mm²) and with a choice of gold or tin plating. Contact springs provide lasting high contact to post retention and are available in both loose piece, and reeled format for efficient volume production.

Locking Clip Receptacle Housings (For use with 0.63mm Square Posts)

Single Row

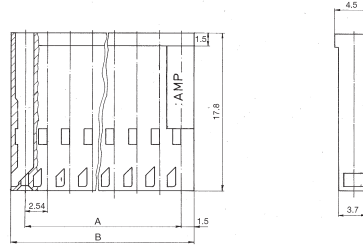

Material and Finish:

Housing—Thermoplastic Polyester
GV, Black, UL 94V-0 Rated

Related Product Data:

Product Specification
108-36028 & 108-36028-1

Application Specification
114-25006

Both Ends Closed Housings

Number of Cavities	Dimensions (mm)		Part Numbers
	B	A	
1	2.9	—	926010-1
2	5.5	2.54	926657-2
3	8.1	5.08	926657-3
4	10.6	7.62	926657-4
5	13.2	10.16	926657-5
6	15.7	12.70	926657-6
7	18.3	15.24	926657-7
8	20.8	17.78	926657-8
9	23.3	20.32	926657-9
10	25.9	22.86	1-926657-0
11	28.4	25.40	1-926657-1
12	30.9	27.94	1-926657-2
13	33.5	30.48	1-926657-3
14	36.0	33.02	1-926657-4
15	38.6	35.56	1-926657-5

Stackable Side Open Housings

Number of Cavities	Dimension (mm) A	Part Numbers
2	2.54	5-926657-2
3	5.08	5-926657-3
4	7.62	5-926657-4
5	10.16	5-926657-5
6	12.70	5-926657-6
7	15.24	5-926657-7
8	17.78	5-926657-8
9	20.32	5-926657-9
10	22.86	6-926657-0
11	25.40	6-926657-1
12	27.94	6-926657-2
13	30.48	6-926657-3
14	33.02	6-926657-4
15	35.56	6-926657-5

Double Row

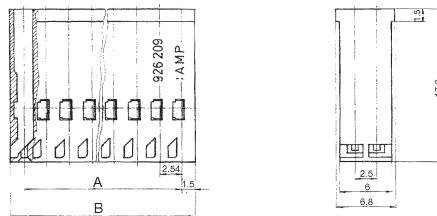

Material and Finish:

Housing—Thermoplastic Polyester
GV, Black, UL 94V-0 Rated

Related Product Data:

Product Specification
108-36028 & 108-36028-1

Application Specification
114-25006

Both Ends Closed Housings

Number of Cavities	Dimensions (mm)		Part Numbers
	B	A	
2x2	5.5	2.54	926209-2
2x3	8.1	5.08	926209-3
2x4	10.6	7.62	926209-4
2x5	13.2	10.16	926209-5
2x6	15.7	12.70	926209-6
2x7	18.3	15.24	926209-7
2x8	20.8	17.78	926209-8
2x9	23.3	20.32	926209-9
2x10	25.9	22.86	1-926209-0
2x11	28.4	25.40	1-926209-1
2x12	30.9	27.94	1-926209-2
2x13	33.5	30.48	1-926209-3
2x14	36.0	33.02	1-926209-4
2x15	38.6	35.56	1-926209-5

Stackable Side Open Housings

Number of Cavities	Dimension (mm) A	Part Numbers
2x3	5.08	5-926209-3
2x4	7.62	5-926209-4
2x5	10.16	5-926209-5
2x6	12.70	5-926209-6
2x7	15.24	5-926209-7
2x8	17.78	5-926209-8
2x9	20.32	5-926209-9
2x10	22.86	6-926209-0
2x11	25.40	6-926209-1
2x12	27.94	6-926209-2
2x13	30.48	6-926209-3
2x14	33.02	6-926209-4
2x15	35.56	6-926209-5

Keying Plug Part Number 926329-1

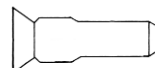

Locking Clip Receptacle Contacts (For use with 0.63mm Square Posts)

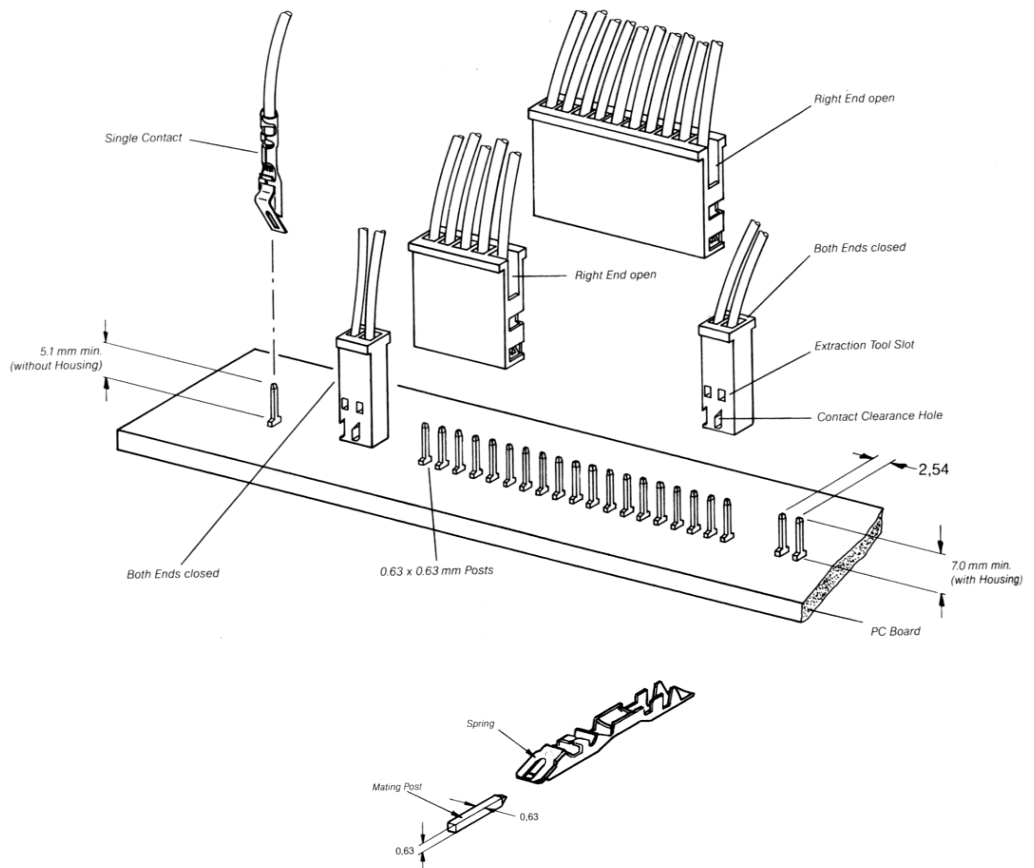

Material and Finish:

Contact Spring—Stainless Steel

Contact Material—Phosphor Bronze

Plating A—Selectively plated 0.8 µm gold on contact area, with gold flash over 1.3 µm nickel on entire contact

Plating B—2.5 µm tin over 1.3 µm nickel on entire contact

Wire Size Range		Insulation Diameter mm	Finish	Part Numbers		Hand Tool
AWG	mm ²			On Reel	Loose Piece	
30-28	0.05-0.09	0.7-1.0	Plating A	5-87190-1	5-87191-1	656075-1
			Plating B	5-87190-2	5-87191-2	
26-22	0.12-0.40	1.0-1.6	Plating A	5-87124-1	5-87165-1	656075-1
			Plating B	5-87124-2	5-87165-2	
20	0.5-0.6	1.0-1.6	Plating A	5-867052-2	—	656075-1
			Plating B	5-867052-1	—	

Related Product Data:

Product Specification

108-36028 & 108-36028-1

Application Specification

114-25006



Extraction Tool
Part No. 91084-1

Locking Clip Receptacle Housings (For use with 0.79mm x 1.57mm Square Posts)

Single Row

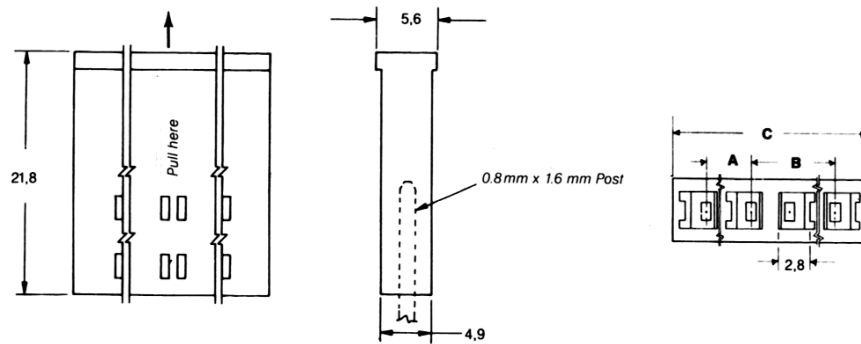

Material and Finish:

Housing Material—Polyamide GV, Black, UL 94V-0 Rated

Related Product Data:

Product Specification
108-36029

Application Specification

114-25008

No. of Positions	Dimensions			Part Numbers
	A	B	C	
1	—	—	5.08	87270-1
2	—	—	9.55	87270-2
3	3.96	3.96	13.51	1-87270-3
4	3.96	7.92	17.48	87270-4
5	7.92	7.92	21.44	1-87270-4
6	7.92	11.90	25.40	87270-5
7	11.90	11.90	29.36	1-87270-5
8	11.90	15.84	33.32	87270-6
9	15.84	15.84	37.28	1-87270-6
10	15.84	19.81	41.24	87270-7

Locking Clip Receptacle Contacts (For use with 0.79mm x 1.57mm Square Posts)

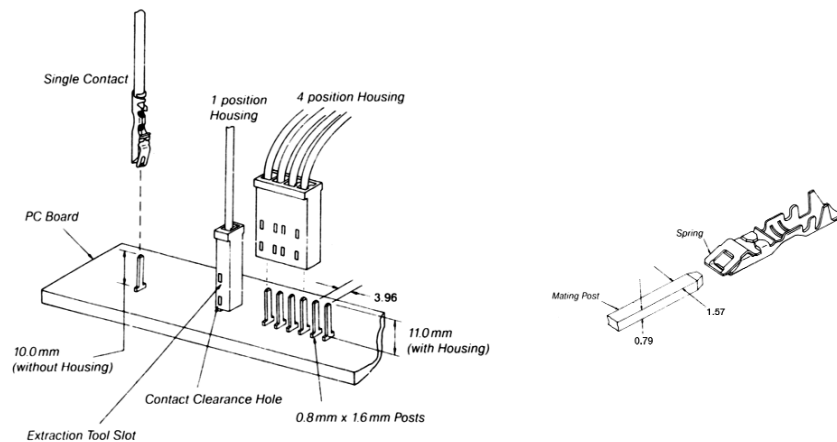

Material and Finish:

Contact Spring—Stainless Steel
Contact Material—Phosphor Bronze
Plating A—Selectively plated 0.4 µm gold on contact area, with gold flash over 1.3 µm nickel on entire contact
Plating B—2.5 µm tin over 1.3 µm nickel on entire contact

Related Product Data:

Product Specification
108-36029

Application Specification

114-25008

Wire Size Range		Insulation Diameter mm	Finish	Part Numbers		Hand Tool
AWG	mm ²			On Reel	Loose Piece	
22-18	0.3-0.9	1.3-2.5	Plating A	5-87269-2	5-87278-2	90308-1
			Plating B	5-87269-1	5-87278-1	

Extraction Tool
Part No. 91104-1



Product Facts

- Receptacle assemblies preloaded with Insulation Displacement Contacts (IDC) to terminate discrete wires or 2.54 mm centerline ribbon cables
- Receptacle housings receive crimp snap-in contacts to terminate discrete wires (straight exit)
- Headers provided for straight or right-angle mounting to be soldered onto 1.6 mm thick printed circuit boards
- Protective header shrouds feature an integrated detent latching device
- Compliant to the CEI IEC 603-8 International Standard

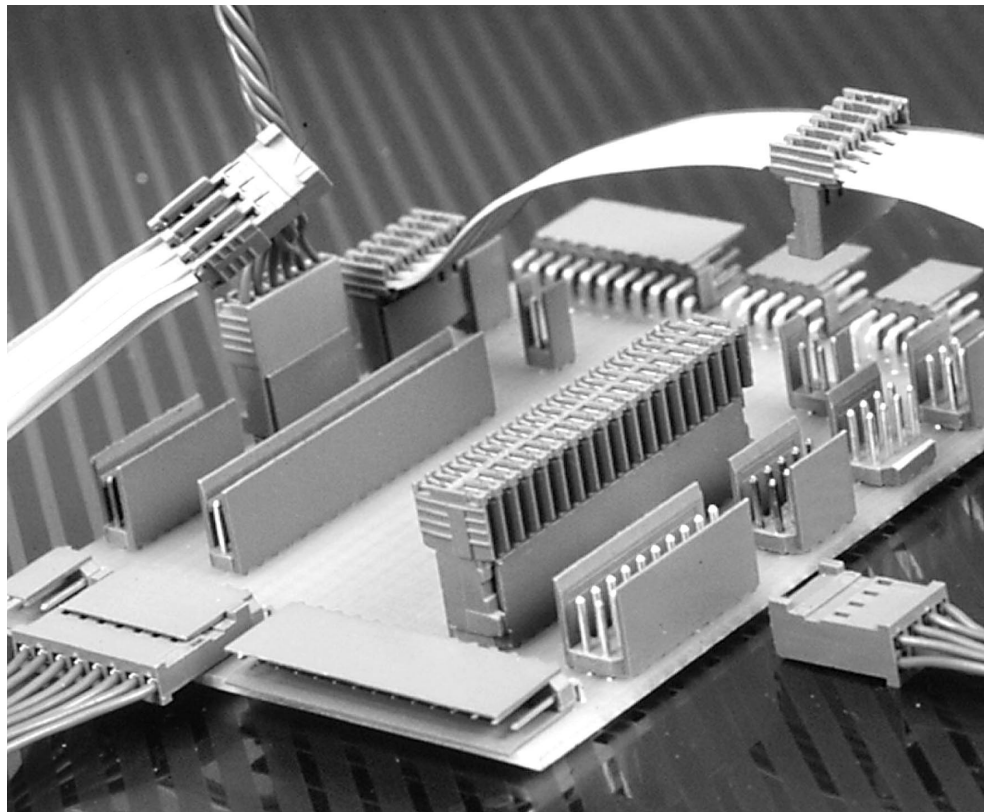

Performance Specifications:

Electrical

Contact Current Rating—
3 A max at 20°C

Contact Termination Resistance—
20 mΩ max (HE 13)
30 mΩ max (HE 14)

Dielectric Withstanding Voltage—
1000 V rms (HE 13)
500 V rms (HE 14)

Insulation Resistance—
5,000 megaohms (HE 13)
1,000 megaohms (HE 14)

Environmental

Operating Temperature—
-55°C to +125°C (HE13)
-40°C to +100°C (HE14)

Mechanical

Durability—
400 cycles (HE 13)
30 cycles (HE 14)

Insertion/Withdrawal Force—
1.5 N max per contact + latching force
(HE 13)
3 N max per contact + latching force
(HE 14)

A multi-contact connector range designed to reliably meet today's interconnection requirements for signal transmission in a variety of computer, telecommunications and industrial applications.

Complying fully with the CEI IEC 603-8 international standard, this wire-to-board interconnection system is composed of IDC receptacle assemblies for discrete wires or ribbon cable, receptacle housings for crimp snap-in receptacle contacts and 2.54mm pitch vertical or right-angle shrouded and polarised board-mount headers.

All products are available with a choice of gold (HE13) or tin (HE14) plating finishes.

IDC Receptacle Assembly, Right-Angle

Single Row

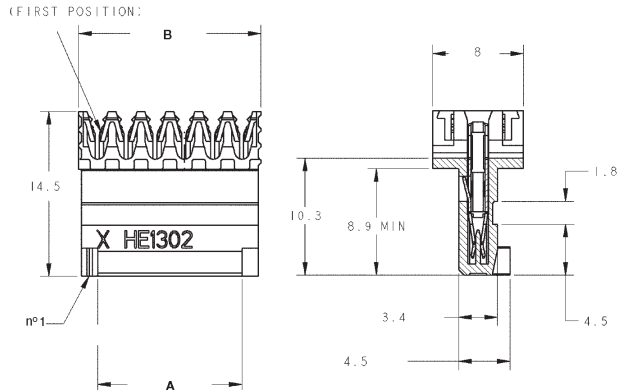
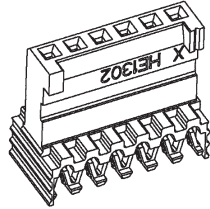
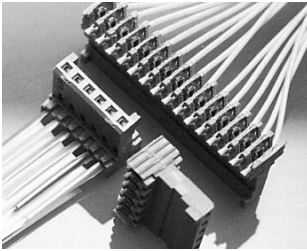

Material and Finish:

Housing—Blue flame retardant glass filled polyester, UL 94V-0 rated

IDC Contact—Phosphor bronze, plated as follows:

HE13—Selectively plated 0.4 µm gold on contact area, 0.8 µm tin min on termination area with entire contact under-plated 1.3 µm nickel

HE14—Plated 1µm min. tin

Technical Documents:

Product Specification
108-15053

Application Specification:
114-15030

HE13

No. of Positions	Dimensions A B		Part Numbers			
			26 AWG		24 AWG	
			Tube	Loose Piece	Tube	Loose Piece
2	2.54	5.88	281712-2	144274-2	281709-2	144273-2
3	5.08	8.42	281712-3	144274-3	281709-3	144273-3
4	7.62	10.96	281712-4	144274-4	281709-4	144273-4
5	10.16	13.50	281712-5	144274-5	281709-5	144273-5
6	12.70	16.04	281712-6	144274-6	281709-6	144273-6
7	15.24	18.58	281712-7	144274-7	281709-7	144273-7
8	17.78	21.12	281712-8	144274-8	281709-8	144273-8
10	22.86	26.20	1-281712-0	1-144274-0	1-281709-0	1-144273-0
12	27.94	31.28	1-281712-2	1-144274-2	1-281709-2	1-144273-2
15	35.56	38.90	1-281712-5	1-144274-5	1-281709-5	1-144273-5
18	43.18	46.52	1-281712-8	1-144274-8	1-281709-8	1-144273-8

Receptacles for 28 AWG Wire available on request

HE14

No. of Positions	Dimensions A B		Part Numbers			
			26 AWG		24 AWG	
			Tube	Loose Piece	Tube	Loose Piece
2	2.54	5.88	281711-2	144271-2	281708-2	144270-2
3	5.08	8.42	281711-3	144271-3	281708-3	144270-3
4	7.62	10.96	281711-4	144271-4	281708-4	144270-4
5	10.16	13.50	281711-5	144271-5	281708-5	144270-5
6	12.70	16.04	281711-6	144271-6	281708-6	144270-6
7	15.24	18.58	281711-7	144271-7	281708-7	144270-7
8	17.78	21.12	281711-8	144271-8	281708-8	144270-8
10	22.86	26.20	1-281711-0	1-144271-0	1-281708-0	1-144270-0
12	27.94	31.28	1-281711-2	1-144271-2	1-281708-2	1-144270-2
15	35.56	38.90	1-281711-5	1-144271-5	1-281708-5	1-144270-5
18	43.18	46.52	1-281711-8	1-144271-8	1-281708-8	1-144270-8

Receptacles for 28 AWG Wire available on request

IDC Receptacle Assembly, Straight

Single Row

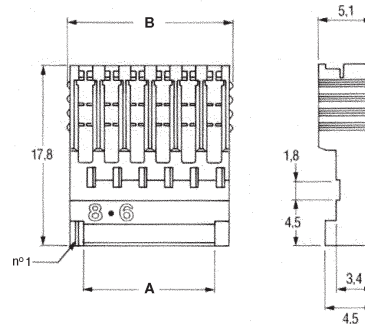
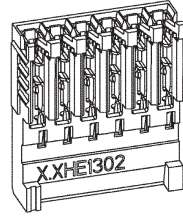
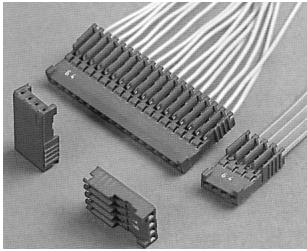

Material and Finish:

Housing—Blue flame retardant glass filled polyester, UL 94V-0 rated

IDC Contact—Phosphor bronze, plated as follows:

HE13—Selectively plated 0.4 µm gold on contact area, 0.8 µm tin min on termination area with entire contact under-plated 1.3 µm nickel

HE14—Plated 1µm min. tin

Technical Documents:

Product Specification
108-15053

Application Specification:
114-15031

No. of Positions	Dimensions		Part Numbers			
			HE13		HE14	
			28-26 AWG Loose Piece	26-24 AWG Loose Piece	28-26 AWG Loose Piece	26-24 AWG Loose Piece
2	2.54	5.88	281787-2	281784-2	281786-2	281783-2
3	5.08	8.42	281787-3	281784-3	281786-3	281783-3
4	7.62	10.96	281787-4	281784-4	281786-4	281783-4
5	10.16	13.50	281787-5	281784-5	281786-5	281783-5
6	12.70	16.04	281787-6	281784-6	281786-6	281783-6
8	17.78	21.12	281787-8	281784-8	281786-8	281783-8
10	22.86	26.20	1-281787-0	1-281784-0	1-281786-0	1-281783-0
12	27.94	31.28	1-281787-2	1-281784-2	1-281786-2	1-281783-2
15	35.56	38.90	1-281787-5	1-281784-5	1-281786-5	1-281783-5
18	43.18	46.52	1-281787-8	1-281784-8	1-281786-8	1-281783-8

Double Row

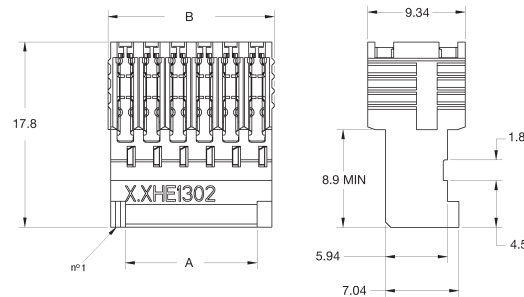
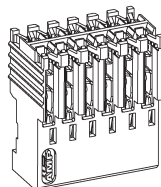
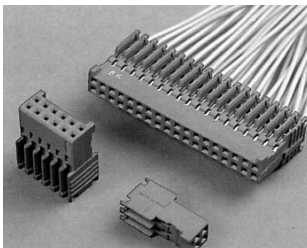

Material and Finish:

Housing—Blue flame retardant glass filled polyester, UL 94V-0 rated

IDC Contact—Phosphor bronze, plated as follows:

HE13—Selectively plated 0.4 µm gold on contact area, 0.8 µm tin min on termination area with entire contact under-plated 1.3 µm nickel

HE14—Plated 1µm min. tin

Technical Documents:

Product Specification
108-15053

Application Specification:
114-15031

No. of Positions	Dimensions		Part Numbers			
			HE13		HE14	
			28-26 AWG Loose Piece	26-24 AWG Loose Piece	28-26 AWG Loose Piece	26-24 AWG Loose Piece
2x2	2.54	5.88	281793-2	281790-2	281792-2	281789-2
2x3	5.08	8.42	281793-3	281790-3	281792-3	281789-3
2x4	7.62	10.96	281793-4	281790-4	281792-4	281789-4
2x5	10.16	13.50	281793-5	281790-5	281792-5	281789-5
2x6	12.70	16.04	281793-6	281790-6	281792-6	281789-6
2x8	17.78	21.12	281793-8	281790-8	281792-8	281789-8
2x10	22.86	26.20	1-281793-0	1-281790-0	1-281792-0	1-281789-0
2x12	27.94	31.28	1-281793-2	1-281790-2	1-281792-2	1-281789-2
2x15	35.56	38.90	1-281793-5	1-281790-5	1-281792-5	1-281789-5
2x18	43.18	46.52	1-281793-8	1-281790-8	1-281792-8	1-281789-8

Shrouded Headers, Straight

Straight 0.63 mm Square Post

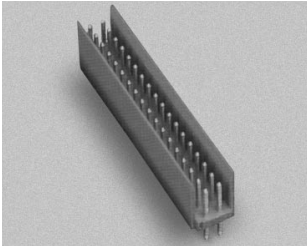

Material and Finish:

Housing—Blue flame retardant glass filled polyester, UL 94V-0 rated

Posts—Phosphor bronze, plated as follows:

HE13—Selectively plated 0.4 µm gold on contact area, gold flash on insertion area, 2.5 µm tin min on solder tail with entire post underplated 1.3 µm nickel

HE14—Tin plated min. 2.5 µm on solder area, with entire post tin plated 0.8 µm over 0.8 µm nickel

Technical Documents:

Product Specification
108-15053

Single-Row

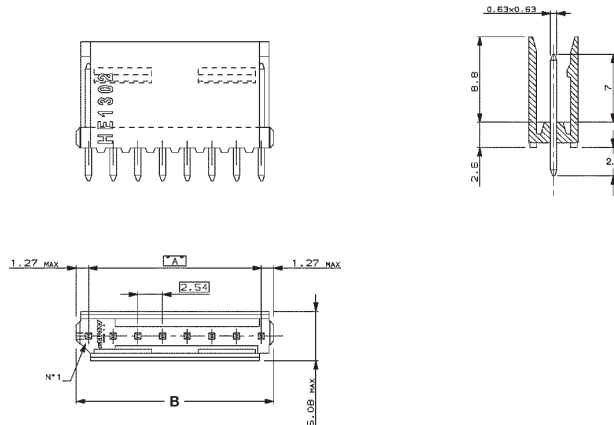

Double-Row

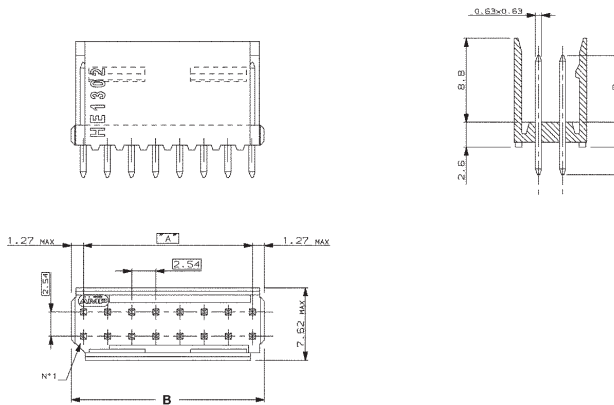

No. of Positions	Dimensions		Single-Row		Double-Row	
	A	B	Type / Part Numbers		Type / Part Numbers	
			HE13	HE14	HE13	HE14
2	2.54	5.08	281696-2	281695-2	281740-2	281739-2
3	5.08	7.62	281696-3	281695-3	281740-3	281739-3
4	7.62	10.16	281696-4	281695-4	281740-4	281739-4
5	10.16	12.70	281696-5	281695-5	281740-5	281739-5
6	12.70	15.24	281696-6	281695-6	281740-6	281739-6
7	15.24	17.78	281696-7	281695-7	—	—
8	17.78	20.32	281696-8	281695-8	281740-8	281739-8
10	22.86	25.40	1-281696-0	1-281695-0	1-281740-0	1-281739-0
12	27.94	30.48	1-281696-2	1-281695-2	1-281740-2	1-281739-2
13	30.48	33.82	—	—	1-281740-3	1-281739-3
15	35.56	38.10	1-281696-5	1-281695-5	1-281740-5	1-281739-5
17	40.64	43.18	1-281696-7	1-281695-7	1-281740-7	1-281739-7
18	43.18	45.72	1-281696-8	1-281695-8	1-281740-8	1-281739-8
20	48.26	50.80	—	—	2-281740-0	2-281739-0

Shrouded Headers, Right Angle

Right-Angle 0.63 mm Square Post

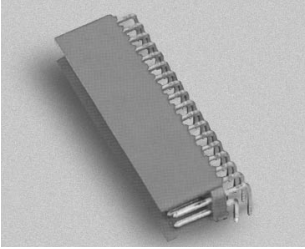

Material and Finish:

Housing—Blue flame retardant glass filled polyester, UL 94V-0 rated

Posts—Phosphor bronze, plated as follows:

HE13—Selectively plated 0.4 µm gold on contact area, gold flash on insertion area, 2.5 µm tin min on solder tail with entire post underplated 1.3 µm nickel

HE14—Tin plated min. 2.5 µm on solder area, with entire post tin plated 0.8 µm over 0.8 µm nickel

Technical Documents:

Product Specification
108-15053

Single-Row

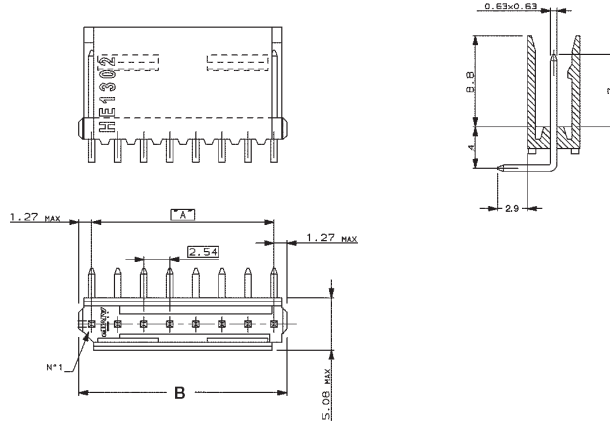

Double-Row

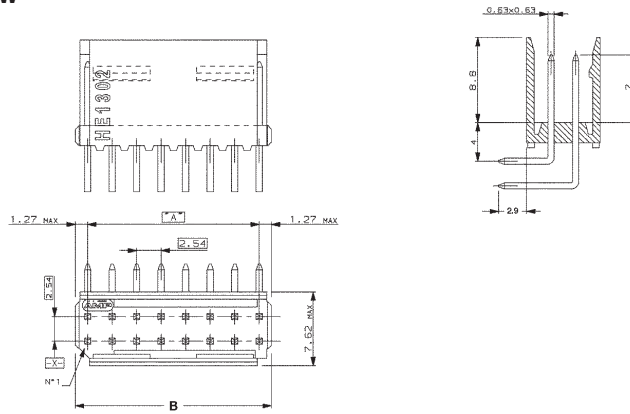

No. of Positions	Dimensions		Single Row		Double-Row	
			Type / Part Numbers		Type / Part Numbers	
			HE13	HE14	HE13	HE14
2	2.54	5.08	281699-2	281698-2	281743-2	281742-2
3	5.08	7.62	281699-3	281698-3	281743-3	281742-3
4	7.62	10.16	281699-4	281698-4	281743-4	281742-4
5	10.16	12.70	281699-5	281698-5	281743-5	281742-5
6	12.70	15.24	281699-6	281698-6	281743-6	281742-6
7	15.24	17.78	281699-7	281698-7	—	—
8	17.78	20.32	281699-8	281698-8	281743-8	281742-8
10	22.86	25.40	1-281699-0	1-281698-0	1-281743-0	1-281742-0
12	27.94	30.48	1-281699-2	1-281698-2	1-281743-2	1-281742-2
13	30.48	33.82	—	—	1-281743-3	1-281742-3
15	35.56	38.10	1-281699-5	1-281698-5	1-281743-5	1-281742-5
17	40.64	43.18	1-281699-7	1-281698-7	1-281743-7	1-281742-7
18	43.18	45.72	1-281699-8	1-281698-8	1-281743-8	1-281742-8
20	48.26	50.80	—	—	2-281743-0	2-281742-0

Receptacle Housings

Single & Double Row Receptacle Housings

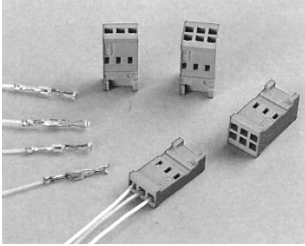

Material and Finish:

Housing—Blue flame retardant glass filled polyester, UL 94V-0 rated

Technical Documents:

Product Specification
108-15053

Single Row

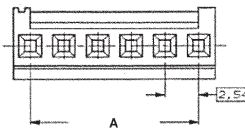
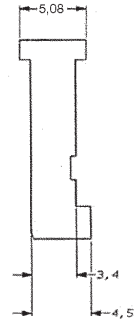
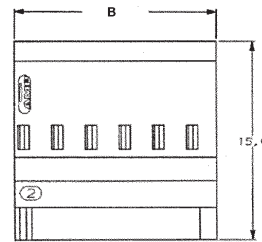
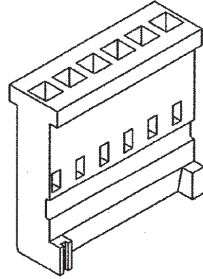

Double Row

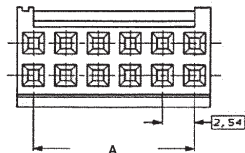
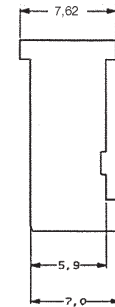
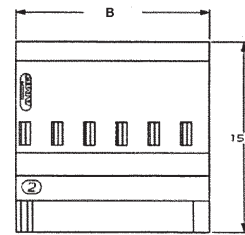
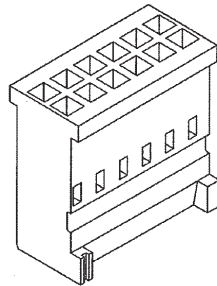

No. of Positions	Dimensions		Part Numbers	
	A	B	Single Row	Double Row
3	5.08	7.62	281838-3	281839-3
4	7.62	10.16	281838-4	281839-4
5	10.16	12.70	281838-5	281839-5
6	12.70	15.24	281838-6	281839-6
7	15.24	17.78	281838-7	281839-7
8	17.78	20.32	281838-8	281839-8
9	20.32	22.86	281838-9	281839-9
10	22.86	25.40	1-281838-0	1-281839-0
12	27.94	30.48	1-281838-2	1-281839-2
14	33.02	35.56	1-281838-4	-
15	35.56	38.10	1-281838-5	1-281839-5
18	43.18	45.72	1-281838-8	1-281839-8

Crimp Snap-In Receptacle Contacts, with Insulation Support

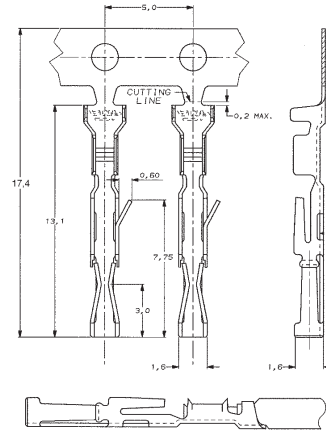

Material and Finish:

Phosphor bronze, plated as follows:
HE13—Selectively plated 0.8 µm gold on contact area, 2.5 µm tin on crimp area, with entire contact underplated 1.3 µm nickel
HE14—Plated 2.5 µm tin

Wire Size Range mm ²	AWG	Insulation Diameter mm	Plating	Part Numbers		Hand Tool
				Strip Form	Loose Piece	
0.22-0.08	24-28	1.5-0.8	HE 13	188746-1	182734-3	947679-1
			HE 14	188744-1	182734-2	

Technical Documents:

Product Specification
108-15053

Part Number Index

Part Number	Page Number	Part Number	Page Number	Part Number	Page Number	Part Number	Page Number	Part Number	Page Number
58535	14	182206	14	280509	17	281331	15	826658	20
58654	14	182207	14	280510	18	281332	15	826662	21
85861	38	182734	49	280511	18	281333	16	826664	21
85863	38	188744	49	280512	12	281334	16	826853	9
85865	38	188746	49	280513	12	281336	16	826925	20
85866	38	215297	26	280514	12	281339	15	826926	20
86181	7	215298	26	280515	12	281340	15	826936	20
86286	15, 16, 38	215299	26	280520	17	281342	15	826938	20
86557	14	215300	26	280521	17	281349	15	826942	20
86561	14	215301	27	280522	18	281350	15	826944	20
87077	12	215302	27	280523	18	281351	15	826947	21
87116	6	215303	27	280530	14	281352	15	826949	21
87124	41	215304	27	280578	16	281353	15	826951	21
87165	41	215305	28	280579	16	281423	6	826953	21
87190	41	215306	28	280580	16	281556	14	826955	21
87191	41	215307	26	280581	16	281695	46	826957	21
87269	42	215308	26	280582	16	281696	46	827295	32
87270	42	215309	26	280583	16	281698	47	827296	33
87278	42	215310	26	280585	16	281699	47	827297	32
88048	14	215311	27	280586	16	281708	44	827298	33
90308	42	215312	27	280590	6	281709	44	827312	22
91084	41	215313	27	280591	6	281711	44	827313	22
91104	42	215314	27	280592	6	281712	44	827914	38
141002	7	215315	28	280593	6	281739	46	828213	22
141003	7	215316	28	280594	6	281740	46	828214	22
141004	7	216601	30	280595	6	281742	47	829094	26
141007	7	216602	30	280609	8	281743	47	829095	26
141008	7	216603	30	280610	8	281783	45	829264	29
141009	7	216604	30	280611	8	281784	45	829265	29
141577	38	280358	12	280612	8	281786	45	829410	26
141578	38	280359	12	280613	8	281787	45	829411	26
141579	38	280360	12	280614	8	281789	45	829575	29
141584	7	280361	12	280615	8	281790	45	829576	29
141585	7	280362	12	280616	8	281792	45	843473	6, 37
141586	7	280363	12	280617	8	281793	45	867052	41
141588	7	280364	12	280618	8	281838	48	925366	36
141589	7	280365	12	280619	8	281839	48	925367	36
141590	7	280366	12	280620	8	281999	14	925369	36
141603	37	280368	12	280621	6	282790	18	925370	36
141708	37	280369	12	280628	13	282792	12	926010	40
142165	7	280370	17	280629	13	284123	12	926209	40
142166	7	280371	17	280630	13	284124	18	926329	40
142270	38	280372	17	280631	13	656075	41	926475	34
144270	44	280373	17	280632	13	825433	22	926476	34
144271	44	280374	17	280633	13	825434	22	926477	35
144273	44	280375	17	280634	13	825435	22	926478	35
144274	44	280376	17	280635	13	825437	23	926498	35
166309	37	280377	18	280637	13	825440	22	926519	36
166310	37	280378	18	280638	13	825457	23	926657	40
167020	37	280379	18	280640	13	826467	32	947679	49
167021	37	280380	18	280702	6	826468	33	966572	25
167022	37	280381	18	280708	14	826469	32	966573	25
167023	37	280382	18	280709	14	826470	33	966574	25
167024	37	280383	18	280836	15	826539	9	966575	25
167025	37	280384	17	280851	15	826576	9	966645	31
167300	37	280385	17	280922	15	826629	20	966657	31
167301	37	280387	17	281018	12	826631	21	969973	31
167651	38	280388	17	281019	17	826632	20	1241050	24
167652	38	280389	18	281021	18	826634	21	1241150	24
169481	37	280390	18	281215	15	826646	20	1241152	31
181270	14	280392	18	281216	15	826648	20	1285002	6
181271	14	280393	18	281218	16	826652	21	1355344	31
181299	6	280422	14	281327	15	826654	21	1355347	31
182198	6	280508	17	281328	15	826656	20		

Engineering Notes



Americas

Argentina - Buenos Aires
Phone: +54-1-733-2000
Fax: +54-1-717-0988

Brazil - São Paulo
Phone: +55-11-3611-1311
Fax: +55-11-3611-0397

Canada - Toronto
Phone: +905-475-6222
Fax: +905-474-5520

Chile - Santiago
Phone: +56-2-739-1230
Fax: +56-2-739-1227

Columbia - Bogota
Phone: +57-1-231-9398
Fax: +57-1-240-3769

Mexico - Mexico City
Phone: +52-5-729-0400
Fax: +52-5-361-8545

United States - Harrisburg, PA
Phone: +1-717-564-0100
Fax: +1-717-986-7575

Customer Service:
Phone: +1-800-522-6752

Venezuela - Caracas
Phone: +58-2-986-7774
Fax: +58-2-986-9739

For Latin/South American Countries not shown
Phone: +54-11-4733-2015
Fax: +54-11-4733-2083

Asia/Pacific

Australia - Sydney
Phone: +61-2-9554-2600
Fax: +61-2-9502-2556

India - Bangalore
Phone: +91-80-2854-0800
Fax: +91-80-2854-0820

Indonesia - Jakarta
Phone: +62-21-526-7852
Fax: +62-21-526-7856

Japan - Kawasaki, Kanagawa
Phone: +81-44-844-8111
Fax: +81-44-812-3207

Korea - Seoul
Phone: +82-2-3415-4500
Fax: +82-2-3486-3810

Malaysia - Selangor
Phone: +60-3-7805-3055
Fax: +60-3-7805-3066

New Zealand - Auckland
Phone: +64-9-634-4580
Fax: +64-9-634-4586

Philippines - Makati City
Phone: +632-867-8641
Fax: +632-867-8661

People's Republic of China
Hong Kong
Phone: +852-2735-1628
Fax: +852-2735-0243

Shanghai
Phone: +86-21-5383-8188
Fax: +86-21-5383-8018

Shunde
Phone: +86-765-775-1368
Fax: +86-765-775-2823

Singapore - Singapore
Phone: +65-480-4525
Fax: +65-482-1012

Taiwan - Taipei
Phone: +886-2-2664-9977
Fax: +886-2-2664-9900

Thailand - Bangkok
Phone: +66-2-955-0500
Fax: +66-2-955-0505

Vietnam - Ho Chi Minh City
Phone: +84-8-930-4547
Fax: +84-8-930-3443

Europe/Middle East/Africa

Austria - Vienna
Phone: +43-1-90-560-0
Fax: +43-1-90-560-1333

Belgium - Kessel-Lo
Phone: +32-16-352-300
Fax: +32-16-352-352

Bulgaria - Sofia
Phone: +359-2-971-2152
Fax: +359-2-971-2153

Czech Republic - Kurim
Phone: +420-5-41-162-111
Fax: +420-5-41-162-223

Denmark - Viby J
Phone: +45-70-15-52-00
Fax: +45-86-29-51-33

Egypt - Cairo
Phone: +20-2-417-76-47
Fax: +20-2-419-23-34

Estonia - Tallinn
Phone: +372-65-05-474
Fax: +372-65-05-470

Finland - Helsinki
Phone: +358-95-12-34-20
Fax: +358-95-12-34-205

France - Cergy-Pontoise Cedex
Phone: +33-1-3420-8888
Fax: +33-1-3420-8600

Product Information Centre:
Phone: +33-1-3420-8686
Fax: +33-1-3420-8623

Tyco Electronics Export -
Cergy-Pontoise Cedex
Phone: +33-1-3420-8888
Fax: +33-1-3420-8600

Germany - Bensheim
Phone: +49-6251-133-0
Fax: +49-6251-133-1600

Product Information Centre:
Phone: +49-6251-133-1999
Fax: +49-6251-133-1988

Great Britain -
Stanmore, Middlesex
Phone: +44-8076-080-208
Fax: +44-208-954-6234

Swindon, Wiltshire
Phone: +44-8076-080-208
Fax: +44-1793-572-516

Product Information Centre:
Freephone GB: 0800-267-666
Phone: +44-208-420-8341
Fax: +44-208-420-8081

Greece - Athens
Phone: +30-1-9370-396/397
Fax: +30-1-9370-655

Hungary - Budapest
Phone: +36-1-289-1000
Fax: +36-1-289-1010

Ireland - Dublin
Phone: +353-1-820-3000
Fax: +353-1-820-9790

Israel - Yokneam
Phone: +972-4-959-0508
Fax: +972-4-959-0506

Italy - Collegno (Torino)
Phone: +39-011-4012-111
Fax: +39-011-4031-116

Product Information Centre:
Phone: +39-011-4012-360
Fax: +39-011-40287-360

Lithuania - Vilnius
Phone: +370-5-2131-402
Fax: +370-5-2131-403

Netherlands - 's-Hertogenbosch
Phone: +31-73-6246-246
Fax: +31-73-6212-365

Product Information Centre:
Phone: +31-73-6246-999
Fax: +31-73-6246-998

Norway - Nesbru
Phone: +47-66-77-88-99
Fax: +47-66-77-88-55

Poland - Warsaw
Phone: +48-22-45-76-700
Fax: +48-22-45-76-720

Romania - Bucharest
Phone: +40-21-311-3479+3596
Fax: +40-21-312-0574

Russia - Moscow
Phone: +7-095-926-55-06...09
Fax: +7-095-926-55-05

Russia - St. Petersburg
Phone: +7-812-118-8192
Fax: +7-812-118-8193

Slovenia - Ljubljana
Phone: +386-1561-3270
Fax: +386-1561-3240

South Africa - Port Elizabeth
Phone: +27-41-405-4500
Fax: +27-41-486-1314

Spain - Barcelona
Phone: +34-93-291-0330
Fax: +34-93-201-7879

Product Information Centre:
Phone: +34-93-291-0330
Fax: +34-93-200-3779

Sweden - Upplands Väsby
Phone: +46-8-50-72-50-00
Fax: +46-8-50-72-50-01

Switzerland - Steinach
Phone: +41-71-447-0447
Fax: +41-71-447-0444

Turkey - Istanbul
Phone: +90-212-281-8181...3
+90-212-282-5130/5430
Fax: +90-212-281-8184

Ukraine - Kiev
Phone: +38-044-238-6908
Fax: +38-044-568-5740