

Who would have thought it possible to reinvent the ratchet?

The Wera **ratchet range** impresses users with product features that provide distinct productivity advantages. Wera ratchets have one thing in common: they all combine robustness with precision. The return angles are minimal, despite the high degree of torque transfer.



The Zyklop – combines the advantages of six tools in one and allows considerably higher working speeds, thanks to its innovative and unique design.



The KOLOSS – the heavy-duty ratchet that can also be safely used as a hammer.



The Bit Ratchet – a symbiosis of strength and style ideal for, but not limited to, tight space working.



Ever needed a robust ratchet with a variety of functions that allows high working speeds?

The Zyklop!

Unbelievably fast and incredibly flexible!

Zyklop "6 in 1"

The Wera Zyklop ratchet combines five different types of ratchet in one, and you can even use it as a screwdriver.

1. Fine-tooth ratchet
2. Flex-head ratchet
3. Angle ratchet
4. Quick-release ratchet
5. Power ratchet
6. Screwdriver

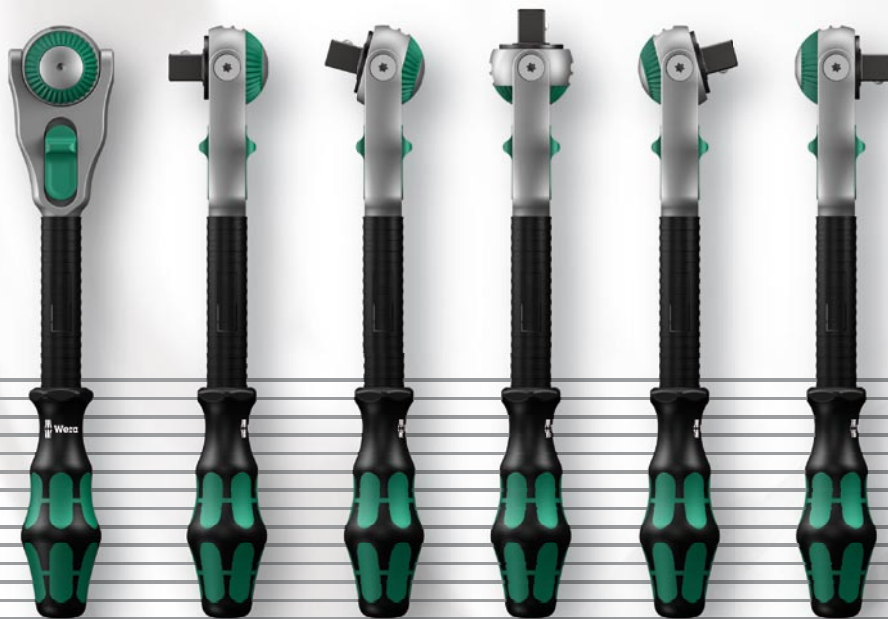

The Zyklop ratchets are **really fast movers**. The gyrating mass design means that screwdriving is accelerated. The rotation-symmetric structure of the Kraftform handle and the free-turning sleeve reinforce this rapid twisting process, particularly when the ratchet does not engage due to too little resistance in the thread.



The reversible ratchet with 72 fine-pitched teeth has a **low return angle of only 5°**. This short stroke allows fast and precise work in all types of installation.



The ball lock **holds the sockets and attachments securely**, ensuring safe working. A changeover into any **predefined position is completed** by simply pressing the release button – this is even the case in the 90° position.



reddot design award
winner 2010



The **ratchet head pivots freely** and can be **locked into any position** by using the slide switch that is positioned on either side. It is even possible to work in very confined and difficult-to-access areas with enhanced hand clearance. The predefined locking at 0°, 15° and 90°, both to the right and left, ensure **safe working without any slipping of the ratchet head**.

All Zyklop ratchets feature a thumbwheel that can be used to **quickly and easily switch between clockwise and anticlockwise rotation**, at any position. No complicated handling, no loss of time!

The ratchet can be used as a conventional **screwdriver** in the 0° position by attaching a unique bit-holding adaptor and a bit.



The ratchet head has an **ergonomic design** with finger recesses that offer a perfect contact surface for the hand or fingers to turn the head.

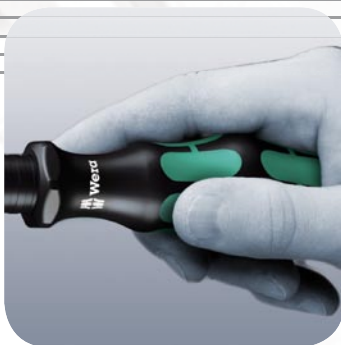

The outstanding design of the Kraffform handle fits perfectly into the hand, **preventing hand injuries such as blisters and calluses**. The hard materials used for the handle ensure quick and easy hand repositioning without any danger of the skin "sticking" to the handle, whilst the softer "anti-slip" zones enable the low-loss transfer of high forces – resulting in less screwdriving effort being required. The circular handle design allows rapid turning in the 0° position.



The free-turning sleeve on the extension **effectively speeds up the tightening or loosening** of screws and bolts.

The Zyklop!

Unbelievably fast and incredibly flexible!



The extensions from the premium lines are also equipped with the unique **"flexible-lock-system"**. By activating this system, attachments can be fixed to the extension permanently – preventing slipping and any unintentional loss of the attachment. When the system is deactivated, the sockets can be attached as usual and changed in a flash.

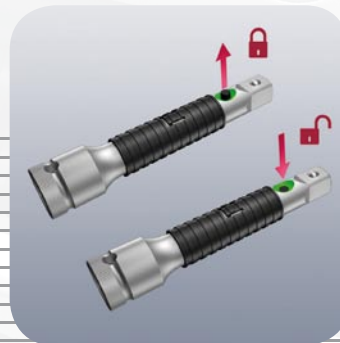

The **Zyklop ratchet cases** have been attractively designed. They are manufactured from robust metal and feature anti-slip rubber feet. The foam insert section means the tools can be safely kept at the workplace and transported vibration-free. This foam insert can be removed if need be – for example, for use in tool cabinets. The designated position of the included tools can be clearly seen in the lid of the case, where they have been permanently laser-etched.



The **wobble extension** pivots through 15° in all directions. This enables rapid and precise working in concealed or confined installation areas.



Manual and machine sockets (ISO 2725-Part 3) can be used both for manual and power tool use (excluding impact). Users need just one socket set for all applications.

The Zyklop Ratchet

The really fast mover!

1/4"

8100 SA 1 Zyklop ratchet set, 1/4" drive, metric



18-piece set in strong metal case

1 Zyklop ratchet with 1/4" drive, 13 Zyklop sockets (metric), 2 Zyklop extensions (short and long) with free-turning sleeve, 1 sliding T-handle, 1 universal joint

Code	Icon	Part Number	Description	Quantity
05003532001	○	8000 A	1 x 1/4"x152,0	1
	○	8789 A	1 x 1/4"x110,0	
	●	8790 HMA	1 x 4,0x23,0; 1 x 4,5x23,0; 1 x 5,0x23,0; 1 x 5,5x23,0; 1 x 6,0x23,0; 1 x 7,0x23,0; 1 x 8,0x23,0; 1 x 9,0x23,0; 1 x 10,0x23,0; 1 x 11,0x23,0; 1 x 12,0x23,0; 1 x 13,0x23,0; 1 x 14,0x23,0	
	●○	8794 LA	1 x 1/4"x150,0	
	●○	8794 SA	1 x 1/4"x75,0	
	●○	8795 A	1 x 1/4"x35,5	

8100 SA 2 Zyklop ratchet set, 1/4" drive, metric



42-piece set in strong metal case

1 Zyklop ratchet with 1/4" drive, 13 Zyklop sockets (metric), 2 Zyklop "flexible-lock" extensions (short and long) with free-turning sleeve, 1 wobble extension, 1 sliding T-handle, 1 universal joint, 1 adaptor with quick-release chuck, 22 bits

Code	Icon	Part Number	Description	Quantity
05003533001	○	8000 A	1 x 1/4"x152,0	1
	●	800/1 Z	1 x 0,6x4,5x25; 1 x 1,0x5,5x25; 1 x 1,2x8,0x25	
	○	840/1 Z Hex-Plus	1 x 3,0x25; 1 x 4,0x25; 1 x 5,0x25; 1 x 6,0x25; 1 x 8,0x25	
	⊕	851/1 Z PH	1 x PH 1x25; 1 x PH 2x25; 1 x PH 3x25	
	⊕	855/1 Z PZ	1 x PZ 1x25; 1 x PZ 2x25; 1 x PZ 3x25	
	⊕	867/1 Z TORX® B0	1 x TX 8x25; 1 x TX 9x25; 1 x TX 10x25; 1 x TX 15x25; 1 x TX 20x25; 1 x TX 25x25; 1 x TX 30x25; 1 x TX 40x25	
	●○	8784 A1	1 x 1/4"x1/4"x37,0	
	○	8789 A	1 x 1/4"x110,0	
	●	8790 HMA	1 x 4,0x23,0; 1 x 4,5x23,0; 1 x 5,0x23,0; 1 x 5,5x23,0; 1 x 6,0x23,0; 1 x 7,0x23,0; 1 x 8,0x23,0; 1 x 9,0x23,0; 1 x 10,0x23,0; 1 x 11,0x23,0; 1 x 12,0x23,0; 1 x 13,0x23,0; 1 x 14,0x23,0	
	●○	8794 A	1 x 1/4"x56,0	
	●○	8795 A	1 x 1/4"x35,5	
	●○	8796 LA	1 x 1/4"x150,0	
	●○	8796 SA	1 x 1/4"x75,0	



How to notice missing tools more quickly



Perfectly conceived in every detail: the storage case for the Zyklop ratchet sets! The two-tone foam insert section means that the tools can be quickly and reliably replaced, and that missing tools can be detected immediately. The tools and their position can be clearly seen in the

lid where they have been laser-etched, ensuring that they are legible even when the insert section is covered with grease, dirt or oil. Additionally, the foam section can be removed and placed in the drawer of a tool cabinet or trolley.

The Zyklop Ratchet

The really fast mover!

1/4"

8100 SA 3 Zyklop ratchet set, 1/4" drive, imperial



15-piece set in strong metal case

1 Zyklop ratchet with 1/4" drive, 10 Zyklop sockets (imperial), 2 Zyklop extensions (short and long) with free-turning sleeve, 1 sliding T-handle, 1 universal joint

Code			
05003534001	○	8000 A	1 x 1/4"x152,0
	○	8789 A	1 x 1/4"x110,0
	●	8790 HMA	1 x 3/16"x23,0; 1 x 7/32"x23,0; 1 x 1/4"x23,0; 1 x 9/32"x23,0; 1 x 5/16"x23,0; 1 x 11/32"x23,0; 1 x 3/8"x23,0; 1 x 7/16"x23,0; 1 x 1/2"x23,0; 1 x 9/16"x23,0
	●○	8794 LA	1 x 1/4"x150,0
	●○	8794 SA	1 x 1/4"x75,0
	●○	8795 A	1 x 1/4"x35,5

8100 SA 4 Zyklop ratchet set, 1/4" drive, imperial



41-piece set in strong metal case

1 Zyklop ratchet with 1/4" drive, 10 Zyklop sockets (imperial), 2 Zyklop "flexible-lock" extensions (short and long) with free-turning sleeve, 1 wobble extension, 1 sliding T-handle, 1 universal joint, 1 adaptor with quick-release chuck, 24 bits

Code			
05003535001	○	8000 A	1 x 1/4"x152,0
	●	800/1 Z	1 x 0,6x4,5x25; 1 x 1,0x5,5x25; 1 x 1,2x8,0x25
	○	840/1 Z Hex-Plus	1 x 5/64"x25; 1 x 3/32"x25; 1 x 1/8"x25; 1 x 9/64"x25; 1 x 5/32"x25; 1 x 3/16"x25; 1 x 7/32"x25
	⊕	851/1 Z PH	1 x PH 1x25; 1 x PH 2x25; 1 x PH 3x25
	⊕	855/1 Z PZ	1 x PZ 1x25; 1 x PZ 2x25; 1 x PZ 3x25
	⊕	867/1 Z TORX® BO	1 x TX 8x25; 1 x TX 9x25; 1 x TX 10x25; 1 x TX 15x25; 1 x TX 20x25; 1 x TX 25x25; 1 x TX 30x25; 1 x TX 40x25
	●○	8784 A1	1 x 1/4"x1/4"x37,0
	○	8789 A	1 x 1/4"x110,0
	●	8790 HMA	1 x 3/16"x23,0; 1 x 7/32"x23,0; 1 x 1/4"x23,0; 1 x 9/32"x23,0; 1 x 5/16"x23,0; 1 x 11/32"x23,0; 1 x 3/8"x23,0; 1 x 7/16"x23,0; 1 x 1/2"x23,0; 1 x 9/16"x23,0
	●○	8794 A	1 x 1/4"x56,0
	●○	8795 A	1 x 1/4"x35,5
	●○	8796 LA	1 x 1/4"x150,0
	●○	8796 SA	1 x 1/4"x75,0



Is it also possible to reverse the drive with oily hands?



The thumbwheel is designed in such a way that it offers outstanding grip and can, therefore, even be operated with oily hands.

The Zyklon Ratchet

The really fast mover!

1/4"

8100 SA 5 Module insert



NEW

30-piece ratchet and bit set in a foam insert

Fits into conventional tool trolleys from e.g. Stahlwille, Hazet, Gedore, Matador, Facom, Carolus, Berner, Kraftwerk, KS-Tools, Würth, Förch as well as workbenches.

Size 342 mm x 174 mm, can be cut down in size to 310 mm x 158 mm; by cutting off the edges, the insert can quickly and easily be shaped to fit into the respective drawer

Code	Icon	Part Number	Description	Quantity
05134057001	⊙	8000 A	1 x 1/4"x152,0	1
	⊙	816 R	1 x 1/4"x119	
	⊖	800/4 Z	1 x 1,0x5,5x89	
	⊙	840/4 Z	1 x 4,0x89; 1 x 5,0x89	
		Hex-Plus		
	⊕	851/4 Z PH	1 x PH 1x89; 1 x PH 2x89; 1 x PH 3x89	
	⊕	867/4 Z	1 x TX 15x89; 1 x TX 20x89; 1 x TX 25x89; 1 x TX 27x89	
		TORX®		
	⊙	8784 A1	1 x 1/4"x1/4"x37,0	
	⊙	8790 HMA	1 x 4,0x23,0; 1 x 4,5x23,0; 1 x 5,0x23,0; 1 x 5,5x23,0; 1 x 6,0x23,0; 1 x 7,0x23,0; 1 x 8,0x23,0; 1 x 9,0x23,0; 1 x 10,0x23,0; 1 x 11,0x23,0; 1 x 12,0x23,0; 1 x 13,0x23,0; 1 x 14,0x23,0	
	⊙	8795 A	1 x 1/4"x35,5	
	⊙	8796 LA	1 x 1/4"x150,0	
	⊙	8796 SA	1 x 1/4"x75,0	

Kraftform Kompakt Zyklon



NEW

26-piece set in a belt pouch

1 Zyklon ratchet with 1/4" drive, 7 Zyklon sockets (metric), 1 Zyklon extension (long) with free-turning sleeve, 1 adaptor, 16 bits of 50 mm in length

Code	Icon	Part Number	Description	Quantity
05051045001	⊙	8000 A	1 x 1/4"x152,0	1
	⊖	800/4 Z	1 x 1,0x5,5x50	
	⊙	840/4 Z	1 x 3,0x50; 1 x 4,0x50; 1 x 5,0x50	
		Hex-Plus		
	⊕	851/4 TZ PH	1 x PH 1x50; 1 x PH 2x50; 1 x PH 3x50	
	⊕	855/4 TZ PZ	1 x PZ 1x50; 1 x PZ 2x50	
	⊕	867/4 Z TORX®	1 x TX 10x50; 1 x TX 15x50; 1 x TX 20x50; 1 x TX 25x50; 1 x TX 27x50; 1 x TX 30x50	
	⊙	8784 A1	1 x 1/4"x1/4"x37,0	
	⊙	8790 HMA	1 x 5,5x23,0; 1 x 6,0x23,0; 1 x 7,0x23,0; 1 x 8,0x23,0; 1 x 10,0x23,0; 1 x 12,0x23,0; 1 x 13,0x23,0	
	⊙	8794 LA	1 x 1/4"x150,0	

Foam inserts



Due to their flexible design, the new Wera foam inserts fit into the common tool cabinets and workbenches (maximum size 342mm x 174mm, can be cut down to 310mm x 158mm). By cutting off the edges the insert is adapted quickly & easily to the drawer.

The modular design allows the user to customise his tool trolley/workbench. Suitable for Stahlwille, Hazet, Gedore, Matador, Facom, Carolus, Berner, Kraftwerk, KS-Tools, Würth, Förch tool trolleys and more.

8000 A Zyklop ratchet with 1/4" drive



Application: 1/4" square sockets and 1/4" adaptors with square drive, equipped with ball lock

Design: Flywheel design and easy-to-grip free-turning sleeve for faster work, swivel ratchet head, defined lock positions at 0° and 90° to the left and right as well as at 15° before 90° inwards, at 0° it can be used like a conventional screwdriver, pushbutton release, left/right switchover, fine-tooth design, small return angle of 5°

Handle: Multi-component Krafftform handle ensures minimum fatigue

Code	mm	mm	
0500350001	1/4"	152,0	1

8790 HMA Zyklop 1/4" socket

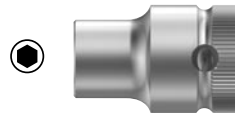

Application: Hexagon headed bolts, screws and nuts

Design: Manual and (non-impact) machine applications, ball intercept ring, knurls at base for precision handling in manual operations, chrome vanadium, brushed chrome-plated finish

Code	mm	mm	mm	mm	mm	
05003501001	4,0	23,0	6,9	13,0	10,0	1
05003502001	4,5	23,0	7,5	13,0	10,0	1
05003503001	5,0	23,0	8,2	13,0	10,0	1
05003504001	5,5	23,0	8,8	13,0	10,0	1
05003505001	6,0	23,0	9,4	13,0	10,0	1
05003506001	7,0	23,0	11,0	13,0	10,0	1
05003507001	8,0	23,0	12,0	13,0	10,0	1
05003508001	9,0	23,0	13,0	14,0	10,0	1
05003509001	10,0	23,0	14,5	14,5	-	1
05003510001	11,0	23,0	16,0	15,0	13,0	1
05003511001	12,0	23,0	17,0	16,0	13,0	1
05003512001	13,0	23,0	18,0	17,0	13,0	1
05003513001	14,0	23,0	20,0	18,0	13,0	1
05003514001	3/16"	23,0	7,5	13,0	10,0	1
05003515001	7/32"	23,0	8,8	13,0	10,0	1
05003516001	1/4"	23,0	11,0	13,0	10,0	1
05003517001	9/32"	23,0	11,0	13,0	10,0	1
05003518001	5/16"	23,0	12,0	13,0	10,0	1
05003519001	11/32"	23,0	13,0	14,0	10,0	1
05003520001	3/8"	23,0	14,5	14,5	-	1
05003521001	7/16"	23,0	16,0	15,0	13,0	1
05003522001	1/2"	23,0	18,0	17,0	13,0	1
05003523001	9/16"	23,0	20,0	18,0	13,0	1



Can the entire ratchet be used to turn a screw?



Simply hold the extension sleeve and spin the ratchet through 360°. This greatly accelerates the screwdriving process.



How to avoid the need for two socket sets – one for manual and one for machine operations



The new manual and machine sockets (ISO 2725-Part 3) can be used both for hand and power tools use (non-impact). Users need just one socket set for all applications.

The Zyklop Ratchet

The really fast mover!

1/4"

8796 SA Zyklop "flexible-lock" extension with free-turning sleeve, short, 1/4"



Application: 1/4" square drive sockets with ball lock

Design: Flexible lock system either for permanent interlocking or fast change of accessories, free-turning sleeve for rapid tightening or loosening of screws and nuts, chrome vanadium, brushed chrome-plated finish

Code	1/4"	mm	
05003530001	1/4"	75,0	1

8794 SA Zyklop extension with free-turning sleeve, short, 1/4"



Application: 1/4" square drive sockets with ball lock

Design: Easy-to-grip free-turning sleeve for rapid tightening or loosening of screws and nuts, chrome vanadium, brushed chrome-plated finish

Code	1/4"	mm	
05003525001	1/4"	75,0	1

8796 LA Zyklop "flexible-lock" extension with free-turning sleeve, long, 1/4"



Application: 1/4" square drive sockets with ball lock

Design: Flexible lock system either for permanent interlocking or fast change of accessories, free-turning sleeve for rapid tightening or loosening of screws and nuts, chrome vanadium, brushed chrome-plated finish

Code	1/4"	mm	
05003531001	1/4"	150,0	1

8794 LA Zyklop extension with free-turning sleeve, long, 1/4"



Application: 1/4" square drive sockets with ball lock

Design: Easy-to-grip free-turning sleeve for rapid tightening or loosening of screws and nuts, chrome vanadium, brushed chrome-plated finish

Code	1/4"	mm	
05003526001	1/4"	150,0	1



How to secure the socket when required

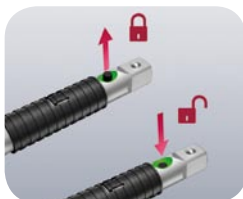

The extensions on the premium lines are also equipped with the "flexible-lock-system". By activating this system, attachments can be fixed to the extension permanently, preventing slipping and any unintentional loss of the attachment.

When the system is deactivated, the sockets can be attached as usual and changed in a flash.

8789 A Zyklop sliding T-handle, 1/4"



Application: 1/4" square drive sockets with ball lock

Design: Sliding drive, chrome vanadium, brushed chrome-plated finish

Code	1/4"	mm	
05003524001	1/4"	110,0	1

8795 A Zyklop universal joint, 1/4"



Application: 1/4" square drive sockets with ball lock

Design: Chrome vanadium/chrome molybdenum, brushed chrome-plated finish

Code	mm	
05003528001	1/4"	35,5

8784 A1 Zyklop adaptor, 1/4"



Application: Suitable for 1/4" hex bits as per DIN 3126-C 6.3 and E 6.3, ISO 1173 and Wera series 1 and 4

Design: Quick-release chuck for fast bit changes, chromium vanadium

Code	mm	
05003529001	1/4"	37,0



How to work quickly when there is too little resistance in the thread



Everyone knows the problem of when there is insufficient resistance on the thread to engage the ratchet on the return stroke, and it becomes irritating and time-consuming to fix. The Zyklop ratchets are really fast movers – their gyrating mass design means that

screwdriving is accelerated. The free-turning sleeve and the rotation-symmetric structure of the Kraftform handle reinforce this rapid twisting process.



How to work well in confined installation areas



The Zyklop wobble extensions pivot through 15° in all directions. This enables rapid and precise work in concealed or confined installation areas.

8794 A Zyklop wobble extension, 1/4"



Application: 1/4" square drive sockets with ball lock

Design: Swivels through 15°, chrome vanadium, brushed chrome-plated finish

Code	mm	
05003527001	1/4"	56,0

Display Zyklop, 1/4" drive



Application: 1/4" square sockets and 1/4" adaptors with square drive, equipped with ball lock

Design: Flywheel design and easy-to-grip free-turning sleeve for faster work, swivel ratchet head, defined lock positions at 0° and 90° to the left and right as well as at 15° before 90° inwards, at 0° it can be used like a conventional screwdriver, pushbutton release, left/right switchover, fine-tooth design, small return angle of 5°

Handle: Multi-component Kraftform handle ensures minimum fatigue

Code		
05003540001	8000 A	8 x 1/4"x152,0

The Zyklop Ratchet

The really fast mover!

3/8"

8100 SB 1 Zyklop ratchet set, 3/8" drive, metric



23-piece set in strong metal case

1 Zyklop ratchet with 3/8" drive, 18 Zyklop sockets (metric), 2 Zyklop extensions (short and long) with free-turning sleeve, 1 sliding T-handle, 1 universal joint

Code	Item	Quantity
05003593001	8000 B	1 x 3/8"x199,0
	8789 B	1 x 3/8"x165,0
	8790 HMB	1 x 6,0x29,0; 1 x 7,0x29,0; 1 x 8,0x29,0; 1 x 9,0x29,0; 1 x 10,0x29,0; 1 x 11,0x29,0; 1 x 12,0x29,0; 1 x 13,0x29,0; 1 x 14,0x29,0; 1 x 15,0x29,0; 1 x 16,0x30,0; 1 x 17,0x30,0; 1 x 18,0x30,0; 1 x 19,0x30,0; 1 x 20,0x30,0; 1 x 21,0x30,0; 1 x 22,0x30,0; 1 x 24,0x32,0
	8794 LB	1 x 3/8"x200,0
	8794 SB	1 x 3/8"x125,0
	8795 B	1 x 3/8"x50,0

8100 SB 2 Zyklop ratchet set, 3/8" drive, metric



43-piece set in strong metal case

1 Zyklop ratchet with 3/8" drive, 18 Zyklop sockets (metric), 2 Zyklop "flexible-lock" extensions (short and long) with free-turning sleeve, 1 sliding T-handle, 1 wobble extension, 1 universal joint, 1 adaptor with quick-release chuck, 18 bits

Code	Item	Quantity
05003594001	8000 B	1 x 3/8"x199,0
	800/1 Z	1 x 1,0x5,5x25
	840/1 Z Hex-Plus	1 x 3,0x25; 1 x 4,0x25; 1 x 5,0x25; 1 x 6,0x25; 1 x 8,0x25; 1 x 10,0x25
	851/1 Z PH	1 x PH 2x25; 1 x PH 3x25
	855/1 Z PZ	1 x PZ 2x25; 1 x PZ 3x25
	867/1 Z TORX® BO	1 x TX 10x25; 1 x TX 15x25; 1 x TX 20x25; 1 x TX 25x25; 1 x TX 27x25; 1 x TX 30x25; 1 x TX 40x25
	8784 B1	1 x 1/4"x3/8"x44,0
	8789 B	1 x 3/8"x165,0
	8790 HMB	1 x 6,0x29,0; 1 x 7,0x29,0; 1 x 8,0x29,0; 1 x 9,0x29,0; 1 x 10,0x29,0; 1 x 11,0x29,0; 1 x 12,0x29,0; 1 x 13,0x29,0; 1 x 14,0x29,0; 1 x 15,0x29,0; 1 x 16,0x30,0; 1 x 17,0x30,0; 1 x 18,0x30,0; 1 x 19,0x30,0; 1 x 20,0x30,0; 1 x 21,0x30,0; 1 x 22,0x30,0; 1 x 24,0x32,0
	8794 B	1 x 3/8"x76,0
	8795 B	1 x 3/8"x50,0
	8796 LB	1 x 3/8"x200,0
	8796 SB	1 x 3/8"x125,0



How to notice missing tools more quickly



Perfectly conceived in every detail: the storage case for the Zyklop ratchet sets! The two-tone foam insert section means that the tools can be quickly and reliably replaced, and that missing tools can be detected immediately. The tools and their position can be clearly seen in the

lid where they have been laser-etched, ensuring that they are legible even when the insert section is covered with grease, dirt or oil. Additionally, the foam section can be removed and placed in the drawer of a tool cabinet or trolley.

8100 SB 3 Zyklop ratchet set, 3/8" drive, imperial



17-piece set in strong metal case

1 Zyklop ratchet with 3/8" drive, 12 Zyklop sockets (imperial), 2 Zyklop extensions (short and long) with free-turning sleeve, 1 sliding T-handle, 1 universal joint

Code	Icon	Part Number	Description	Quantity
05003595001		8000 B	1 x 3/8"x199,0	1
		8789 B	1 x 3/8"x165,0	
		8790 HMB	1 x 1/4"x29,0; 1 x 5/16"x29,0; 1 x 11/32"x29,0; 1 x 3/8"x29,0; 1 x 7/16"x29,0; 1 x 1/2"x29,0; 1 x 9/16"x29,0; 1 x 5/8"x30,0; 1 x 11/16"x30,0; 1 x 3/4"x30,0; 1 x 13/16"x30,0; 1 x 7/8"x30,0	
		8794 LB	1 x 3/8"x200,0	
		8794 SB	1 x 3/8"x125,0	
		8795 B	1 x 3/8"x50,0	

8100 SB 4 Zyklop ratchet set, 3/8" drive, imperial



38-piece set in strong metal case

1 Zyklop ratchet with 3/8" drive, 12 Zyklop sockets (imperial), 2 Zyklop "flexible-lock" extensions (short and long) with free-turning sleeve, 1 sliding T-handle, 1 wobble extension, 1 universal joint, 1 adaptor with quick-release chuck, 19 bits

Code	Icon	Part Number	Description	Quantity
05003596001		8000 B	1 x 3/8"x199,0	1
		800/1 Z	1 x 1,0x5,5x25	
		840/1 Z Hex-Plus	1 x 5/64"x25; 1 x 3/32"x25; 1 x 1/8"x25; 1 x 9/64"x25; 1 x 5/32"x25; 1 x 3/16"x25; 1 x 7/32"x25	
		851/1 Z PH	1 x PH 2x25; 1 x PH 3x25	
		855/1 Z PZ	1 x PZ 2x25; 1 x PZ 3x25	
		867/1 Z TORX® B0	1 x TX 10x25; 1 x TX 15x25; 1 x TX 20x25; 1 x TX 25x25; 1 x TX 27x25; 1 x TX 30x25; 1 x TX 40x25	
		8784 B1	1 x 1/4"x3/8"x44,0	
		8789 B	1 x 3/8"x165,0	
		8790 HMB	1 x 1/4"x29,0; 1 x 5/16"x29,0; 1 x 11/32"x29,0; 1 x 3/8"x29,0; 1 x 7/16"x29,0; 1 x 1/2"x29,0; 1 x 9/16"x29,0; 1 x 5/8"x30,0; 1 x 11/16"x30,0; 1 x 3/4"x30,0; 1 x 13/16"x30,0; 1 x 7/8"x30,0	
		8794 B	1 x 3/8"x76,0	
		8795 B	1 x 3/8"x50,0	
		8796 LB	1 x 3/8"x200,0	
		8796 SB	1 x 3/8"x125,0	



The Zyklus Ratchet

The really fast mover!

3/8"

8100 SB 5 Module insert



22-piece ratchet set in a foam insert

Fits into conventional tool trolleys from e.g. Stahlwille, Hazet, Gedore, Matador, Facom, Carolus, Berner, Kraftwerk, KS-Tools, Würth, Förch as well as work benches.

Size 342 mm x 174 mm, can be cut down in size to 310 mm x 158 mm; by cutting off the edges, the insert can quickly and easily be shaped to fit into the respective drawer

Code	Icon	Part Number	Description	Quantity
05134058001	●	8000 B	1 x 3/8"x199,0	1
	●	8790 HMB	1 x 6,0x29,0; 1 x 7,0x29,0; 1 x 8,0x29,0; 1 x 9,0x29,0; 1 x 10,0x29,0; 1 x 11,0x29,0; 1 x 12,0x29,0; 1 x 13,0x29,0; 1 x 14,0x29,0; 1 x 15,0x29,0; 1 x 16,0x30,0; 1 x 17,0x30,0; 1 x 18,0x30,0; 1 x 19,0x30,0; 1 x 20,0x30,0; 1 x 21,0x30,0; 1 x 22,0x30,0; 1 x 24,0x32,0	
	●	8795 B	1 x 3/8"x50,0	
	●	8796 LB	1 x 3/8"x200,0	
	●	8796 SB	1 x 3/8"x125,0	



Foam inserts



Due to their flexible design, the new Wera foam inserts fit into the common tool cabinets and workbenches (maximum size 342mm x 174mm, can be cut down to 310mm x 158mm). By cutting off the edges the insert is adapted quickly & easily to the drawer.

The modular design allows the user to customise his tool trolley/workbench. Suitable for Stahlwille, Hazet, Gedore, Matador, Facom, Carolus, Berner, Kraftwerk, KS-Tools, Würth, Förch tool trolleys and more.

8000 B Zyklus ratchet with 3/8" drive



Application: 3/8" square drive sockets and 3/8" adaptors with square drive, equipped with ball lock

Design: Flywheel design and easy-to-grip free-turning sleeve for faster work, swivel ratchet head, defined lock positions at 0° and 90° to the left and right as well as at 15° before 90° inwards, at 0° it can be used like a conventional screwdriver, pushbutton release, left/right switchover, fine-tooth design, small return angle of 5°

Handle: Multi-component Kraftform handle ensures minimum fatigue

Code	mm	1
05003550001	3/8"	199,0

8790 HMB Zyklus 3/8" socket



Application: Hexagon headed bolts, screws and nuts

Design: Manual and (non-impact) machine applications, ball intercept ring, knurls at base for precision handling in manual operations, chrome vanadium, brushed chrome-plated finish

Code	mm	mm	mm	mm	mm	mm	mm	mm
05003551001	6,0	29,0	10,5	13,0	18,0			1
05003552001	7,0	29,0	11,0	13,0	18,0			1
05003553001	8,0	29,0	12,2	13,0	18,0			1
05003554001	9,0	29,0	13,5	13,0	18,0			1
05003555001	10,0	29,0	14,5	13,0	18,0			1
05003556001	11,0	29,0	16,0	13,0	18,0			1
05003557001	12,0	29,0	17,0	13,0	18,0			1
05003558001	13,0	29,0	18,5	14,0	20,0			1
05003559001	14,0	29,0	19,5	14,5	22,0			1
05003560001	15,0	29,0	21,0	15,0	24,0			1
05003561001	16,0	30,0	22,0	16,0	24,0			1
05003562001	17,0	30,0	23,5	17,0	24,0			1
05003563001	18,0	30,0	24,5	18,0	24,0			1
05003564001	19,0	30,0	26,0	13,0	24,0			1
05003565001	20,0	30,0	28,0	13,0	25,0			1
05003566001	21,0	30,0	28,0	13,0	25,0			1
05003567001	22,0	30,0	32,0	13,0	25,0			1
05003568001	24,0	32,0	32,0	13,0	25,0			1
05003569001		1/4"	29,0	11,0	18,0	12,0		1
05003570001		5/16"	29,0	12,2	18,0	12,0		1
05003571001		11/32"	29,0	13,5	18,0	12,0		1
05003572001		3/8"	29,0	14,5	18,0	12,0		1
05003573001		7/16"	29,0	16,0	18,0	12,0		1
05003574001		1/2"	29,0	18,5	20,0	12,0		1
05003575001		9/16"	29,0	19,5	22,0	12,0		1
05003576001		5/8"	30,0	22,0	24,0	12,0		1
05003577001		11/16"	30,0	23,0	24,0	18,0		1
05003578001		3/4"	30,0	26,0	24,0	18,0		1
05003579001		13/16"	30,0	28,0	25,0	18,0		1
05003580001		7/8"	30,0	32,0	25,0	18,0		1



How to work quickly when there is too little resistance in the thread



Everyone knows the problem of when there is insufficient resistance on the thread to engage the ratchet on the return stroke, and it becomes irritating and time-consuming to fix. The Zyklus ratchets are really fast movers – their gyrating mass design means that

screwdriving is accelerated. The free-turning sleeve and the rotation-symmetric structure of the Kraftform handle reinforce this rapid twisting process.



How to avoid the need for two socket sets – one for manual and one for machine operations



The new manual and machine sockets (ISO 2725-Part 3) can be used both for hand and power tools use (non-impact). Users need just one socket set for all applications.

The Zyklop Ratchet

The really fast mover!

3/8"

8796 SB Zyklop "flexible-lock" extension with free-turning sleeve, short, 3/8"



Application: 3/8" square drive sockets with ball lock

Design: Flexible lock system either for permanent interlocking or fast change of accessories, free-turning sleeve for rapid tightening or loosening of screws and nuts, chrome vanadium, brushed chrome-plated finish

Code	3/8"	mm	
05003591001	3/8"	125,0	1

8796 LB Zyklop "flexible-lock" extension with free-turning sleeve, long, 3/8"



Application: 3/8" square drive sockets with ball lock

Design: Flexible lock system either for permanent interlocking or fast change of accessories, free-turning sleeve for rapid tightening or loosening of screws and nuts, chrome vanadium, brushed chrome-plated finish

Code	3/8"	mm	
05003592001	3/8"	200,0	1

8794 SB Zyklop extension with free-turning sleeve, short, 3/8"



Application: 3/8" square drive sockets with ball lock

Design: Easy-to-grip free-turning sleeve for rapid tightening or loosening of screws and nuts, chrome vanadium, brushed chrome-plated finish

Code	3/8"	mm	
05003582001	3/8"	125,0	1

8794 LB Zyklop extension with free-turning sleeve, long, 3/8"



Application: 3/8" square drive sockets with ball lock

Design: Easy-to-grip free-turning sleeve for rapid tightening or loosening of screws and nuts, chrome vanadium, brushed chrome-plated finish

Code	3/8"	mm	
05003583001	3/8"	200,0	1

8789 B Zyklop sliding T-handle, 3/8"



Application: 3/8" square drive sockets with ball lock

Design: Sliding drive, chrome vanadium, brushed chrome-plated finish

Code	3/8"	mm	
05003581001	3/8"	165,0	1

8795 B Zyklop universal joint, 3/8"



Application: 3/8" square drive sockets with ball lock

Design: Chrome vanadium/chrome molybdenum, brushed chrome-plated finish

Code	3/8"	mm	
05003585001	3/8"	50,0	1

8794 B Zyklop wobble extension, 3/8"



Application: 3/8" square drive sockets with ball lock

Design: Swivels through 15°, chrome vanadium, brushed chrome-plated finish

Code	mm	
05003584001	76,0	1

8784 B1 Zyklop adaptor, 3/8"



Application: Suitable for 1/4" hex bits as per DIN 3126-C 6.3 and E 6.3, ISO 1173 and Wera series 1 and 4

Design: Quick-release chuck for fast bit changes, chromium vanadium

Code	mm	
05003590001	44,0	1

Display Zyklop, 3/8" drive



Application: 3/8" square drive sockets and 3/8" adaptors with square drive, equipped with ball lock

Design: Flywheel design and easy-to-grip free-turning sleeve for faster work, swivel ratchet head, defined lock positions at 0° and 90° to the left and right as well as at 15° before 90° inwards, at 0° it can be used like a conventional screwdriver, pushbutton release, left/right switchover, fine-tooth design, small return angle of 5°

Handle: Multi-component Kraftform handle ensures minimum fatigue

Code		
05003599001	8000 B	5 x 3/8"x199,0



The Zyklop Ratchet

The really fast mover!

1/2"

8100 SC 1 Zyklop ratchet set, 1/2" drive, metric



22-piece set in strong metal case

1 Zyklop ratchet with 1/2" drive, 17 Zyklop sockets (metric),
2 Zyklop extensions (short and long) with free-tuning sleeve,
1 sliding T-handle, 1 universal joint

Code	Item	Quantity
05003644001	8000 C 1 x 1/2"x277,0	1
	8789 C 1 x 1/2"x250,0	
	8790 HMC 1 x 10,0x37,0; 1 x 11,0x37,0; 1 x 12,0x37,0; 1 x 13,0x37,0; 1 x 14,0x37,0; 1 x 15,0x37,0; 1 x 16,0x37,0; 1 x 17,0x37,0; 1 x 18,0x37,0; 1 x 19,0x37,0; 1 x 20,0x37,0; 1 x 21,0x37,0; 1 x 22,0x37,0; 1 x 24,0x37,0; 1 x 27,0x40,0; 1 x 30,0x42,0; 1 x 32,0x42,0	
	8794 LC 1 x 1/2"x250,0	
	8794 SC 1 x 1/2"x125,0	
	8795 C 1 x 1/2"x69,0	

8100 SC 2 Zyklop ratchet set, 1/2" drive, metric



37-piece set in strong metal case

1 Zyklop ratchet with 1/2" drive, 17 Zyklop sockets (metric),
2 Zyklop "flexible-lock" extensions (short and long) with free-tuning sleeve,
1 sliding T-handle, 1 universal joint, 1 wobble extension, 1 adaptor with
quick-release chuck, 13 bits

Code	Item	Quantity
05003645001	8000 C 1 x 1/2"x277,0	1
	840/2 Z Hex-Plus 1 x 5x30; 1 x 6x30; 1 x 8x30; 1 x 10x30	
	851/2 Z PH 1 x PH 3x32	
	855/2 Z PZ 1 x PZ 3x32	
	867/2 Z TORX® 1 x TX 20x35; 1 x TX 25x35; 1 x TX 30x35; 1 x TX 40x35; 1 x TX 45x35; 1 x TX 50x35; 1 x TX 55x35	
	8784 C2 1 x 5/16"x1/2"x50,0	
	8789 C 1 x 1/2"x250,0	
	8790 HMC 1 x 10,0x37,0; 1 x 11,0x37,0; 1 x 12,0x37,0; 1 x 13,0x37,0; 1 x 14,0x37,0; 1 x 15,0x37,0; 1 x 16,0x37,0; 1 x 17,0x37,0; 1 x 18,0x37,0; 1 x 19,0x37,0; 1 x 20,0x37,0; 1 x 21,0x37,0; 1 x 22,0x37,0; 1 x 24,0x37,0; 1 x 27,0x40,0; 1 x 30,0x42,0; 1 x 32,0x42,0	
	8794 C 1 x 1/2"x52,0	
	8795 C 1 x 1/2"x69,0	
	8796 LC 1 x 1/2"x250,0	
	8796 SC 1 x 1/2"x125,0	



How to notice missing tools more quickly



Perfectly conceived in every detail: the storage case for the Zyklop ratchet sets! The two-tone foam insert section means that the tools can be quickly and reliably replaced, and that missing tools can be detected immediately. The tools and their position can be clearly seen

in the lid where they have been laser-etched, ensuring that they are legible even when the insert section is covered with grease, dirt or oil. Additionally, the foam section can be removed and placed in the drawer of a tool cabinet or trolley.

8100 SC 3 Zyklop ratchet set, 1/2" drive, imperial



23-piece set in strong metal case

- 1 Zyklop ratchet with 1/2" drive, 18 Zyklop sockets (imperial),
- 2 Zyklop extensions (short and long) with free-tuning sleeve,
- 1 sliding T-handle, 1 universal joint

Code			
05003646001	● 8000 C	1 x 1/2"x277,0	1
	● 8789 C	1 x 1/2"x250,0	
	● 8790 HMC	1 x 3/8"x37,0; 1 x 7/16"x37,0; 1 x 1/2"x37,0; 1 x 9/16"x37,0; 1 x 19/32"x37,0; 1 x 5/8"x37,0; 1 x 11/16"x37,0; 1 x 3/4"x37,0; 1 x 25/32"x37,0; 1 x 13/16"x37,0; 1 x 7/8"x37,0; 1 x 15/16"x37,0; 1 x 31/32"x37,0; 1 x 1"x40,0; 1 x 1 1/16"x40,0; 1 x 1 1/8"x40,0; 1 x 1 3/16"x42,0; 1 x 1 1/4"x42,0	
	● 8794 LC	1 x 1/2"x250,0	
	● 8794 SC	1 x 1/2"x125,0	
	● 8795 C	1 x 1/2"x69,0	

8100 SC 4 Zyklop ratchet set, 1/2" drive, imperial



38-piece set in strong metal case

- 1 Zyklop ratchet with 1/2" drive, 18 Zyklop sockets (imperial),
- 2 Zyklop "flexible-lock" extensions (short and long) with free-tuning sleeve,
- 1 sliding T-handle, 1 universal joint, 1 wobble extension, 1 adaptor with quick-release chuck, 13 bits

Code			
05003647001	● 8000 C	1 x 1/2"x277,0	1
	● 840/2 Z Hex-Plus	1 x 7/32"x30; 1 x 1/4"x30; 1 x 5/16"x30; 1 x 3/8"x30	
	● 851/2 Z PH	1 x PH 3x32	
	● 855/2 Z PZ	1 x PZ 3x32	
	● 867/2 Z TORX®	1 x TX 20x35; 1 x TX 25x35; 1 x TX 30x35; 1 x TX 40x35; 1 x TX 45x35; 1 x TX 50x35; 1 x TX 55x35	
	● 8784 C2	1 x 5/16"x1 1/2"x50,0	
	● 8789 C	1 x 1/2"x250,0	
	● 8790 HMC	1 x 3/8"x37,0; 1 x 7/16"x37,0; 1 x 1/2"x37,0; 1 x 9/16"x37,0; 1 x 19/32"x37,0; 1 x 5/8"x37,0; 1 x 11/16"x37,0; 1 x 3/4"x37,0; 1 x 25/32"x37,0; 1 x 13/16"x37,0; 1 x 7/8"x37,0; 1 x 15/16"x37,0; 1 x 31/32"x37,0; 1 x 1"x40,0; 1 x 1 1/16"x40,0; 1 x 1 1/8"x40,0; 1 x 1 3/16"x42,0; 1 x 1 1/4"x42,0	
	● 8794 C	1 x 1/2"x52,0	
	● 8795 C	1 x 1/2"x69,0	
	● 8796 LC	1 x 1/2"x250,0	
	● 8796 SC	1 x 1/2"x125,0	



The Zyklop Ratchet

The really fast mover!

1/2"

8100 SC Zyklop 1/2" starter set



NEW

16-piece set in strong metal case

1 Zyklop ratchet with 1/2" drive, 13 Zyklop sockets (metric),
2 Zyklop extensions (short and long) with free-tuning sleeve

Code			
05003454001	8000 C	1 x 1/2"x277,0	1
	8790 HMC	1 x 10,0x37,0; 1 x 11,0x37,0; 1 x 12,0x37,0; 1 x 13,0x37,0; 1 x 15,0x37,0; 1 x 16,0x37,0; 1 x 17,0x37,0; 1 x 18,0x37,0; 1 x 19,0x37,0; 1 x 21,0x37,0; 1 x 22,0x37,0; 1 x 24,0x37,0; 1 x 27,0x40,0	
	8794 LC	1 x 1/2"x250,0	
	8794 SC	1 x 1/2"x125,0	

Zyklop starter set



The practical combination of the required ratchet components makes the Zyklop 8100 SC 1/2" ideal as a starter set or as a supplement to your existing tools. This set is also available in a 1/4" version – see page 121.

8100 SC 5 Module insert



NEW

19-piece ratchet and bit set in a foam insert

Fits into conventional tool trolleys from e.g. Stahlwille, Hazet, Gedore, Matador, Facom, Carolus, Berner, Kraftwerk, KS-Tools, Würth, Förch as well as work benches

Size 342 mm x 174 mm, can be cut down in size to 310 mm x 158 mm; by cutting off the edges, the insert can quickly and easily be shaped to fit into the respective drawer

Code			
05134059001	8000 C	1 x 1/2"x277,0	1
	840/2 Z Hex-Plus	1 x 4x30; 1 x 5x30; 1 x 6x30; 1 x 8x30; 1 x 10x30	
	851/2 Z PH	1 x PH 3x32	
	855/2 Z PZ	1 x PZ 3x32	
	867/2 Z TORX®	1 x TX 20x35; 1 x TX 25x35; 1 x TX 27x35; 1 x TX 30x35; 1 x TX 40x35; 1 x TX 45x35; 1 x TX 50x35; 1 x TX 55x35	
	8784 C2	1 x 5/16"x1/2"x50,0	
	8796 LC	1 x 1/2"x250,0	
	8796 SC	1 x 1/2"x125,0	



Foam inserts



Due to their flexible design, the new Wera foam inserts fit into the common tool cabinets and workbenches (maximum size 342mm x 174mm, can be cut down to 310mm x 158mm). By cutting off the edges the insert is adapted quickly & easily to the drawer.

The modular design allows the user to customise his tool trolley/workbench. Suitable for Stahlwille, Hazet, Gedore, Matador, Facom, Carolus, Berner, Kraftwerk, KS-Tools, Würth, Förch tool trolleys and more.

8000 C Zyklop ratchet with 1/2" drive



Application: 1/2" square drive sockets and 1/2" adapters with square drive, equipped with ball lock

Design: Flywheel design and easy-to-grip free-turning sleeve for faster work, swivel ratchet head, defined lock positions at 0° and 90° to the left and right as well as at 15° before 90° inwards, at 0° it can be used like a conventional screwdriver, pushbutton release, left/right switchover, fine-tooth design, small return angle of 5°

Handle: Multi-component Kraftform handle ensures minimum fatigue

Code	mm	mm
05003600001	1/2"	277,0

8790 HMC Zyklop socket with 1/2" drive

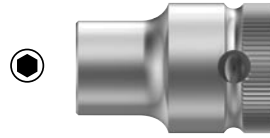

Application: Hexagon headed bolts, screws and nuts

Design: Manual and (non-impact) machine applications, ball intercept ring, knurls at base for precision handling in manual operations, chrome vanadium, brushed chrome-plated finish

Code	mm	mm	mm	mm	mm	mm	mm
05003601001	10,0	37,0	15,5	24,0	17,0		1
05003602001	11,0	37,0	16,5	24,0	17,0		1
05003603001	12,0	37,0	17,5	24,0	17,0		1
05003604001	13,0	37,0	19,0	24,0	17,0		1
05003605001	14,0	37,0	20,0	24,0	17,0		1
05003606001	15,0	37,0	21,0	24,0	17,0		1
05003607001	16,0	37,0	22,5	24,0	17,0		1
05003608001	17,0	37,0	24,0	26,0	17,0		1
05003609001	18,0	37,0	25,0	26,0	17,0		1
05003610001	19,0	37,0	26,5	26,0	20,0		1
05003611001	20,0	37,0	28,0	26,0	20,0		1
05003612001	21,0	37,0	29,0	26,0	20,0		1
05003613001	22,0	37,0	30,5	26,0	20,0		1
05003614001	24,0	37,0	33,0	28,0	20,0		1
05003615001	27,0	40,0	36,5	32,0	23,0		1
05003616001	30,0	42,0	40,0	34,0	25,0		1
05003617001	32,0	42,0	42,0	36,0	25,0		1
05003618001		3/8"	37,0	15,5	24,0	17,0	1
05003619001		7/16"	37,0	16,5	24,0	17,0	1
05003620001		1/2"	37,0	19,0	24,0	17,0	1
05003621001		9/16"	37,0	20,0	24,0	17,0	1
05003622001		19/32"	37,0	21,0	24,0	17,0	1
05003623001		5/8"	37,0	22,5	24,0	17,0	1
05003624001		11/16"	37,0	25,5	26,0	17,0	1
05003625001		3/4"	37,0	26,5	26,0	20,0	1
05003626001		25/32"	37,0	28,0	26,0	20,0	1
05003627001		13/16"	37,0	29,0	26,0	20,0	1
05003628001		7/8"	37,0	30,5	26,0	20,0	1
05003629001		15/16"	37,0	33,0	28,0	20,0	1
05003630001		31/32"	37,0	33,0	28,0	20,0	1
05003631001		1"	40,0	36,5	32,0	23,0	1
05003632001		1 1/16"	40,0	36,5	32,0	23,0	1
05003633001		1 1/8"	40,0	40,0	34,0	23,0	1
05003634001		1 3/16"	42,0	40,0	34,0	25,0	1
05003635001		1 1/4"	42,0	42,0	36,0	25,0	1

? How to avoid buying many different ratchets

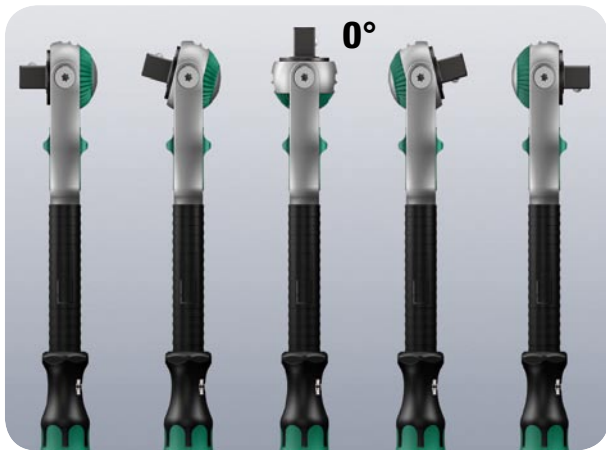

Due to its ingenious design, the Zyklop can be used as a fine-tooth ratchet, flex-head ratchet, angle ratchet, quick-release ratchet and power ratchet. The tool can even be used as a speedy conventional screwdriver in the 0° position.

The Zyklop Ratchet

The really fast mover!

1/2"

8796 SC Zyklop "flexible-lock" extension with free-turning sleeve, short, 1/2"



Application: 1/2" square drive sockets with ball lock

Design: Flexible lock system either for permanent interlocking or fast change of accessories, free-turning sleeve for rapid tightening or loosening of screws and nuts, chrome vanadium, brushed chrome-plated finish

Code	1/2"	mm	
05003642001	1/2"	125,0	1

8794 SC Zyklop extension with free-turning sleeve, short, 1/2"



Application: 1/2" square drive sockets with ball lock

Design: Easy-to-grip free-turning sleeve for rapid tightening or loosening of screws and nuts, chrome vanadium, brushed chrome-plated finish

Code	1/2"	mm	
05003637001	1/2"	125,0	1

8796 LC Zyklop extension "flexible-lock" with free-turning sleeve, long, 1/2"



Application: 1/2" square drive sockets with ball lock

Design: Flexible lock system either for permanent interlocking or fast change of accessories, free-turning sleeve for rapid tightening or loosening of screws and nuts, chrome vanadium, brushed chrome-plated finish

Code	1/2"	mm	
05003643001	1/2"	250,0	1

8794 LC Zyklop extension with free-turning sleeve, long, 1/2"



Application: 1/2" square drive sockets with ball lock

Design: Easy-to-grip free-turning sleeve for rapid tightening or loosening of screws and nuts, chrome vanadium, brushed chrome-plated finish

Code	1/2"	mm	
05003638001	1/2"	250,0	1



How to secure the socket when required

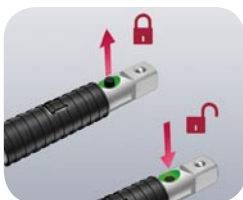

The extensions on the premium lines are also equipped with the "flexible-lock-system". By activating this system, attachments can be fixed to the extension permanently, preventing slipping and any unintentional loss of the attachment.

When the system is deactivated, the sockets can be attached as usual and changed in a flash.

8789 C Zyklop sliding T-handle, 1/2"



Application: 1/2" square drive sockets with ball lock

Design: Sliding drive, chrome vanadium, brushed chrome-plated finish

Code	1/2"	mm	
05003636001	1/2"	250,0	1

8795 C Zyklop universal joint, 1/2"



Application: 1/2" square drive sockets with ball lock

Design: Chrome vanadium/chrome molybdenum, brushed chrome-plated finish

Code	mm	
05003640001	1/2"	69,0

8784 C2 Zyklop adaptor, 1/2", 5/16"



Application: Suitable for 5/16" hex bits as per DIN 3126-C 8, ISO 1173 and Wera series 2

Design: Quick-release chuck for fast bit changes, chromium vanadium

Code	mm	
05003641001	5/16"	50,0

8794 C Zyklop wobble extension, 1/2"



Application: 1/2" square drive sockets with ball lock

Design: Swivels through 15°, chrome vanadium, brushed chrome-plated finish

Code	mm	
05003639001	1/2"	52,0

Display Zyklop, 1/2" drive



Application: 1/2" square drive sockets and 1/2" adaptors with square drive, equipped with ball lock

Design: Flywheel design and easy-to-grip free-turning sleeve for faster work, swivel ratchet head, defined lock positions at 0° and 90° to the left and right as well as at 15° before 90° inwards, at 0° it can be used like a conventional screwdriver, pushbutton release, left/right switchover, fine-tooth design, small return angle of 5°

Handle: Multi-component Kraftform handle ensures minimum fatigue

Code		
05003650001	8000 C	5 x 1/2"x277,0

? How to work quickly when there is too little resistance in the thread



Everyone knows the problem of when there is insufficient resistance on the thread to engage the ratchet on the return stroke, and it becomes irritating and time-consuming to fix. The Zyklop ratchets are really fast movers – their gyrating mass design means that

screwdriving is accelerated. The free-turning sleeve and the rotation-symmetric structure of the Kraftform handle reinforce this rapid twisting process.