

QPD W 3PE2,5 9-14 M25 FC BK

Order No.: 1582178



QUICKON panel feed-through, black, 3+PE-pos., 1.0 mm² ... 2.5 mm² / 690 V / 20 A, with QUICKON nut, for cable diameters of 9 mm ... 14 mm, with 4 slip-on contacts.

Commercial data

EAN	4046356316880
Pack	1
Customs tariff	85366990
Weight/Piece	34.70 g
Country of Origin	DE
Catalog page information	Page 389 (PC-2009)

Product notes

WEEE/RoHS-compliant since:
19/09/2007



Please note that the data given here has been taken from the online catalog. For comprehensive information and data, please refer to the user documentation at <http://www.download.phoenixcontact.com>. The General Terms and Conditions of Use apply to Internet downloads.

Technical data**General characteristics**

Design	QPD 4x2,5
Color	black
Locking type	Screw locking
Connection method	QUICKON connection

Type of connection	IDC connection
Number of positions	4
Note number of positions	3+PE
Wrench size, union nut	22 mm
Tightening torque, union nut	5 Nm
Tightening torque, counter nut	5 Nm
Wrench size, counter nut	27 mm
Number of connections	10
Conductor cross section stranded min.	1.5 mm ²
Conductor cross section stranded max.	2.5 mm ²
Conductor cross section solid min.	1 mm ²
Conductor cross section solid max.	1.5 mm ²
Conductor cross section AWG/kcmil min.	16
Conductor cross section AWG/kcmil max	14

Conductor data

Structure of individual litz in acc. with VDE 0295 / smallest wire diameter	VDE 0295 class 1 to 6 / min. 0.15 mm
Wire insulation material	PVC / PE
Wire diameter including insulation	2.5 mm ... 3.8 mm
External cable diameter	9 mm ... 14 mm

Environmental conditions

Degree of protection	IP68, 24 h / 2 m
Ambient temperature (operation)	-40 °C ... 80 °C
Ambient temperature (storage/transport)	-40 °C ... 80 °C
Temperature when conductor connected	-5 °C ... 50 °C

Electrical characteristics

Nominal current I_N	20 A
Rated current	20 A
Rated voltage (III/3)	690 V
Note on the rated voltage (III/3)	With insulating sleeve PT/FS 4,8, 1670497 without insulating sleeve 250 V.
Rated voltage (III/2)	1000 V
Rated voltage (II/2)	1000 V
Rated surge voltage (III/3)	6 kV
Rated surge voltage (III/2)	8 kV

Rated surge voltage (II/2)	8 kV
----------------------------	------

Mechanical characteristics

QUICKON connectability	max. 10
------------------------	---------

Material data

Contact material	CuZn
Contact surface material	Tin-plated
Contact carrier material	PA
Insulating material	PA
Inflammability class acc. to UL 94	V0
Surge voltage category	III
Pollution degree	3

Certificates

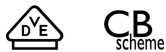

Certification CB, VDE-PZI

Accessories

Item	Designation	Description
1670497	PT/FS 4,8	Insulating sleeve, as touch protection, for 4.8 mm slip-on sleeves, slide onto the conductor before
1640715	Q-MU M25	Nut (plastic) to lock the contact carrier from the inside of the device

General

0806932	GPE 13X 9 WH	Plastic label sheet, self-adhesive double layer plastic labels, square corners, material thickness: 0.8 mm, suitable for plotting and engraving, color: white
1582462	KV-DI-PG16-1XASI	Seal for one AS-i line, 17.2 x 9 mm, from NBR, black, for IP65/67 degree of protection
1582464	KV-DI-PG16-2XASI	Seal for two AS-i lines, 17.2 x 9 mm, from NBR, black, for IP65/67 degree of protection
1582150	QPD QSK 2,5	Protective cap made of transparent plastic for QPD QUICKON connection 4x 2.5 mm ² , IP54.

1582488	QPD QSK 2,5 FS	Plastic protective cap, for QPD-QUICKON connectors, green, with holding band, IP68
---------	----------------	--

Marking

0819453	EMLP (13X9)R	Labels for thermal transfer printer
---------	--------------	-------------------------------------

Plug/Adapter

1582459	CP-QPD	Keying profile red, for pushing into the QUICKON dome and connector, can be positioned in 90° steps.
---------	--------	--

Protection and sealing elements

1400270	SEALING PLUG 14X22 RD	Closing cap, for closing unused bore holes in multiple seals and cable glands, diameter 14 mm
---------	-----------------------	---

Tools

1670206	QSS 22	Allen wrench, for loosening and fastening the QUICKON union nut, WAF 22 mm
---------	--------	--

Drawings

Diagram

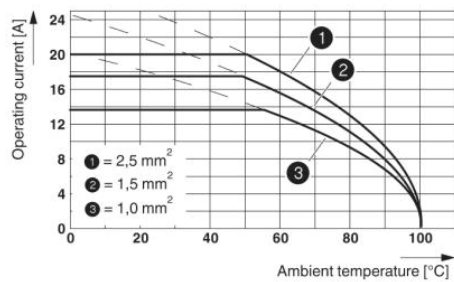

Dimensioned drawing

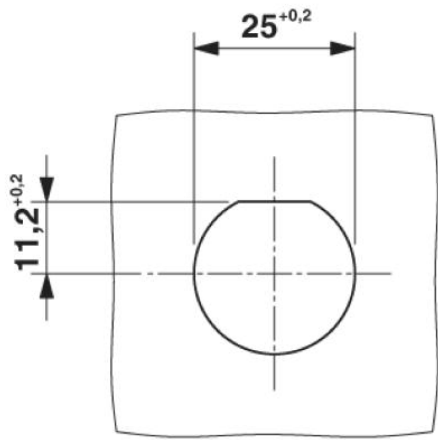

Address

PHOENIX CONTACT Ltd
Halesfield 13
Telford / Shropshire / TF7 4PG,England
Phone 01952 681 700
Fax 01952 681 799
<http://www.phoenixcontact.co.uk>



Phoenix Contact Ltd.
Technical modifications reserved;
