

H 316

Dimensions

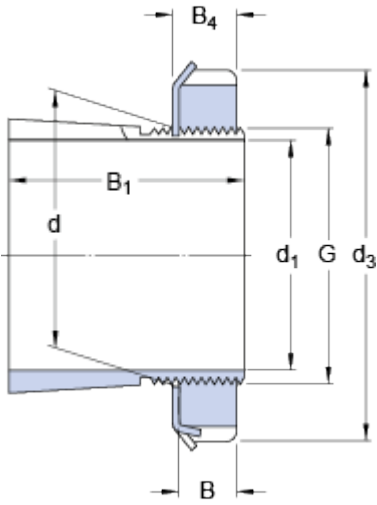

d_1	70	mm
d	80	mm
d_3	105	mm
B_1	59	mm
B	15	mm
B_4	17	mm
G	M 80x2	

Mass

Mass adapter sleeve assembly	0.95	kg
------------------------------	------	----

Appertaining products

Lock nut	KM 16
Locking device	MB 16

Appropriate products

Hydraulic nut	HMV 16 E
---------------	----------