

TOKO DEM2818C SAMPLE KIT DATA SHEET

DEM2818C



Features

- Low profile (2.8x3.0mm. square, 1.8mm Max. height).
- Magnetically shielded construction and low DC resistance.
- Ideal for a variety of DC-DC converter inductor applications.
- RoHS compliant.
- Halogen free.

Electrical characteristics

Inductance range

DEM2818C : 0.47~12 μ H

Recommended patterns

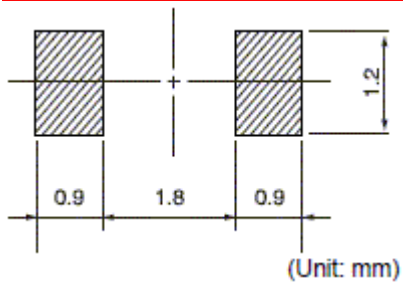

Dimensions

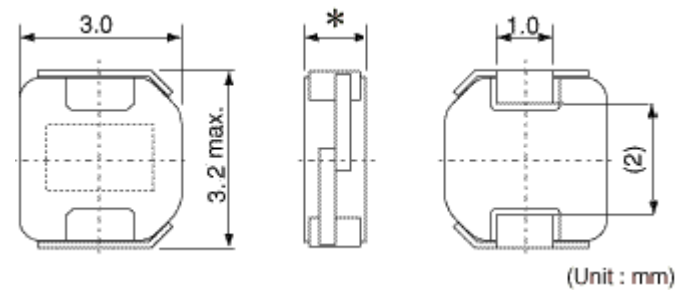

* DEM2818C : 1.8mm Max.

TOKO DEM2818C SAMPLE KIT DATA SHEET

<u>TOKO PART NUMBER</u>	<u>INDUCTANCE (μH)</u>	<u>TOLERANCE (%)</u>	<u>DC RESISTANCE (mΩ) Max. (Typ.)</u>	<u>Temperature Rise Current⁽³⁾ T=40C (A) Max. (Typ.)</u>	<u>QUANTITY PER SAMPLE BOX</u>
1227AS-H-R47N	0.47	+/-30	20 (17)	4.70 (5.50)	5
1227AS-H-1R0N	1.0	+/-30	29 (24)	3.70 (4.30)	5
1227AS-H-1R5N	1.5	+/-30	32 (27)	3.40 (4.00)	5
1227AS-H-2R2M	2.2	+/-20	47 (39)	2.60 (3.10)	5
1227AS-H-3R3M	3.3	+/-20	67 (56)	2.00 (2.40)	5
1227AS-H-4R7M	4.7	+/-20	92 (77)	1.80 (2.10)	5
1227AS-H-6R8M	6.8	+/-20	146 (122)	1.30 (1.50)	5
1227AS-H-100M	10.0	+/-20	204 (170)	1.20 (1.40)	5
1227AS-H-120M	12.0	+/-20	258 (215)	1.00 (1.20)	5

1) Inductance is measured with a LCR meter 4284A (Agilent Technologies) or equivalent. Test frequency at 100kHz

(2) DC resistance is measured with 34420A (Agilent Technologies) or 3541(HIOKI). (Reference ambient temperature 25°C)

(3) Maximum allowable DC current is that which causes a 30% inductance reduction from the initial value, or coil temperature to rise by 40°C, whichever is smaller. (Reference ambient temperature 20°C)