

NO	DESCRIPTION	DATE
⚠	ADD STRIPPING DIMENSION BACKGROUND FORMAT UPDATED	03.02.10*

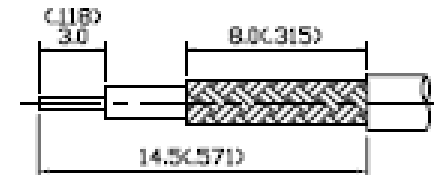
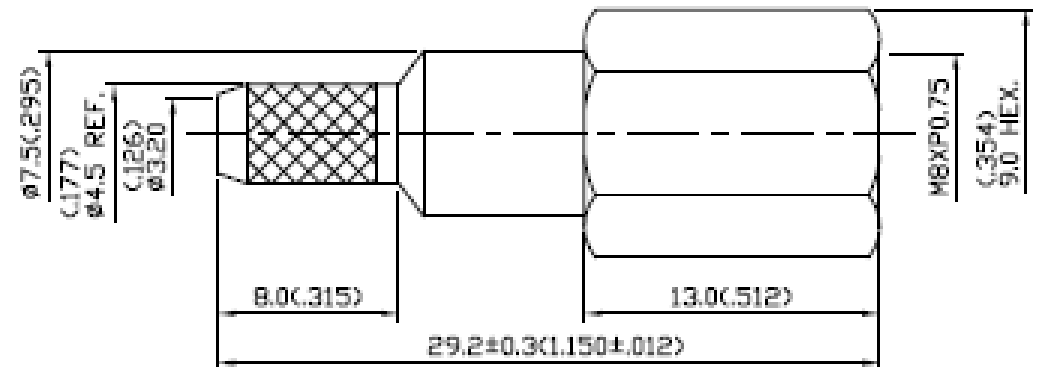
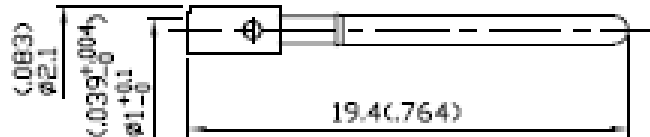
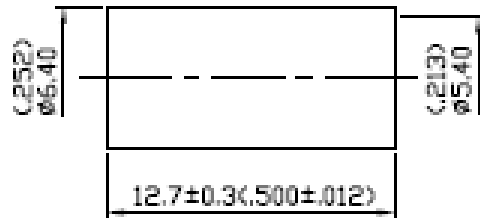

⚠ STRIPPING DIMENSION

1.0 ELECTRICAL

- 1.1 FREQUENCY RANGE: DC-900 MHz
1.2 NOMINAL IMPEDANCE: 50 OHM

2.0 MATERIALS

- 2.1 BODIES: BRASS PER JIS-C3604
2.2 CENTER CONTACT: BRASS PER JIS-C3604
2.3 INSULATION: TEFLON PER ASTM D1487 AND ASTM D1710
2.4 CRIMP FERRULE: BRASS PER JIS-C3700

3.0 FINISHES AND OTHERS

- 3.1 SEE BELOW TABLE FOR DETAILS.

4.0 MECHANICAL

- 4.1 FOR USE WITH NG58U OR SIMILAR STYLE CABLE
4.2 CABLE ATTACHMENT: OUTER: CRIMP, INNER: SOLDER/CRIMP
4.3 CRIMP SIZE REQUIRED: CONTACT: SOLDER/1.8(0.071) HEX. CRIMP TOOL
FERRULE: 3.5(0.138) HEX. CRIMP TOOL

5.0 ENVIRONMENTAL

- 5.1 OPERATING TEMPERATURE RANGE: -55° C TO +125° C

NO	DESCRIPTION	MATERIAL	Q'TY	FINISH
5	INSULATION	TEFLON	1	NONE
4	BODY	BRASS	1	NICKEL 100μ ² MIN.
3	INSULATION	TEFLON	1	NONE
2	CENTER CONTACT	BRASS	1	GOLD
1	CRIMP FERRULE	BRASS	1	NICKEL 100μ ² MIN.



APPROVED

by

DATE:

DESCRIPTION		FME STRAIGHT PLUG CRIMP	
製	DRAWN	TOLERANCE	品名
圖	Yoko	.X ±0.2	23-07 T.G.N 58U
檢	CHECK	.XX ±0.1	TITLE \ROHS COMPLIANT (500)
圖	Jacky	.XXX ±0.05	DATE 09.30.92*
定	APPROVAL	ANGLE ±5°	REV. A-1
定	Lewis		DWG.NO. 23-0032
			UNIT mm(In)
			SCALE 4:1