

**Ordering number C11793\_ANNA-40-4-S**

Family	Anna-40-4	FWHM	18 degrees
Type	Lens array	Efficiency	93 %
LED	LUXEON Rebel ES	cd/lm	6.100
Color	Clear	Gerber File	Available
Diameter	40 mm		
Height	10.7 mm		
Style	Round		
Optic Material	PMMA		
Holder Material	-		
Fastening	Pin, glue		
Status	Ready		

**Ordering number C11794\_ANNA-40-4-M**

Family	Anna-40-4	FWHM	27 degrees
Type	Lens array	Efficiency	87 %
LED	LUXEON Rebel ES	cd/lm	2.300
Color	Clear	Gerber File	Available
Diameter	40 mm		
Height	10.7 mm		
Style	Round		
Optic Material	PMMA		
Holder Material	-		
Fastening	Pin, glue		
Status	Ready		

**Ordering number C11795\_ANNA-40-4-W**

Family	Anna-40-4	FWHM	29 degrees
Type	Lens array	Efficiency	86 %
LED	LUXEON Rebel ES	cd/lm	2.200
Color	Clear	Gerber File	Available
Diameter	40 mm		
Height	10.7 mm		
Style	Round		
Optic Material	PMMA		
Holder Material	-		
Fastening	Pin, glue		
Status	Ready		

**NOTE: The typical divergence will be changed by different color, chip size and chip position tolerance. The typical total divergence is the full angle measured where the luminous intensity is half of the peak value.**



## PRODUCT DATASHEET

### Anna-40-4 series

last update 27/3/2012

PHILIPS  
LUMILEDS

#### GENERAL INFORMATION

- Product series especially designed & optimized for LUXEON Rebel ES series of LEDs.
- Special care taken to make light distribution as uniform as possible.
- Lens material optical grade PMMA with high UV and temperature resistance. Allows use of high current and temperature conditions.

Please find more information about used material from below:

[http://ledil.fi/sites/default/files/Documents/Technical/Material/PMMA%20N%20UL94\\_Yellow%20Card.pdf](http://ledil.fi/sites/default/files/Documents/Technical/Material/PMMA%20N%20UL94_Yellow%20Card.pdf)

<http://ledil.fi/sites/default/files/Documents/Technical/Material/PMMA%20N%20PLEXIGLAS-Datasheet.pdf>

D

C

B

A

4

4

3

3

2

2

1

1

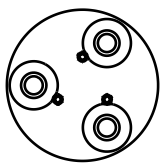

Anna-3

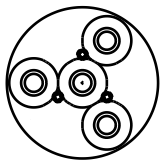

Anna-4

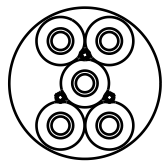

Anna-5

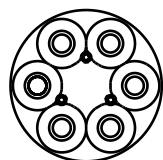

Anna-6

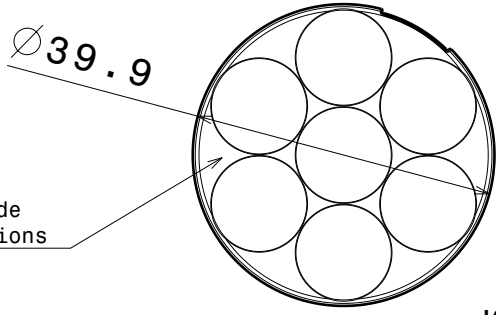
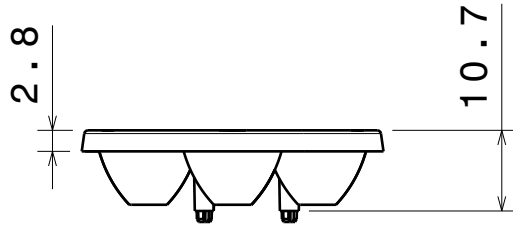

Anna-7

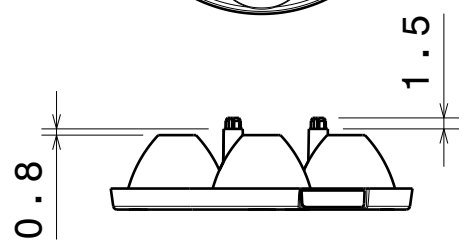

Same top side in all versions

Same location pin-circle in all versions

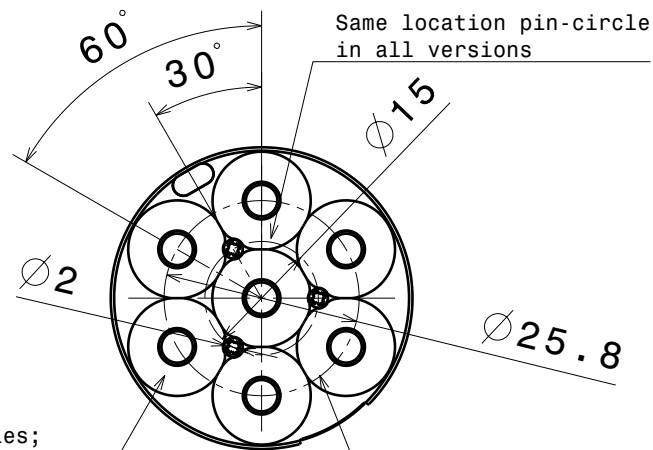

Number of cones varies; 3, 4, 5, 6 and 7pcs on bottom side depending the version.

Same led-circle in all versions

Material: PMMA

Versions:

- Anna-3-S
- Anna-3-M
- Anna-3-W
- Anna-4-S
- Anna-4-M
- Anna-4-W
- Anna-5-S
- Anna-5-M
- Anna-5-W
- Anna-6-S
- Anna-6-M
- Anna-6-W
- Anna-7-S
- Anna-7-M
- Anna-7-W

This drawing is our property. It can't be reproduced or communicated without our written agreement.



L  
T  
F  
F

e  
e  
i  
i  
N  
n

d  
h

DRAWING TITLE

Datasheet Anna40-series Lens

DRAWN BY

DATE

p

12.10.2010

CHECKED BY

DATE

s n

12.10.2010

SIZE

A4

DRAWING NUMBER

-

REV

1

DESIGNED BY

DATE

hh

30.07.2010

SCALE

1:1

WEIGHT (g)

SHEET

1/1

D

A