

Datasheet

Insulated Bootlace Ferrule, 12mm Pin Length

RS Stock number [513-2641](#)

Dimensions (mm)

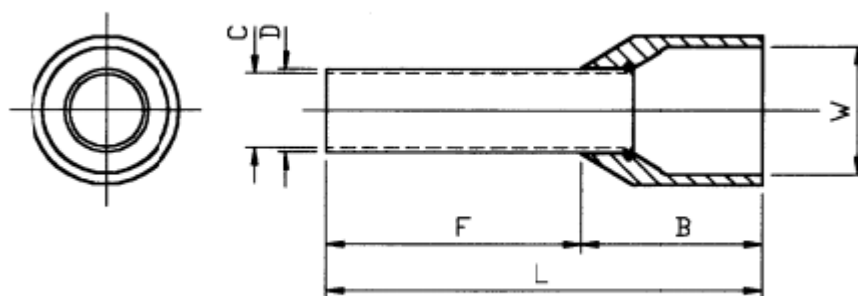

Stock Number	F ± 0.50	L ± 1.00	W ± 0.30	B ± 0.50	D ± 0.10	C ± 0.10	Colour
513-2641	12	20.5	6	8.5	3.9	3.5	YELLOW

Specifications

- Maximum Electrical Rating: 105 ° C 300 Volts Max
- Insulation Material: Nylon
- Terminal Material: Copper Tube
- Wire Range: 10A.W.G (6.0₂)