

holding system

NF1015 / NF1018



NF1022



NF1030 / NF1033

NF1021 / NF1024



MG71003



SPECIALTY HOLDERS

In respond to market demand NOGA offers 8 holders with special features.

Order no. Clamp

NF1021	8mm	<ul style="list-style-type: none"> • On/off switchable magnet. • Magnet dimensions - W30 x L40 x H35.
NF1024	3/8"	<ul style="list-style-type: none"> • Magnet force - 320N. • Weight: 0.575 Kg.
NF1030	8mm	<ul style="list-style-type: none"> • Permanent magnet. • Magnet dimensions - W16 x L60 x H32.
NF1033	3/8"	<ul style="list-style-type: none"> • Magnet force - 280N. • Weight: 0.545 Kg.

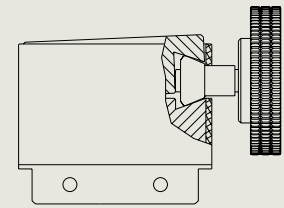

360° fine adjustment

- 5 axis holder.
- 360° fine adjustment at base.
- Holds indicator with stem and dovetail.
- Central locking mechanism with NOGA designed spring loaded bearing.
- Bottom arm - 56mm.
- Top arm - 51mm.
- Black finished arms.

NF1015	8mm	<ul style="list-style-type: none"> • Used for centering of workpieces.
NF1018	3/8"	<ul style="list-style-type: none"> • Holds indicator with stem or dovetail. • Central locking mechanism with spring loaded bearing. • Bottom arm - 56mm. • Top arm - 51mm. • Centering rod \varnothing 8mm x 40 mm. • Black finished arms. • Weight: 0.345 Kg.

NF1022	universal	<ul style="list-style-type: none"> • Universal fine adjustment, holds: 6mm, 8mm, 3/8", dovetail and back lug.
--------	-----------	--

MG71003	universal	<ul style="list-style-type: none"> • New fine adjustment on top with universal swivel clamp. • Holds 6mm, 8mm, 3/8", dovetail and back lug. • Central locking mechanism with NOGA designed spring loaded bearing. • 5 axis holder. • Powerful on/off magnetic base. • Instant fixation in any position. • Fast and easy to set up gauges into required position. • Black finished arms. • Bottom arm - 163.5 mm. • Top arm - 113 mm. • Bottom thread - Ext. M8. • Magnet force - 800N. • Magnet dimensions - W50 x L60 x H55. • Weight: 1.950 Kg.
---------	-----------	---