

# Deep groove ball bearings, single row, SKF Energy Efficient (E2) bearings

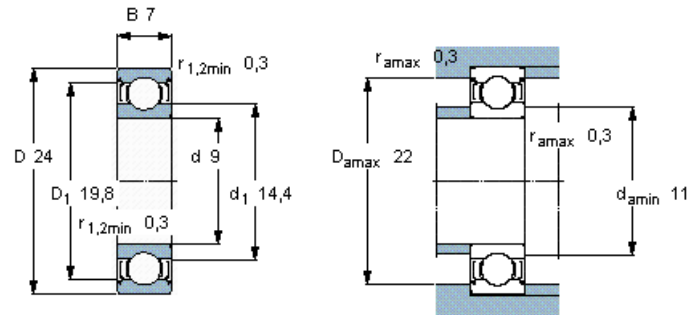

Principal dimensions			Basic load ratings		Fatigue load limit $P_u$	Speed ratings		Mass	Designation
d	D	B	dynamic	static		Reference speed	Limiting speed		
mm			kN		kN	r/min		kg	-
9	24	7	3,71	1,66	0,072	75000	37000	0,014	E2.609-2Z/C3



### Calculation factors

$k_r$  0,025  
 $f_0$  13