

Fast Ethernet PCI Adapter with Personal Firewall

EZ Installation - Fast Ethernet PCI Adapter with Personal Firewall
EZ Installation - Fast Ethernet PCI Adapter mit Personal Firewall Software
Installation EZ - Carte réseau Fast Ethernet PCI avec firewall personnel
Instalación EZ - Adaptador PCI Fast Ethernet con firewall personal
Installazione EZ - Scheda PCI Fast Ethernet con Personal firewall

Quick Installation Guide
Installationskurzanleitung
Guide d'installation rapide
Guía de inicio rápido
Guida rapida all'avvio

English 2 - 4

Deutsch 5 - 7

Français 8 - 10

Español 11 - 13

Italiano 14 - 16

Compliances, Copyright & Notes 17 - 20

Step 1... Unpack

EZ Card™ 10/100 Fast Ethernet PCI Card SMC1255TX-PF

Thank you for choosing the SMC Networks Wired 10/100 Mbps Network Interface Card (SMC1255TX-PF). This EZ Quick Installation Guide provides simple setup instructions. For more additional information, see the manual included on the CD-ROM.

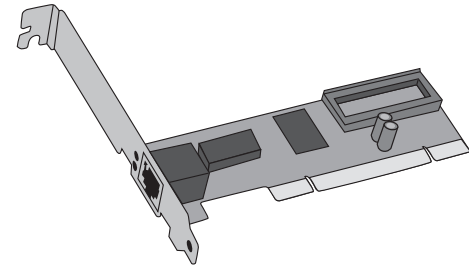

Box Contents:

- One EZ Card™ Fast Ethernet PCI Card (SMC1255TX-PF)
- One Quick Installation Guide
- One CD containing: Installation Wizard, Manual, and Driver

Before you begin verify the following:

- All of the box contents are included.
- At least one windows-based computer has a CD-ROM Drive.
- You have an Ethernet cable to attach to hub, switch, broadband router, broadband modem, etc.

Note: Please **DO NOT** install the SMC1255TX-PF prior to running the Installation Wizard.

Step 2... Load Installation Wizard

Once you have removed the SMC1255TX-PF contents from the box you are ready to install the EZ Installation Wizard.

- If the computer is off, turn it on.
- When computer boots up, insert the SMC1255TX-PF CD-ROM into the CD-ROM drive of the computer that you are going to install the SMC1255TX-PF.

Note: If the EZ Installation Wizard does not start automatically, follow the steps below to start the program:

1. Double-click the [My Computer] icon.
2. Double-click on the CD-ROM or Compact Disk icon to view the contents of the Installation CD.
3. Click on the [EZ Install] icon to launch the program.

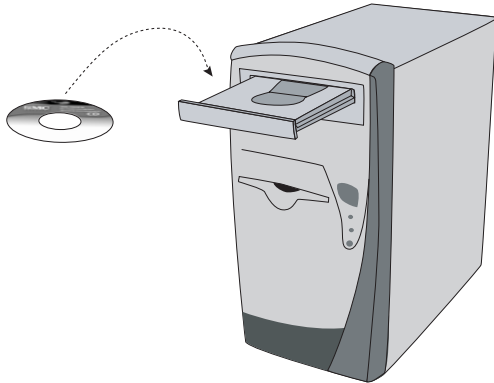

Macintosh Users!

If you are setting up the SMC1255TX-PF in a Macintosh, please see the manual on the Installation CD for instructions. The EZ Installation Wizard is not compatible with the MacOS.

Step 3... Installing Network Card

Note: Network cards are sensitive to static electricity. To protect the card, avoid touching its electrical components and always touch the metal chassis of your computer before handling the card.

1. Switch off the computer, unplug the power cord, and remove the computer's cover.
2. Select an unused PCI bus-master slot and remove its protective bracket.
3. Carefully insert the card and press until all the edge connectors are firmly seated inside the slot. Then screw the card's bracket securely into the PC's chassis.

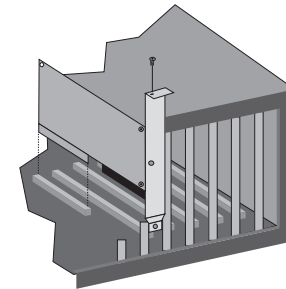

4. Connect the EZ Card™ Fast Ethernet PCI Card (SMC1255TX-PF) directly to a 10BASE-T or 100BASE-TX hub or switch using UTP cable (Category 3, 4, or 5 for 10BASE-T; Category 5 for 100BASE-TX). The maximum allowable length of UTP cable connections is 100 meters. When inserting an RJ-45 plug, be sure the tab on the plug clicks into position to ensure that it is properly seated.
5. Replace the computer's cover and power it on. Once the computer has booted you will be networked.

EZ Card™ 10/100 Fast Ethernet PCI-Karte SMC1255TX-PF

Danke für den Kauf dieser SMC Networks 10/100 MBit/s Netzwerkkarte (SMC1255TX-PF). Dieses Installationshandbuch enthält eine einfache Kurzanleitung. Weitere Informationen finden Sie im ausführlichen Handbuch auf der CD-ROM.

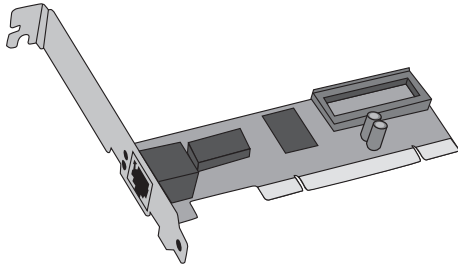

Lieferumfang:

- Eine EZ Card™ Fast Ethernet PCI-Karte (SMC1255TX-PF)
- Eine Installationskurzanleitung
- Eine CD mit: Installationsassistent, Handbuch und Treibern

Prüfen Sie vor Beginn Folgendes:

- Der Packungsinhalt ist vollständig.
- Mindestens ein Windows-basierter Computer verfügt über ein CD-ROM-Laufwerk.
- Sie verfügen über ein Ethernet-Kabel zum Anschluss des PCs an einen Hub, Switch, Breitband-Router, Breitband-Modem etc.

Hinweis: Installieren Sie die SMC1255TX-PF **ERST**, wenn Sie den Installationsassistenten ausgeführt haben.

- Wenn der Computer ausgeschaltet ist, schalten Sie ihn ein.
- Legen Sie die CD-ROM für die SMC1255TX-PF in das CD-ROM-Laufwerk des Computers ein, auf dem Sie die SMC1255TX-PF installieren wollen.

Hinweis: Wenn der EZ Installation-Assistent nicht automatisch startet, befolgen Sie die unten aufgeführten Schritte, um das Programm zu starten:

1. Doppelklicken Sie auf das Symbol [My Computer] (Arbeitsplatz) auf Ihrem Desktop.
2. Doppelklicken Sie auf das CD-ROM- oder CD-Symbol, um den Inhalt der Installations-CD anzuzeigen.
3. Klicken Sie auf das [EZ Install]-Symbol (Installation), um das Programm zu starten.

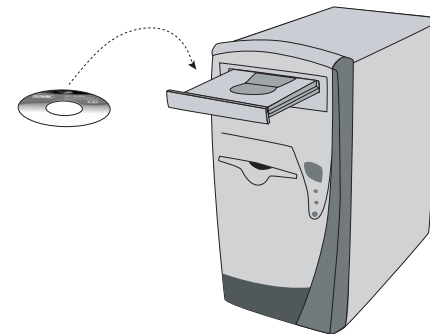

Hinweis für Macintosh-Benutzer:

Wenn Sie die SMC1255TX-PF in einem Macintosh installieren, beachten Sie die Hinweise im Handbuch auf der Installations-CD. Der EZ Installationsassistent ist nicht mit MacOS kompatibel.

Hinweis: Netzwerkkarten sind anfällig für statische Aufladungen. Vermeiden Sie es deshalb, die elektronischen Komponenten der Karte zu berühren, und fassen Sie immer erst kurz an das Metallgehäuse Ihres Computers, ehe Sie die Karte in die Hand nehmen.

1. Schalten Sie den Computer aus, ziehen Sie den Netzstecker und öffnen Sie das Computergehäuse.
2. Entfernen Sie die Schutzabdeckung von einem freiem PCI-Bus-Master-Steckplatz.
3. Stecken Sie die Karte ein, und drücken Sie vorsichtig, bis alle Anschluss-Pins fest mit dem Steckplatz verbunden sind. Drehen Sie anschließend die Befestigungsschraube der Karte am PC-Gehäuse fest.

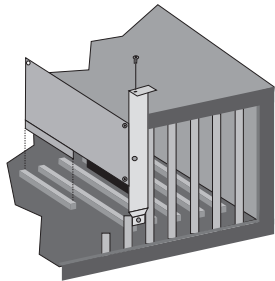

4. Verbinden Sie die Netzwerkkarte über ein UTP-Netzwerkkabel (Kategorie 3, 4 oder 5 für 10BASE-T; Kategorie 5 für 100BASE-TX) direkt mit einem- 10BASE-T/ 100BASE-TX Hub, Switch, Breitband Router etc. Die zulässige maximale Länge von UTP-Kabelverbindungen beträgt 100 m. Achten Sie beim Einstecken des RJ-45-Steckers darauf, dass die Verriegelung einrastet, damit die Verbindung hergestellt ist.
5. Bringen Sie die Computerabdeckung wieder an und schalten Sie den Computer ein. Nach dem Starten des Computers besteht eine Verbindung zum Netzwerk.

Carte réseau Fast Ethernet PCI 10/100 EZ Card™ SMC1255TX-PF

Merci d'avoir choisi la carte d'interface réseau SMC Networks SMC1255TX-PF. Ce Guide d'installation rapide fournit des instructions d'installation simples. Pour plus d'informations, consultez le manuel présent sur le CD-ROM.

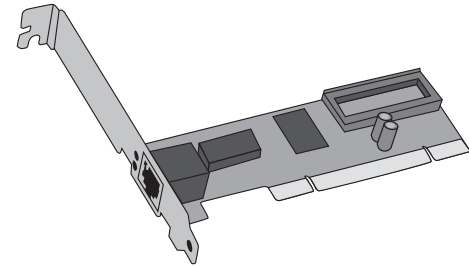

Contenu de l'emballage :

- Une carte réseau Fast Ethernet PCI EZ Card™ (SMC1255TX-PF)
- Un Guide d'installation rapide
- Un CD-ROM contenant : l'Assistant d'installation, le manuel et le driver

Avant de commencer, vérifiez les points suivants :

- Le contenu de l'emballage doit être complet.
- Un ordinateur sous Windows au moins doit disposer d'un lecteur de CD-ROM.
- Vous devez disposer d'un câble Ethernet pour la connexion à un concentrateur, un commutateur, un routeur haut débit, un modem haut débit, etc.

Remarque : veuillez à **NE PAS** installer la carte SMC1255TX-PF avant d'avoir exécuté l'Assistant d'installation.

Étape 2... Chargez l'Assistant d'installation

Retirez la carte SMC1255TX-PF de son emballage et tenez-vous prêt à installer l'Assistant EZ Installation Wizard.

- Si l'ordinateur est éteint, allumez-le.
- Lorsque l'ordinateur a démarré, insérez le CD-ROM de la carte SMC1255TX-PF dans le lecteur de CD-ROM de l'ordinateur destiné à recevoir la carte SMC1255TX-PF.

Remarque : si l'Assistant EZ Installation Wizard ne démarre pas automatiquement, effectuez les étapes suivantes pour le faire démarrer :

1. Double-cliquez sur l'icône [My Computer] (Poste de travail).
2. Double-cliquez sur l'icône de CD-ROM ou de disque compact pour voir le contenu du CD-ROM d'installation.
3. Cliquez sur l'icône [EZ Install] pour lancer le programme.

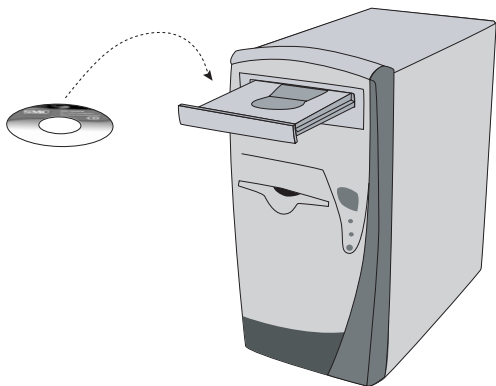

Utilisateurs de Macintosh !

Si vous installez la carte SMC1255TX-PF sur un Macintosh, consultez le manuel qui se trouve sur le CD-ROM d'installation pour prendre connaissance des instructions. L'Assistant EZ Installation Wizard n'est pas compatible avec MacOS.

Étape 3... Installez la carte réseau

Remarque : les cartes réseau sont sensibles à l'électricité statique. Pour protéger la carte, évitez de toucher ses composants électriques et veillez à toujours toucher le châssis en métal de votre ordinateur avant de la manipuler.

1. Éteignez l'ordinateur, débranchez son cordon d'alimentation et ouvrez son capot.
2. Choisissez un emplacement PCI bus master libre et retirez son cache de protection.
3. Introduisez délicatement la carte dans le connecteur, et appuyez jusqu'à que son connecteur-peigne soit enfoncé complètement dans le connecteur femelle PCI. Vissez ensuite la bride de protection sur le châssis de l'ordinateur.

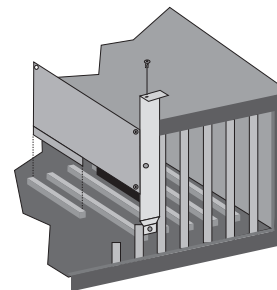

4. Raccordez la carte réseau Fast Ethernet PCI EZ Card™ (SMC1255TX-PF) directement à un concentrateur ou un commutateur 10BASE-T ou 100BASE-TX à l'aide d'un câble UTP (de catégorie 3, 4 ou 5 pour 10BASE-T, de catégorie 5 pour 100BASE-TX). La longueur maximale des liaisons par ce type de câble est de 100 mètres. Lors du branchement sur la prise RJ-45, vérifiez que les clips de fixation sont bien enclenchés pour assurer la connexion.
5. Remettez le capot de l'ordinateur en place, et rallumez ce dernier. Vous êtes connecté dès que l'ordinateur a démarré.

1º paso... Desempaquetar

Tarjeta PCI Fast Ethernet de 10/100 Mbps EZ Card™ SMC1255TX-PF

Gracias por escoger la tarjeta de interfaz de red de 10/100 Mbps cableada de SMC Networks (SMC1255TX-PF). En este manual de instalación rápida EZ encontrará instrucciones de instalación sencillas. Si desea más información, consulte el manual incluido en el CD-ROM.

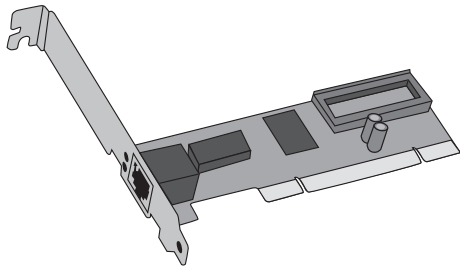

Contenido de la caja:

- Una tarjeta PCI Fast Ethernet EZ Card™ (SMC1255TX-PF)
- Un manual de instalación rápida
- Un CD con: el asistente de instalación, el manual y el controlador

Antes de empezar compruebe que:

- La caja contenga todos los componentes.
- Posea como mínimo un ordenador Windows con unidad de CD-ROM.
- Tenga un cable Ethernet para conectar con un hub, switch, router de banda ancha, módem de banda ancha, etc.

Nota: **NO** instale SMC1255TX-PF antes de ejecutar el asistente de instalación.

2º paso: Cargar el asistente de instalación

Una vez desempaquetado el contenido de SMC1255TX-PF, ya puede empezar con el asistente de instalación EZ.

- Encienda el ordenador.
- Introduzca el CD-ROM de SMC1255TX-PF en la unidad de CD-ROM del ordenador en el que quiera instalar SMC1255TX-PF.

Nota: Si el asistente de instalación EZ no se inicia de forma automática, siga los pasos indicados a continuación para ejecutar el programa:

1. Haga doble clic en el icono [My Computer] (Mi PC).
2. Haga doble clic en el icono del CD-ROM o el compact disc para ver el contenido del CD de instalación.
3. Pulse el icono [EZ Install] (EZ Install) para ejecutar el programa.

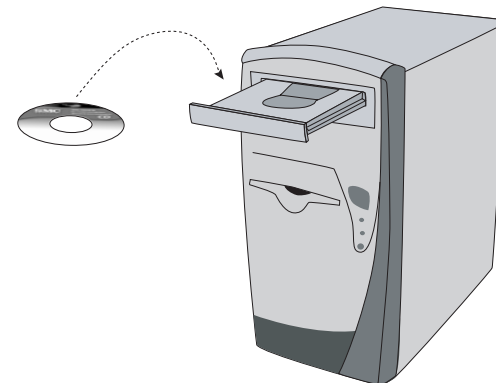

¡Usuarios de Macintosh!

Si instala SMC1255TX-PF en un Macintosh, consulte las instrucciones del manual incluido en el CD de instalación. El asistente de instalación EZ no es compatible con MacOS.

Nota: Las tarjetas de red son sensibles a la electricidad estática. Para preservar la tarjeta, no toque sus componentes eléctricos, y antes de manipularla, toque siempre el chasis metálico del ordenador.

1. Apague el ordenador, desconecte el cable de la corriente y retire la carcasa del ordenador.
2. Busque una ranura bus-master PCI que esté libre y quítele la pieza de sujeción protectora.
3. Introduzca la tarjeta con cuidado y presione hasta que todos los conectores de los extremos estén bien encajados en la ranura. A continuación, atornille la pieza de sujeción de la tarjeta en el chasis del ordenador.

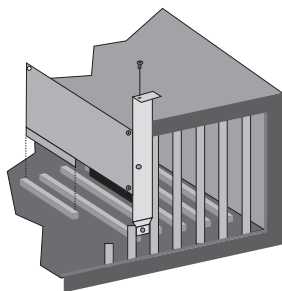

4. Conecte la tarjeta PCI Fast Ethernet EZ Card™ (SMC1255TX-PF) directamente a un hub o switch de 10BASE-T o 100BASE-TX mediante un cable UTP (categoría 3, 4 o 5 para 10BASE-T y categoría 5 para 100BASE-TX). La longitud máxima permitida de las conexiones con cable UTP es de 100 metros. Al insertar un conector RJ-45, asegúrese de que la pestaña quede bien colocada para garantizar una buena conexión.

5. Vuelva a colocar la carcasa del ordenador y enciéndalo. Una vez encendido, el ordenador ya estará en red.

Scheda PCI Fast Ethernet 10/100 EZ Card™ SMC1255TX-PF

Grazie per aver scelto la scheda di rete 10/100 Mbps SMC Networks cablata (SMC1255TX-PF). La presente guida rapida all'installazione di EZ fornisce istruzioni semplificate per la configurazione. Per ulteriori informazioni, consultare il manuale contenuto nel CD-ROM.

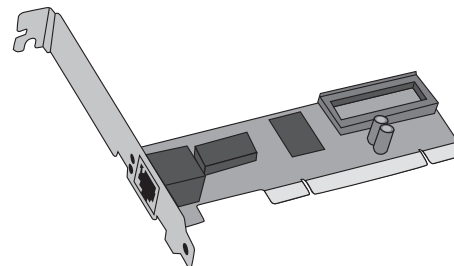

Contenuto della confezione:

- Una scheda PCI Fast Ethernet EZ Card™ (SMC1255TX-PF)
- Una guida rapida all'installazione.
- Un CD che contiene: installazione guidata, manuale e driver

Prima d'iniziare, verificare che:

- Tutti gli elementi della confezione siano presenti;
- Almeno un computer in ambiente Windows disponga di un'unità CD-ROM.
- Viene fornito un cavo Ethernet per il collegamento a hub, switch, router a banda larga, modem a banda larga, ecc.

Nota: Si prega di **NON** installare SMC1255TX-PF prima di aver eseguito l'installazione guidata

Dopo aver estratto il contenuto di SMC125TX-PF dalla scatola, è possibile eseguire l'installazione guidata EZ.

- Se il computer è spento, accenderlo.
- All'avvio, inserire il CD-ROM di SMC125TX-PF nella relativa unità del computer sul quale sarà installata SMC125TX-PF.

Nota: Se l'installazione guidata EZ non si avvia automaticamente, attenersi alla procedura descritta di seguito per l'avvio del programma:

1. Fare doppio clic sull'icona [My Computer] (Risorse del computer).
2. Fare doppio clic sull'icona del CD-ROM o del Compact Disc per visualizzare il contenuto del CD d'installazione.
3. Fare clic sull'icona [EZ Install] (Installa EZ) per avviare il programma.

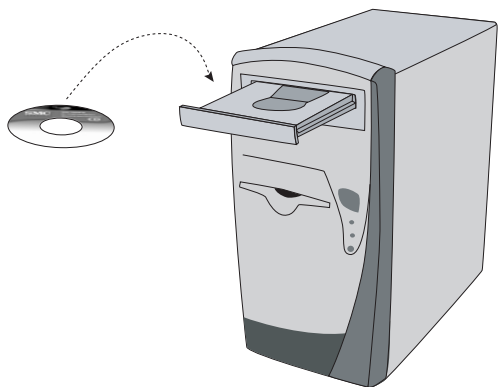

Utenti Macintosh!

Se si installa SMC125TX-PF su un Macintosh, leggere il manuale contenuto nel CD d'installazione per le relative istruzioni. L'installazione guidata EZ non è compatibile con i sistemi operativi Mac.

Nota: le schede di rete sono sensibili all'elettricità statica. Per proteggere la scheda, evitare il contatto con i componenti elettrici e toccare sempre la parte metallica del computer prima di maneggiare la scheda stessa.

1. Spegner il computer, disinserire il cavo di alimentazione e rimuovere la copertura del computer.
2. Selezionare uno slot PCI bus-master non utilizzato e rimuovere la barretta protettiva.
3. Inserire con cautela la scheda e premere finché tutti i connettori sul bordo non siano saldamente inseriti nello slot. Quindi avvitare fino in fondo la barretta della scheda all'interno del telaio del PC.

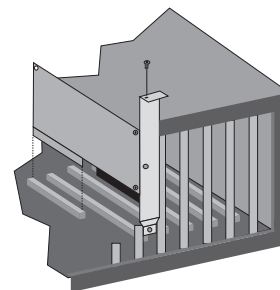

4. Collegare la scheda PCI Fast Ethernet EZ Card™ (SMC125TX-PF) direttamente a un Hub o a uno switch 10BASE-T o 100BASE-TX, utilizzando il cavo UTP (Categoria 3, 4, o 5 per 10BASE-T; categoria 5 per 100BASE-TX). La lunghezza massima consentita per i collegamenti con cavo UTP è 100 metri. Quando si inserisce un connettore RJ-45, controllare che la linguetta sul connettore scatti in posizione, per accertarsi che il fissaggio sia corretto.
5. Riposizionare la copertura e accendere il computer. Dopo aver avviato il computer, sarà stabilito il collegamento alla rete.

Federal Communication Commission Interference Statement

This equipment has been tested and found to comply with the limits for a Class B digital device, pursuant to Part 15 of the FCC Rules. These limits are designed to provide reasonable protection against harmful interference in a residential installation. This equipment generates, uses and can radiate radio frequency energy and, if not installed and used in accordance with the instructions, may cause harmful interference to radio communications. However, there is no guarantee that interference will not occur in a particular installation. If this equipment does cause harmful interference to radio or television reception, which can be determined by turning the equipment off and on, the user is encouraged to try to correct the interference by one of the following measures:

- Reorient or relocate the receiving antenna.
- Increase the separation between the equipment and receiver.
- Connect the equipment into an outlet on a circuit different from that to which the receiver is connected.
- Consult the dealer or an experienced radio/TV technician for help.

FCC Caution: Any changes or modifications not expressly approved by the party responsible for compliance could void the user's authority to operate this equipment.

This device complies with Part 15 of the FCC Rules. Operation is subject to the following two conditions: (1) This device may not cause harmful interference, and (2) this device must accept any interference received, including interference that may cause undesired operation.

IMPORTANT NOTE:

FCC Radiation Exposure Statement: This equipment complies with FCC radiation exposure limits set forth for an uncontrolled environment. This equipment should be installed and operated with minimum distance 20cm between the radiator & your body.

This transmitter must not be co-located or operating in conjunction with any other antenna or transmitter.

Industry Canada - Class B

This digital apparatus does not exceed the Class B limits for radio noise emissions from digital apparatus as set out in the interference-causing equipment standard entitled "Digital Apparatus," ICES-003 of the Department of Communications.

Cet appareil numérique respecte les limites de bruits radioélectriques applicables aux appareils numériques de Classe B prescrites dans la norme sur le matériel brouilleur : « Appareils Numériques », NMB-003 édictée par l'Industrie.

Firmware and Drivers

For latest driver, technical information and bug-fixes please visit www.smc-europe.com (section support).

Limited Lifetime Warranty Statement

For detailed information on SMC's limited lifetime warranty please visit www.smc-europe.com (section support, product registration).

Contact SMC

Contact details for your relevant countries are available on www.smc-europe.com and www.smc.com.

Statement of Conditions

In line with our continued efforts to improve internal design, operational function, and/or reliability, SMC reserves the right to make changes to the product(s) described in this document without notice. SMC does not assume any liability that may occur due to the use or application of the product(s) described herein. In order to obtain the most accurate knowledge of installation, bug-fixes and other product related information we advise to visit the relevant product support page at www.smc-europe.com before you start installing the equipment. All information is subject to change without notice.

Limitation of Liability

In no event, whether based in contract or tort (including negligence), shall SMC be liable for incidental, consequential, indirect, special or punitive damages of any kind, or for loss of revenue, loss of business or other financial loss arising out of or in connection with the sale, installation, maintenance, use, performance, failure or interruption of its products, even if SMC or its authorized reseller has been advised of the possibility of such damages.

Copyright

Information furnished by SMC Networks, Inc. (SMC) is believed to be accurate and reliable. However, no responsibility is assumed by SMC for its use, nor for any infringements of patents or other rights of third parties which may result from its use. No license is granted by implication or otherwise under any patent or patent rights of SMC. SMC reserves the right to change specifications at any time without notice.

Trademarks

SMC is a registered trademark and EZ Connect is a trademark of SMC Networks, Inc. Other product and company names are trademarks or registered trademarks of their respective holders.