

NSYSFPSC20

Post fixing device WM Spacial, length 200. For post max 675. Max. Load:100kg.

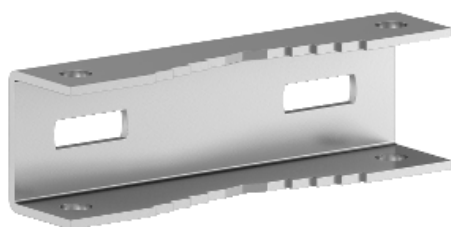

Main

Range	Spacial
Accessory / separate part category	Fixing accessory
Product or component type	Post fixing device
Application	Multi-purpose
Mounting location	Rear of enclosure
Range compatibility	Spacial SBM
Device composition	fixing elements 2 support rail 2 strip
Quantity per set	Set of 1

Complementary

Material	Galvanised steel
Fixing mode	By fixing element - screw type M8 - to the inserts in the rear of the enclosure location Minimum diameter 150 mm Maximum diameter 215 mm
Permanent permissible load	100 kg
Height	45 mm
Width	195 mm
Depth	32.5 mm
Product weight	1.048 kg

Offer Sustainability

Sustainable offer status	Green Premium product
REACH Regulation	REACH Declaration
REACH free of SVHC	Yes
EU RoHS Directive	Pro-active compliance (Product out of EU RoHS legal scope) EU RoHS Declaration

Toxic heavy metal free	Yes
Mercury free	Yes
RoHS exemption information	Yes
China RoHS Regulation	Download RoHS China Declaration Pro-active China RoHS declaration (out of China RoHS legal scope)
Environmental Disclosure	Product Environmental Profile
Circularity Profile	No need of specific recycling operations

Contractual warranty

Warranty	18 months
----------	-----------