

Datasheet

## RS Pro Cable Clip 15.2mm Black PE

RS Stock No: **184-4615**



### Product Details

RS Pro cable clip in black colour, has a maximum bundle diameter of 15.2 mm. The cable cleat is manufactured from low density polyethylene, which has high strength and impact resistance. The material is resistant to corrosion and UV light. It is stable at temperature of -30 to +60°C.

### Features and Benefits

- Comes in black colour
- Low density polyethylene (LDPE) construction
- Temperature range from -30 to +60°C

**Specifications:**

Affixing Method	Screw
Cable Clip/Clamp Style	Cable Clip
Colour	Black
Depth	31 mm
Dimensions [L x W (x D)]	20 x 31 mm
Material	PE
Maximum Bundle Diameter	15.2 mm
Width	20 mm

- MS4 = RS 184-4609**
- MS5 = RS 184-5214**
- MS6 = RS 184-4615**
- MS7 = RS 184-5220**
- MS8 = RS 184-4621**
- MS9 = RS 184-4637**
- MS10 = RS 184-4643**

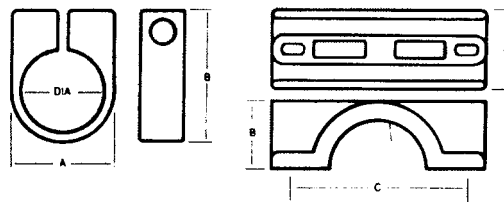

**Dimensional Data**

Reference Numbers	Dimensions			
	Width	Height	Fixing Centres	Clearance Bolt Holes
Standard Polypropylene	A mm	B mm	C mm	mm
<b>Single Fixing</b>				
MS 5	17.5	28.0	N/A	6
MS 6	20.0	31.0	N/A	6
MS 7	23.0	34.0	N/A	6
MS 8	25.0	38.0	N/A	6
MS 9	28.5	41.0	N/A	6
MS 10	30.0	43.5	N/A	6

Size:

**MS 6**

Qty:

**50**

Conductor size mm <sup>2</sup>	Copper conductor wire armoured Number of cores				Aluminium conductor wire armoured Number of cores					MULTICORE CABLES		
										Conductor size		
										1.5mm <sup>2</sup>	2.5mm <sup>2</sup>	4mm <sup>2</sup>
1.5	5	5	6						5 core	6	7	8
2.5	6	6	6						7 core	6	7	9
4	6	7	7						10 core	8	9	11
6	7	8	8						12 core	8	9	11
10	8	9	9						19 core	9	10	12
16	9	10	11	7	8	9			27 core	10	12	16
25	10	11	12	9	10	12			37 core	12	14	
35	12	12	14	10	10	12			48 core	14	16	
50	7	11	12	14	8	10	12	14				
70	8	12	14	16	8	12	14	16				
95	9	14	16	18	9	14	16	18				
120	10	16	18	20	10		16	20				
150	11	16	18		12		18	20				
185	12	18			12		20					
240	14	20			14							
300	16				14							