

# Housing - HC-ADV-B10-SHFH-2STM25-EEE - 1408753

Please be informed that the data shown in this PDF Document is generated from our Online Catalog. Please find the complete data in the user's documentation. Our General Terms of Use for Downloads are valid (<http://phoenixcontact.com/download>)



HEAVYCON ADVANCE B10 box mounting base, for M6 screw locking, salt-water-resistant aluminum, with 2 x M25 thread, without surface coating



## Key commercial data

Packing unit	1 pc
GTIN	 4 046356 583367
Weight per Piece (excluding packing)	425.1 g
Custom tariff number	85389099
Country of origin	China

## Technical data

### Dimensions

Height	68 mm
Width	45 mm
Length	105 mm

### Ambient conditions

Degree of protection of housing (IP)	IP66
	IP68 (0.2 bar/24 h)
	IP69K
Degree of protection of housing (NEMA)	4 (UL50e / NEMA 250)
	4X (UL50e / NEMA 250)
	6P (UL50e / NEMA 250)
	12 (UL50e / NEMA 250)
Ambient temperature (operation)	-40 °C ... 125 °C

### General

Note	For contact inserts HC-B10, BB18, DD42, M, K8/24
Type	B10
Housing type	Box mounting bases

# Housing - HC-ADV-B10-SHFH-2STM25-EEE - 1408753

## Technical data

### General

Locking type	Screw locking
Fixing screws	M6
No. of cable outlets	2
Cable exit	Lateral
Screw connection	none
Type of the screw connection	2x M25
Housing material	Die-cast aluminum, corrosion resistant
Housing surface material	Uncoated
Connection	To ensure optimum shielding, any insulating powder coating must be removed from the housing support area on the control cabinet panel

## Classifications

### eCl@ss

eCl@ss 4.0	27140816
eCl@ss 4.1	27140816
eCl@ss 5.0	27143424
eCl@ss 5.1	27143424
eCl@ss 6.0	27261203
eCl@ss 7.0	27440202
eCl@ss 8.0	27440202

### ETIM

ETIM 4.0	EC000437
ETIM 5.0	EC000437

### UNSPSC

UNSPSC 6.01	31261502
UNSPSC 7.0901	31261502
UNSPSC 11	31261502
UNSPSC 12.01	31261502
UNSPSC 13.2	31261502

## Approvals

### Approvals

---

Approvals

EAC

---

Ex Approvals

# Housing - HC-ADV-B10-SHFH-2STM25-EEE - 1408753

## Approvals

---

Approvals submitted

---

## Approval details

EAC
-----

## Accessories

### Accessories

#### Extension adapter

Extension adapter - ENLAR-M-KV-M25/M32 - 1647679



Step-up adapter, M25 to M32, including O-ring

---

#### Full screw connection

Cable gland - G-INS-M25-M68N-PNES-GY - 1411126



Cable gland, Cable gland material: Polyamide 6, External cable diameter 11 mm ... 17 mm, Shielding: No, Connecting thread: M25, Color: silver grey

---

Cable gland - G-INS-M25-M68N-PNES-BK - 1411134



Cable gland, Cable gland material: Polyamide 6, External cable diameter 11 mm ... 17 mm, Shielding: No, Connecting thread: M25, Color: jet black

---

Cable gland - G-INS-M25-M68N-NNES-S - 1411165



Cable gland, Cable gland material: Brass, nickel-plated, External cable diameter 11 mm ... 17 mm, Shielding: No, Connecting thread: M25, Color: silver

---

## Housing - HC-ADV-B10-SHFH-2STM25-EEE - 1408753

### Accessories

Cable gland - HC-M-KV-M25(14-21) - 1646007



Metal screw connection up to 5 bar, thread length: 7 mm, cable diameter: 14 - 21 mm, WAF 34, screw connection: M25

---

Cable gland - G-INSEC-M25-S68N-NCRS-S - 1411190



Cable gland, Cable gland material: Brass, nickel-plated, External cable diameter 11 mm ... 16 mm, Shielding: Yes, Connecting thread: M25, Color: silver

---

Cable gland - HC-M-KV-Z-M25 - 1646159



Metal screw connection with strain relief clamp, thread length: 7 mm, cable sealing area: 10 - 19 mm, clamping area: 12 - 22 mm, SW 30, screw connection: M25

---

Cable gland - HC-M-KV-T-M25 - 1646191



Metal screw connection with cable bend protection and strain relief, thread length: 7 mm, cable sealing area: 10 - 19 mm, clamping area: 14 - 21 mm, SW 30, screw connection: M25

---

Plug for cable screw gland

Filler plugs - HC-M-BS-M25 - 1645859



Filler plug, metal, size: M25

---

Protective cover

## Housing - HC-ADV-B10-SHFH-2STM25-EEE - 1408753

### Accessories

Protective covers - HC-B 10-TMS-SD-IP50 - 1690749



HEAVYCON ADVANCE IP50 protective cover B10, for panel mounting side, with clip locking, with retaining cord, diameter of retaining cord eyelet 3 mm

Protective covers - HC-B 10-TMS-SD-IP65 - 1690781



HEAVYCON ADVANCE IP65 protective cover B10, for panel mounting side, with screw locking, with retaining cord, diameter of retaining cord eyelet 3 mm

### Reducing adapter

Reducing adapter - REDUC-M-KV-M25/M20 - 1647624



Step-down adapter, M25 to M20, including O-ring

### Drawings

Dimensioned drawing

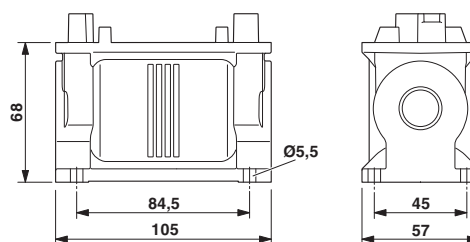

Dimensional drawing