



2NO+2NC CONTACTOR,
AC3: 4KW DC 24V 4-POLE, 2NO+2NC,
SZ: S00, SCREW TERMINAL

General technical data:

| | | |
|---|----|----------------------------|
| product brand name | | SIRIUS |
| Size of the contactor | | S00 |
| Product extension / auxiliary switch | | Yes |
| Protection class IP / on the front | | IP20 |
| Protection against electrical shock | | finger-safe |
| Degree of pollution | | 3 |
| Installation altitude / at a height over sea level / maximum | m | 2,000 |
| Ambient temperature | | |
| • during storage | °C | -55 ... +80 |
| • during operating | °C | -25 ... +60 |
| Shock resistance | | |
| • at rectangular impulse | | |
| • at DC | | 6,7g / 5 ms, 4,2g / 10 ms |
| • at sine pulse | | |
| • at DC | | 10,5g / 5 ms, 6,6g / 10 ms |
| Impulse voltage resistance / rated value | kV | 6 |
| Insulation voltage / rated value | V | 690 |
| Mechanical operating cycles as operating time | | |
| • of the contactor / typical | | 30,000,000 |

- of the contactor with added auxiliary switch block / typical
- of the contactor with added electronics-compatible auxiliary switch block / typical

10,000,000

5,000,000

Main circuit:

| | | |
|--|-----|--------|
| Number of NC contacts / for main contacts | | 2 |
| Number of NO contacts / for main contacts | | 2 |
| Operating current | | |
| • at AC-1 / at 400 V | | |
| • at 40 °C ambient temperature / rated value | A | 22 |
| • at 60 °C ambient temperature / rated value | A | 20 |
| • at AC-2 / at 400 V / rated value | A | 9 |
| • at AC-3 / at 400 V / rated value | A | 9 |
| • at AC-4 / at 400 V / rated value | A | 8.5 |
| Operating current | | |
| • with 1 current path / at DC-1 | | |
| • at 24 V / rated value | A | 20 |
| • at 110 V / rated value | A | 2.1 |
| • with 2 current paths in series / at DC-1 | | |
| • at 24 V / rated value | A | 20 |
| • at 110 V / rated value | A | 12 |
| • with 1 current path / at DC-3 / at DC-5 | | |
| • at 24 V / rated value | A | 20 |
| • at 110 V / rated value | A | 0.1 |
| • with 2 current paths in series / at DC-3 / at DC-5 | | |
| • at 24 V / rated value | A | 20 |
| • at 110 V / rated value | A | 0.35 |
| Service power | | |
| • at AC-2 / at 400 V / rated value | kW | 4 |
| • at AC-3 / at 400 V / rated value | kW | 4 |
| • at AC-4 / at 400 V / rated value | kW | 4 |
| Active power loss / per conductor / typical | W | 0.7 |
| Off-load operating frequency | | |
| • at AC | 1/h | 10,000 |
| • at DC | 1/h | 10,000 |
| Frequency of operation / at AC-1 / according to IEC 60947-6-2 | 1/h | 1,000 |
| Frequency of operation / at AC-2 / according to IEC 60947-6-2 | 1/h | 750 |
| Frequency of operation / at AC-3 / according to IEC 60947-6-2 | 1/h | 750 |
| Frequency of operation / at AC-4 / according to IEC 60947-6-2 | 1/h | 250 |

Control circuit:

- with type of assignment 1 / required
- at type of coordination 2 / required

gL/gG LV HRC 3NA, DIAZED 5SB, NEOZED 5SE: 35 A
 gL/gG LV HRC 3NA, DIAZED 5SB, NEOZED 5SE: 20A

Installation/mounting/dimensions:

| | | |
|---|----|--|
| mounting position | | +/-180° rotation possible on vertical mounting surface; can be tilted forward and backward by +/- 22.5° on vertical mounting surface |
| Type of mounting | | screw and snap-on mounting onto 35 mm standard mounting rail according to DIN EN 50022 |
| Type of fixing/fixation / series installation | | Yes |
| Width | mm | 45 |
| Height | mm | 57.5 |
| Depth | mm | 73 |
| Distance, to be maintained, to the ranks assembly / sideways | mm | 0 |
| Distance, to be maintained, to earthed part / sideways | mm | 6 |

Connections:

| | | |
|---|--|---|
| Design of the electrical connection | | |
| <ul style="list-style-type: none"> • for main current circuit • for auxiliary and control current circuit | | <p>screw-type terminals</p> <p>screw-type terminals</p> |
| Type of the connectable conductor cross-section | | |
| <ul style="list-style-type: none"> • for main contacts <ul style="list-style-type: none"> • solid • finely stranded <ul style="list-style-type: none"> • with conductor end processing • for AWG conductors / for main contacts • for auxiliary contacts <ul style="list-style-type: none"> • solid • finely stranded <ul style="list-style-type: none"> • with conductor end processing • for AWG conductors / for auxiliary contacts | | <p>2x (0.5 ... 1.5 mm²), 2x (0.75 ... 2.5 mm²), 2x 4 mm²</p> <p>2x (0.5 ... 1.5 mm²), 2x (0.75 ... 2.5 mm²)</p> <p>2x (20 ... 16), 2x (18 ... 14), 2x 12</p> <p>2x (0.5 ... 1.5 mm²), 2x (0.75 ... 2.5 mm²), 2x 4 mm²</p> <p>2x (0.5 ... 1.5 mm²), 2x (0.75 ... 2.5 mm²)</p> <p>2x (20 ... 16), 2x (18 ... 14), 2x 12</p> |

Certificates/approvals:

General Product Approval

Declaration of Conformity



Test Certificates

[Special Test Certificate](#)

[Type Test Certificates/Test Report](#)

Shipping Approval



Shipping Approval

other



[Confirmation](#)



UL/CSA ratings:

| | | |
|---|----|-------------|
| <p>yielded mechanical performance (hp)</p> <ul style="list-style-type: none"> for single-phase squirrel cage motors <ul style="list-style-type: none"> at 110/120 V / rated value at 230 V / rated value for three-phase squirrel cage motors <ul style="list-style-type: none"> at 220/230 V / rated value at 460/480 V / rated value | hp | 0.33 |
| | hp | 1 |
| | hp | 3 |
| | hp | 5 |
| <p>Operating current (FLA) / for three-phase squirrel cage motors</p> <ul style="list-style-type: none"> at 480 V / rated value | A | 7.6 |
| <p>Contact rating designation / for auxiliary contacts / according to UL</p> | | A600 / Q600 |

Sicherheitsrelevante Kenngrößen:

| | | |
|--|-----|-----------|
| <p>B10 value / with high demand rate</p> <ul style="list-style-type: none"> according to SN 31920 | | 1,000,000 |
| <p>T1 value / for proof test interval or service life</p> <ul style="list-style-type: none"> according to IEC 61508 | a | 20 |
| <p>Proportion of dangerous failures</p> <ul style="list-style-type: none"> with low demand rate / according to SN 31920 with high demand rate / according to SN 31920 | % | 40 |
| | % | 73 |
| <p>Failure rate (FIT value) / with low demand rate</p> <ul style="list-style-type: none"> according to SN 31920 | FIT | 100 |
| <p>Product function</p> <ul style="list-style-type: none"> mirror contact to IEC 60947-4-1 | | Yes |

- comment
- positively driven operation to IEC 60947-5-1

with 3RH29

No

Further information:

Information- and Downloadcenter (Catalogs, Brochures,...)

<http://www.siemens.com/industrial-controls/catalogs>

Industry Mall (Online ordering system)

<http://www.siemens.com/industrial-controls/mall>

Cax online generator:

<http://www.siemens.com/cax>

Service&Support (Manuals, Certificates, Characteristics, FAQs,...)

<http://support.automation.siemens.com/WW/view/en/3RT2516-1BB40/all>

Image database (product images, 2D dimension drawings, 3D models, device circuit diagrams, ...)

http://www.automation.siemens.com/bilddb/cax_en.aspx?mlfb=3RT2516-1BB40

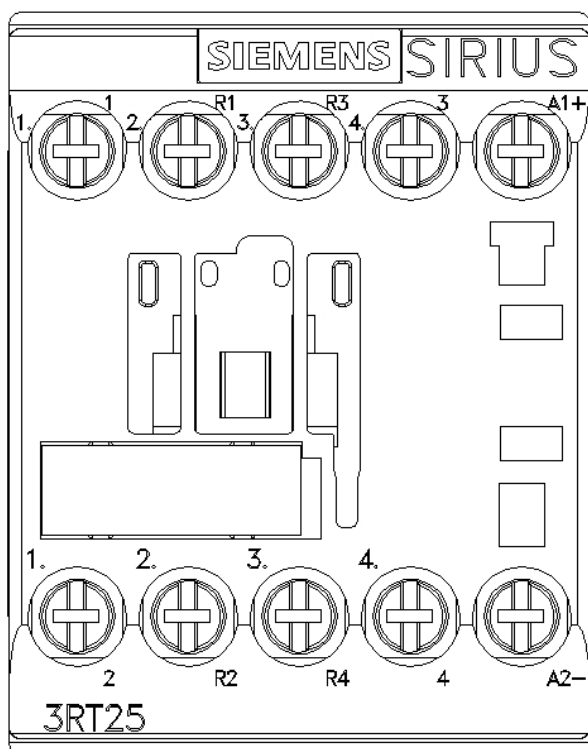
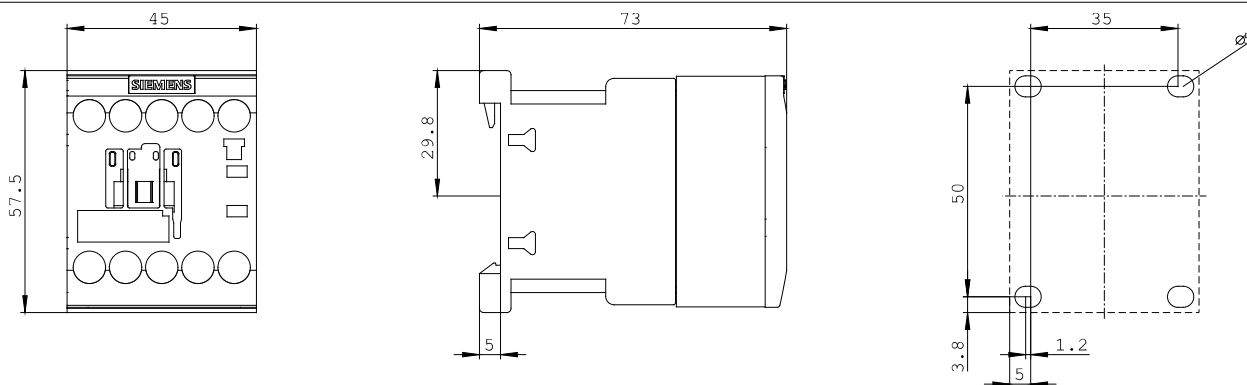

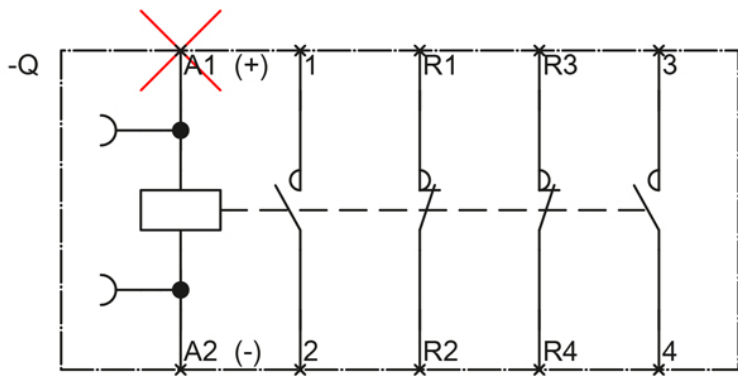

last change:

Jul 26, 2012