

USED ON

POLZAHL	1-REIHIG	2-REIHIG	3-REIHIG
1			
2	925366-2		
3			
4			
5	925366-5		
6	925366-6		
7			
8			
9			
10	1-925366-0		
11			
12			
13			
14			
15	1-925366-5		
16			
17			
18			
19			
20	2-925366-0		
21			
22			
23			
24			
25	2-925366-5		
26			
27			
28			
29			
30	3-925366-0		
31			
32			
33			
34			
35	3-925366-5		
36			
37			
38			
39			
40	4-925366-0		
41			
42			
43			
44			
45	4-925366-5		
46			
47			
48			
49			
50	5-925366-0		
51			

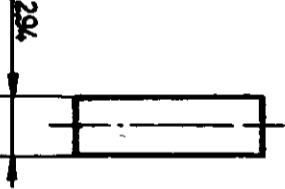
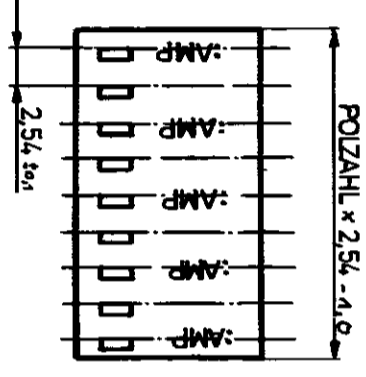
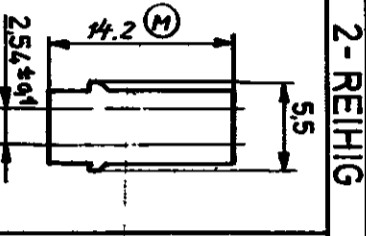
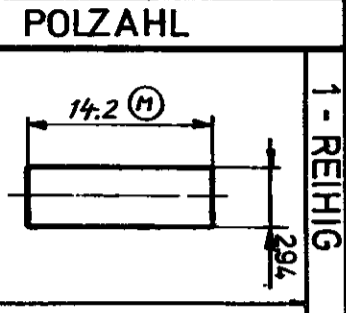

MAT.: POLYAMID 66
FARBE: GRÜN, 6011

AMP - MODU IV GEHÄUSE



Zeichnung geschützt durch
© Copyright 1975
AMP DEUTSCHLAND GmbH
Alle Rechte vorbehalten



AMP DEUTSCHLAND GmbH
Langen b. Frankfurt/Main

AUSGABE

04/11/84

~~925368 WIRD ALS 925366 UND 925367 HERGESTELLT~~

925366-368

UNLESS OTHERWISE SPECIFIED		FRACTIONS: ± 1/64	DECIMALS: 0.00 ± 0.005	0.000 ± 0.002
MATERIAL		OR S-42 35 APP		
Polyamid		Dahlmann		
HEAT TREAT		CHR 1/11		
COATING OR PLATING		AMP Deutschland G.m.b.H. Langen b. Frankfurt/Main Germany		
SCALE		LOC: C ^{NO} 925366-368		
NAME		MODU IV. GEHÄUSE		
REVISION RECORD		DATE		
LTR	ECN	DATE		

5726-51 SVN

RIGHTS RESERVED BY AMP INCORPORATED, MILWAUKEE, WISCONSIN, U.S.A.

UNLESS OTHERWISE SPECIFIED DIMENSIONS ARE IN INCHES DO NOT SCALE PRINT