



ENCLOSURE FOR COMMAND DEVICES, 22MM, ROUND, ENCLOSURE MATERIAL METAL, ENCLOSURE TOP PART GRAY, 6 COMMAND POINTS, UNEQUIPPED, RECESS FOR LABELS, BASE MOUNTING, TOP AND BOTTOM 1 X M25 EACH

Figure similar

product brand name		SIRIUS ACT
Product designation		Commanding and signaling devices
Design of the product		Surface-mounted housing

Enclosure:

Design of the housing		with recess for label
Shape of the enclosure front		rectangular
Material of the enclosure		metal
Number of control points		6
Product component		
• protective collar		No
Color		
• of top part of the enclosure		grey
Mounting type of the enclosure		Vertical / horizontal

Installation/ mounting/ dimensions:

Height	mm	280
Width	mm	85
Depth	mm	63.8
Mounting diameter	mm	22

Certificates/ approvals:

Further information

Information- and Downloadcenter (Catalogs, Brochures,...)

<http://www.siemens.com/industrial-controls/catalogs>

Industry Mall (Online ordering system)

<http://www.siemens.com/industrymall>

Cax online generator

<http://support.automation.siemens.com/WW/CAXorder/default.aspx?lang=en&mlfb=3SU18560AA000AB1>

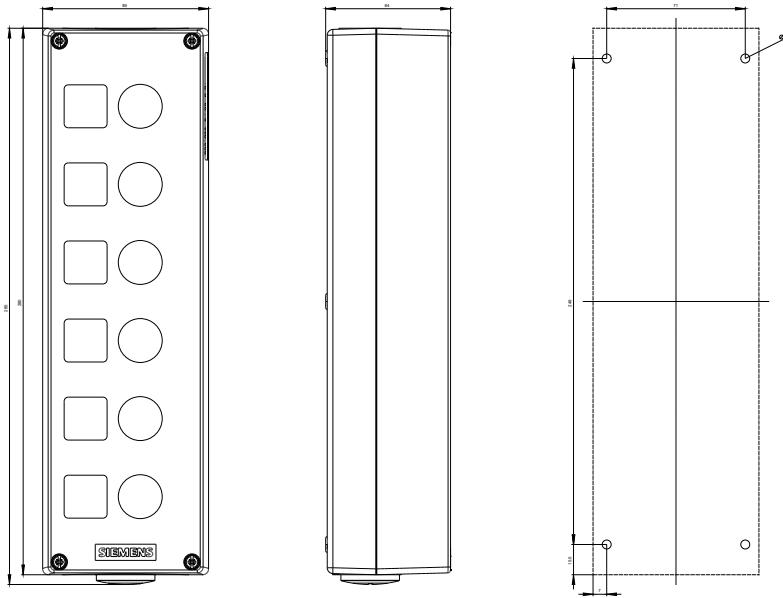

last modified:

09.03.2015