

## The expansion plug for fixings in gypsum plasterboard, gypsum fibreboard and wooden panels



Towel rails



Small shelves

### BUILDING MATERIALS

- Gypsum plasterboard and gypsum fibreboards
- Wooden boards
- MDF boards
- Multiplex boards
- OSB boards
- Plywood boards
- Chipboard
- Wood core plywood boards

### CHARACTERISTICS



### ADVANTAGES

- The operating principle of the fixing allows for use in various board thicknesses including in low cavity depths. This provides great flexibility.
- The special fixing geometry with a nylon cone ensures a high tightening torque that can be identified immediately. This offers a high level of installation safety.
- The longitudinal ribs prevent the fixing from rotating in the drill hole, thus allowing for a reliable installation.

### APPLICATIONS

- Pictures
- Lighting
- Shelves
- Towel rails
- Mirror cabinets
- Curtain rails

### FUNCTIONING

- The board fixing PD is suitable for pre-positioned installation.
- Use rotary drilling to create the drill hole.
- When the screw is tightened, the plastic cone is pulled into the sleeve and expands the fixing.
- Use full-thread screws, or alternatively, the part of the screw without thread may not be longer than the thickness of the item being attached.
- Must be used with chipboard screws.
- Do not use screws with double-start threads.

### INSTALLATION

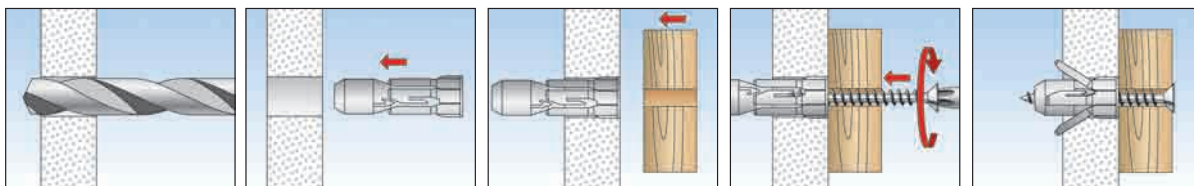

## TECHNICAL DATA

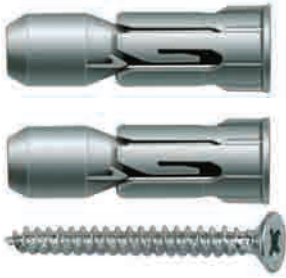

Board fixing **PD**

Board fixing **PD S** - with chipboard screw

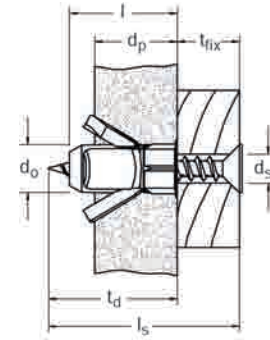

| Items to order only |                             | Drill hole diameter | Min. drill hole depth | Min. panel thickness | Anchor length | Chipboard screw                | Max. fixture thickness | Sales unit |
|---------------------|-----------------------------|---------------------|-----------------------|----------------------|---------------|--------------------------------|------------------------|------------|
| Item                | Art.-No.                    | $d_o$<br>[mm]       | $h_1$<br>[mm]         | $d_p$<br>[mm]        | $l$<br>[mm]   | $d_s / d_s \times l_s$<br>[mm] | $t_{fix}$<br>[mm]      | [pcs]      |
| <b>PD 8</b>         | <b>024771</b>               | 8                   | 31                    | 6                    | 29            | 4                              | —                      | 100        |
| <b>PD 10</b>        | <b>015935</b>               | 10                  | 30                    | 7                    | 28            | 5                              | —                      | 100        |
| <b>PD 12</b>        | <b>015937</b>               | 12                  | 29                    | 9                    | 27            | 6                              | —                      | 50         |
| <b>PD 8 S</b>       | <b>024772</b> <sup>1)</sup> | 8                   | 31                    | 6                    | 29            | 4 x 40                         | 11                     | 50         |
| <b>PD 10 S</b>      | <b>015936</b> <sup>1)</sup> | 10                  | 30                    | 7                    | 28            | 5 x 40                         | 12                     | 50         |
| <b>PD 12 S</b>      | <b>015938</b> <sup>1)</sup> | 12                  | 29                    | 9                    | 27            | 6 x 50                         | 22                     | 25         |

<sup>1)</sup> PD-S with chipboard screw.

## LOADS

### Board fixing PD

Highest recommended loads<sup>1)</sup> for a single anchor.

The given loads are valid for chipboard screws with the specified diameter.

| Type  |                  |      | PD 8 | PD 10 | PD 12 |
|---|------------------|------|------|-------|-------|
| Chipboard screw   | $\emptyset$ [mm] |      | 4    | 5     | 6     |
| <b>Recommended loads in the respective base material <math>F_{rec}</math> <sup>2)</sup></b> |                  |      |      |       |       |
| Gypsum plasterboard   | 9,5 mm           | [kN] | 0,10 | 0,10  | 0,10  |
| Gypsum plasterboard   | 12,5 mm          | [kN] | 0,10 | 0,10  | 0,15  |
| Gypsum plasterboard   | 2 x 12,5 mm      | [kN] | 0,15 | 0,15  | 0,15  |
| Gypsum fibreboard   | 12,5 mm          | [kN] | 0,20 | 0,25  | 0,30  |
| Plywood   |                  | [kN] | 0,15 | 0,40  | 0,80  |
| Chipboard   | 16 mm            | [kN] | 0,25 | 0,25  | 0,25  |

<sup>1)</sup> Required safety factors are considered.

<sup>2)</sup> Valid for tensile load, shear load and oblique load under any angle.