

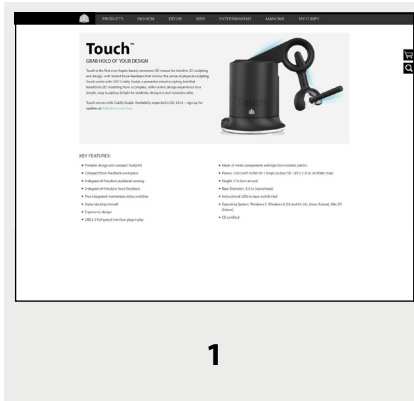

# Touch™ 3D stylus



Please refer to the Touch User Guide for safety and comprehensive operating instructions. You can find the Touch User Guide on [Cubify.com/Touch](http://Cubify.com/Touch).



1

## Go to [Cubify.com/Touch](http://Cubify.com/Touch)

Register your Touch by logging in or creating an account.



2

## Plug in Touch to USB

Plug the Touch into a USB port. Plug the power supply into the Touch and a power outlet.



3

## Handling and using Touch

See the Touch User Guide for proper handling and the correct way to hold the Touch.

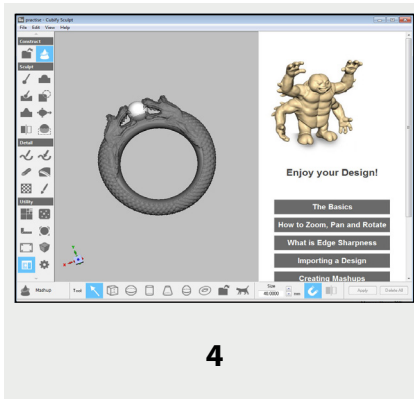

4

## Download and start your 3D software

Register and activate your 3D software online. When you start the application, Touch automatically recognizes it.

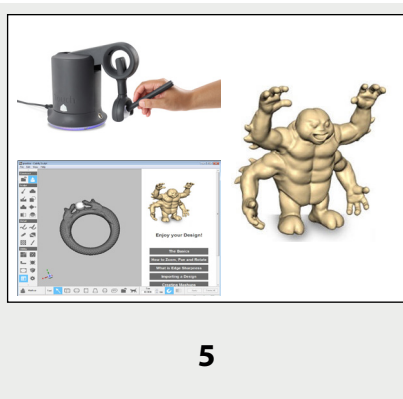

5

## Start designing!

Find inspiration and start designing your world.



**Support:**  
[Cubify@Cubify.com](mailto:Cubify@Cubify.com)



**Connect:**  
[Facebook.com/Cubify](https://Facebook.com/Cubify)



**Follow:**  
[@Cubify](https://twitter.com/Cubify)

© 2014 by 3D Systems Inc. All rights reserved. The 3D Systems logo, stylized text, Touch, and Cubify are registered trademarks of 3D Systems Inc. All other trademarks are the property of their respective owners.