

Inductive proximity sensors

Osiprox® Application, food and beverage processing series
Cylindrical, stainless steel, non flush mountable
Three-wire, d.c. supply, solid-state output

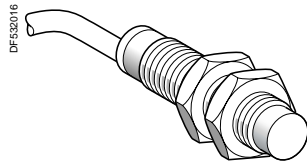

XS2 ●●SA●●L2

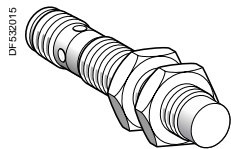

XS2 ●●SA●●M12

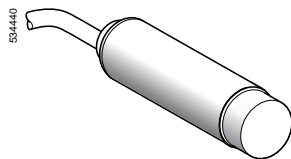

XS2 L2SA●●L2

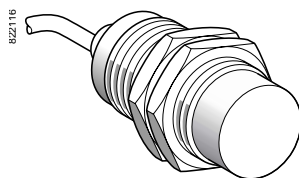

XS2 30SA●●L2



XUZ B2005



XSZ BS12

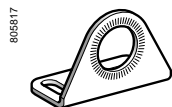

XUZ A118

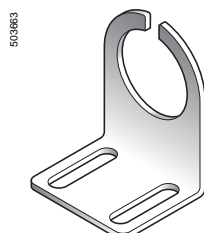

XSZ BS30

Ø 12, threaded M12 x 1

Sensing dist. (Sn) mm	Function	Output	Connection	Reference	Weight kg
7	NO	PNP	Pre-cabled (L = 2 m) (1)	XS2 12SAPAL2	0.075
			M12 connector	XS2 12SAPAM12	0.035
		NPN	Pre-cabled (L = 2 m) (1)	XS2 12SANAL2	0.075
			M12 connector	XS2 12SANAM12	0.035

Ø 18, threaded M18 x 1

Sensing dist. (Sn) mm	Function	Output	Connection	Reference	Weight kg
12	NO	PNP	Pre-cabled (L = 2 m) (1)	XS2 18SAPAL2	0.120
			M12 connector	XS2 18SAPAM12	0.060
		NPN	Pre-cabled (L = 2 m) (1)	XS2 18SANAL2	0.120
			M12 connector	XS2 18SANAM12	0.060

Ø 18, plain

Sensing dist. (Sn) mm	Function	Output	Connection	Reference	Weight kg
12	NO	PNP	Pre-cabled (L = 2 m) (1)	XS2 L2SAPAL2	0.120
			M12 connector	XS2 L2SAPAM12	0.060
		NPN	Pre-cabled (L = 2 m) (1)	XS2 L2SANAL2	0.120
			M12 connector	XS2 L2SANAM12	0.060

Ø 30, threaded M30 x 1.5

Sensing dist. (Sn) mm	Function	Output	Connection	Reference	Weight kg
22	NO	PNP	Pre-cabled (L = 2 m) (1)	XS2 30SAPAL2	0.205
			M12 connector	XS2 30SAPAM12	0.145
		NPN	Pre-cabled (L = 2 m) (1)	XS2 30SANAL2	0.205
			M12 connector	XS2 30SANAM12	0.145

Accessories (2)

Description	For use with	Reference	Weight kg
Plastic fixing clamp , 24.1 mm centres, with locking screw	Ø 18 sensor, plain case	XUZ B2005	0.007
Stainless steel fixing bracket	Ø 12 sensor	XSZ BS12	0.060
	Ø 18 sensor	XUZ A118	0.045
	Ø 30 sensor	XSZ BS30	0.080

Connecting cables

Description	Type	Cable length m	Reference	Weight kg
Pre-wired M12 connectors Female, 4-pin, stainless steel clamping ring	Straight	2	XZC PA1141L2	0.090
		5	XZC PA1141L5	0.210
		10	XZC PA1141L10	0.410
	Elbowed	2	XZC PA1241L2	0.090
		5	XZC PA1241L5	0.210
		10	XZC PA1241L10	0.410
M12 jumper cable Male, 3-pin, stainless steel clamping ring	Straight	2	XZC RA151140A2	0.095
		5	XZC RA151140A5	0.200

(1) For a 5 m long cable replace L2 by L5; for a 10 m long cable replace L2 by L10.

Example: **XS2 12SAPAL2** becomes **XS2 12SAPAL5** with a 5 m long cable.

(2) For further information, see page 37317/2.

