

Bus system flat-type plug - SACCBP-M12MSB-2CON-M16/2,0-915 - 1402849

Please be informed that the data shown in this PDF Document is generated from our Online Catalog. Please find the complete data in the user's documentation. Our General Terms of Use for Downloads are valid (<http://phoenixcontact.com/download>)



Bus system flush-type plug, PROFIBUS, 2-pos., M12, shielded, green outer sheath, B-coded, rear/screw mounting with M16 thread, with 2 m bus cable, 2 x 0.25 mm²



Key commercial data

Packing unit	1 pc
GTIN	 4 046356 633505
Weight per Piece (excluding packing)	187.4 g
Custom tariff number	85444290
Country of origin	Germany
Note	Made to Order (non-returnable)

Technical data

Dimensions

Length of cable	2 m
-----------------	-----

Ambient conditions

Degree of protection	IP67
----------------------	------

General

Rated current at 40°C	4 A
Rated voltage	60 V
Number of positions	2
Contact resistance	≤ 3 mΩ
Insulation resistance	≥ 10 GΩ
Coding	B - inverse
Signal type/category	PROFIBUS
Status display	No
Surge voltage category	II

Bus system flat-type plug - SACCBP-M12MSB-2CON-M16/2,0-915 - 1402849

Technical data

General

Pollution degree	3
------------------	---

Material

Inflammability class according to UL 94	V0
Contact material	CuZn
Contact surface material	Ni/Au
Contact carrier material	PA 66
Material, knurls	Nickel-plated brass
Sealing material	NBR

Cable

Cable type	PROFIBUS
Cable type (abbreviation)	915
Conductor cross section	0.25 mm ²
AWG signal line	24
Conductor structure signal line	19x 0.14 mm
Core diameter including insulation	2.56 mm
Thickness, insulation	Outer cable sheath
Wire colors	Red, green
Type of pair shielding	Aluminum-lined polyester foil
Overall twist	2 wires, twisted
Shielding	Tinned copper braided shield
Optical shield covering	70 %
External sheath, color	Green RAL 6018
External cable diameter	8.00 mm
Smallest bending radius, fixed installation	min. 40 mm
Smallest bending radius, movable installation	min. 60 mm
Number of bending cycles	3000000
Bending radius	60 mm
Cable weight	74 kg/km
Outer sheath, material	PUR
Material conductor insulation	Foamed PE
Conductor material	Bare Cu litz wires
Insulation resistance	≥ 16 GΩ*km
Working capacitance	28 nF (At 1 kHz)
Nominal voltage, cable	100 V
Test voltage Core/Core	3600 V

Bus system flat-type plug - SACCBP-M12MSB-2CON-M16/2,0-915 - 1402849

Classifications

eCl@ss

eCl@ss 4.0	27140815
eCl@ss 4.1	27140815
eCl@ss 5.0	27143423
eCl@ss 5.1	27143423
eCl@ss 6.0	27143423
eCl@ss 7.0	27449001
eCl@ss 8.0	27440103

ETIM

ETIM 4.0	EC000830
ETIM 5.0	EC002061

UNSPSC

UNSPSC 6.01	31251501
UNSPSC 7.0901	31251501
UNSPSC 11	31251501
UNSPSC 12.01	31251501
UNSPSC 13.2	31251501

Drawings

Dimensioned drawing

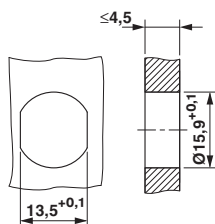

Schematic diagram

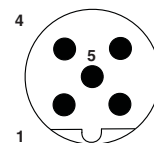

Pin assignment M12 male connector, 5-pos., B-coded, male side

Housing cutout for M16 fastening thread, mounting panel with feed-through hole (alternatively with surface as protection against rotation)

Bus system flat-type plug - SACCBP-M12MSB-2CON-M16/2,0-915 - 1402849

Dimensioned drawing

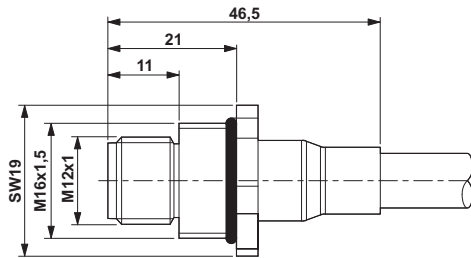

M12 flush-type plug

Circuit diagram

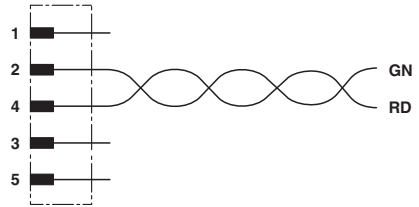

Contact assignment of the M12 plug