

Number of contacts

64

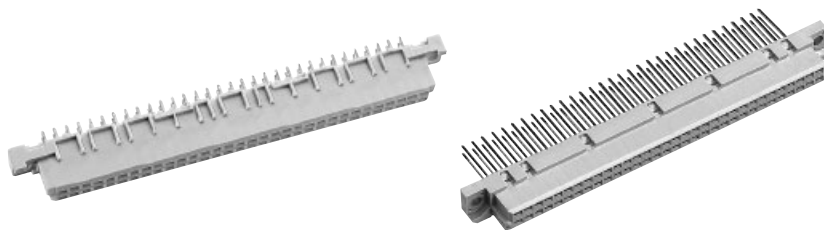

Female connectors

DIN Signal up to 2 A

| Identification | Number of contacts | Contact arrangement | Part No. | Performance levels according to IEC 60603-2. Explanation chapter 00 | | |
|---|--------------------|---------------------|--------------------------------|--|----------------|---|
| | | | | 3 | 2 | 1 |
| Female connector with solder pins 2.9 mm | 64 | | Performance level 3 on request | 09 02 264 6824 09 02 464 6824 ^{b)} 09 02 764 6824 ^{c)} | 09 02 264 2824 | |
| | SMC | 64 | | 09 02 264 6841 ^{d)} | | |
| Female connector with solder pins 4.5 mm | 64 | | | 09 02 264 6825 09 02 264 6825 222 ^{f)} 09 02 464 6825 ^{b)} 09 02 764 6825 ^{c)} | 09 02 264 2825 | |
| | SMC | 64 | | 09 02 264 6829 ^{d)} | | |
| Female connector with solder pins 13 mm | 64 | | | 09 02 264 6421 | | |
| Female connector with press-in pins 4.5 mm | 64 | | | 09 02 264 6850 09 02 264 6850 222 ^{f)} | 09 02 264 2850 | |
| Female connector with press-in pins without flange 5.3 mm | 64 | | | 09 02 264 6870 | | |
| Female connector with press-in pins 13.2 mm | 64 | | | 09 02 264 6861 ^{a)} | | |
| Female connector with wrap posts ¹⁾ 13 mm | 64 | | | 09 02 264 6821 | | |
| Female connector with solder lugs 5.2 mm | 64 | | 09 02 264 6823 | | | |

01
12

1) To be used only for wire wrap termination
 a) Wrap posts selectively gold plated (performance level 3)
 b) Connectors with snap-in clips see chapter 00
 c) Connectors with coding see chapter 00

d) CTI > 400
 f) Railway classification NFF 16-101, Smoke index: F1, Flammability class: I2
 Other contact arrangements on request