

NAUTIC SERIES

Type

Nautic 025

80 x 80 x 52 mm

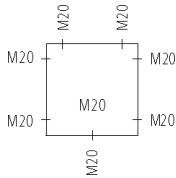

Description

IP 65 junction box complying with DIN VDE 0606, $U_i=690$ V, **weather-proof, shock-resistant and halogen-free**, with self-sealing, soft entry membranes
M 20 seal range 2-16 mm
Cable range 1-4 mm²

NEW

Order N°

Packing Qty

Nautic 025 L – empty,
grey

490 902 01

60 / 3

Nautic 025 – 2.5²,
grey, 5-pole 1.5-4 mm² screw terminal
(4 x 1.5² / 4 x 2.5² / 3 x 4²)

490 402 01

60 / 3

Nautic 025 SL – 2.5²,
grey, 5 screwless terminals 5 x 1.0-2.5 mm²

490 802 01

60 / 3

Recommended accessories:
lead seal set

890 010 01

10

IP 68 cable gland with lock-nut
M20 (seal range 6 - 12 mm)

227 420 01

50

M20 IP 54 mini-conduit adapter, grey

233 455 01

240 / 20

Nautic 040

93 x 93 x 55 mm

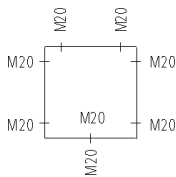

IP 65 junction box complying with DIN VDE 0606, $U_i=690$ V, **weather-proof, shock-resistant and halogen-free**, with self-sealing, soft entry membranes
M 20 seal range 2-16 mm
Cable range 1-4 mm²

NEW

Order N°

Packing Qty

Nautic 040 L – empty,
grey

490 904 01

60 / 3

Nautic 040 – 4²,
grey, 5-pole 1-4 mm² screw terminal
(4 x 1.5² / 4 x 2.5² / 3 x 4²)

490 404 01

60 / 3

Recommended accessories:
lead seal set

890 010 01

10

IP 68 cable gland with lock-nut
M20 (seal range 6 - 12 mm)
M20 (" 7 - 14 mm)

227 420 01

50

227 421 01

30

M 20 IP 54 mini-conduit adapter, grey

233 455 01

240 / 20

NAUTIC SERIES

Type

Nautic 060

110 x 110 x 67 mm

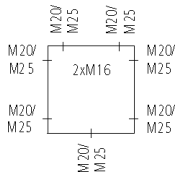

Description

IP 65 junction box complying with DIN VDE 0606, $U_i=690$ V, **weather-proof, shock-resistant and halogen-free**, with IP 66 double membrane adapter M25 seal range 9-16 mm

Nautic 060 L – empty,
grey

Nautic 060 – 6²,
grey, 5-pole 6 mm² high-set screw terminal
(4 x 2.5² / 4 x 4² / 3 x 6²)

Recommended accessories:

lead seal set

IP 68 cable gland with lock-nut
M20 (seal range 6 - 12 mm)
M20 (" 7 - 14 mm)
M25 (" 7 - 16 mm)

IP 66 double membrane adapter
M20 (seal range 7 - 12 mm)
M25 (" 9 - 16 mm)

NS35 DIN rail

Mounting plate from insulating material

81 mm

83 x 83 mm

Order N°

Packing Qty

490 906 01

24 / 2

490 406 01

24 / 2

890 010 01

10

227 420 01

50

227 421 01

30

227 425 01

25

260 420 01

600 / 50

260 425 01

600 / 50

198 081 01

1

895 006 01

1

Nautic 100

140 x 140 x 79 mm

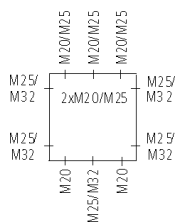

IP 65 junction box complying with DIN VDE 0606, $U_i=690$ V, **weather-proof, shock-resistant and halogen-free**, with IP 66 double membrane adapter M32 seal range 14-21 mm

Nautic 100 L – empty,
grey

Nautic 100 – 10²,
grey, 5-pole 10 mm² high-set screw terminal
(4 x 4² / 4 x 6² / 4 x 10²)

Recommended accessories:

lead seal set

IP 68 cable gland with lock-nut
M20 (seal range 6 - 12 mm)
M20 (" 7 - 14 mm)
M25 (" 7 - 16 mm)
M32 (" 11 - 21 mm)

IP 66 double membrane adapter
M25 (seal range 9 - 16 mm)
M32 (" 14 - 21 mm)

NS35 DIN rail

Mounting plate from insulating material

106 mm

109 x 109 mm

490 910 01

20 / 2

490 410 01

20 / 2

890 010 01

10

227 420 01

50

227 421 01

30

227 425 01

25

227 432 01

10

260 425 01

600 / 50

260 432 01

300 / 25

198 106 01

1

895 010 01

1

Type

Nautic 160

180 x 180 x 91 mm

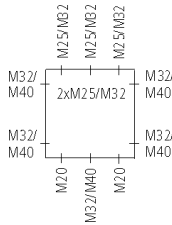

Description

IP 65 junction box complying with DIN VDE 0606, $U_i=690$ V, **weather-proof, shock-resistant and halogen-free**, with lead seal set, matching cable entries see accessories

Nautic 160 L – empty,
grey

Order N° Packing Qty

490 916 01 10 / 1

Nautic 160 – 16²,
grey, 5-pole 16 mm² high-set screw terminal
(4 x 6² / 4 x 10² / 4 x 16²)

490 416 01 10 / 1

Recommended accessories:

IP 68 cable gland with lock-nut

M20 (seal range 6 - 12 mm)

227 420 01 50

M20 (" 7 - 14 mm)

227 421 01 30

M25 (" 7 - 16 mm)

227 425 01 25

M32 (" 11 - 21 mm)

227 432 01 10

M40 (" 16 - 28 mm)

227 440 01 5

IP 66 double membrane adapter

M32 (seal range 14-21 mm)

260 432 01 300 / 25

NS35 DIN rail

144 mm

894 016 01 1

Mounting plate from insulating material

149 x 149 mm

895 016 01 1

Nautic 350

250 x 250 x 115 mm

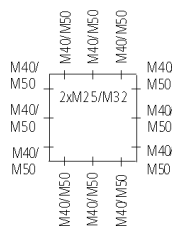

IP 65 junction box complying with DIN VDE 0606, $U_i=690$ V, **weather-proof, shock-resistant and halogen-free**, with lead seal set, matching cable entries see accessories

Nautic 350 L – empty,
grey

490 935 01 4 / 1

Nautic 350 – 35²,
grey, 5-pole 35 mm² high-set screw terminal
(4 x 16² / 4 x 25² / 4 x 35²)

490 435 01 4 / 1

Recommended accessories:

IP 68 cable gland with lock-nut

M40 (seal range 16 - 28 mm)

227 440 01 5

M50 (" 21 - 34.5 mm)

227 450 01 5

NS35 DIN rail

216 mm

894 035 01 1

Mounting plate from insulating material

217 x 217 mm

895 035 01 1

NAUTIC SERIES



Type

Nautic 700 – 70²

440 x 320 x 179 mm



top end entries:
8 x M20 / M25
2 x M32 / M40
1 x M40 / M50
sidewalls, each:
4 x M16
3 x M40 / M50

Description

IP 65 junction box, $U_i=690$ V,
weather-proof, shock-resistant and halogen-free,
can be sealed with standard leads
matching cable entries see accessories

grey, 4 terminal blocks 4 x 70 mm²

NEW

Recommended accessories:

Adapter for 5 connection poles 1 block 4 x 70 mm²
cable entry (elastic) 2 x Ø 75 mm (320 mm wide)
cable entry (elastic) 3 x Ø 75 mm (440 mm wide)

Order N°

Packing Qty

490 470 01

1

840 070 01

1

073 032 01

5 / 1

073 043 01

5 / 1

Nautic 1500 – 150²

440 x 320 x 179 mm



top end entries:
8 x M20 / M25
2 x M32 / M40
1 x M40 / M50
sidewalls, each:
4 x M16
3 x M40 / M50

IP 65 junction box, $U_i=690$ V,
weather-proof, shock-resistant and halogen-free,
can be sealed with standard leads
special screw terminal for cable entry from above
each pole up to 2 x 150² or 4 x 70²
matching cable entries see accessories

grey, 4-pole up to 2 x 150 mm²

NEW

Recommended accessories:

Adapter for 5 connection poles 1-pole 2 x 150 mm²
cable entry (elastic) 2 x Ø 75 mm (320 mm wide)
cable entry (elastic) 3 x Ø 75 mm (440 mm wide)

490 485 01

1

076 125 01

1

073 032 01

5 / 1

073 043 01

5 / 1

Nautic 1500 DK – 150²

440 x 320 x 179 mm



top end entries:
8 x M20 / M25
2 x M32 / M40
1 x M40 / M50
sidewalls, each:
4 x M16
3 x M40 / M50

IP 65 continuity box, $U_i=690$ V,
weather-proof, shock-resistant and halogen-free,
can be sealed with standard leads
with multiple terminal assembly

grey, multiple terminal 4-pole -150 mm²

NEW

Recommended accessories:

Adapter for 5 connection poles 1-pole -150 mm²
cable entry (elastic) 2 x Ø 75 mm (320 mm wide)
cable entry (elastic) 3 x Ø 75 mm (440 mm wide)

490 585 01

1

670 650 01

1

073 032 01

5 / 1

073 043 01

5 / 1

Nautic 2400 – 240²

640 x 320 x 179 mm

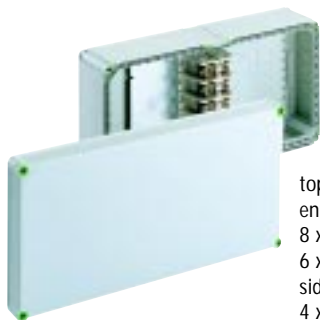

top end entries:
8 x M16
6 x M40 / M50
sidewalls, each:
4 x M16
3 x M40 / M50

IP 65 junction box, $U_i=690$ V,
weather-proof, shock-resistant and halogen-free,
can be sealed with standard leads
special screw terminal for cable entry from above
each pole up to 2 x 185²/240² or 4 x 120²
matching cable entries see accessories

grey, 4-pole up to 2 x 240 mm²

NEW

Recommended accessories:

Adapter for 5 connection poles 1-pole 2 x 240 mm²
cable entry (elastic) 2 x Ø 75 mm (320 mm wide)

490 494 01

1

076 140 01

1

073 032 01

5 / 1

1

NAUTIC SERIES

Type

Nautic 2400 DK – 240²

640 x 320 x 179 mm



top end
entries:
8 x M16
6 x M40 / M50
sidewalls, each:
4 x M16
3 x M40 / M50

Description

IP 65 junction box, $U_i=690$ V,
weather-proof, shock-resistant and halogen-free,
can be sealed with standard leads,
with multiple terminal assembly

grey, 4-pole-240 mm²

NEW

Recommended accessories:

Adapter for 5 connection poles 1-pole-240 mm²
cable entry (elastic) 2 x Ø 75 mm (320 mm wide)

Order N°

Packing Qty

490 594 01

1

670 740 01

1

073 032 01

5 / 1

Type Nautic terminals



Description	Order N°	Packing Qty
Junction terminal complying with DIN EN 60998 / VDE 0613, $U_i=690$ V,		
for		
Abox/Nautic 025/040 5-pole-1-4 mm ² (4 x 1.5 ² / 4 x 2.5 ² / 3 x 4 ²)	840 004 01	10
Abox/Nautic 060 5-pole-6 mm ² (4 x 2.5 ² / 4 x 4 ² / 3 x 6 ²)	840 006 01	5
Abox/Nautic 100 5-pole-10 mm ² (4 x 4 ² / 4 x 6 ² / 4 x 10 ²)	840 010 01	5
Abox/Nautic 160 5-pole-16 mm ² (4 x 6 ² / 4 x 10 ² / 4 x 16 ²)	840 016 01	2
Abox/Nautic 350 5-pole-35 mm ² (4 x 16 ² / 4 x 25 ² / 4 x 35 ²)	840 035 01	1
Abox/Nautic 700* 1-pole-70 mm ²	840 070 01	1
Abox 1500 1-pole-150 mm ² *	076 125 01	1
Abox 2400 1-pole-240 mm ² *	076 140 01	1
Abox/Nautic 040 Voltage terminal 16/6 ²	462 166 01	10



*VDE approval in preparation

Lead seal set



Lead seal set for Abox / Nautic 025 to 100, (from Abox / Nautic 160 can be sealed with standard leads)	890 010 01	10
--------------------------------------------------------------------------------------------------------------	------------	----

Cable entries

for Nautic 700 / 1500 / 2400



Plug-in type cable entry with pleated rubber for cables under tension up to 75 mm diameter			
Width 320 mm	2 x 75 mm Ø	073 032 01	5 / 1
Width 440 mm	3 x 75 mm Ø	073 043 01	5 / 1

Cleats

for Nautic 700 / 1500 / 2400



Cleats for cables up to 75 mm			
Width 320 mm for	1 x 75 mm	073 003 01	10 / 1
Width 440 mm for	1 x 75 mm	073 004 01	5 / 1
Recommended accessories: additional clamp for 2nd cable up to 75 mm		073 075 01	50 / 1

DIN rails

NS 35



35 mm DIN rail incl. fixing screws, for			
Abox 060	Length 81 mm	198 081 01	1
Abox 100	Length 106 mm	198 106 01	1
Abox 160	Length 144 mm	894 016 01	1
Abox 350	Length 216 mm	894 035 01	1
Abox 700 (with plastic bearer)	Length 216 mm	562 035 01	1

Mounting plates



Mounting plate from insulating material for installing units with floor fixing, incl. fixing screws, for			
Abox 060	83 x 83 mm	895 006 01	1
Abox 100	109 x 109 mm	895 010 01	1
Abox 160	149 x 149 mm	895 016 01	1
Abox 350	217 x 217 mm	895 035 01	1
Abox 700	390 x 240 mm	795 003 01	1