

2 CKTS ONLY.

3 TO 32 CKTS.

**2 POLARISING BUTTON VERSION**

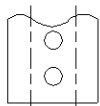

2 CKTS ONLY.

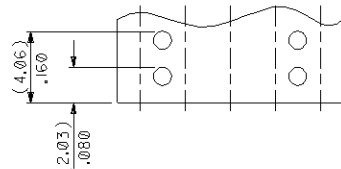

**4 POLARISING BUTTON VERSION**

NO. OF CKTS	PART NUMBER		DIM A	DIM B	DIM C
	2 BUTT'S	4 BUTT'S			
2	90123-0102	90123-0202	(2.54)/0.100	(5.08)/0.200	---
3	90123-0103	90123-0203	(5.08)/0.200	(7.62)/0.300	(2.54)/0.100
4	90123-0104	90123-0204	(7.62)/0.300	(10.16)/0.400	(5.08)/0.200
5	90123-0105	90123-0205	(10.16)/0.400	(12.70)/0.500	(7.62)/0.300
6	90123-0106	90123-0206	(12.70)/0.500	(15.24)/0.600	(10.16)/0.400
7	90123-0107	90123-0207	(15.24)/0.600	(17.78)/0.700	(12.70)/0.500
8	90123-0108	90123-0208	(17.78)/0.700	(20.32)/0.800	(15.24)/0.600
9	90123-0109	90123-0209	(20.32)/0.800	(22.86)/0.900	(17.78)/0.700
10	90123-0110	90123-0210	(22.86)/0.900	(25.40)/1.000	(20.32)/0.800
11					
12	90123-0112	90123-0212	(27.94)/1.100	(30.48)/1.200	(25.40)/1.000
13	90123-0113	90123-0213	(30.48)/1.200	(33.02)/1.300	(27.94)/1.100
14					
15	90123-0115	90123-0215	(35.56)/1.400	(38.10)/1.500	(33.02)/1.300
16					
17					
18	90123-0118	90123-0218	(43.18)/1.700	(45.72)/1.800	(40.64)/1.600
19	90123-0119	90123-0219	(45.72)/1.800	(48.26)/1.900	(43.18)/1.700
20	90123-0120	90123-0220	(48.26)/1.900	(50.80)/2.000	(45.72)/1.800
21					
22					
23					
24	90123-0124	90123-0224	(58.42)/2.300	(60.96)/2.400	(55.88)/2.200
25	90123-0125	90123-0225	(60.96)/2.400	(63.50)/2.500	(58.42)/2.300
26					
27					
28					
29					
30					
31					
32	90123-0132	90123-0232	(78.74)/3.100	(81.28)/3.200	(76.20)/3.000

**NOTES:**

- MATERIAL: POLYPHENYLENE OXIDE 94 VI COLOUR BLACK.
- BUTTONS ARE LOCATED BETWEEN CIRCUITS 1 & 2 AND N-1 & N (WHERE N IS THE NUMBER OF CIRCUITS)
- PART NO. AND CAVITY ID. TO BE ((1.00)/.040 HIGH AND RAISED ((0.07)/.003 IN A ((0.15)/.006 DEEP WELL

90123 - 0 \* \* \* \*  
 INDICATES NO. OF CIRCUITS  
 INDICATES NO. OF BUTTONS.  
 1 - 2 BUTTONS  
 2 - 4 BUTTONS  
 90123 - 9 9 \* \* \* \*  
 VOIDED OPTIONS, PER SHT 2.

FOR PREVIOUS DRAWING ISSUES SEE MRI.

TOL. AND DIM. CHANGE ECN : E170283 93/07/20 SK	REVISIONS LTR	THIRD ANGLE PROJECTION		REVISE ONLY ON CAD SYSTEM	
		DIMENSIONS SHOWN (METRIC) INCH UNLESS OTHERWISE SPECIFIED TOLERANCES: ANGULAR ± 2°	DB	CAD/CAM FILE NAME SD90123.DGN	THIS DRAWING CONTAINS INFORMATION THAT IS PROPRIETARY TO MOLEX INC. & SHOULD NOT BE USED WITHOUT WRITTEN PERMISSION.
2 PLACE ± .004 2 PLACE ± .010 1 PLACE ± .010		DESIGN DIMENSION (DIM) <input type="checkbox"/> IN. EQUIVALENT DIMENSION (DIM) (DIM) <input type="checkbox"/> IN.		TITLE <b>C-GRID III          SINGLE ROW MODULAR          CRIMP CONNECTOR HOUSING</b>	
SCALE 5:1		SHEET NO. DATE 1 OF 2 6/10/87		MOLEX EUROPE PART NO. SEE CHART DWG NO. SD-90123 SIZE C	