

HOLDER FOR 3 MODULES, PLASTIC, 1NO, 1NO, LED  
MODULE, BLUE, 6-24V AC/DC, SCREW TERMINAL



Figure similar

product brand name		SIRIUS ACT
Product designation		Commanding and signaling devices
Design of the product		Holder
<b>Manufacturer article number</b>		
<ul style="list-style-type: none"> <li>• of supplied contact module</li> <li>• of supplied LED module</li> <li>• of the supplied holder</li> </ul>		3SU1400-1AA10-1BA0, 3SU1400-1AA10-1BA0 <a href="#">3SU1401-1BG50-1AA0</a> <a href="#">3SU1500-0AA10-0AA0</a>

### Actuator:

<b>Design of the operating mechanism</b>		3-way with module
<b>Number of contact modules</b>		2

### Holder:

<b>Material of the holder</b>		Plastic
-------------------------------	--	---------

### Display:

<b>Number of LED modules</b>		1
------------------------------	--	---

### General technical data:

<b>Product function</b>		
<ul style="list-style-type: none"> <li>• positive opening</li> </ul>		Yes
<b>Product component</b>		
<ul style="list-style-type: none"> <li>• diode</li> <li>• lamp transformer</li> <li>• Light source</li> <li>• series resistor</li> </ul>		Yes No Yes No
<b>Insulation voltage</b>		
<ul style="list-style-type: none"> <li>• Rated value</li> </ul>	V	320

<b>Degree of pollution</b>		3
<b>Vibration resistance</b>		
<ul style="list-style-type: none"> <li>• acc. to IEC 60068-2-6</li> </ul>		10 ... 500 Hz: 5g
<b>Surge voltage resistance Rated value</b>	kV	4
<b>Operating frequency maximum</b>	1/h	3 600
<b>Mechanical service life (switching cycles)</b>		
<ul style="list-style-type: none"> <li>• typical</li> </ul>		10
<b>Thermal current</b>	A	10
<b>Protection class IP</b>		
<ul style="list-style-type: none"> <li>• of the terminal</li> </ul>		IP20
<b>Equipment marking</b>		
<ul style="list-style-type: none"> <li>• acc. to DIN EN 61346-2</li> </ul>		U
<ul style="list-style-type: none"> <li>• acc. to DIN EN 81346-2</li> </ul>		U
<b>Design of the fuse link for short-circuit protection of the auxiliary switch with type of assignment 1 required</b>		gG / Dz 10 A, quick-acting / Dz 10 A
<b>Continuous current of the C characteristic MCB</b>	A	10
<b>Operating voltage</b>		
<ul style="list-style-type: none"> <li>• with AC</li> </ul>		
<ul style="list-style-type: none"> <li>— at 50 Hz Rated value</li> </ul>	V	6 ... 24
<ul style="list-style-type: none"> <li>— at 60 Hz Rated value</li> </ul>	V	6 ... 24
<ul style="list-style-type: none"> <li>• for DC Rated value</li> </ul>		
<ul style="list-style-type: none"> <li>— maximum</li> </ul>	V	24
<ul style="list-style-type: none"> <li>— minimum</li> </ul>	V	6

#### Power Electronics:

<b>Contact reliability</b>		One maloperation per 100 million (17 V, 5 mA), one maloperation per 10 million (5 V, 1 mA)
----------------------------	--	--

#### Auxiliary circuit:

<b>Number of NC contacts</b>		
<ul style="list-style-type: none"> <li>• for auxiliary contacts</li> </ul>		1
<b>Number of NO contacts</b>		
<ul style="list-style-type: none"> <li>• for auxiliary contacts</li> </ul>		1
<b>Number of CO contacts</b>		
<ul style="list-style-type: none"> <li>• for auxiliary contacts</li> </ul>		0
<b>Design of the contact of the auxiliary contacts</b>		Silver alloy
<b>Operating current at AC-15</b>		
<ul style="list-style-type: none"> <li>• at 230 V Rated value</li> </ul>	A	6

#### Connections/ Terminals:

<b>Type of electrical connection</b>		
<ul style="list-style-type: none"> <li>• of modules and accessories</li> </ul>		Screw-type terminal
<b>Type of connectable conductor cross-section</b>		
<ul style="list-style-type: none"> <li>• solid with core end processing</li> </ul>		2x (0.5 ... 0.75 mm <sup>2</sup> )

<ul style="list-style-type: none"> <li>• solid without core end processing</li> <li>• finely stranded with core end processing</li> <li>• finely stranded without core end processing</li> <li>• for AWG conductors</li> </ul>		2x (1.0 ... 1.5 mm <sup>2</sup> ) 2x (0.5 ... 1.5 mm <sup>2</sup> ) 2x (1.0 ... 1.5 mm <sup>2</sup> ) 2x (18 ... 14)
<b>Tightening torque</b>		
<ul style="list-style-type: none"> <li>• with screw-type terminals</li> </ul>	N·m	0.8 ... 0.9

#### Lamp:

<b>Type of light source</b>		LED
<b>Color of the light source</b>		blue

#### Ambient conditions:

<b>Ambient temperature</b>		
<ul style="list-style-type: none"> <li>• during operation</li> </ul>	°C	-25 ... +70
<ul style="list-style-type: none"> <li>• during storage</li> </ul>	°C	-40 ... +80

#### Installation/ mounting/ dimensions:

<b>Mounting type</b>		
<ul style="list-style-type: none"> <li>• of modules and accessories</li> </ul>		Front plate mounting
<b>Height</b>	mm	40
<b>Width</b>	mm	30
<b>Shape of the installation opening</b>		round

#### Certificates/ approvals:

#### Further information

##### Information- and Downloadcenter (Catalogs, Brochures,...)

<http://www.siemens.com/industrial-controls/catalogs>

##### Industry Mall (Online ordering system)

<http://www.siemens.com/industrymall>

##### Cax online generator

<http://support.automation.siemens.com/WW/CAXorder/default.aspx?lang=en&mlfb=3SU15011AG501NA0>

##### Service&Support (Manuals, Certificates, Characteristics, FAQs,...)

<http://support.automation.siemens.com/WW/view/en/3SU15011AG501NA0/all>

##### Image database (product images, 2D dimension drawings, 3D models, device circuit diagrams, EPLAN macros, ...)

[http://www.automation.siemens.com/bilddb/cax\\_de.aspx?mlfb=3SU15011AG501NA0&lang=en](http://www.automation.siemens.com/bilddb/cax_de.aspx?mlfb=3SU15011AG501NA0&lang=en)

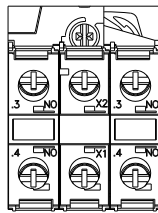
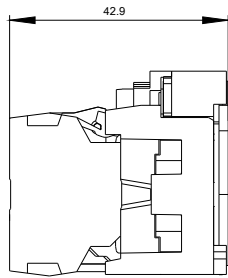
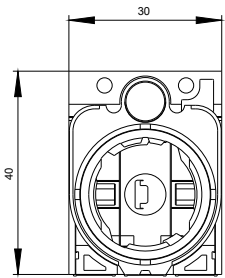

**-P**  
6-24 V AC/DC

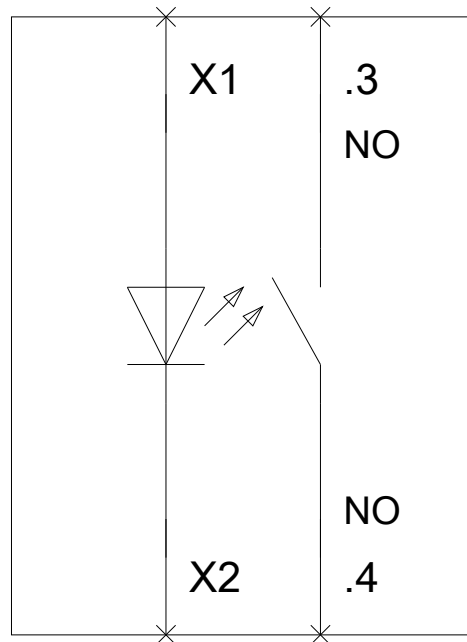

last modified:

09.03.2015