

Female insert - VS-MSTBAV 2,5/ 5-GB-5,08-BK-A - 1609565

Please be informed that the data shown in this PDF Document is generated from our Online Catalog. Please find the complete data in the user's documentation. Our General Terms of Use for Downloads are valid (<http://download.phoenixcontact.com>)



MSTB contact insert, for PCB assembly, 24 V, 5-pos., with straight solder pins, RAL 9005 (black), for panel mounting frame VS-PPC-F2-MSTB-...-1R-P

Key commercial data

Packing unit	0
Minimum order quantity	1
Catalog page	Page 362 (PC-2011)
GTIN	 4 046356 175876
Custom tariff number	85366990
Country of origin	GERMANY

Technical data

Mechanical characteristics

Number of positions	5
Insertion/withdrawal cycles	≥ 100
Connection method	Printed circuit connection
Color	black
Ambient temperature (operation)	-40 °C ... 70 °C

Material data

Inflammability class according to UL 94	V0
Contact carrier material	PA
Contact material	Copper alloy
Contact surface material	Gold over nickel

Electrical characteristics

Number of positions	5
Rated current	16 A

Female insert - VS-MSTBAV 2,5/ 5-GB-5,08-BK-A - 1609565

Classifications

eclass

eCl@ss 4.0	272607xx
eCl@ss 4.1	27260701
eCl@ss 5.0	27260701
eCl@ss 5.1	27260701
eCl@ss 6.0	27261204

etim

ETIM 3.0	EC000438
ETIM 4.0	EC000438

unspsc

UNSPSC 6.01	31261501
UNSPSC 7.0901	31261501
UNSPSC 11	31261501
UNSPSC 12.01	31261501
UNSPSC 13.2	31261501

Approvals

Certificates

Certification

UL Recognized / cUL Recognized / cULus Recognized

Certification EX

Certification submitted

Approval details

UL Recognized	
Nominal current IN	16 A
Nominal voltage UN	24 V

cUL Recognized	
Nominal current IN	16 A
Nominal voltage UN	24 V

Female insert - VS-MSTBAV 2,5/ 5-GB-5,08-BK-A - 1609565

Approvals

cULus Recognized

Accessories

Accessories

Panel mounting frames - VS-PPC-F2-MSTB-MNNA-1R-P - 1608087



MSTB panel mounting frame, IP67, for push-pull interlocking, metal, for PCB connection, for square panel cutout, with grommet, without mounting screws

Panel mounting frames - VS-PPC-F2-MSTB-POBK-1R-P - 1608281



MSTB panel mounting frame, IP67, for push-pull interlocking, plastic, for PCB connection, for square panel cutout, with grommet, without mounting screws

Drawings

Drilling diagram

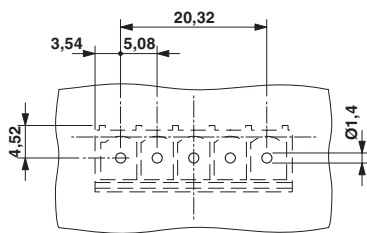

Drilling diagram

Dimensioned drawing

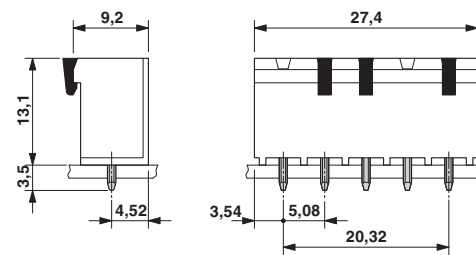

MSTB contact insert