

Bus system flat-type plug - SACC-DSIV-M12FSD-4CON-L90 - 1534630

Please be informed that the data shown in this PDF Document is generated from our Online Catalog. Please find the complete data in the user's documentation. Our General Terms of Use for Downloads are valid (<http://download.phoenixcontact.com>)



Bus system flush-type socket, ETHERNET, 4-pos., M12, shielded, D-coded, rear/screw mounting, with angled solder connection



Key commercial data

Packing unit	10 pc
Minimum order quantity	10 pc
GTIN	 4 046356 026802
Weight per Piece (excluding packing)	10.82 g
Custom tariff number	85366990
Country of origin	Germany

Technical data

Mechanical characteristics

Standards/specifications	M12 connector IEC 61076-2-101
Number of positions	4
Shielded	No
Connection method	Solder pins

Ambient conditions

Ambient temperature (operation)	-25 °C ... 85 °C
Degree of protection	IP67

Material data

Inflammability class according to UL 94	HB
Contact carrier material	PA 66
Contact material	CuZn
Contact surface material	Ni/Au
Cable gland material	Zinc die-cast, nickel-plated
Sealing material	NBR

Bus system flat-type plug - SACC-DSIV-M12FSD-4CON-L90 - 1534630

Technical data

Electrical characteristics

Number of positions	4
Nominal voltage U_N	250 V
Nominal current I_N	4 A
Surge voltage category	II
Pollution degree	3

Classifications

eCl@ss

eCl@ss 4.0	27140815
eCl@ss 4.1	27140815
eCl@ss 5.0	27143423
eCl@ss 5.1	27143423
eCl@ss 6.0	27143423
eCl@ss 7.0	27449001
eCl@ss 8.0	27449001

ETIM

ETIM 2.0	EC001297
ETIM 3.0	EC002061
ETIM 4.0	EC002061
ETIM 5.0	EC002061

UNSPSC

UNSPSC 6.01	31251501
UNSPSC 7.0901	31251501
UNSPSC 11	31251501
UNSPSC 12.01	31251501
UNSPSC 13.2	31251501

Approvals

Approvals

Approvals

GOST

Ex Approvals

Bus system flat-type plug - SACC-DSIV-M12FSD-4CON-L90 - 1534630

Approvals

Approvals submitted

Approval details



Drawings

Schematic diagram

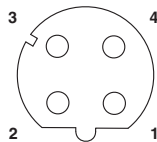

Pin assignment M12 socket, 4-pos., D-coded, female side

Drilling diagram

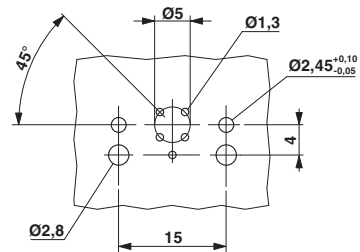

M12 flush-type connector

Dimensioned drawing

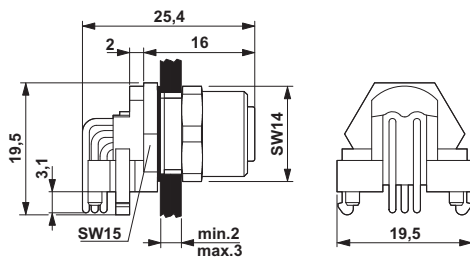

M12 flush-type connector

Dimensioned drawing

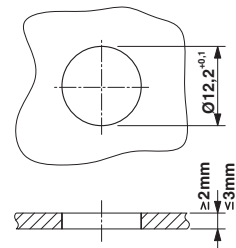

Panel cutout