

# Pin/socket, panel feed-through - SF-7EE1N8AS000 - 1605567

Please be informed that the data shown in this PDF Document is generated from our Online Catalog. Please find the complete data in the user's documentation. Our General Terms of Use for Downloads are valid (<http://download.phoenixcontact.com>)



Pin/socket, panel feed-through, straight, M23, M23, Number of positions: 4+3+PE, Type of contact: Socket, Crimp connection, Axial O-ring, 4xM3, Shielded: Yes, Cable diameter: 0 mm...0 mm



## Key commercial data

Packing unit	1 pc
GTIN	 4 046356 253635
Weight per Piece (excluding packing)	166.88 g
Custom tariff number	85444290
Country of origin	Germany

## Technical data

### General

Type of locking	M23
Coding	N
Contact connection method	Crimp connection
Type of contacts	Socket
Number of positions	8
Nominal current per power contact at 25°C	30 A
Nominal current per signal contact at 25°C	9 A
Conductor entry	0 mm ... 0 mm
Mounting type	4xM3

### Ambient conditions

Ambient temperature	-20 °C ... 125 °C
Degree of protection	IP67

### Material

Housing material	Turned parts: copper zinc alloy (CuZn), die-cast parts: zinc (GD-Zn)
Insulator material	PA 66
Gasket and O-ring material	FPM

# Pin/socket, panel feed-through - SF-7EE1N8AS000 - 1605567

## Technical data

Specifications according to DIN EN 61984:2001

Installation height max.	3000 m
Nominal / operating voltage of power contacts	630 V
Rated surge voltage of power contacts	4 kV
Surge voltage category of power contacts	III
Pollution degree of power contacts	3
Nominal / operating voltage of signal contacts	250 V
Rated surge voltage of signal contacts	6 kV
Surge voltage category of signal contacts	III
Pollution degree of signal contacts	3

## Classifications

eCl@ss

eCl@ss 4.0	272607xx
eCl@ss 4.1	27260701
eCl@ss 5.0	27260701
eCl@ss 5.1	27260701
eCl@ss 6.0	27260708
eCl@ss 7.0	27440312
eCl@ss 8.0	27440312

ETIM

ETIM 3.0	EC001121
ETIM 4.0	EC001121
ETIM 5.0	EC002635

UNSPSC

UNSPSC 6.01	43172015
UNSPSC 7.0901	43201404
UNSPSC 11	43172015
UNSPSC 12.01	43201404
UNSPSC 13.2	43201404

## Approvals

Approvals

---

Approvals

UL Recognized / cUL Recognized / cULus Recognized

---

# Pin/socket, panel feed-through - SF-7EE1N8AS000 - 1605567

## Approvals

Ex Approvals

Approvals submitted

## Approval details

UL Recognized	
mm <sup>2</sup> /AWG/kcmil	4
Nominal current I <sub>N</sub>	25 A
Nominal voltage U <sub>N</sub>	600 V

cUL Recognized	
mm <sup>2</sup> /AWG/kcmil	4
Nominal current I <sub>N</sub>	15 A
Nominal voltage U <sub>N</sub>	600 V

cULus Recognized	
------------------	--

## Accessories

Accessories

Mounting material

Color-coding - SF-Z0064 - 1620585

Color-coding, Color: green



## Pin/socket, panel feed-through - SF-7EE1N8AS000 - 1605567

### Accessories

Color-coding - SF-Z0065 - 1620586



Color-coding, Color: orange

---

Color-coding - SF-Z0066 - 1620587



Color-coding, Color: black

---

Torque screwdriver - SF-Z0028 - 1607456



Torque screwdriver

---

Hook wrench - SF-Z0027 - 1607455



Hook wrench

---

### Protective cover

Plastic dust protection cap - SF-Z0019 - 1607449



Plastic dust protection cap with IP40 eye for connectors with M23 external thread, RF, SF series

---

# Pin/socket, panel feed-through - SF-7EE1N8AS000 - 1605567

## Accessories

Plastic dust protection cap - RC-Z2059 - 1604225



Plastic dust protection cap for connectors with M23 external thread

Plastic anti-static dust protection cap - RC-Z2469 - 1611797



Plastic dust protection cap, anti-static, for RF, SF series connectors, with M23 external thread

Metal dust protection cap - SC-Z2319 - 1605456



Metal dust protection cap for power plugs with M23 external thread

Metal dust protection cap - SC-Z2320 - 1605457



Metal dust protection cap with steel wire for power plugs with M23 external thread

## Drawings

Schematic diagram

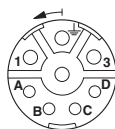

Socket pin assignment

Schematic diagram

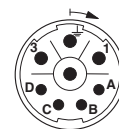

Pin assignment of pin

# Pin/socket, panel feed-through - SF-7EE1N8AS000 - 1605567

Dimensioned drawing

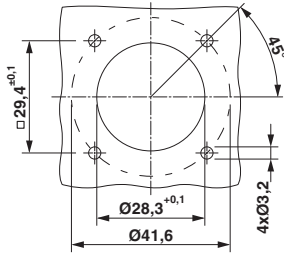

Installation dimensions

Dimensioned drawing

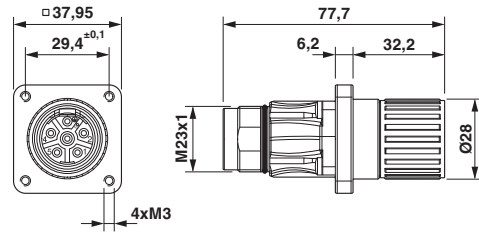

Dimensional drawing

Diagram

