



ENGLISH

## Dimensions

# RS Pro Steel Ventilated Rack Mount Case

Stock No: 665-7738

Item	Description	Qty.
1	TOP-BASE COVER	2
2	GERNERAL PURPOSE BAR 1. (3J-5J-6J,3U-5U-6U)	8
3	INSIDE FRONT/BACK PANEL	2
4	SIDE PANEL	2
5	FRONT PANEL	1
6	HANDLE	2
7	SCREW M3 X 6 mm. PAN HEAD BLACK (With washer)	16
8	TAPER SCREW M3 X 15	12
9	HEX NUT M3 X 0.50 BLACK	12
10	HEX SOCKET SCREW M5 X 15	4
11	RUBBER FOOT	4
12	SCREW M4 X 8 mm. PAN HEAD BLACK (With washer)	16

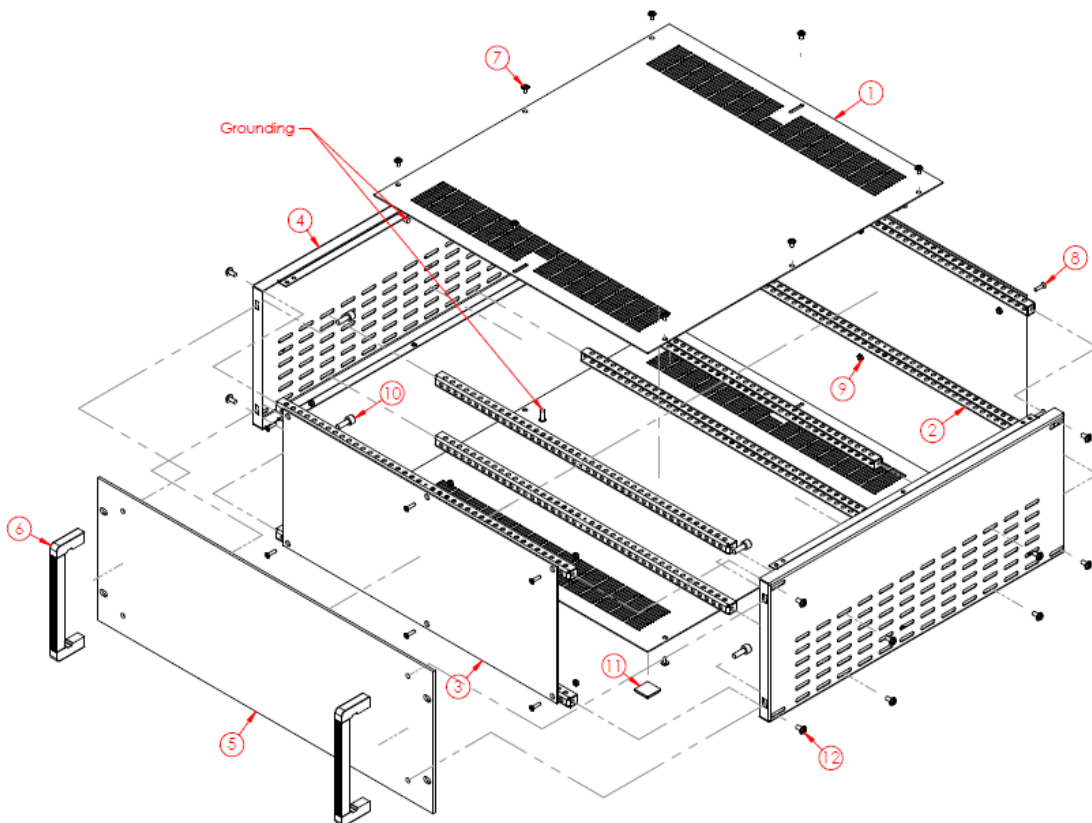

PF 19" ENCLOSURES SERIES					
MODEL	REF. "A"	REF. "B"	REF. "C"	REF. "D"	REF. "E"
PF19" 3U-D2	482.60	132.60	128.00	335.00	425.00
PF19" 3U-D3	482.60	132.60	128.00	425.00	425.00
PF19" 4U-D2	482.60	177.00	172.40	335.00	425.00
PF19" 4U-D3	482.60	177.00	172.40	425.00	425.00
PF19" 5U-D3	482.60	221.50	216.90	425.00	425.00
PF19" 6U-D3	482.60	265.90	261.40	425.00	425.00
PF19" 6U-D4	482.60	265.90	261.40	465.00	425.00

