

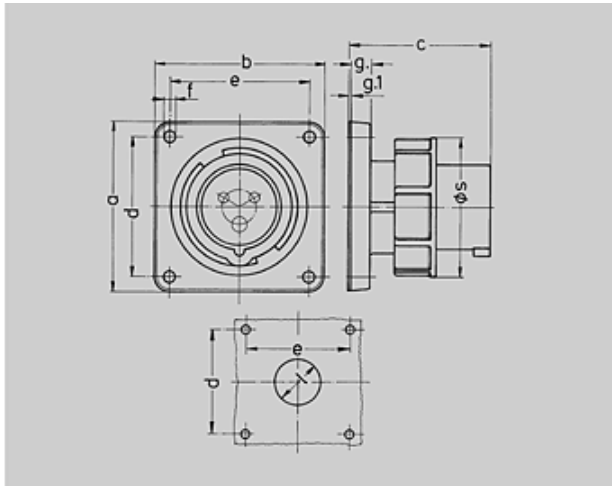

: 825







**Panel mounted inlet**

with nickel-plated contacts



Drawing	Amp.	16			32		
		2 MB 187/2 Poles			3	4	5
Dim. in mm	a	85,7	85,7	85,7	85,7	85,7	85,7
	b	85,7	85,7	85,7	85,7	85,7	85,7
	c	72	72	72	90	90	90
	d	69,5	69,5	69,5	69,5	69,5	69,5
	e	69,5	69,5	69,5	69,5	69,5	69,5
	f	5,5	5,5	5,5	5,5	5,5	5,5
	g.	11	11	11	11	11	11
	g.1	2	2	2	2	2	2
	l	32	36	47	47	47	47
	s	71	79	89	94	94	102
	Terminal for cond. cross section (mm <sup>2</sup> ) min.-max.		1,5	1,5	1,5	2,5	2,5
		-4	-4	-4	-10	-10	-10

	: <b>2080</b>
voltages	: 110V
rated current	: 16A
pole	: 3 pole
IP protection types	: IP67
position of ground contact	: 4h
packing unit	: 0010
	: 155 g

		<b>110</b>	<b>230</b>	<b>400</b>	<b>500</b>	<b>&gt;50-500</b>	
		50,60	50,60	50,60	50,60	100-300	300-500
							
<b>16 A</b>	3	<u>825</u>	826				
	4		839	827	828		
	5			829			
<b>32 A</b>	3	830	831				
	4		840	832	833		
	5			834			