

Datasheet

RS Pro Cable Clip 12.7mm Black PE

RS Stock No: **184-5214**



Product Details

RS Pro cable clip in black colour, has a maximum bundle diameter of 12.7 mm. The cable cleat is manufactured from low density polyethylene, which has high strength and impact resistance. The material is resistant to corrosion and UV light. It is stable at temperature of -30 to +60°C.

Features and Benefits

- Comes in black colour
- Low density polyethylene (LDPE) construction
- Temperature range from -30 to +60°C

Specifications:

Affixing Method	Screw
Cable Clip/Clamp Style	Cable Clip
Colour	Black
Depth	28 mm
Dimensions [L x W (x D)]	17.5 x 28 mm
Material	PE
Maximum Bundle Diameter	12.7 mm
Width	17.5 mm

- MS4 = RS 184-4609**
- MS5 = RS 184-5214**
- MS6 = RS 184-4615**
- MS7 = RS 184-5220**
- MS8 = RS 184-4621**
- MS9 = RS 184-4637**
- MS10 = RS 184-4643**

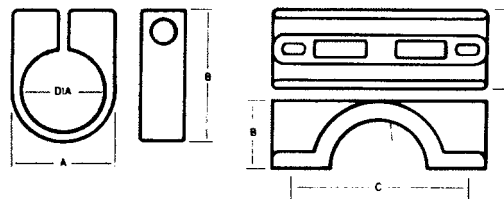

Dimensional Data

Reference Numbers	Dimensions			
	Width A mm	Height B mm	Fixing Centres C mm	Clearance Bolt Holes mm
Standard Polypropylene				
Single Fixing				
MS 5	17.5	28.0	N/A	6
MS 6	20.0	31.0	N/A	6
MS 7	23.0	34.0	N/A	6
MS 8	25.0	38.0	N/A	6
MS 9	28.5	41.0	N/A	6
MS 10	30.0	43.5	N/A	6

Size:

MS
5

Qty:

50

Conductor size mm ²	Copper conductor wire armoured Number of cores			Aluminium conductor wire armoured Number of cores			MULTICORE CABLES			
							Conductor size			
				4			1.5mm ²	2.5mm ²	4mm ²	
1.5	5	5	6				5 core	6	7	8
2.5	6	6	6							
4	6	7	7				7 core	6	7	9
6	7	8	8							
10	8	9	9				10 core	8	9	11
16	9	10	11	7	8	9				
25	10	11	12	9	10	12	12 core	8	9	11
35	12	12	14	10	10	12				
50	7	11	12	14	8	10	19 core	9	10	12
70	8	12	14	16	8	12				
95	9	14	16	18	9	14	27 core	10	12	16
120	10	16	18	20	10	16				
150	11	16	18		12	18	37 core	12	14	
185	12	18			12	20				
240	14	20			14		48 core	14	16	
300	16				14					