



Figure similar

ENCLOSURE FOR COMMAND DEVICES, 22MM, ROUND, ENCLOSURE MATERIAL METAL, ENCLOSURE TOP PART YELLOW, WITH PROTECTIVE COLLAR, 1 COMMAND POINT, UNEQUIPPED, BASE MOUNTING, TOP AND BOTTOM 1 X M20 EACH

product brand name		SIRIUS ACT
Product designation		Commanding and signaling devices
Design of the product		Surface-mounted housing

Enclosure:

Design of the housing		with protective collar
Shape of the enclosure front		Square
Material of the enclosure		metal
Number of control points		1
Product component		
• protective collar		Yes
Color		
• of top part of the enclosure		yellow
Mounting type of the enclosure		Vertical

Installation/ mounting/ dimensions:

Height	mm	85
Width	mm	85
Depth	mm	111.3
Mounting diameter	mm	22

Certificates/ approvals:

Further information

Information- and Downloadcenter (Catalogs, Brochures,...)

<http://www.siemens.com/industrial-controls/catalogs>

Industry Mall (Online ordering system)

<http://www.siemens.com/industrymall>

Cax online generator

<http://support.automation.siemens.com/WW/CAXorder/default.aspx?lang=en&mfb=3SU18510AA000AC2>

Service&Support (Manuals, Certificates, Characteristics, FAQs,...)
<http://support.automation.siemens.com/WW/view/en/3SU18510AA000AC2/all>

Image database (product images, 2D dimension drawings, 3D models, device circuit diagrams, EPLAN macros, ...)
http://www.automation.siemens.com/bilddb/cax_de.aspx?mlfb=3SU18510AA000AC2&lang=en

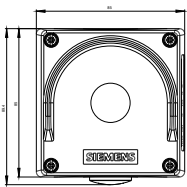

last modified:

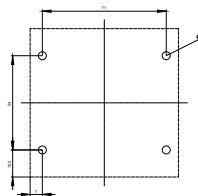
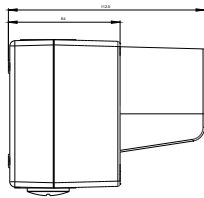

09.03.2015