

Deep groove ball bearings, single row, SKF Energy Efficient (E2) bearings

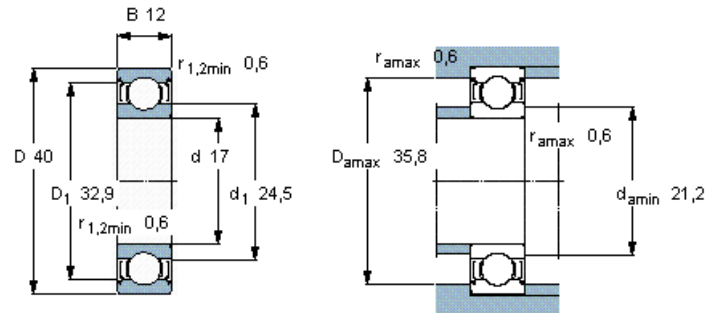

Principal dimensions			Basic load ratings		Fatigue load limit P_u	Speed ratings		Mass	Designation
d	D	B	dynamic	static		Reference speed	Limiting speed		
mm			kN		kN	r/min		kg	-
17	40	12	9,56	4,75	0,2	41000	21000	0,065	E2.6203-2Z/C3



Calculation factors

k_r 0,025
 f_0 13