

Product datasheet

Black post with retractable black belt

RS 829-9062



Material: stainless steel tube 63 mm dia.
350 mm dia. Dome cover and concrete base
Rubber under base for protection
Belt heavy nylon/polyester cross weave belt

Finished: black powder coating

Centrifugal braking system cassette w/4 –way retractable belt 2.8 m length / 5 cm width

Post height: 950 – 1000 mm

Features:

Heavy gauge steel post won't dent and scratch like aluminum

Usability: 4-way receptacles + universal belt end/clip + rubber protectors

Simplicity: knocked down + easy assembly + easy replaceable cassette

Assemble instruction:

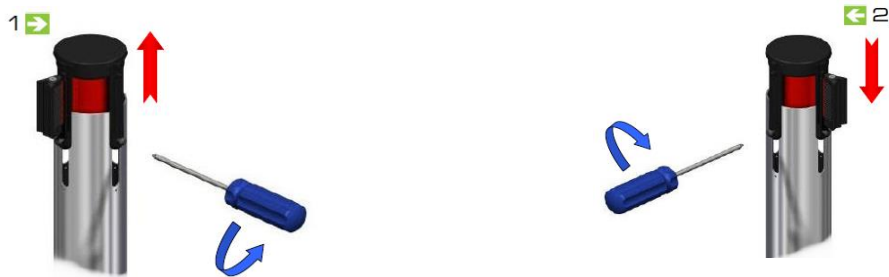

Packaging information: 2 set into carton

