

THIS DRAWING IS UNPUBLISHED. RELEASED FOR PUBLICATION 20
 © COPYRIGHT 20 BY TYCO ELECTRONICS CORPORATION. ALL RIGHTS RESERVED.

LOC	DIST	REVISIONS						
		P	LTR	DESCRIPTION	ECN	DATE	DWN	APVD
J	-	A1		REVISED	ECR-05-012963	130CT2005	M.M	D.M
		A2		PART NO ADDITION	ECR-07-005648	22MAR2007	M.M	D.M
		A3		REVISED	ECR-07-016167	10JUL2007	M.M	D.M
		A4		PART NO ADDITION	ECR-08-025620	140CT2008	M.M	S.M

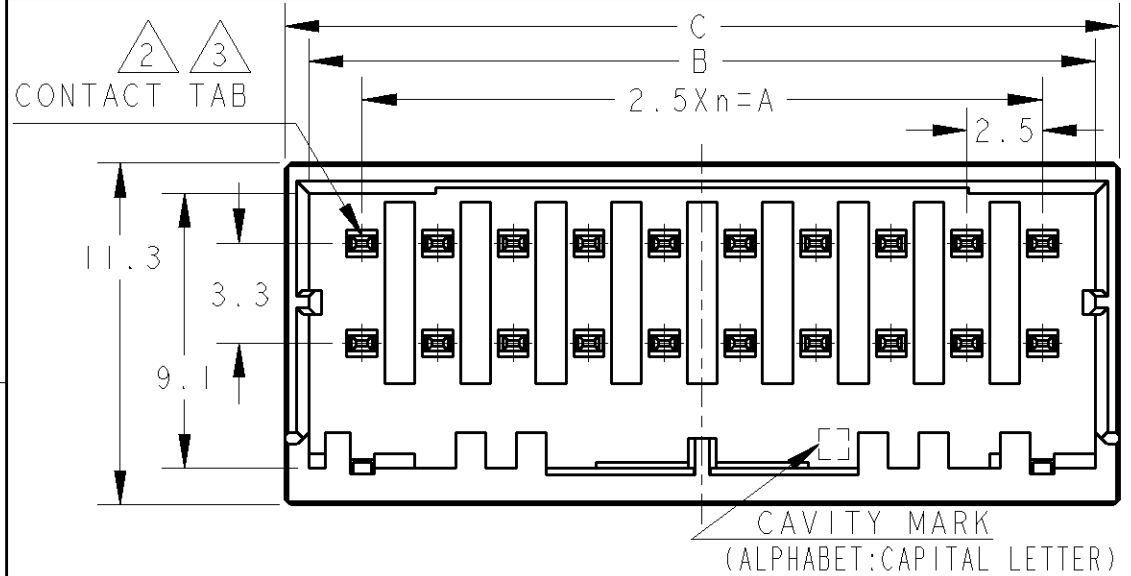

1. 材料:ハウジング:ガラス入り熱可塑性ポリエステル樹脂(94V-0)、色:黒
 コンタクト:銅合金
 リテンションレグ:錫めっき銅合金
- △2. めっき:全面:ニッケル下地めっき1.27μm以上
- △3. めっき:接触部 △2の上に金めっき0.38μm以上
- △4. めっき:コンタクト半田付部: △2の上に錫めっき2μm以上
5. 文字の形状、大きさ、および位置については、大略を示すものであり、詳細を示すものではありません。
6. Y KEY形状は、X KEY形状と左右対称

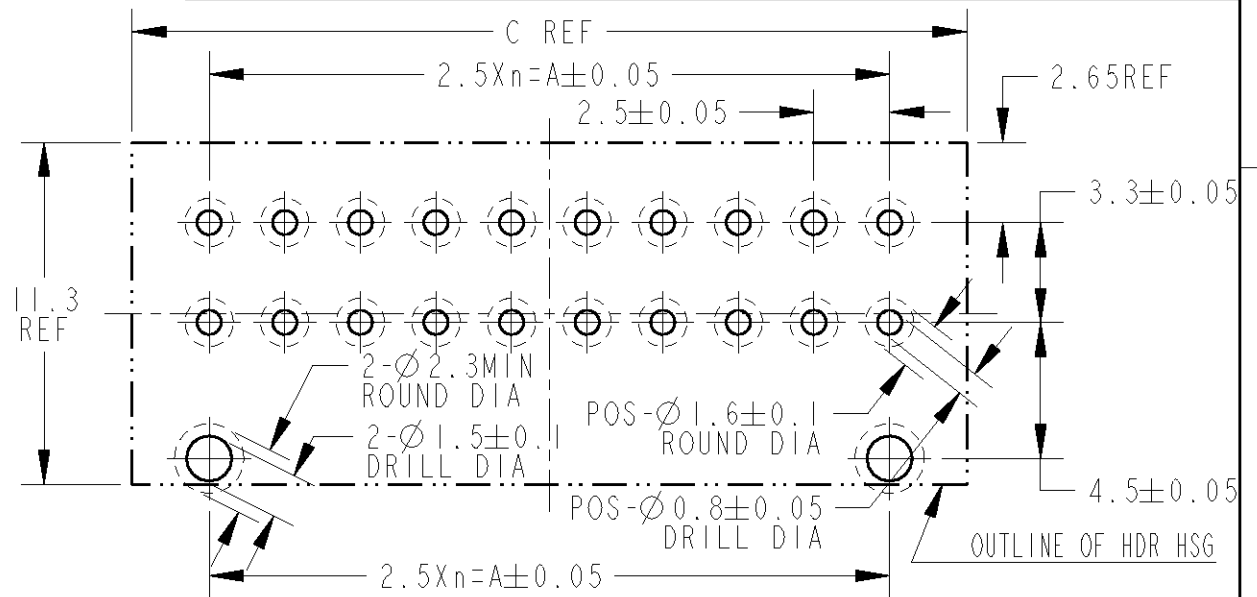

推奨基板取付穴寸法:コネクタ搭載面(非累積公差)
 PC基板厚:1.0~1.6±0.1

RECOMMEND PC BOARD HOLE PATTERN
 : CONNECTOR MOUNT SIDE (NOT ACCUMULATE TOLERANCE)
 PC BOARD THICKNESS : 1.0~1.6±0.1

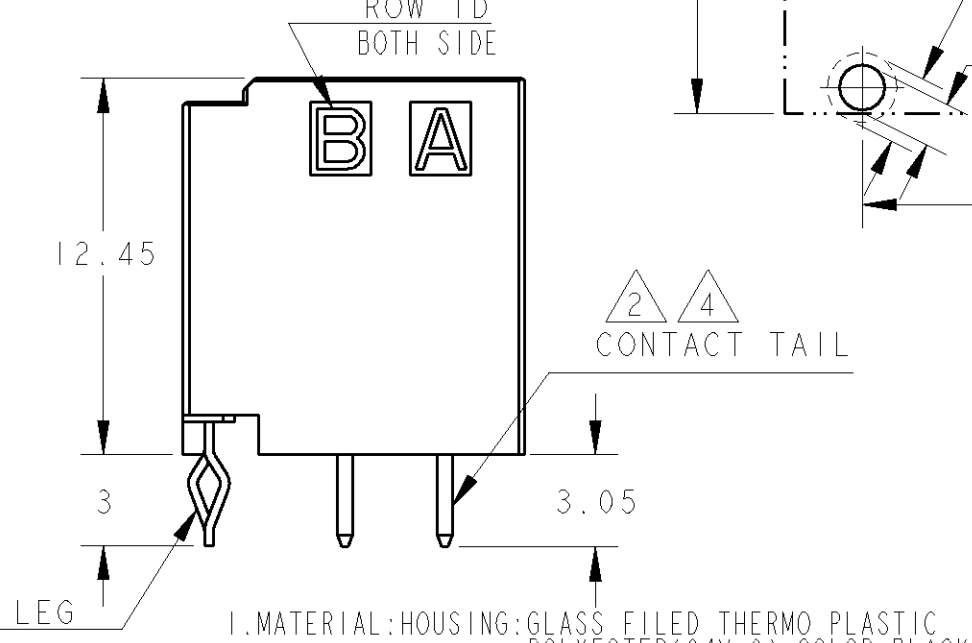
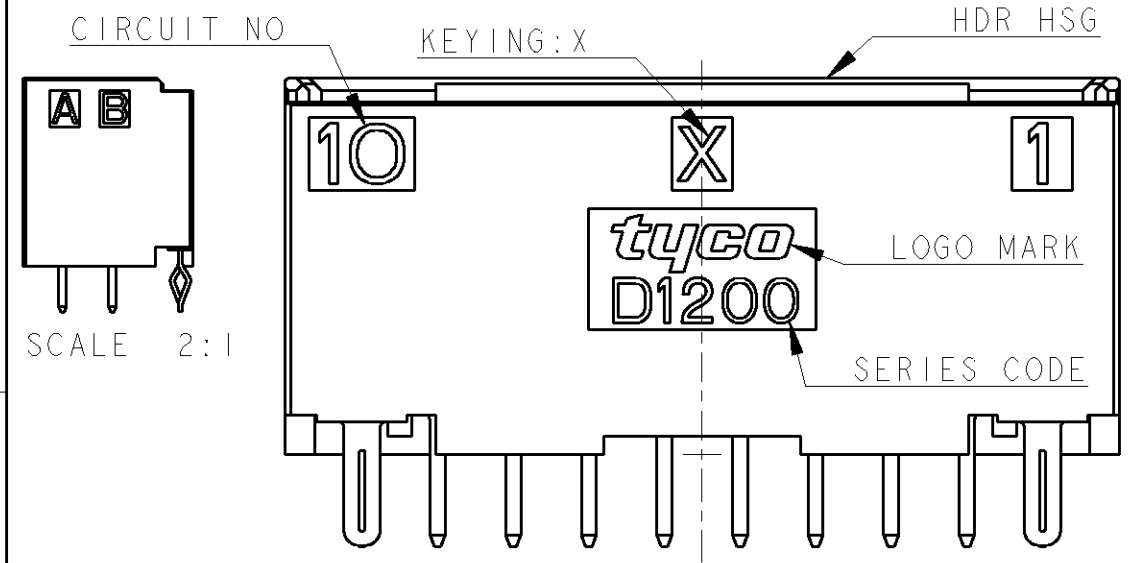

1. MATERIAL: HOUSING: GLASS FILLED THERMO PLASTIC POLYESTER (94V-0), COLOR: BLACK
 CONTACT: COPPER ALLOY
 RETENTION LEG: PRE-TIN COPPER ALLOY
- △2. FINISH (ALL OVER): NICKEL PL. 1.27μm MIN
- △3. FINISH (CONTACT AREA): GOLD PL. 0.38μm MIN AFTER △2
- △4. FINISH (CONTACT TAIL): TIN PL. 2μm MIN AFTER △2
5. THE SHAPE, SIZE AND POSITION OF THE CHARACTER SHOW THE OUTLINE. THEY DON'T SHOW DETAILS.
6. THE KEYING ARRANGEMENT OF "Y" IS SYMMETRIC WITH "X".

20	Y	9	22.5	26.0	27.6	2-1827875-0
20	X	9	22.5	26.0	27.6	1-1827875-0
16	Y	7	17.5	21.0	22.6	2-1827875-8
16	X	7	17.5	21.0	22.6	1-1827875-8
12	Y	5	12.5	16.0	17.6	2-1827875-6
12	X	5	12.5	16.0	17.6	1-1827875-6
10	Y	4	10.0	13.5	15.1	2-1827875-5
10	X	4	10.0	13.5	15.1	1-1827875-5
8	Y	3	7.5	11.0	12.6	2-1827875-4
8	X	3	7.5	11.0	12.6	1-1827875-4
6	Y	2	5.0	8.5	10.1	2-1827875-3
6	X	2	5.0	8.5	10.1	1-1827875-3
4	Y	1	2.5	6.0	7.6	2-1827875-2
4	X	1	2.5	6.0	7.6	1-1827875-2
POS	KEY	n	A	B	C	PART NO

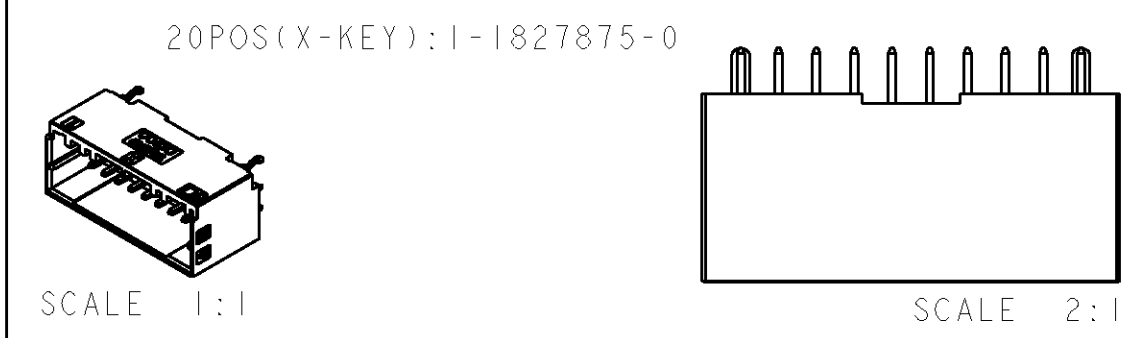
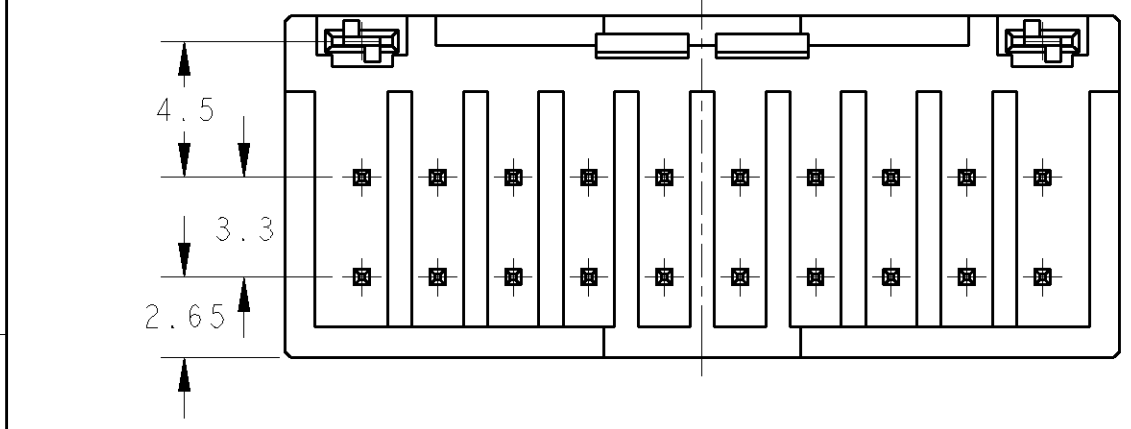

THIS DRAWING IS A CONTROLLED DOCUMENT FOR TYCO ELECTRONICS CORPORATION. IT IS SUBJECT TO CHANGE AND THE CONTROLLING ENGINEERING ORGANIZATION SHOULD BE CONTACTED FOR THE LATEST REVISION.

DIMENSIONS: 単位: 概 mm	TOLERANCES UNLESS OTHERWISE SPECIFIED: 一般公差 ±0.3, ±5°	DWN T. KUDO 14JAN2005	Tyco Electronics AMP K.K. Kawasaki, Japan
	0-PLC ±	CHK D. MITSUGI 14JAN2005	
	1-PLC ±0.5	APVD D. MITSUGI 14JAN2005	
	2-PLC ±0.13	PRODUCT SPEC 108-78268	
MATERIAL 材料	FINISH 仕上	APPLICATION SPEC 114-5377	NAME 名称 DYNAMIC D1200D 2.5mm PITCH HDR ASSY (V-TYPE) 4-20POS
		WEIGHT -	SIZE A3 CAGE CODE 00779 DRAWING NO C-1827875 RESTRICTED TO -
CUSTOMER DRAWING			SCALE 4:1 SHEET 1 OF 3 REV A4

4

4POS(X-KEY):1-1827875-2

3

2

1

THIS DRAWING IS UNPUBLISHED. RELEASED FOR PUBLICATION
© COPYRIGHT 20 BY TYCO ELECTRONICS CORPORATION. ALL RIGHTS RESERVED.

LOC	DIST	REVISIONS					
		P	LTR	DESCRIPTION	DATE	DWN	APVD
J	-			SEE SHEET 1 OF 3			

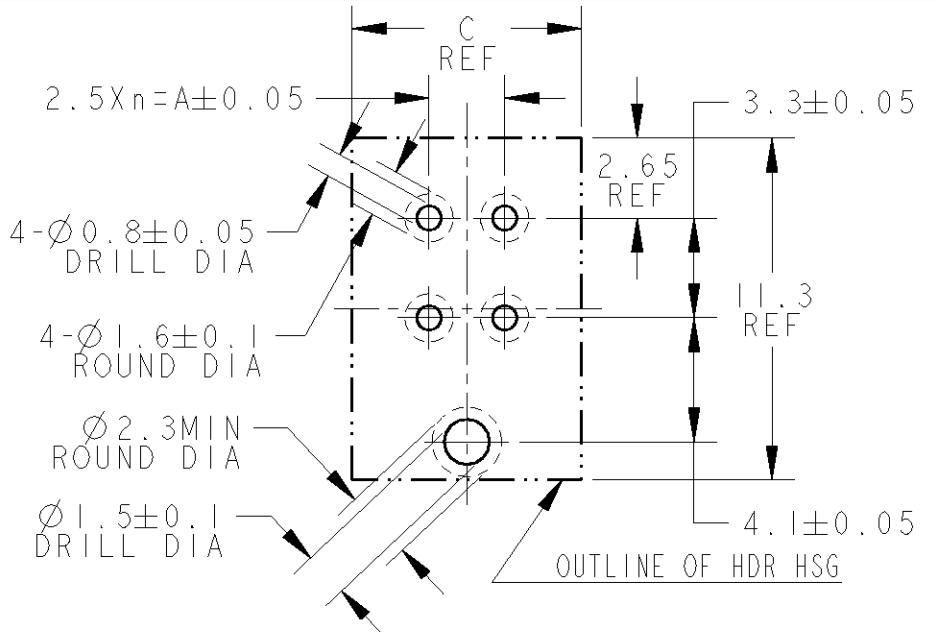
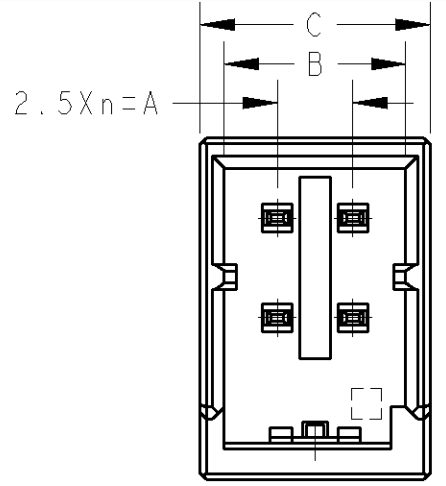

推奨基板取付穴寸法: コネクタ搭載面 (非累積公差)
PC基板厚: 1.0~1.6±0.1
RECOMMEND PC BOARD HOLE PATTERN
: CONNECTOR MOUNT SIDE (NOT ACCUMULATE TOLERANCE)
PC BOARD THICKNESS : 1.0~1.6±0.1

ONLY 4POS

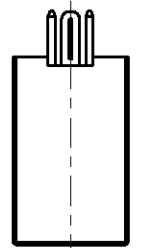
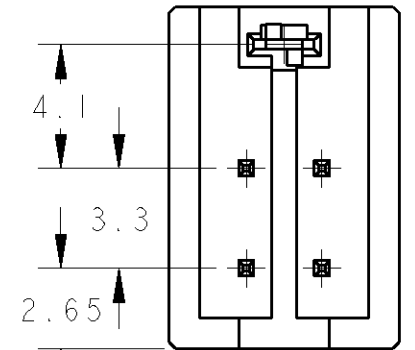
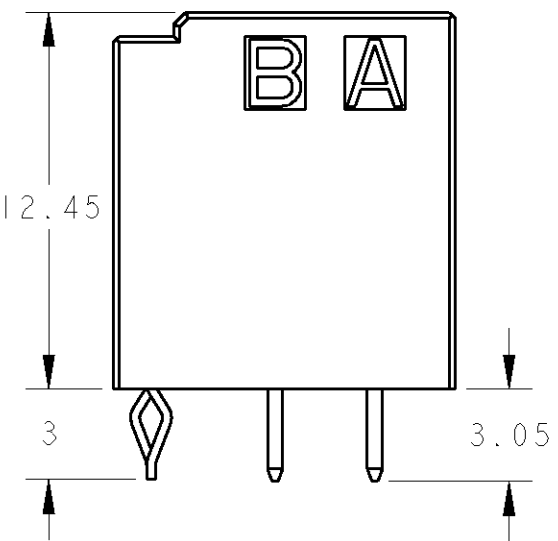
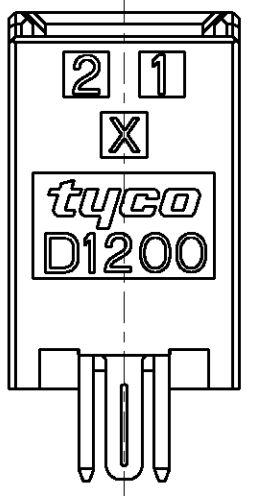

SCALE 2:1

4POS(X-KEY):1-1827875-2

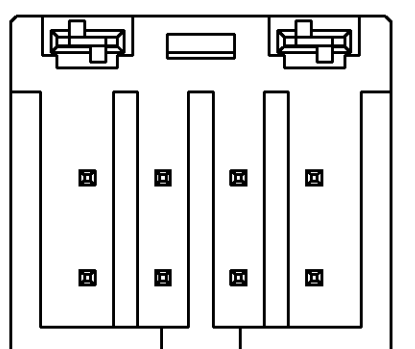
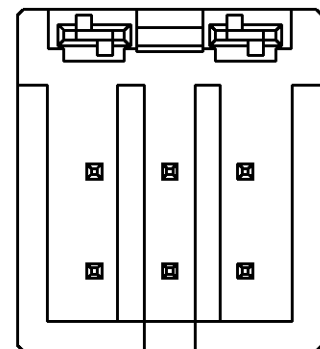
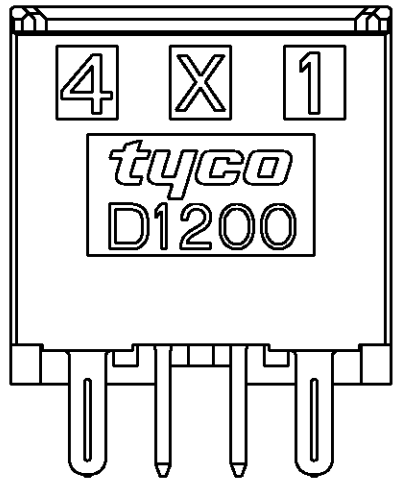
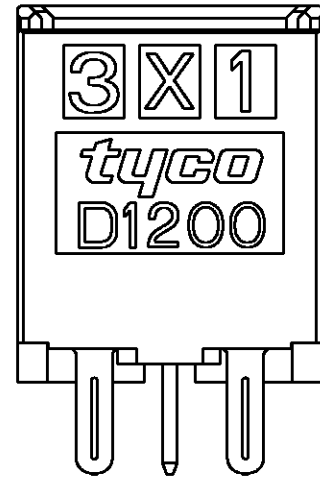
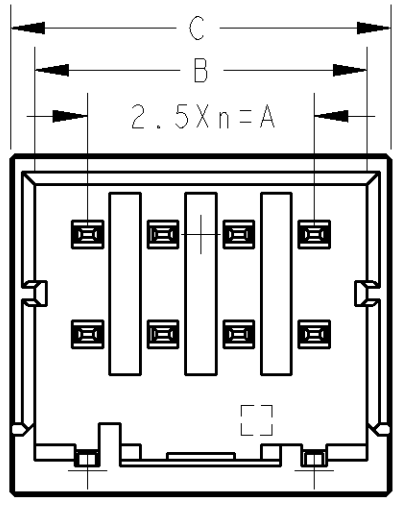
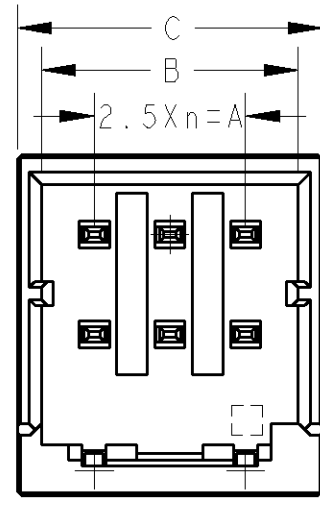

6POS(X-KEY):1-1827875-3

8POS(X-KEY):1-1827875-4

THIS DRAWING IS A CONTROLLED DOCUMENT FOR TYCO ELECTRONICS CORPORATION. IT IS SUBJECT TO CHANGE AND THE CONTROLLING ENGINEERING ORGANIZATION SHOULD BE CONTACTED FOR THE LATEST REVISION.		DWN	T. KUDO	14JAN2005	Tyco Electronics Tyco Electronics AMP K.K. Kawasaki, Japan
DIMENSIONS:		CHK	D. MITSUGI	14JAN2005	
TOLERANCES UNLESS OTHERWISE SPECIFIED:		APVD	D. MITSUGI	14JAN2005	NAME DYNAMIC D1200D 2.5mmPITCH HDR ASSY (V-TYPE) 4-20POS
0 PLC ±		PRODUCT SPEC	108-78268	APPLICATION SPEC	
1 PLC ±		APPLIC. SPEC	114-5377	WEIGHT	SIZE
2 PLC ±		MATERIAL		FINISH	CAGE CODE
3 PLC ±		SEE SHEET 1 OF 3			DRAWING NO
4 PLC ±					RESTRICTED TO
ANGLES ±					SCALE
MATERIAL					SHEET
FINISH					OF
		CUSTOMER DRAWING			REV
					A4

THIS DRAWING IS UNPUBLISHED. RELEASED FOR PUBLICATION 20
 © COPYRIGHT 20 BY TYCO ELECTRONICS CORPORATION. ALL RIGHTS RESERVED.

LOC	DIST	REVISIONS					
J	-	P	LTR	DESCRIPTION	DATE	DWN	APVD
				SEE SHEET 1 OF 3			

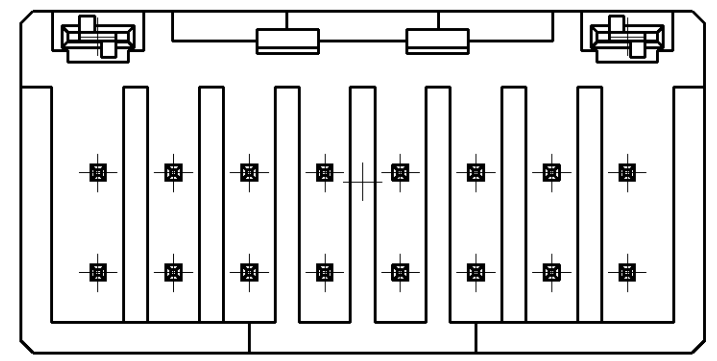
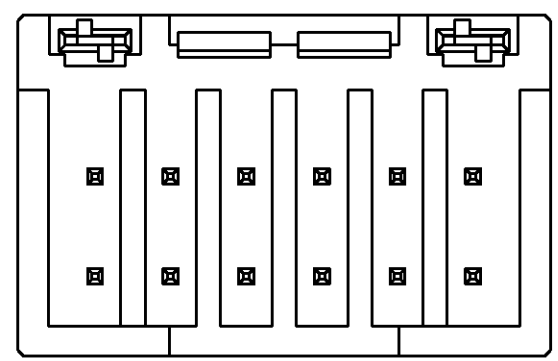
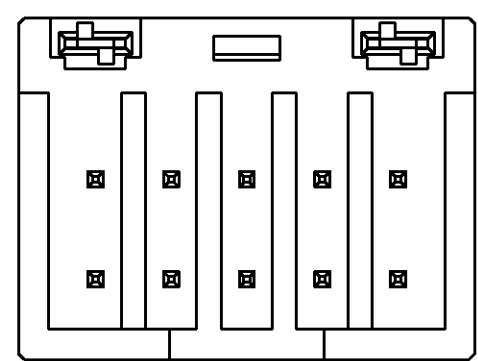
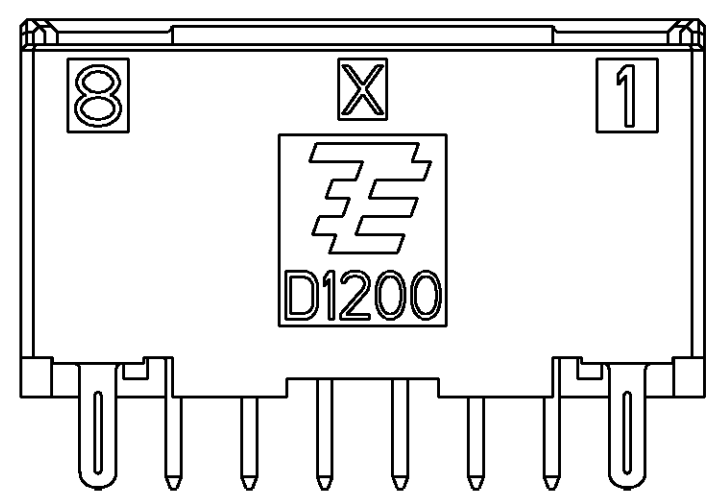
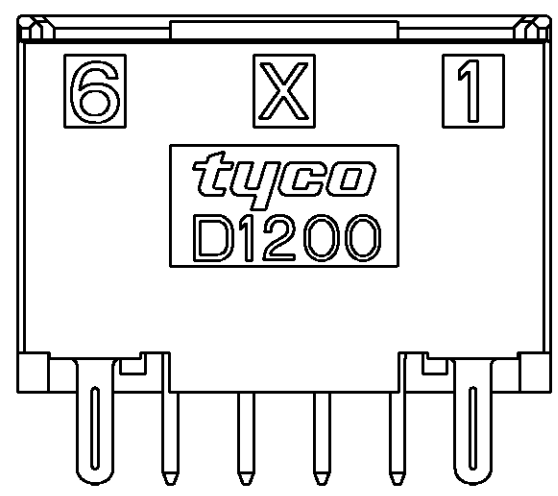
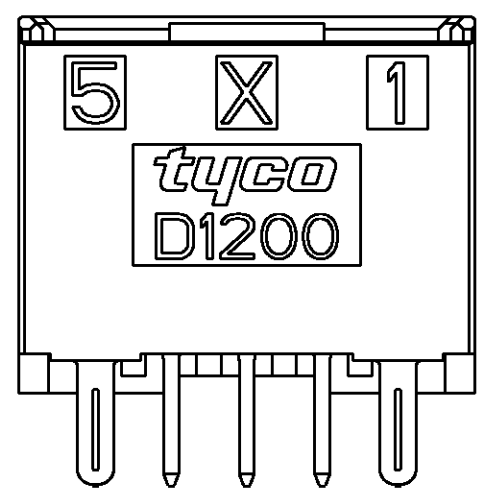
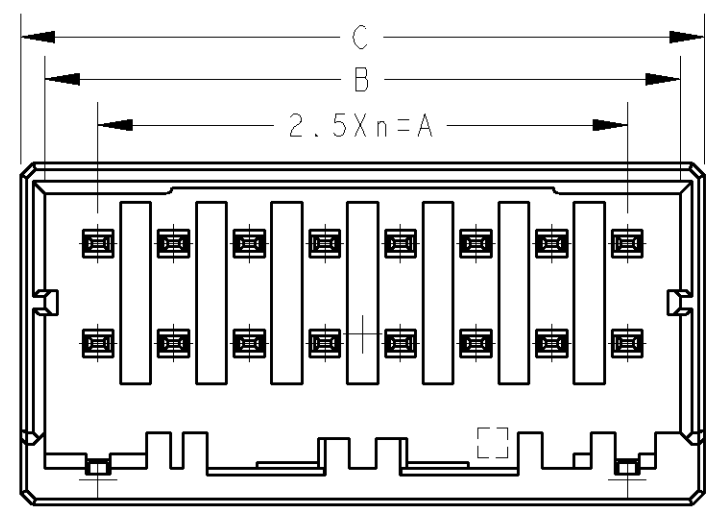
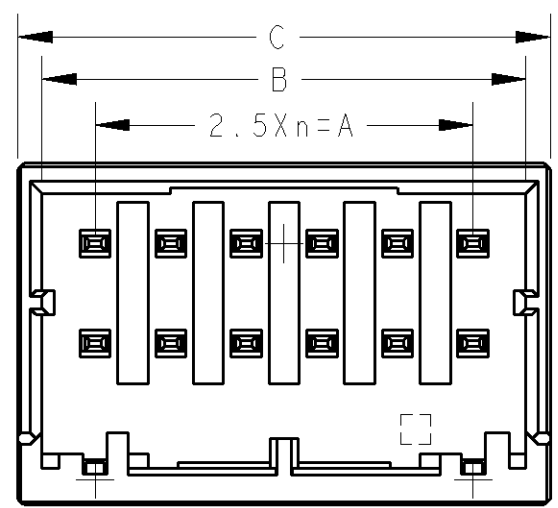
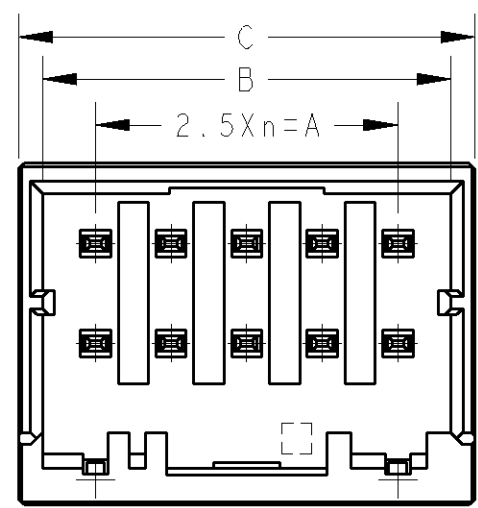

10POS(X-KEY): I-1827875-5

12POS(X-KEY): I-1827875-6

16POS(X-KEY): I-1827875-8

THIS DRAWING IS A CONTROLLED DOCUMENT FOR TYCO ELECTRONICS CORPORATION
 IT IS SUBJECT TO CHANGE AND THE CONTROLLING ENGINEERING ORGANIZATION
 SHOULD BE CONTACTED FOR THE LATEST REVISION.

DIMENSIONS:	TOLERANCES UNLESS OTHERWISE SPECIFIED:
0 PLC	±
1 PLC	±
2 PLC	±
3 PLC	±
4 PLC	±
ANGLES	±
MATERIAL	FINISH

SEE SHEET 1 OF 3

DWN	T. KUDO	14JAN2005	Tyco Electronics AMP K.K. Kawasaki, Japan	
CHK	D. MITSUGI	14JAN2005		
APVD	D. MITSUGI	14JAN2005		
PRODUCT SPEC	NAME			
108-78268	DYNAMIC D1200D 2.5mmPITCH			
APPLICATION SPEC	HDR ASSY (V-TYPE)			
114-5377	4-20POS			
WEIGHT	SIZE	CAGE CODE	DRAWING NO	RESTRICTED TO
-	A3	00779	C-1827875	-
CUSTOMER DRAWING	SCALE	SHEET	OF	REV
	4:1	3	3	A4