

Datasheet

## RS Pro Cable Clip 10.1mm Black PE

RS Stock No: **184-4609**



### Product Details

RS Pro cable clip in black colour, has a maximum bundle diameter of 10.1 mm. The cable cleat is manufactured from low density polyethylene, which has high strength and impact resistance. The material is resistant to corrosion and UV light. It is stable at temperature of -30 to +60°C.

### Features and Benefits

- Comes in black colour
- Low density polyethylene (LDPE) construction
- Temperature range from -30 to +60°C

**Specifications:**

|                         |            |
|-------------------------|------------|
| Affixing Method         | Screw      |
| Cable Clip/Clamp Style  | Cable Clip |
| Colour                  | Black      |
| Material                | PE         |
| Maximum Bundle Diameter | 10.1 mm    |

- MS4 = RS 184-4609
- MS5 = RS 184-5214
- MS6 = RS 184-4615
- MS7 = RS 184-5220
- MS8 = RS 184-4621
- MS9 = RS 184-4637
- MS10 = RS 184-4643

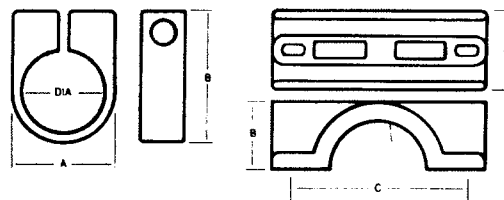

**Dimensional Data**

| Reference Numbers             | Dimensions |         |                |                      |
|-------------------------------|------------|---------|----------------|----------------------|
|                               | Width      | Height  | Fixing Centres | Clearance Bolt Holes |
|                               | A<br>mm    | B<br>mm | C<br>mm        | mm                   |
| <i>Standard Polypropylene</i> |            |         |                |                      |
| <b>Single Fixing</b>          |            |         |                |                      |
| MS 5                          | 17.5       | 28.0    | N/A            | 6                    |
| MS 6                          | 20.0       | 31.0    | N/A            | 6                    |
| MS 7                          | 23.0       | 34.0    | N/A            | 6                    |
| MS 8                          | 25.0       | 38.0    | N/A            | 6                    |
| MS 9                          | 28.5       | 41.0    | N/A            | 6                    |
| MS10                          | 30.0       | 43.5    | N/A            | 6                    |

Size:

**MS 4**

Qty:

**50**

| Conductor size mm <sup>2</sup> | Copper conductor wire armoured<br>Number of cores |    |    | Aluminium conductor wire armoured<br>Number of cores |    |    | MULTICORE CABLES   |                    |                  |    |    |    |
|--------------------------------|---|----|----|--|----|----|--------------------|--------------------|------------------|----|----|----|
|                                |   |    |    |  |    |    | Conductor size     |                    |                  |    |    |    |
|                                |   |    |    | 4  |    |    | 1.5mm <sup>2</sup> | 2.5mm <sup>2</sup> | 4mm <sup>2</sup> |    |    |    |
| 1.5                            | 5   | 5  | 6  |  |    |    | 5 core             | 6                  | 7                | 8  |    |    |
| 2.5                            | 6   | 6  | 6  |  |    |    |                    |                    |                  |    |    |    |
| 4                              | 6   | 7  | 7  |  |    |    | 7 core             | 6                  | 7                | 9  |    |    |
| 6                              | 7   | 8  | 8  |  |    |    |                    |                    |                  |    |    |    |
| 10                             | 8   | 9  | 9  |  |    |    | 10 core            | 8                  | 9                | 11 |    |    |
| 16                             | 9   | 10 | 11 | 7  | 8  | 9  |                    |                    |                  |    |    |    |
| 25                             | 10  | 11 | 12 | 9  | 10 | 12 | 12 core            | 8                  | 9                | 11 |    |    |
| 35                             | 12  | 12 | 14 | 10   | 10 | 12 |                    |                    |                  |    |    |    |
| 50                             | 7   | 11 | 12 | 14   | 8  | 10 | 12                 | 14                 | 19 core          | 9  | 10 | 12 |
| 70                             | 8   | 12 | 14 | 16   | 8  | 12 | 14                 | 16                 |                  |    |    |    |
| 95                             | 9   | 14 | 16 | 18   | 9  | 14 | 16                 | 18                 | 27 core          | 10 | 12 | 16 |
| 120                            | 10  | 16 | 18 | 20   | 10 |    | 16                 | 20                 |                  |    |    |    |
| 150                            | 11  | 16 | 18 |  | 12 |    | 18                 | 20                 | 37 core          | 12 | 14 |    |
| 185                            | 12  | 18 |    |  | 12 |    | 20                 |                    |                  |    |    |    |
| 240                            | 14  | 20 |    |  | 14 |    |                    |                    |                  |    |    |    |
| 300                            | 16  |    |    |  | 14 |    |                    |                    | 48 core          | 14 | 16 |    |