



ENGLISH

Datasheet

RS Pro Cylindrical Transducer Magnet, 4 x 19 mm

RS Stock No: **536-1710**



Product Details

RS Pro transducer magnet in cylindrical shape, is perfect for use in actuating reed switches. This magnet measures 4 x 19 mm and is suitable for transducer.

Features and Benefits

- Cylindrical shape
- Used for transducer
- Measures 4 x 19 mm



Specifications:

Application	Transducer
Diameter	4 mm
Dimensions	4 (dia.) x 19 mm
Length	19 mm
Shape	Cylindrical
Operating Temperature Range	+450°C

Dimensions (mm)

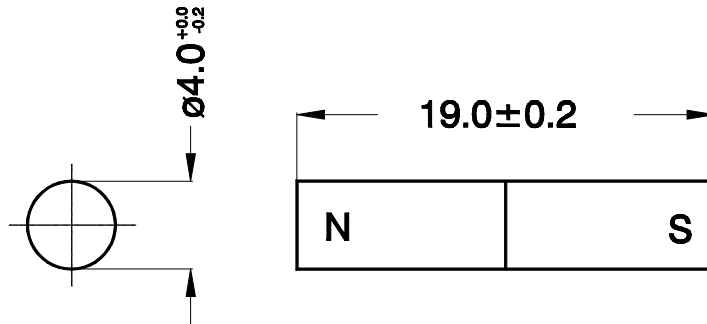

round bar magnet magnetization axial

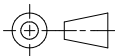

AlNiCo 500 code acc. to DIN 17410 : 35 / 5

Magnetic values acc. to DIN 17410		Min.	Typ.	Max.	unit
Energy product	(B x H) max.	35	39,8	-	kJ/m^3
Remanence	B_r	1120	1240	-	mT
revers. temp. coeff. of B_r		-	-0,02%	-	%/K
Coercivity	H_{cB}	47,0	51,3	-	kA/m
Coercivity	H_{cJ}	48,0	51,7	-	kA/m
revers. temp. coeff. of H_{cJ}		-	-	-	%/K
Density		-	7,4	-	g/cm^3
max. operating temperature		-	-	450	$^{\circ}\text{C}$

Remark : all details correspond to manufacturers information

Magnetic Moment	M	1,98	2,22	-	$\text{X}10^{-5}$ Vs-cm
-----------------	---	------	------	---	----------------------------

DEFINITION:

$$M = \Phi \cdot K$$

Φ = Magnetic Flux

K = Coil Constant