

FILE NO:

DESCRIPTION CONTROL

REV	DRAW	DATE	ECN NO.
R1		2012.04.23	

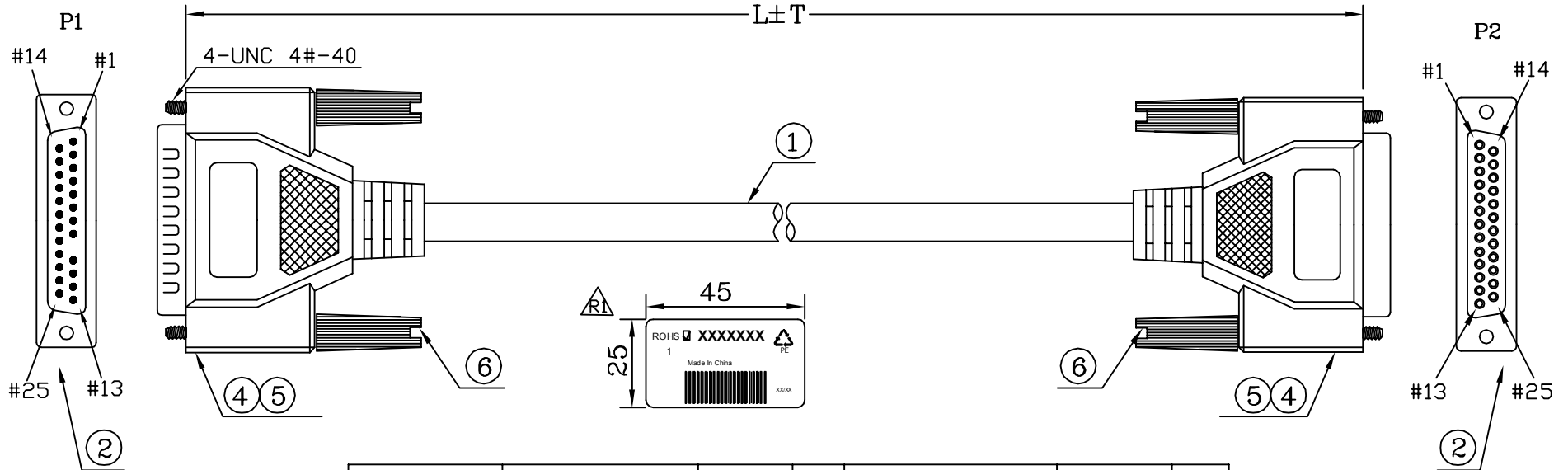

CUSTOMER P/N	L	M	PE BAG:L*W*0.06MM	TIE-A/GY22	Q'TY
7587447	2000±50	2.0	PE BAG:6*8*0.06MM	120*1	A/R
7587440	6000±50	6.0	PE BAG:7*10*0.06MM		A/R
7587444	10000±100	10.0	PE BAG:8*12*0.06MM		A/R

RoHS COMPLIANT



PIN ASSIGNMENT				7587447& 7587440& 7587441			
P1	P2	P1	P2				
1	1	14	14				
2	2	15	15				
3	3	16	16				
4	4	17	17				
5	5	18	18				
6	6	19	19				
7	7	20	20				
8	8	21	21				
9NC	NC9	22	22				
10	10	23	23				
11	11	24	24				
12	12	25	25				
13	13	S	S				
*		LABEL:45*25MM*	1	PCS			
*	220030000361	TIE-A-GY22	***	MM	OUTER MOLDING	IDB2515	
*	310000000012	CARTON:46*30*25CM	A/R	PCS	INNER MOLDING	IDB2514	
*	300010000001	PE BAG:30*28*0.08MM	A/R	PCS			
*		PE BAG:L*W*0.06MM	1	PCS			
6	240010100031	SRW-E31.5/GY22	4	PCS			
5	120010000042	PVC-GY22/50	69	G			
4	220020000001	PVC-IN	16.6	G			
3		CDS-25S<BK>	1	PCS			
2		CDS-25P<BK><PIN9 plugged>	1	PCS			
1	1205725922002X	28#-25C+D+A-GY22-Ø7.0UL2464	L	M			
NO	PART NO.	DESCRIPTION	QTY	UNIT	ALL DIMENSIONS IN		

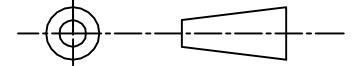

ITEM:	REV
SCALE: NONE	R1
DATE: 2011-08-30	
CUSTOMER: C331<RS>	
PAGE: 1/1	
CUSTOMER P/N:	