

**Ordering number** C11794_ANNA-40-4-M

| | | | |
|-----------------|------------|-------------|------------|
| Family | Anna-40-4 | FWHM | 20 degrees |
| Type | Lens array | Efficiency | 90 % |
| LED | NF2x757A | cd/lm | 4.080 |
| Color | Clear | Gerber File | Available |
| Diameter | 40 mm | | |
| Height | 10.7 mm | | |
| Style | Round | | |
| Optic Material | PMMA | | |
| Holder Material | - | | |
| Fastening | Pin, glue | | |
| Status | Ready | | |

NOTE: The typical divergence will be changed by different color, chip size and chip position tolerance. The typical total divergence is the full angle measured where the luminous intensity is half of the peak value.



PRODUCT DATASHEET
Anna-40-4 series
last update 16/4/2012



GENERAL INFORMATION

- Product series especially designed & optimized for NF2x757A series of LEDs.
- Special care taken to make light distribution as uniform as possible.
- Lens material optical grade PMMA with high UV and temperature resistance. Allows use of high current and temperature conditions.

Please find more information about used material from below:

http://ledil.fi/sites/default/files/Documents/Technical/Material/PMMA%20N%20UL94_Yellow%20Card.pdf

<http://ledil.fi/sites/default/files/Documents/Technical/Material/PMMA%20N%20PLEXIGLAS-Datasheet.pdf>

D

C

B

A

4

4

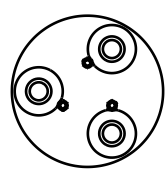

Anna-3

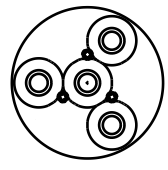

Anna-4

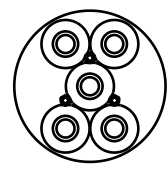

Anna-5

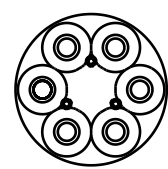

Anna-6

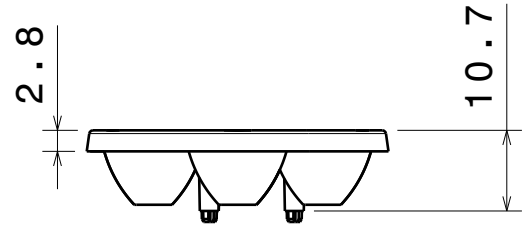

Anna-7

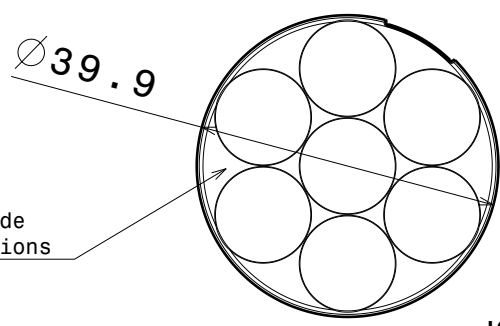

Same top side in all versions

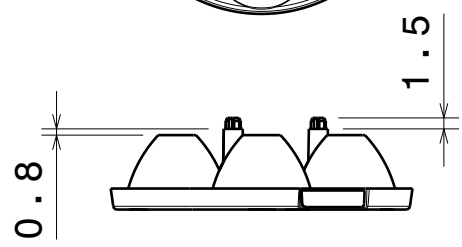

3

3

Material: PMMA

- Versions:
- Anna-3-S
 - Anna-3-M
 - Anna-3-W
 - Anna-4-S
 - Anna-4-M
 - Anna-4-W
 - Anna-5-S
 - Anna-5-M
 - Anna-5-W
 - Anna-6-S
 - Anna-6-M
 - Anna-6-W
 - Anna-7-S
 - Anna-7-M
 - Anna-7-W

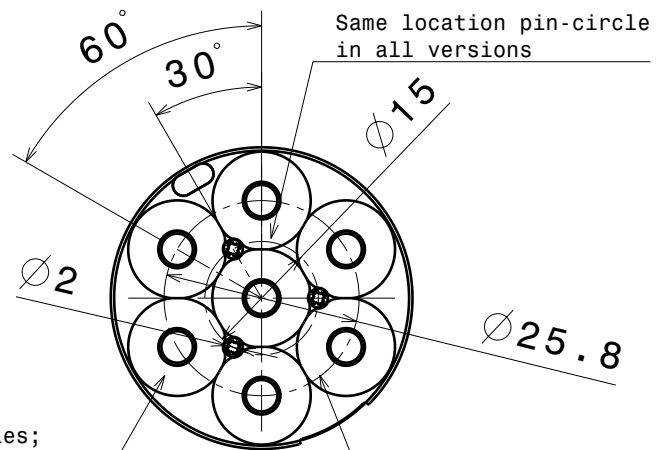

Number of cones varies; 3, 4, 5, 6 and 7pcs on bottom side depending the version.

Same led-circle in all versions

2

2

This drawing is our property. It can't be reproduced or communicated without our written agreement.



L T F F e i n e i n

DRAWING TITLE

Datasheet Anna40-series Lens

1

1

| | |
|-------------------|--------------------|
| DRAWN BY p | DATE 12.10.2010 |
| CHECKED BY s n | DATE 12.10.2010 |
| DESIGNED BY hh | DATE 30.07.2010 |

| | | |
|--------------|---------------------|--------------|
| SIZE A4 | DRAWING NUMBER - | REV 1 |
| SCALE 1:1 | WEIGHT (g) | SHEET 1/1 |

D

A

Luminaire: Ledil Oy C11794_ANNA-40-4-M-757 (Nichia 757 129lm @ 100mA) LOR=90%
Lamps: 1 x Nichia 757 129lm @ 100mA

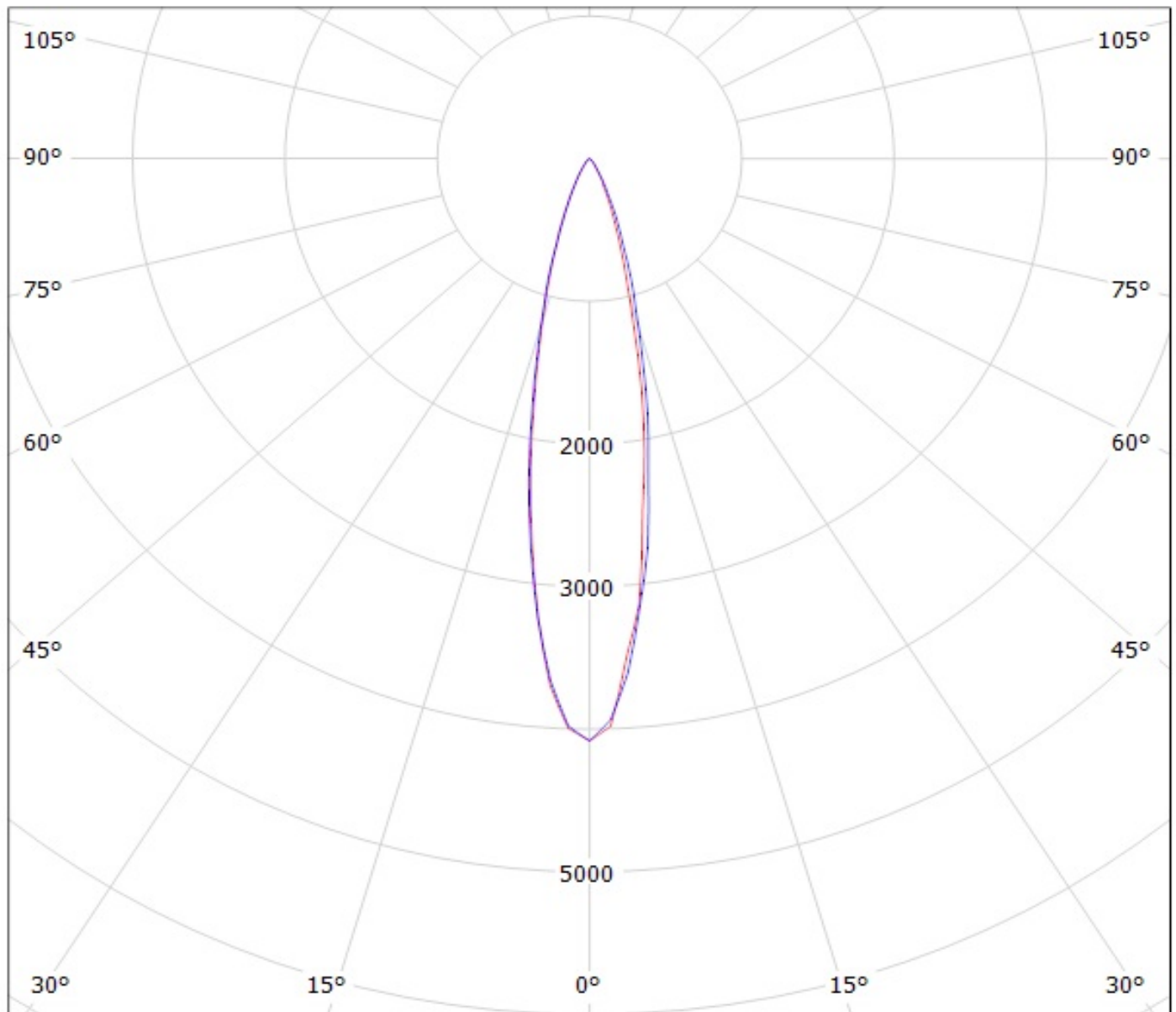

cd/klm

— C0 - C180

— C90 - C270