

Deep groove ball bearings, single row, SKF Energy Efficient (E2) bearings

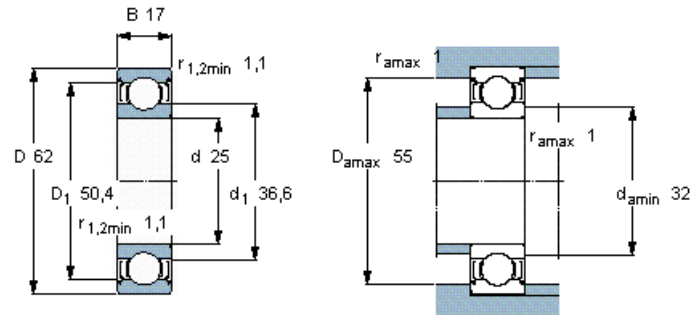

Principal dimensions			Basic load ratings		Fatigue load limit P_u	Speed ratings		Mass	Designation
d	D	B	dynamic	static		Reference speed	Limiting speed		
mm			kN		kN	r/min		kg	-
25	62	17	22,9	11,6	0,49	27000	15000	0,23	E2.6305-2Z/C3



Calculation factors

k_r 0,03
 f_0 12