

DATASHEET

ITEM: 28106

WHEEL FS 100X30/40 PB SWL X20

WHEEL SERIE

Wheels from thermoplastic compound suitable for high temperature applications (270°C / 518°F) with plain bore. For manual applications. Excellent shock resistance with minimal rolling resistance. Load rating according to EN12527 & EN12532 without obstacles. When present, do not apply brake at temperatures > 40°C (104°F).

Plain bore wheel.



FORK DESCRIPTION

Inox20 series, polished stainless steel forks, swivels with double ball races.

TECHNICAL DETAILS

Wheel diameter	(D)	100 mm
Tyre width	(E)	30 mm
Bore diameter	(d)	12 mm
Reference weight		0,59 kg
Overall height	(H)	128 mm
Top plate outer dimensions	(AxB)	102x83 mm
Bolt hole spacing	(axb)	76x55 mm
Bolt hole spacing	(axb)	80x60 mm
Fixing bolt diameter	(g)	8 mm
Offset	(F)	37 mm
Fork width	(U)	40 mm
Load capacity		150 kg

Possible options :

Wheel replacement 28006

Brake FR

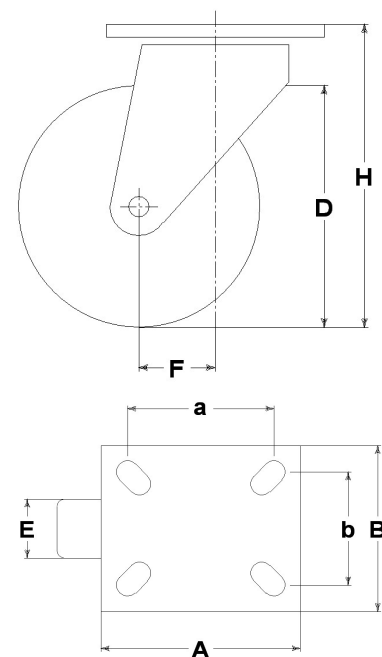

GENERAL INFORMATION / RECOMMENDATIONS AND WARNINGS

The cited text and the complete catalogue in their most up-dated versions are available in our web-site www.lagspa.eu/web/downloads. The dimensions, descriptions, specifications and illustrations herein are indicative and subject to variations without notice. The fact that products are illustrated herein does not necessarily imply they are available from stock nor does it place us under any obligation to supply them. Tests carried out refer to the original products with original accessories: the replacement of one of the components with others of different manufacture might prevent the same results from being achieved and will automatically invalidate any guarantee. Please contact our technical service concerning any special application.