

X
(Lochbild)
(board drillings)

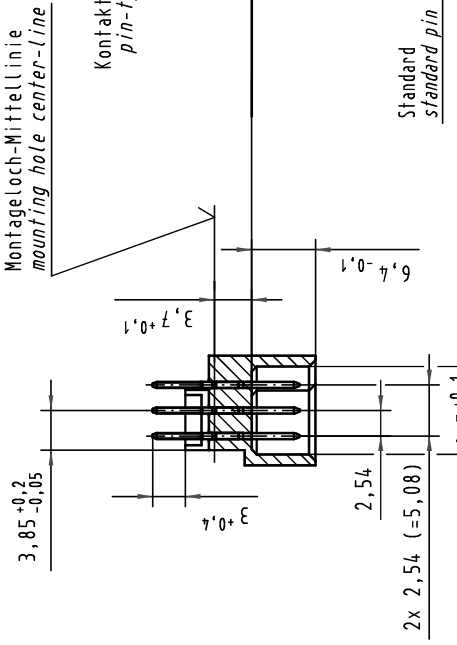

A-B
2:1

X
Kontaktbelegung
contact loading

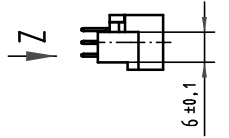
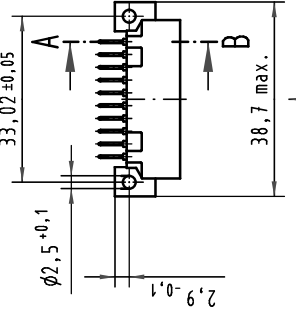
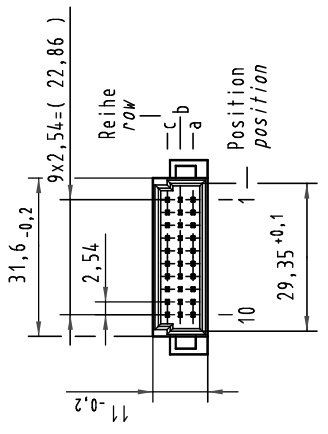
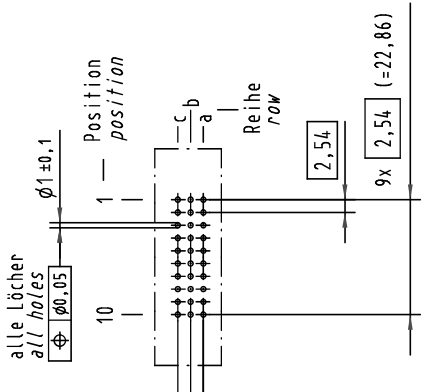
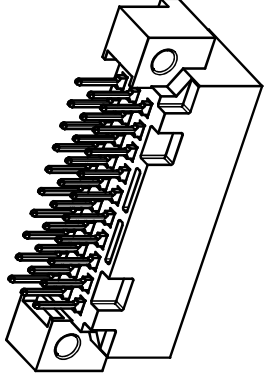
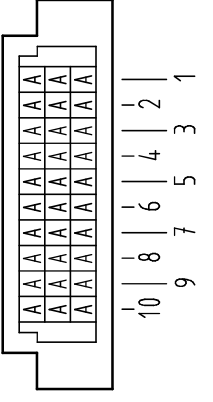

09 25 130 6922	2	Au flash over PdNi over Ni
Bestell-Nr. part-no.	Anforderungsstufe nach IEC performance level acc. to IEC	Kontaktoberfläche contact plating
Nicht tolerierte Maß-/Free size tolerances IEC 60603-2		
Maßstab/Scale Bauform 3C Messerleiste Einlötl, 30 pol. type 3C male connector solder, 30 pol.		
HARTING Electronics GmbH & Co. KG D-32339 ESPELKNIP		
TB 09 25 130 X922 Blatt/page Sub.		

